

FED. ROAD DIST. NO.	STATE	FED. AID PROJ. NO.	FISCAL YEAR	SHEET NO.	TOTAL SHEETS
0	VT	18	1948	10	24

TOWN OF
 W. B. BROWN
 SUBDIVISION OF
 1948
 MAP NO. 100
 100' X 100'

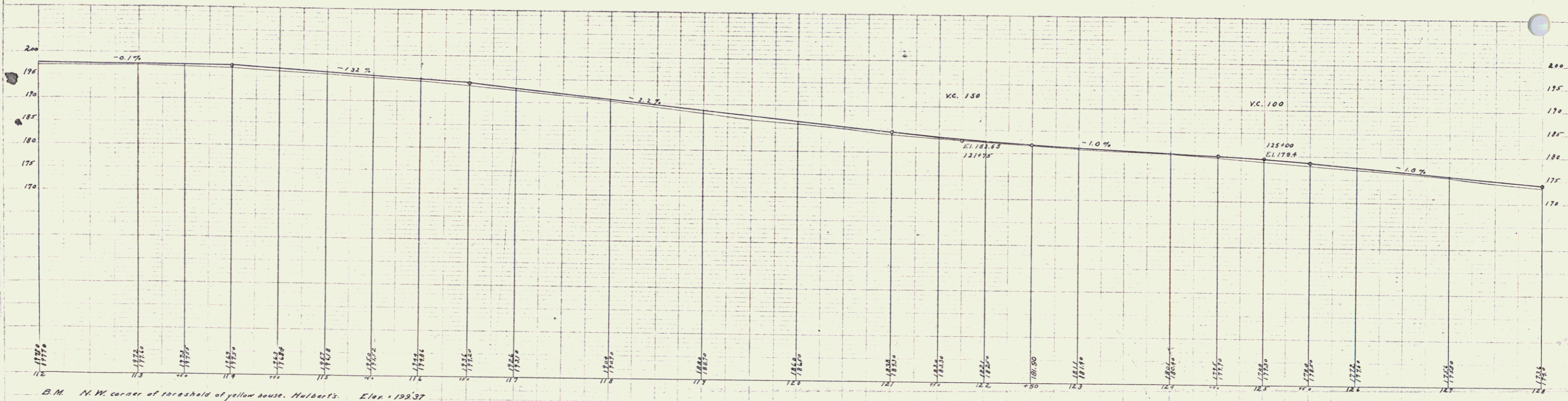
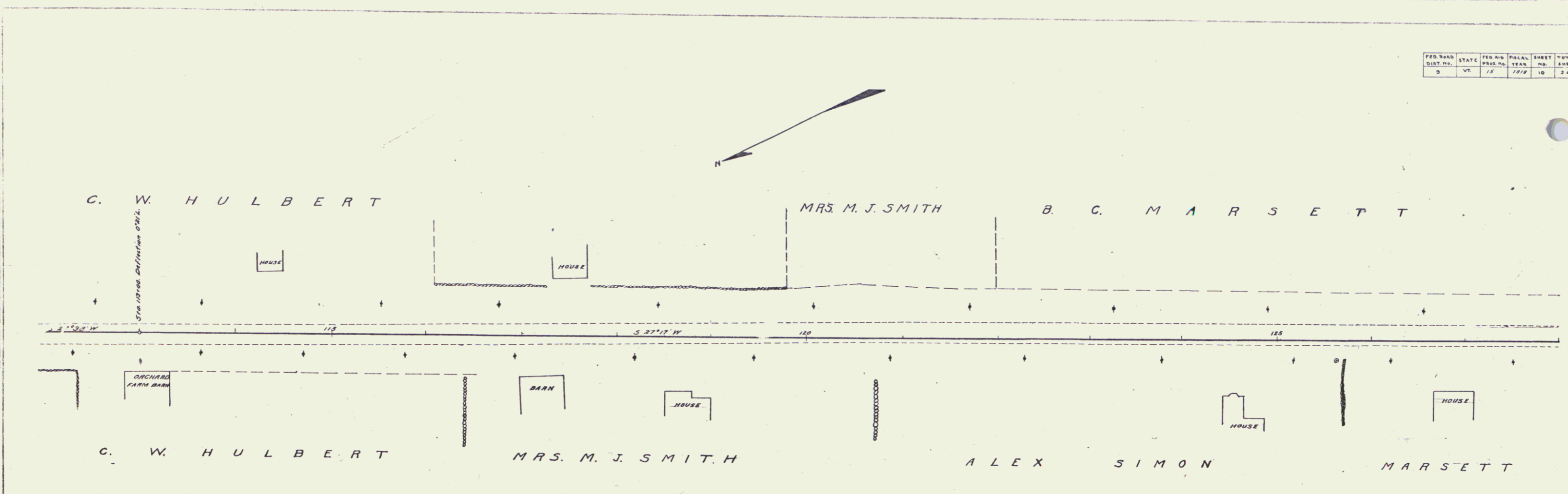

B.M. N.W. corner of threshold of yellow house, Hulbert's. Elev. 192.37
 B.M. N.E. corner of top front step of Marsett's house. Elev. 179.20

Series F-100-100
 544000-10