

FED. ROAD DIST. NO.	STATE	FED. AID PROJ. NO.	FISCAL YEAR	SHEET NO.	TOTAL SHEETS
5	VT	17	1918	5	23

W.B. BROWN  
 CIVIL ENGINEER  
 111 W. WATER ST.  
 CHICAGO, ILL.

W.B. BROWN  
 CIVIL ENGINEER  
 111 W. WATER ST.  
 CHICAGO, ILL.

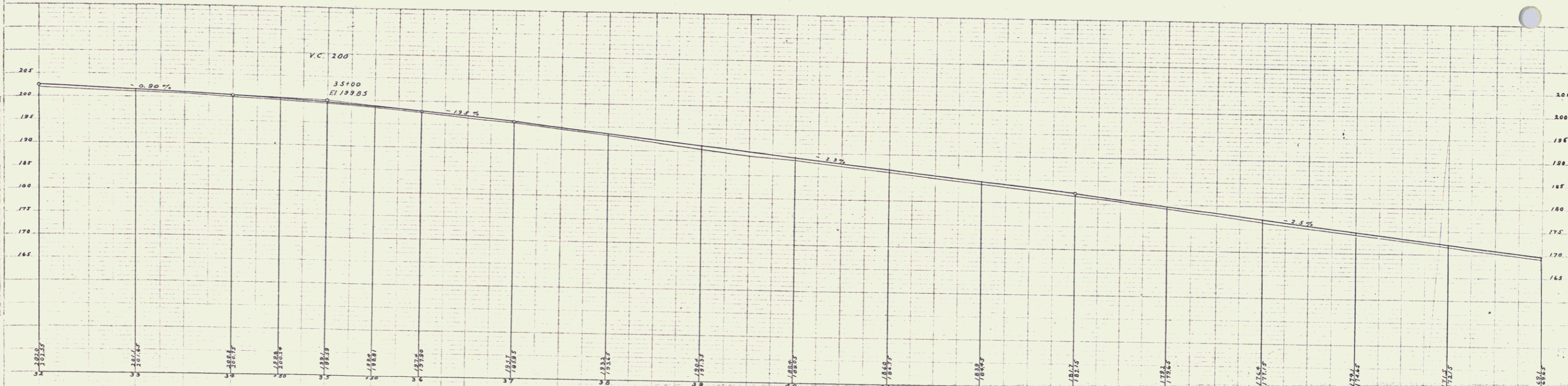
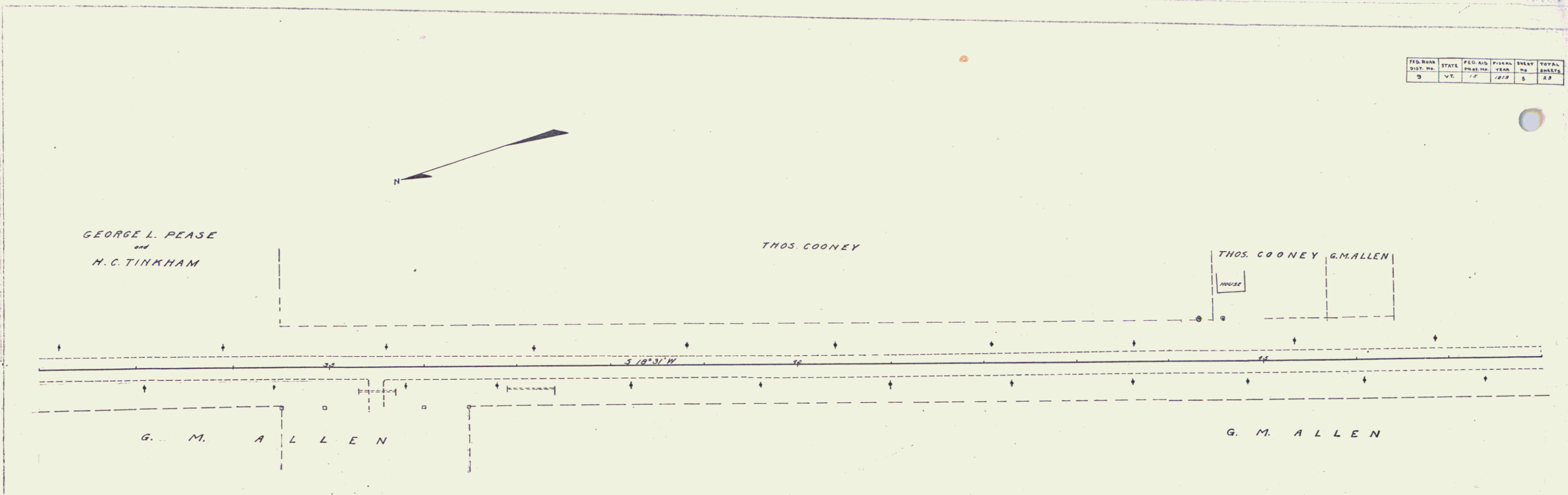

B.M. North corner of S.E. entrance stone (to Pierson's) at South of entrance. Elen. 196.08  
 B.M. West stone of North end of culvert, in front of Cooney's. Elen. 177.20.

SHEET NO. 5 OF 23  
 4