

WOOD GUARD RAIL REQUIRED

STATION	LENGTH
Sta 376+50 to Sta 376+76	24 ft
Sta 376+76 to Sta 381+00	42 ft

CABLE GUARD RAIL REQUIRED

ON LEFT
Sta. 372+00 to Sta. 372+52 Length 52 ft.

NEW GULLETS REQUIRED

Sta 372+00	16" Cast Iron Pipe Culvert	32 ft
	Concrete Class B (1-2-4)	27 Cu Yds
	Reinforcing Steel	22 pounds
Sta 376+70	24" Manj. Conc. Box Culvert	12.8 Cu Yds
	Concrete Class A (1-2-4)	837 pounds
	Reinforcing Steel	32 ft
Sta 381+80	16" Cast Iron Pipe Culvert	32 ft
	Concrete Class B (1-2-4)	27 Cu Yds
	Reinforcing Steel	22 pounds

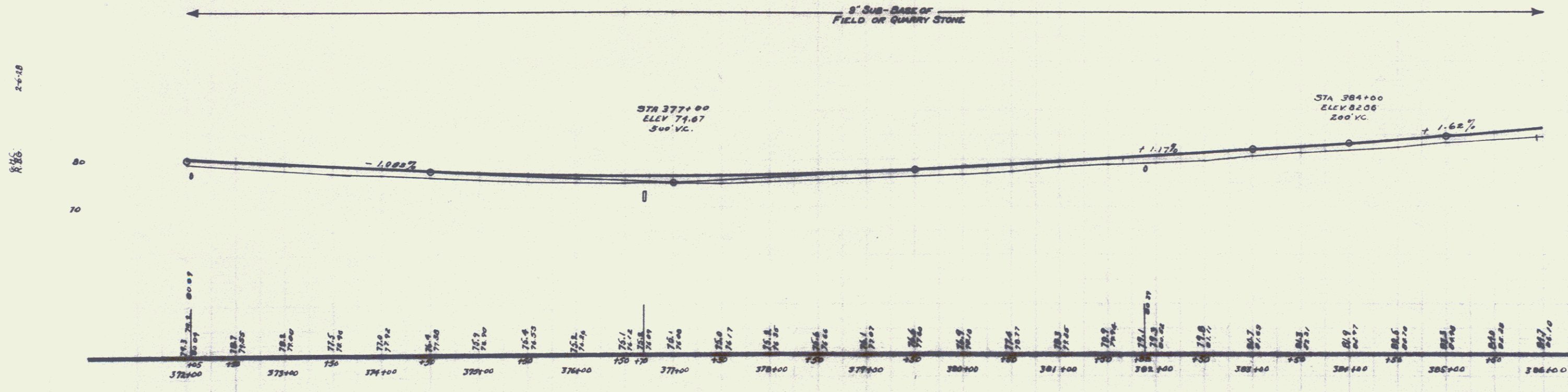
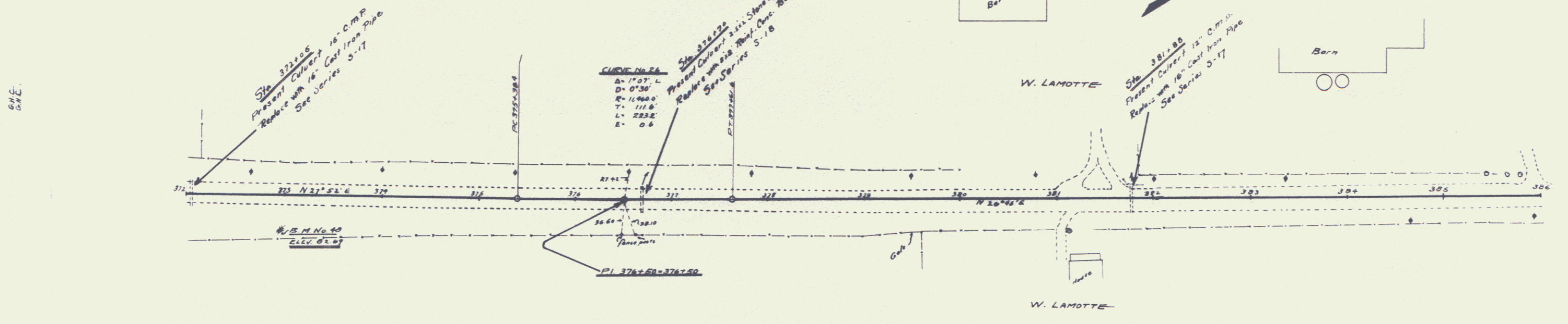

B.M. No. 99 Boulder on Right of Sta. 372+78 Elev. 82.67

19