

CABLE GUARD RAIL REQUIRED
 On Left
 Sta 118+24 to Sta 119+00 Length 186 ft
 On Right
 Sta 118+24 to Sta 119+00 Length 186 ft

NEW CULVERTS REQUIRED
 Sta 118+78 Reinf. Con. Box Culvert
 Concrete Class A(1-2-A) 232 Cyd
 Reinforcing Steel 1602 lb.

Town: Georgia - St. Albans
 Route: US 7 Pin # 99R430
 Proj: F52B
 WILLIAM CLARK

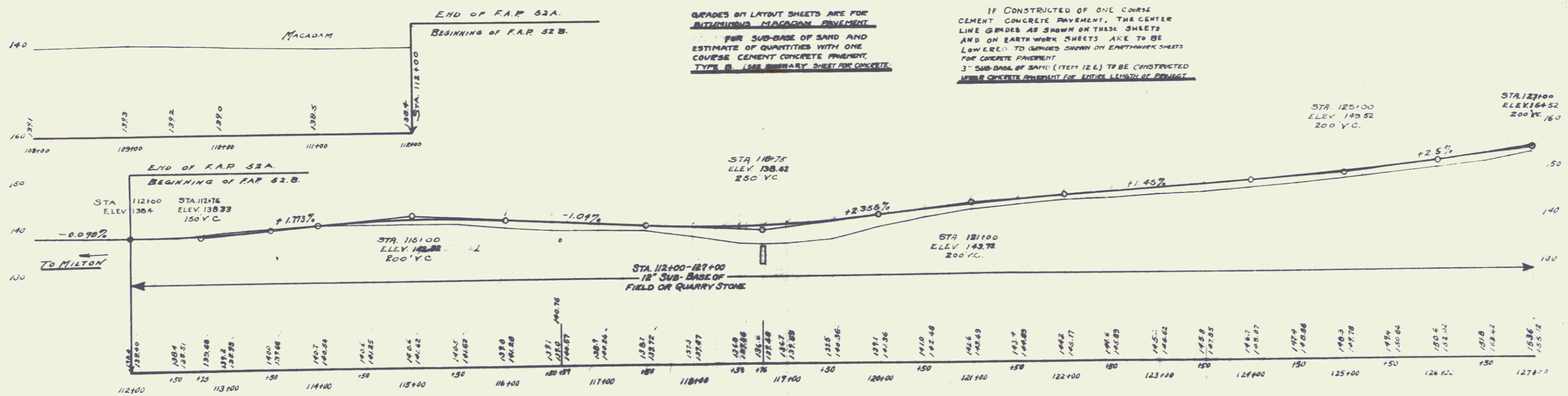
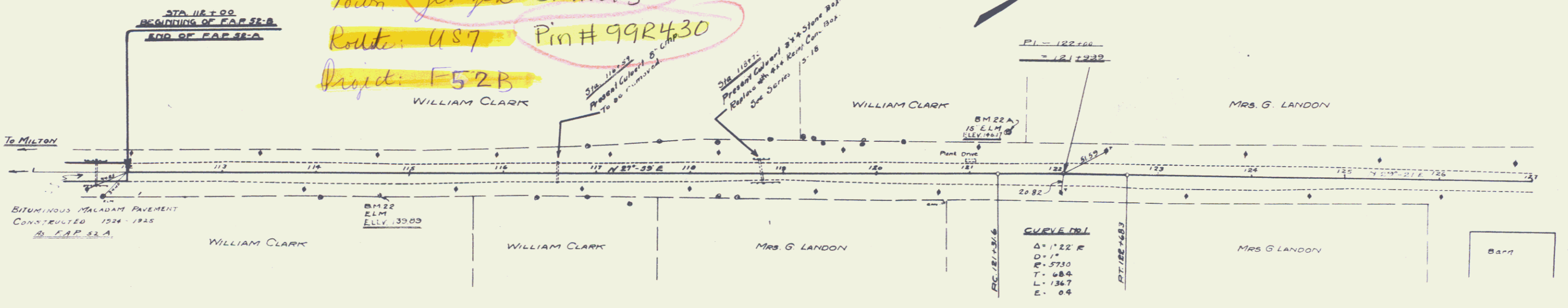

BM #22 SPIKE IN ELM RT STA 114+70 ELEV. 139.89
 BM #22A SPIKE IN 16" ELM LT STA 121+00 ELEV. 146.17

11128
 SERIES F No 52B
 SHEET 6 of 71