

INDEX OF SHEETS

STATE OF VERMONT
DEPARTMENT OF HIGHWAYS

PROPOSED IMPROVEMENT

TOWN OF GEORGIA
COUNTY OF FRANKLIN *Pin # 99R428*
U.S. ROUTE 7 AND VERMONT 104-A
BURLINGTON-ST. ALBANS ROAD
R.O.W. PLANS

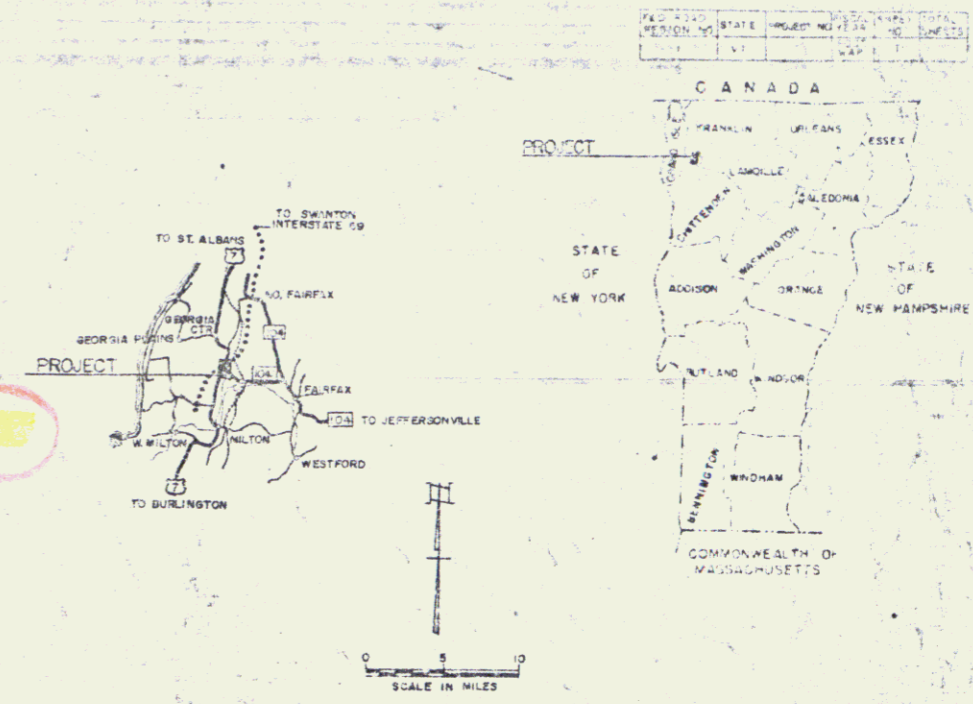

BP 019-5 6676

BEGINNING AT A POINT 0.802 MILE NORTH OF THE MILTON-GEORGIA TOWN LINE AND EXTENDING NORTHERLY 0.985 MILES EXCLUDING A CENTER SECTION OF 0.502 MILE

BEGINNING AT THE JUNCTION WITH U.S. ROUTE 7, NORTH OF THE MILTON-GEORGIA TOWN LINE AND EXTENDING EASTERLY 0.284 MILE

LENGTH OF CONTRACT 4051.75 FEET 0.767 MILE

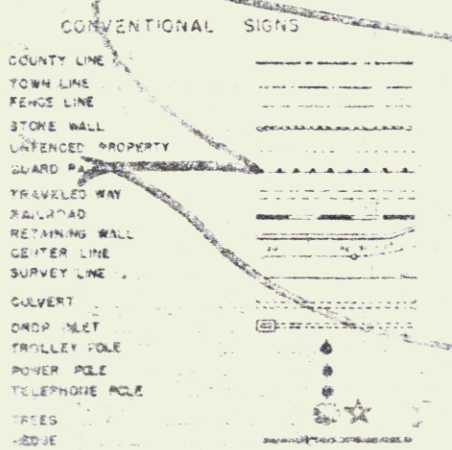
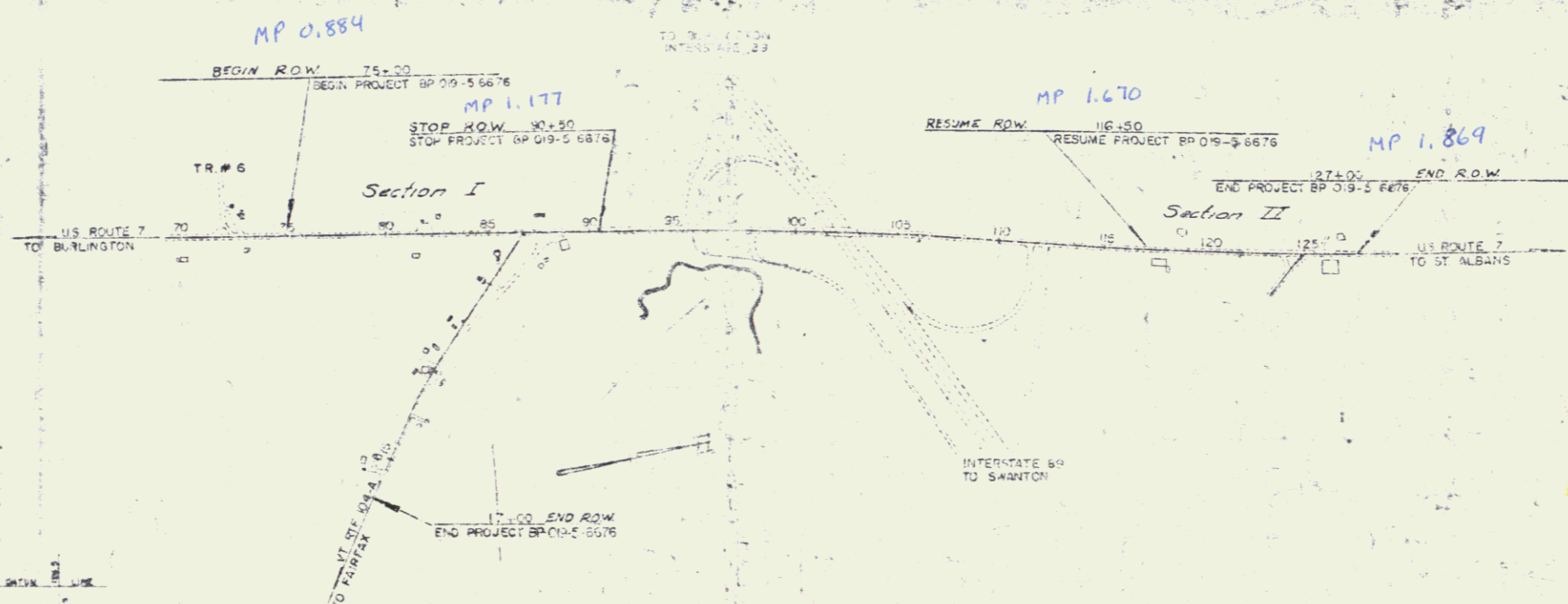

GROUND ELEVATION

| GRADE ELEVATION | RAIN | ICE LINE |
|-----------------|------|----------|
| — | — | — |

CURVE DATA

| DEFLECTION ANGLE | A |
|-----------------------|------|
| DEGREE OF CURVE | D |
| RADIUS OF CURVE | R |
| TANGENT DISTANCE | T |
| LENGTH OF CURVE | L |
| EXTERNAL DISTANCE | E |
| POINT OF INTERSECTION | PI |
| POINT OF CURVE | PC |
| POINT OF TANGENT | PT |
| POINT ON TANGENT | PST |
| POINT ON SUBTANGENT | POST |

RIGHT-OF-WAY DIVISION
TOWN FILE
PERPETUAL
Route U.S. #7
(To Be Returned To R.O.W. Division)

THESE PLANS ARE SUBJECT TO SUCH REVISIONS AS MAY BE REQUIRED BY THE BUREAU OF PUBLIC ROADS OF THE COMMISSIONER OF HIGHWAYS.
CONSTRUCTION IS TO BE CARRIED ON IN ACCORDANCE WITH THESE PLANS AND THE STANDARD SPECIFICATIONS FOR HIGHWAY AND BRIDGE CONSTRUCTION, LATEST EDITION, AS ADOPTED BY THE BUREAU OF PUBLIC ROADS OF VERMONT. ANY CHANGES MADE BY THE BUREAU OF PUBLIC ROADS OR ANY OTHER AGENCY SHALL BE INDICATED BY SPECIAL APPROVAL REVISED AND SUCH REVISED SPECIFICATIONS AND SPECIAL PROVISIONS TO BE INDICATED IN THESE PLANS.

DEPARTMENT OF COMMERCE
BUREAU OF PUBLIC ROADS

APPROVED

BP 019-5-7185 Const.
REQ. NO. BP 019-5-6676 Rev

SHEET 1 OF 2 SHEETS

| APPROVED | DATE | APPROVED | DATE | APPROVED | DATE | APPROVED | DATE | APPROVED | DATE |
|--------------------|--------|--------------------|--------|--------------------|--------|--------------------|--------|--------------------|--------|
| <i>[Signature]</i> | 7/8/66 | <i>[Signature]</i> | 7/8/66 | <i>[Signature]</i> | 7/8/66 | <i>[Signature]</i> | 7/8/66 | <i>[Signature]</i> | 7/8/66 |

STATE OF VERMONT
DEPARTMENT OF HIGHWAYS
RIGHT-OF-WAY PLANS
DETAIL SHEET
OF

TABLE OF PROJECT PROPERTY ACQUISITION

| PARCEL NO. | GRANTOR | SHEET NO. | BEGINNING STATION | ENDING STATION | TAKING | REM. | RIGHTS | TITLE TABLE | DATE | TOWN OR CITY RECORDED | EN. | PC | REMARKS |
|------------|----------------------------------|-----------|--|----------------------------------|--------|----------------|---|-------------|------|-----------------------|-----|----|---------|
| 1 | PERRAS, GERALD P. & ALICE J. | 7 | 75+00 RT 77+31 RT | 77+39 RT | 2300' | 14.0A' | | | | | | | SIGN |
| 2A | BLAKE, GEORGE E. & YVONNE M. | 7 | 75+00 LT | 77+52 LT | 2600'± | 1.9A' | | | | | | | |
| B | | 8,9 | 84+33 RT 84+38 RT 88+44 RT 2+20VTDART | 1+07 LT 0+86 RT 89+00 RT | 0.5A' | 0.4A' 0.3A' | DRIVE (T) | | | | | | |
| D | | | 89+00 RT 89+70 RT 88+34 RT | 90+92 RT | 0.5A' | | DRIVE (T) DRAINAGE (D) | | | | | | |
| E | | | 90+50 RT | 90+92 RT | | | DITCH (P) | | | | | | |
| | | | 89+00 RT 88+93 LT 92+40 LT | 90+92 RT 89+64 LT 92+60 LT | | | SLOPE (3000°) (T) SLOPE (80°) (T) SLOPE (40°) (T) | | | | | | |
| C | | 9 | 85+00 RT 88+92 LT 88+93 LT | 85+63 RT 89+64 LT 92+64 LT | 1600'± | 7.7A' | SLOPE (460°) (T) | | | | | | |
| 3 | FAIRBANKS, RAEBURN M. & FLORA E. | 7,8 | 77+52 LT 79+50 LT 82+00 LT 77+80 LT | 84+46 LT 84+00 LT | 0.3A' | 12.7A' | SLOPE (1550°) (T) DRIVE (T) | | | | | | SIGN |
| 4 | GAUDETTE, ETHEL I. | 7,8 | 77+34 RT 77+34 RT | 81+00 RT 81+00 RT | 0.14A' | 1.86A' | SLOPE (500°) (T) | | | | | | |

TABLE OF REVISIONS

| REVISION NO. | SHEET NO. | DESCRIPTION OF REVISION | DATE | MADE BY | APPROVED BY |
|--------------|-----------|---|----------|---------|-------------|
| 1 | 10 | CHANGE OF OWNERSHIP OF PARCEL #1 TO READ: GERALD P. & ALICE J. PERRAS PER C.O.# 1270 | 10-31-68 | CRG | TCB |
| 2 | 10 | CHANGE OF OWNERSHIP OF PARCEL #9 TO READ: RUDOLPH & CLAIRE BOURDEAU PER C.O.# 1271 | 10-31-68 | CRG | TCB |
| 3 | 10 | CHANGE OF OWNERSHIP OF PARCEL #10 TO READ: DONALD R. & PENNY F. COBB PER C.O.# 1272 | 10-31-68 | CRG | TCB |
| 4 | 10 | ADDITION OF NEW PARCEL #12 OWNERS: MARK GAGNON & MARCEL GONYEAU PER C.O.# 1273 | 10-31-68 | CRG | TCB |
| 5 | 4,8,9 | PARCELS #11&2A CORRECTED THE AREAS OF THESE PARCELS. COMBINED OLD PARCELS #2B1&2C TO MAKE NEW PARCEL #2B MADE NEW PARCELS #2C1&2D WHICH WERE ORIGINALLY PART OF 2B PER CHANGE ORDER #1307 | 1-30-69 | WJM | TCB |
| 6 | | PARCEL #9 DELETED DRIVE RIGHT STA 125+37, PER CHANGE ORDER #1322 | 2-18-69 | RLS | TCB |
| 7 | 5,6,9 | PARCELS #8&11 CHANGED THE TAKING LINE ON PARCEL #11 ALSO THE SLOPE RIGHTS. CHANGED THE DRAINAGE ON PARCEL #8 PER CHANGE ORDER #1324 | 2-24-69 | WJM | SRJ SRJ |
| 8 | 8 | PARCEL #2D REMOVED CULVERT EXTENSION. NEW STATIONING READS 88+17RT-88+34RT, PER CHANGE ORDER #1325 | 2-26-69 | RLS | SRJ SRJ |
| 9 | 9 | PARCEL #11 ADDED SEPTIC TANK TO PLANS AT STATION 4+98 RT PER CHANGE ORDER #1349 | 4-1-69 | SRJ | SRJ |
| 10 | 6 | PARCEL #12 ADDED SLOPE RIGHTS (25°) TO DETAIL SHEET PER CHANGE ORDER #1357 | 4-7-69 | WJM | SRJ |
| 11 | 9 | Parcel no 8, Removed culvert at sta. 5+00 Rt-6+75 Lt, and permanent culvert & drainage at sta. 6+29-6+75 Lt from plans per change order no. 1358 | 4-8-69 | RLS | SRJ |
| 12 | 5,10 | PARCEL #9 ADDED DITCH RIGHT & CULVERT EIGHT TO DETAIL SHEET & REMOVED SEPTIC TANK DRAIN FROM LAYOUT SHEET PER CHANGE ORDER #1359 | 4-8-69 | WJM | SRJ |

LEGEND

MAILED BY NBB DATE 6-13-68

CHECKED BY L.W.B. DATE 6-11-68

— PRESENT R.O.W.
— TAKING WITHOUT ALLEYS
— TAKING WITHOUT ACCESS ALONG PROPERTY LINES
— DURING WIDE ACCESS
— PERMANENT EASEMENT
— TEMPORARY EASEMENT

— SLOPE 1:1
— SLOPE 2:1
— SLOPE 3:1
— SLOPE 4:1
— SLOPE 5:1
— SLOPE 6:1
— SLOPE 7:1
— SLOPE 8:1
— SLOPE 9:1
— SLOPE 10:1
— SLOPE 12:1
— SLOPE 15:1
— SLOPE 20:1
— SLOPE 25:1
— SLOPE 30:1
— SLOPE 40:1
— SLOPE 50:1
— SLOPE 60:1
— SLOPE 75:1
— SLOPE 100:1

APPROVED Thomas C. Remilly 6-14-68
J.M. L... 6-17-68
S.E. Jenkins 6-17-68

PROJECT GEORGIA
BP 019-5-6676
OF 12

STATE OF VERMONT
DEPARTMENT OF HIGHWAYS
RIGHT-OF-WAY PLANS
DETAIL SHEET
OF

TABLE OF PROJECT PROPERTY ACQUISITION

| PARCEL NO. | GRANTOR | SHEET NO. | BEGINNING STATION | ENDING STATION | TAKING | REM. | RIGHTS | TITLE TAKEN | DATE | TOWN OR CITY RECORDED | BK. | PG. | REMARKS |
|------------|----------------------------------|-----------|---|-------------------------------------|---|------|---|-------------|------|-----------------------|-----|-----|---------------------------------|
| 5 | GAUDETTE, VERNON L. & SHIRLEY J. | 8 | 81+00 RT 81+00 RT 81+08 RT | 84+38 RT 81+85 RT | 0.24 [±] 5.76A [±] | | SLOPE (500 [±]) (T) DRIVE (T) | | | | | | |
| 6 | TURNER, AUGUSTUS R. | 8 | 84+46 LT 86+90 LT 87+00 LT 87+88 LT | 88+93 LT 88+93 LT | 0.3A [±] 2.9A [±] | | REMOVE SEPTIC TANK (T) DRIVE (T) SLOPE (400 [±]) (T) | | | | | | |
| 7 | KING, KATHLEEN L. | 8 | 89+64 LT 89+64 LT 89+87 LT | 91+04 LT 91+04 LT | NONE 0.26A [±] | | SLOPE (1400 [±]) (T) DRIVE (T) | | | | | | |
| 8A | BLAKE, EDWARD M. & ETHEL C. | 8 | 90+92 RT | 92+34 RT | NONE 14.5A [±] | | SLOPE (2170 [±]) (T) | | | | | | |
| B | | 9 | 1+94 LT 90+92 RT | 6+72 LT 91+60 RT | 2450 [±] 20.9A [±] | | DRAINAGE & DITCH (P) DRIVE (T) | | | | | | |
| | | 8 | 91+00 | 91+15 RT | | | DRIVE (T) | | | | | | |
| 9 | BOURDEAU, RUDOLPHE & CLAUDE | 10 | 116+05 LT 117+90 LT 118+20 LT 118+15 118+25 LT 119+50 LT | 121+75 LT 121+25 LT 119+50 LT | | | SLOPE (4800 [±]) (T) DRIVE (T) WATER PIPE (P) DITCH (P) CULVERT (P) | | | | | | EXCEPT & RESERVE TO THE GRANTOR |

TABLE OF REVISIONS

| REVISION NO. | SHEET NO. | DESCRIPTION OF REVISION | DATE | MADE BY | APPROVED BY |
|--------------|-----------|--|---------|---------|-------------|
| 13 | 8 | Parcel no. 8 Deleted ditch at sta. 90+70 RT, per change order no. 1364 | 4-11-69 | RLS | RLS |
| 14 | 6 & 10 | PARCEL #10 CHANGED TAKE LINE THAT DELETED THE TAKING. ADDED DRAINAGE & DITCH & INCREASED THE SLOPE RIGHTS PER CHANGE ORDER #1371 | 4-22-69 | WJM | TGB |
| 15 | 8 | PARCEL #2 DELETED FOLLOWING FROM DETAIL SHEET; REMOVE GAS PUMPS (P) AT STATIONS 88+83 RT TO 89+00 RT. PER CHANGE ORDER #1375 | 4-24-69 | RLS | TGB |
| 16 | 7 & 8 | Parcel #2 Added drives at sta. 77+20 LT & 89+25 LT to layout sheets. Per Change Order #1302 | 5-4-71 | RLS | T.P.M. |
| 17 | 8 | Parcel #2D Changed position and length of culverts converging at sta. 88+34 RT to end in take. Per Change Order #1930 | 5-11-71 | RLS | RLS |

MADE BY: NBB DATE: 5-14-68
CHECKED BY: J.W.B. DATE: 6-11-68

PRESENT R.O.W.
--- TAKING WITHOUT ACCESS
--- TAKING WITHOUT ACCESS ALONG PROPERTY LINES
--- TAKING WITH ACCESS
(P) PERMANENT EASEMENT
(T) TEMPORARY EASEMENT

LEGEND
--- SR --- SR --- SLOPE RIGHTS
--- P --- P --- PROPERTY LINE
--- Δ --- Δ --- TOP OF CUT
--- O --- O --- TOP OF SLOPE

APPROVED: Thomas C. Bennett DATE: 6-19-68
APPROVED: J.M. Carlsberg DATE: 6-17-68
APPROVED: J.R. Lenham DATE: 6-17-68

PROJECT: GEORGIA
NO. BP-012-5-1188 6676
SHEET: 5 OF 12

STATE OF VERMONT
DEPARTMENT OF HIGHWAYS
RIGHT-OF-WAY PLANS
DETAIL SHEET
OF

TABLE OF PROJECT PROPERTY ACQUISITION

| PARCEL NO. | GRANTOR | SHEET NO. | BEGINNING STATION | ENDING STATION | TAKING | REM. | RIGHTS | TITLE TAKEN | DATE | TOWN OR CITY RECORDED | BK. | PG. | REMARKS |
|------------|--|-----------|--|-------------------------------------|--------|-------|--|-------------|------|-----------------------|-----|-----|---------|
| 10 | COBB, DONALD R. & PENNY F. | 10 | 125+64 LT 124+50 RT 125+37 LT 126+34 RT 125+76 LT 125+64 LT | 126+92 LT 126+50 LT | | | DRAINAGE (P) DRIVE (T) DRIVE (T) SLOPE (1740°)(T) DRAINAGE & DITCH (P) | | | | | | |
| 11 | WHITTEMORE, ELIZABETH M. A/K/A WHITTEMORE, EVELYN M. | 9 | 3+56 RT 5+07 RT 4+98 RT | 5+10 RT 5+18 RT | 0.1A± | 0.7A± | SLOPE (100°)(T) ALL RT & L IN & TO SEPTIC TANK (P) | | | | | | WELL |
| 12 | GAGNON, MARK & GONYEAU, MARCEL | 10 | 116+50 RT 116+50 RT 119+50 RT 118+09 RT | 125+37 RT 117+15 RT 118+45 RT | | | SLOPE (975°)(T) DRAINAGE & DITCH (P) SLOPE (125°)(T) | | | | | | |

TABLE OF REVISIONS

| REVISION NO. | SHEET NO. | DESCRIPTION OF REVISION | DATE | MADE BY | APPROVED BY |
|--------------|-----------|-------------------------|------|---------|-------------|
| | | | | | |
| | | | | | |
| | | | | | |
| | | | | | |

MADE BY NBB DATE 6-14-68
CHECKED BY LMB DATE 6-17-68

- LEGEND
- PRESENT R.O.W.
 - //--- TAKING WITHOUT ACCESS
 - //--- TAKING WITHOUT ACCESS ALONG PROPERTY LINES
 - //--- TAKING WITH ACCESS
 - (P) PERMANENT EASEMENT
 - (T) TEMPORARY EASEMENT
 - SR — SR — SLOPE RIGHTS
 - L — L — PROPERTY LINE
 - Δ — Δ — TOP OF CUT
 - O — O — TOP OF SLOPE

APPROVED Thomas C. Benoitly DATE 6-14-68
APPROVED J. M. Lewis DATE 6-17-68
APPROVED A. H. Leachman DATE 6-17-68

PROJECT GEORGIA
NO. BP 019-5-7105 6676
SHEET 6 5 12

PLAN
 DATE: 10/15/50
 DRAWN BY: [Signature]
 CHECKED BY: [Signature]
 NO. 101

PROFILE
 DATE: 10/15/50
 DRAWN BY: [Signature]
 CHECKED BY: [Signature]
 NO. 101

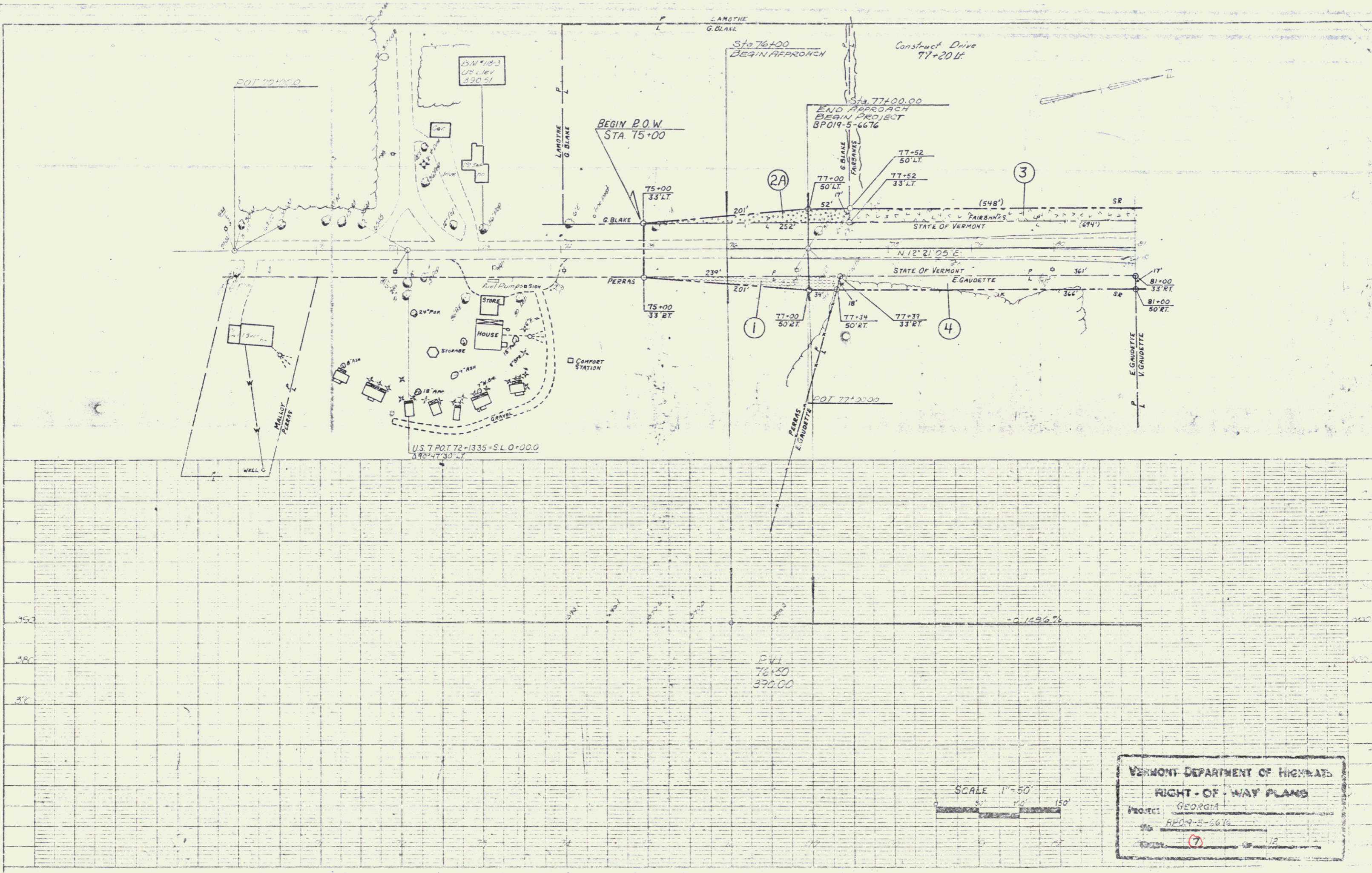

SCALE 1" = 50'
 0 50 100 150

VERMONT DEPARTMENT OF HIGHWAYS
 RIGHT-OF-WAY PLANS
 PROJECT: GEORGIA
 NO. 101-5-5476
 DATE: 10/15/50

5

PLAN
 DRAWN BY: [unclear]
 CHECKED BY: [unclear]
 DATE: [unclear]

PROFILE
 DRAWN BY: [unclear]
 CHECKED BY: [unclear]
 DATE: [unclear]

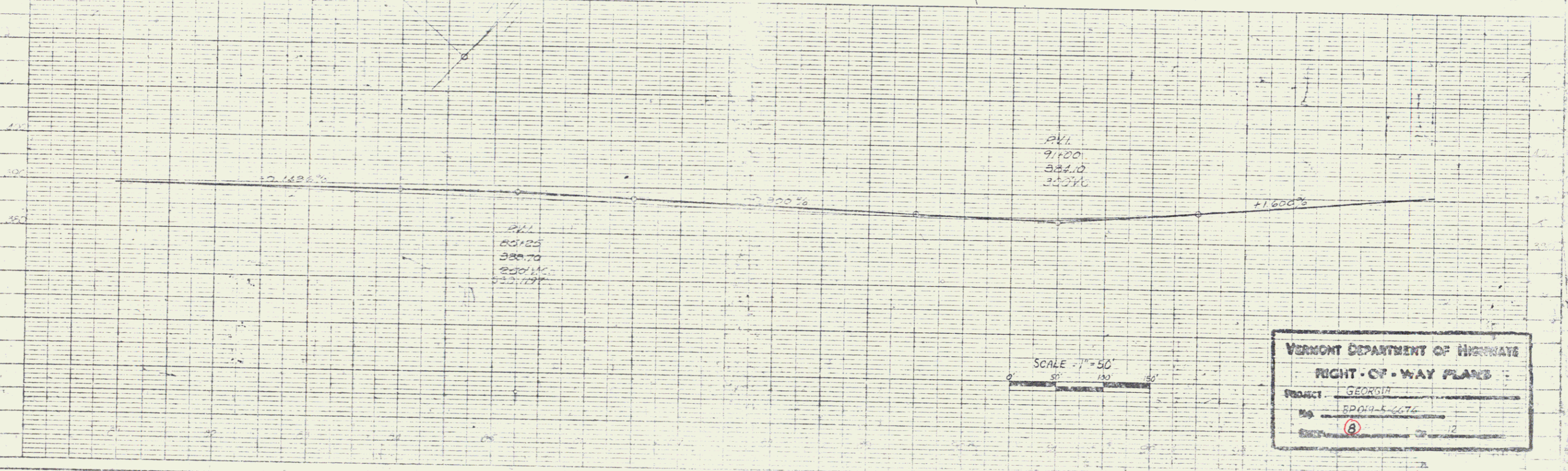
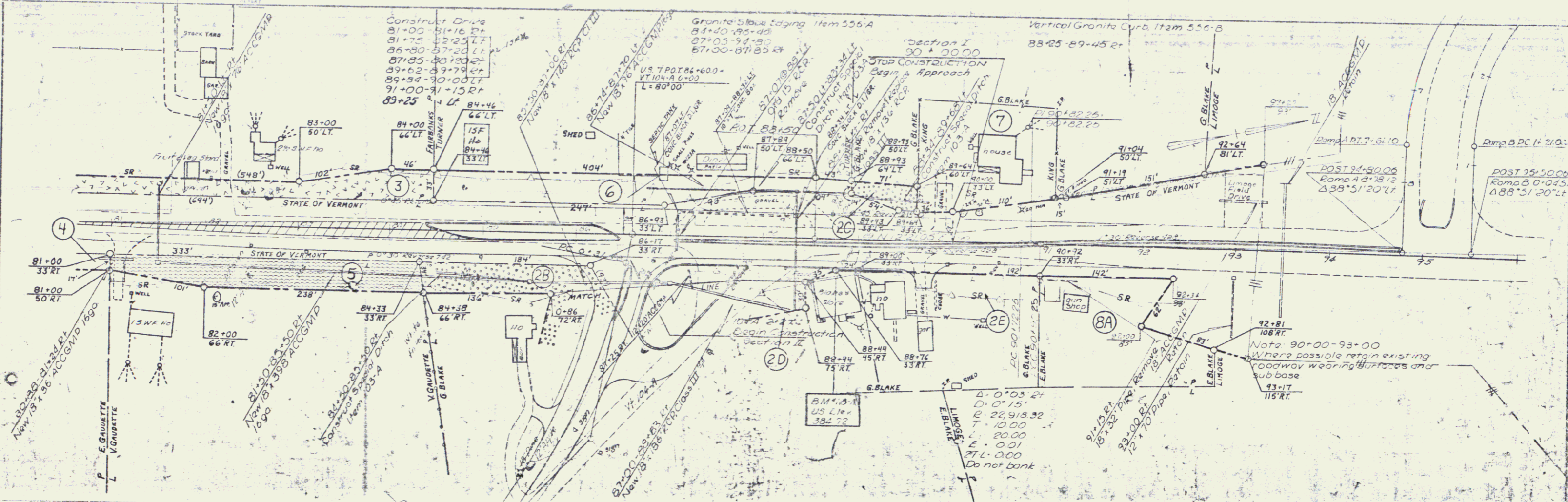

VERMONT DEPARTMENT OF HIGHWAYS
RIGHT-OF-WAY PLANS
 PROJECT: GEORGIA
 NO. 85014-S-6674
 SHEET: 8 OF 12

Δ 105.51' LT
 D 0' 13"
 R 229.332
 T 213.51
 L 439.00
 E 1.15

SECTION I
 Sta 116+00
 RESUME CONSTRUCTION
 PROJECT 8P019-5-6676

Granite S/Scre Edging
 Item 53097
 112+19.99 - 117+00

Construct Drive
 115+33 LT
 118+36 LT
 125+37 LT
 126+34 RT

STA 127+00
 END ROW Sec II

PLAN
 1" = 40'

PROFILE
 1" = 10'

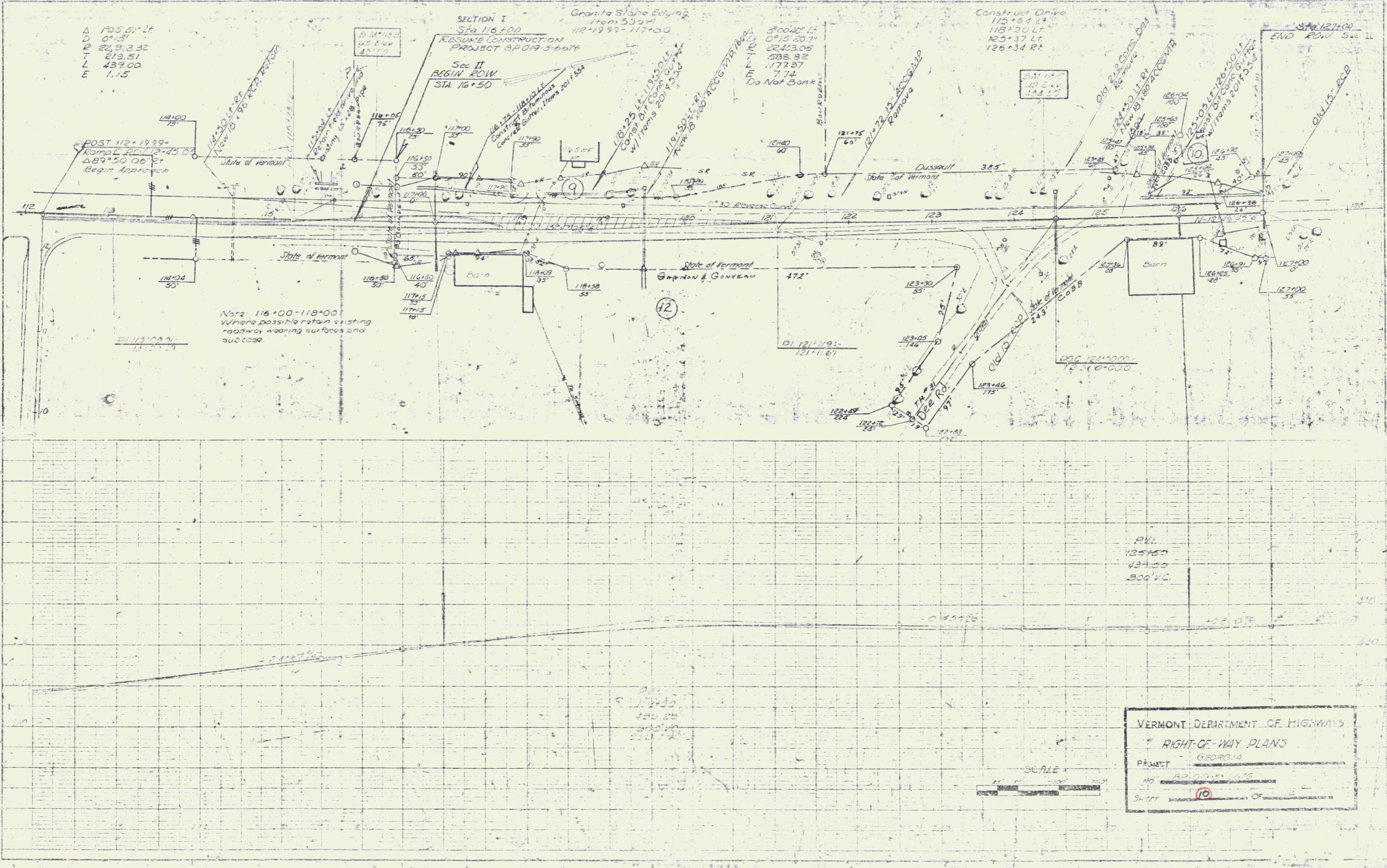

Note 116+00-118+00
 Where possible retain existing
 roadway wearing surfaces and
 subbase

VERMONT DEPARTMENT OF HIGHWAYS
 RIGHT-OF-WAY PLANS
 PROJECT GEORGIA
 NO. 8P019-5-6676
 SHEET 10 OF 12

SCALE
 1" = 40'

PVI
 125+50
 434.50
 300' RC

PVI
 125+50
 434.50
 300' RC

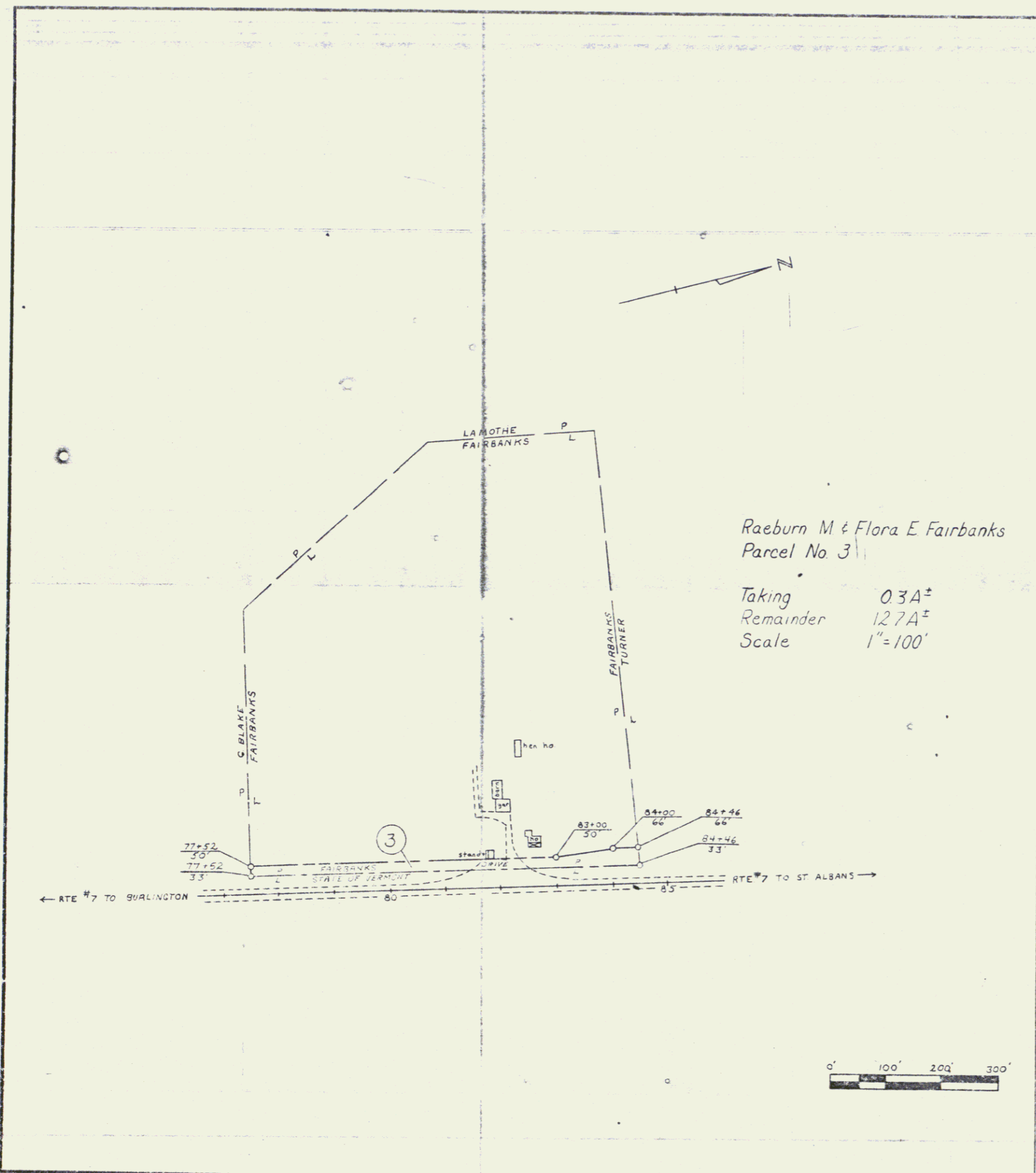

Raeburn M & Flora E Fairbanks
Parcel No 3
Taking 0.3A±
Remainder 12.7A±
Scale 1"=100'

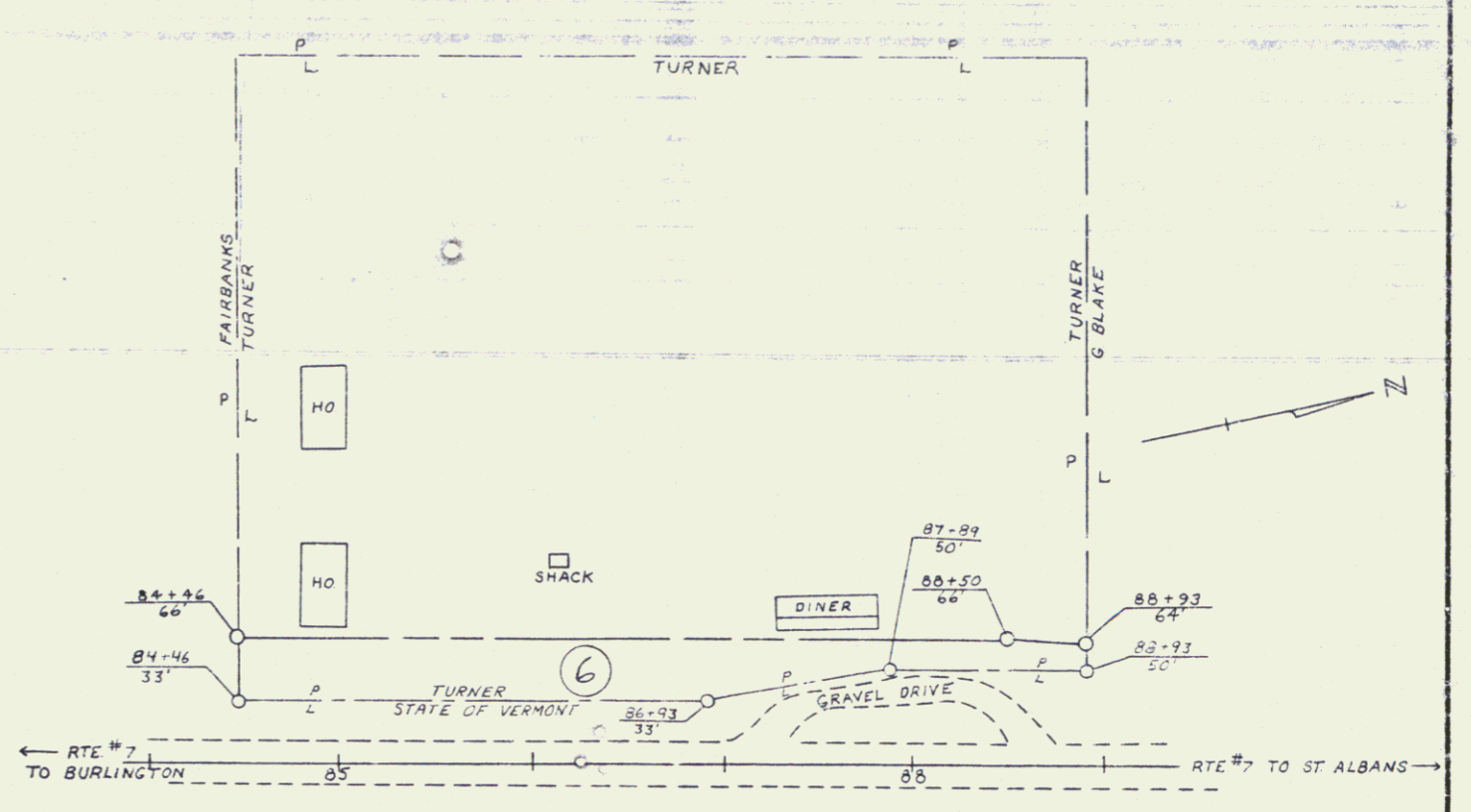
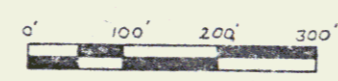

Augustus R Turner
Parcel No 6
Taking 0.3A±
Remainder 2.9A±
Scale 1"=50'

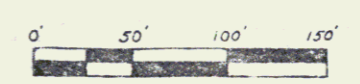

VERMONT DEPARTMENT OF HIGHWAYS
RIGHT-OF-WAY PLANS
GEORGIA
BP-019-5-6676
11 12

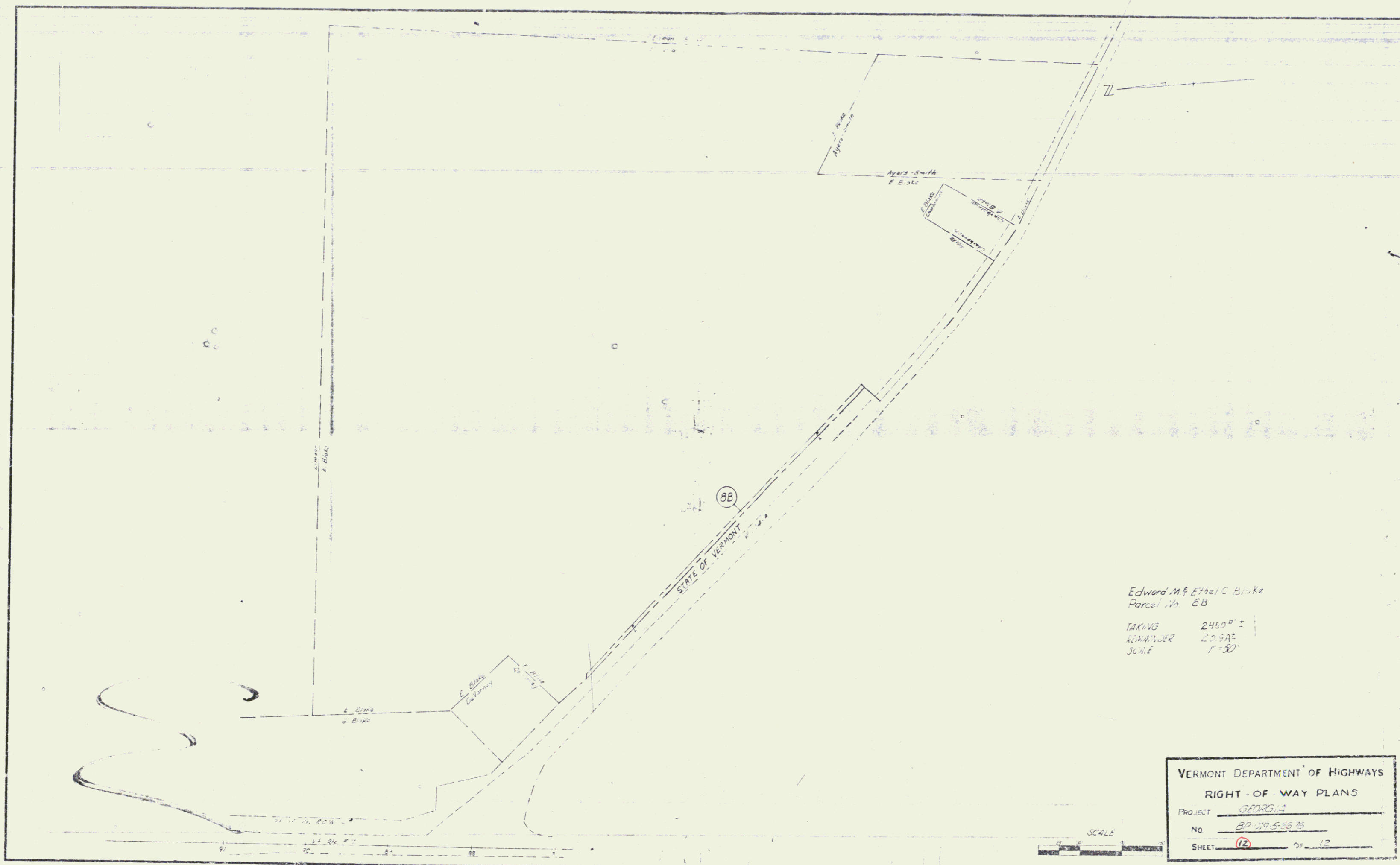

Edward M. & Ethel C. Blake
 Parcel No. EB
 TAKING 2450⁰⁰ ±
 REMAINDER 2094⁰⁰ ±
 SCALE 1"=50'

VERMONT DEPARTMENT OF HIGHWAYS
 RIGHT-OF-WAY PLANS
 PROJECT GEORGETOWN
 NO. BD 019 5-26 75
 SHEET (12) OF 12



0-9

10

INDEX OF SHEETS

STATE OF VERMONT
DEPARTMENT OF HIGHWAYS

PROPOSED IMPROVEMENT

TOWN OF GEORGIA
COUNTY OF FRANKLIN
U.S. ROUTE 7 AND VERMONT 104-A
BURLINGTON-ST. ALBANS ROAD
R.O.W. PLANS

BP 019-5 6676

BEGINNING AT A POINT 0.892 MILE NORTH OF THE MILTON-GEORGIA TOWN LINE AND EXTENDING NORTHERLY 0.985 MILES EXCLUDING A CENTER SECTION OF 0.502 MILE

BEGINNING AT THE JUNCTION WITH U.S. ROUTE 7, NORTH OF THE MILTON-GEORGIA TOWN LINE AND EXTENDING EASTERLY 0.284 MILE

LENGTH OF CONTRACT 4051.75 FEET • 0.767 MILE

| FILE NO. | STATE | PROJECT NO. | SHEET NO. | TOTAL SHEETS |
|----------|-------|-------------|-----------|--------------|
| 1 | VT | | 1 | 1 |

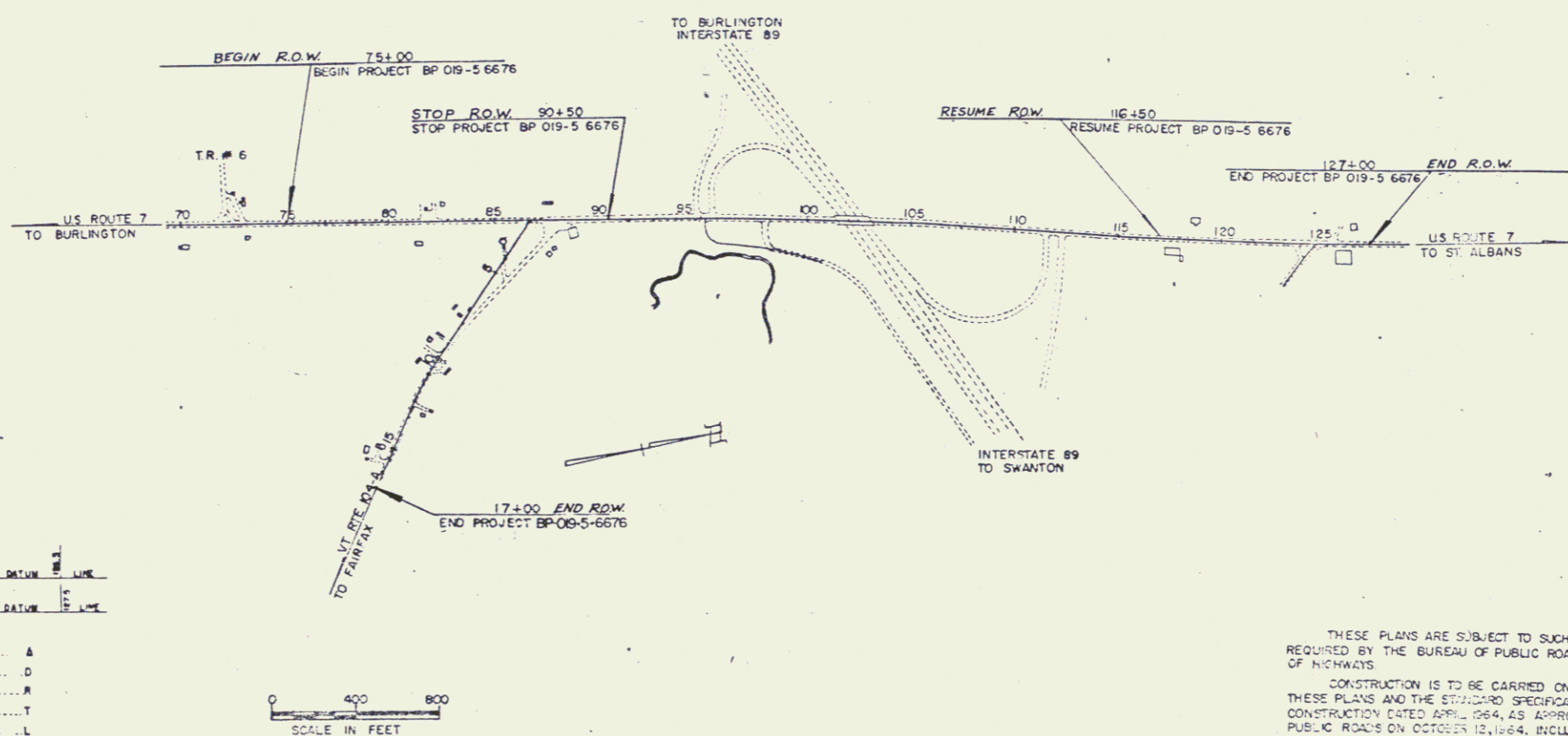
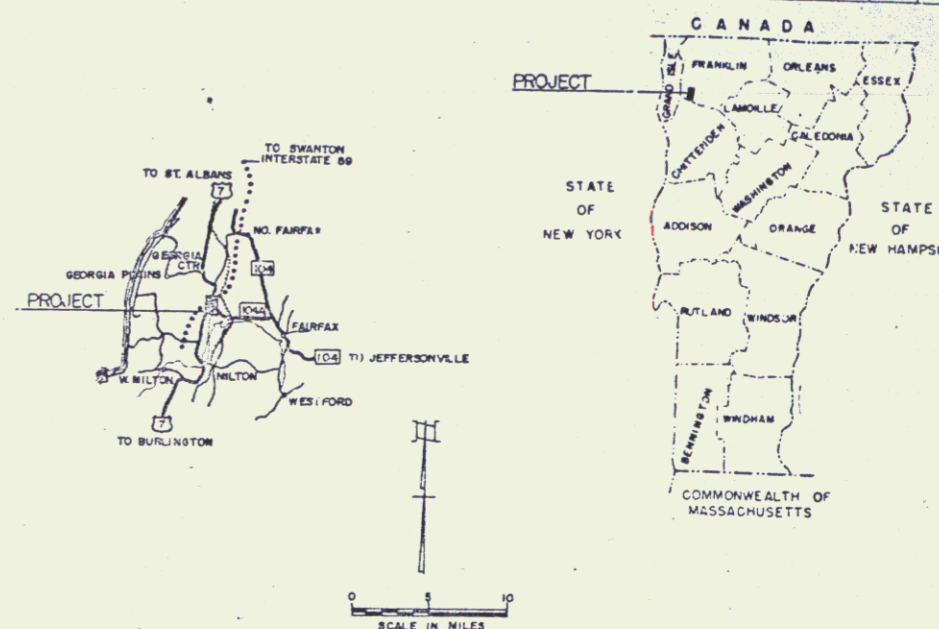

CONVENTIONAL SIGNS

| | |
|-------------------|-------|
| COUNTY LINE | --- |
| TOWN LINE | ---- |
| FENCE LINE | ----- |
| STONE WALL | ----- |
| UNFENCED PROPERTY | ----- |
| TO RAIL | ----- |
| ELED WAY | ----- |
| RAILROAD | ----- |
| RETAINING WALL | ----- |
| ER LINE | ----- |
| ZY LINE | ----- |
| CULVERT | ----- |
| DROP INLET | ----- |
| TROLLEY POLE | ----- |
| POWER POLE | ----- |
| TELEPHONE POLE | ----- |
| TREES | ----- |
| HEDGE | ----- |

CURVE DATA

| | | |
|-----------------------|-------|-----|
| DEFLECTION OF ANGLE | | A |
| DEGREE OF CURVE | | D |
| RADIUS OF CURVE | | R |
| TANGENT DISTANCE | | T |
| LENGTH OF CURVE | | L |
| EXTERNAL DISTANCE | | E |
| POINT OF INTERSECTION | | PI |
| POINT OF CURVE | | PC |
| POINT OF TANGENT | | PT |
| POINT ON TANGENT | | POT |
| POINT ON SUB-TANGENT | | PST |

THESE PLANS ARE SUBJECT TO SUCH REVISIONS AS MAY BE REQUIRED BY THE BUREAU OF PUBLIC ROADS OR THE COMMISSIONER OF HIGHWAYS.
CONSTRUCTION IS TO BE CARRIED ON IN ACCORDANCE WITH THESE PLANS AND THE STANDARD SPECIFICATIONS FOR HIGHWAY AND BRIDGE CONSTRUCTION DATED APRIL 1964, AS APPROVED BY THE BUREAU OF PUBLIC ROADS ON OCTOBER 12, 1964, INCLUDING ALL SUBSEQUENT APPROVED REVISIONS AND SUCH REVISED SPECIFICATIONS AND SPECIAL PROVISIONS AS ARE INCORPORATED IN THESE PLANS.

DEPARTMENT OF COMMERCE
BUREAU OF PUBLIC ROADS

APPROVED _____
DIVISION ENGINEER

PROJECT BP NO. 019-5-6676

SHEET 1 OF 13 SHEETS

| | | | | | |
|--|--|--|---|--|--|
| APPROVED <i>E. J. Doherty</i> ASST. CHIEF ENGINEER DATE 7/6/66 | APPROVED <i>R. L. French</i> CONSTRUCTION ENGINEER DATE 7/7/66 | APPROVED <i>N. P. Lang</i> DIRECTOR RIGHT-OF-WAY DATE 11-29-66 | APPROVED <i>R. M. Blanchard</i> DISTRICT ENGINEER DATE 7/6/66 | APPROVED <i>G. M. D. Dore</i> HIGHWAY ENGINEER DATE 7/6/66 | APPROVED <i>R. H. Currier</i> CHIEF ENGINEER DATE 7/8/66 |
|--|--|--|---|--|--|

TYPICAL SECTIONS

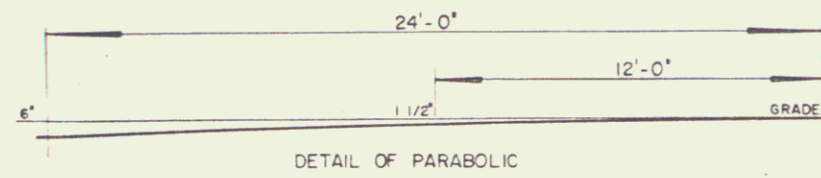

2 1/2" BITUMINOUS CONCRETE PAVEMENT, ITEM 361 MOD. (± 1/4" FOR TOTAL THICKNESS) 1 1/4" WEARING COURSE TYPE III
 3" CRUSHED GRAVEL OR CRUSHED STONE PLANT MIXED BASE COURSE, ITEM 213 (± 1/2")
 24" SUB-BASE OF CRUSHED ROCK, ITEM 204 (± 1")
 3" CRUSHED STONE SHOULDERS, ITEM 303 WITH TACK COAT TYPE III, ITEM 315 MOD.
 SUB-BASE OF GRAVEL, ITEM 201 MOD.
 24" SUB-BASE OF SAND, ITEM 202 (± 1") IN CUT] TO BE PLACED AS NOTED ON THE PLANS
 12" GRANULAR BORROW, ITEM 105 (± 1") IN FILL] OR AS DIRECTED BY THE ENGINEER.
 PERMISSIBLE TOLERANCES IN PARENTHESES
 APPLY TO THICKNESS ONLY.

GENERAL NOTES

FOR ROUNDING OF SLOPES, SEE STANDARD SHEET B-5
 STEEL MARKER POSTS, ITEM 547-D TO BE PLACED AS DIRECTED BY THE ENGINEER
 MULCH, ITEM 622, TO BE PLACED ON ALL EARTH SLOPES AT THE RATE OF 2 TONS PER ACRE.

THE FERTILIZER, ITEM 615, SHALL BE MIXED AS FOLLOWS:

| NITROGEN | 10% | | | |
|---|----------|----------------------------|----------|--------|
| PHOSPHORUS | 20% | | | |
| POTASH | 10% | | | |
| THE FERTILIZER SHALL BE DELIVERED IN BAGS OF NOT TO EXCEED 100 LBS EACH AND IS TO BE APPLIED AT THE RATE OF 500 LBS PER ACRE. | | | | |
| SEEDING, ITEM 611 | | | | |
| % | LBS/ACRE | NAME | PURITY % | GERM % |
| 33.33 | 20 | CREeping RED FESCUE | 97 | 82 |
| 10.00 | 8 | TALL FESCUE | 95 | 80 |
| 16.67 | 10 | KENTUCKY BLUE GRASS | 85 | 75 |
| 8.33 | 5 | RED TOP | 92 | 90 |
| 16.67 | 0 | DOMESTIC RYE GRASS | 98 | 90 |
| 8.33 | 5 | BIRDFOOT TREFLOIL (EMPIRE) | 99 | 80 |
| 0.42 | 1/4 | WEED SEED | | |
| 6.25 | 3.34 | INERT MATERIAL | | |
| 100.00 | 60 | LBS PER ACRE | | |

50 LBS OF WINTER RYE PER ACRE TO BE USED IN ADDITION TO THE ABOVE SEEDING FORMULA IF DIRECTED BY THE ENGINEER.

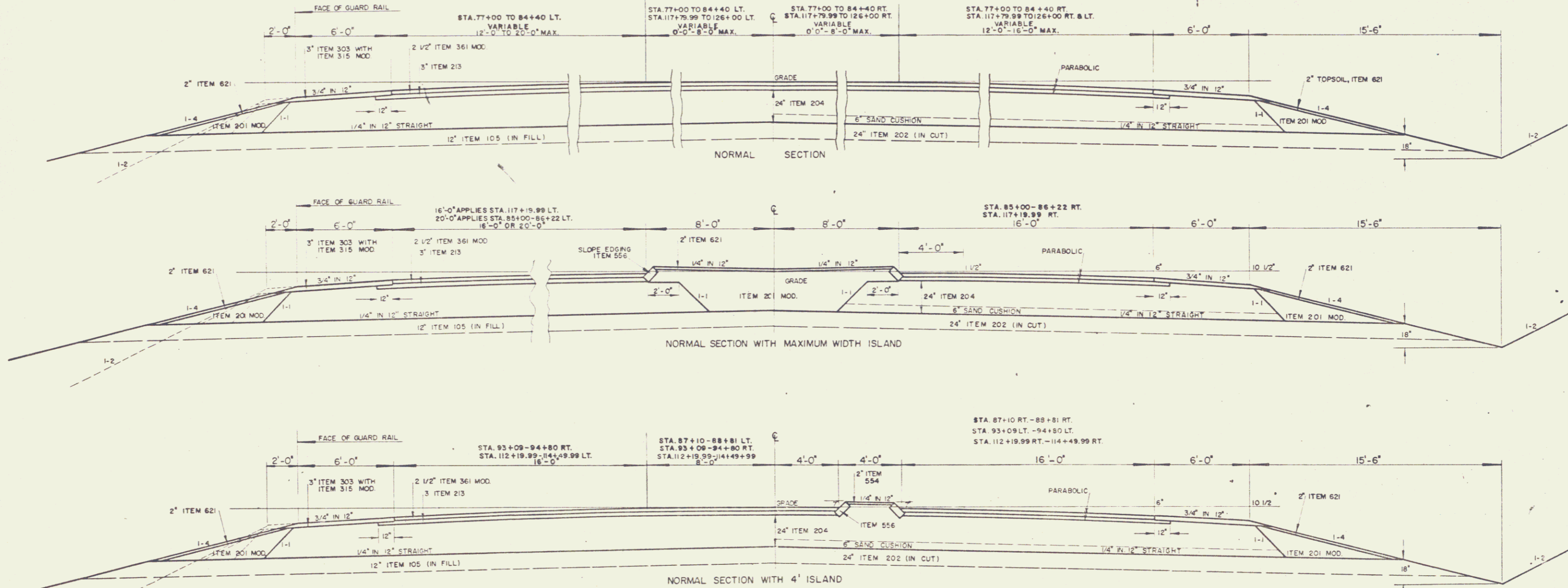

GEORGIA U.S. ROUTE 7
 SURVEYED BY: R.G. DATE: 5/66
 DRAWN BY: R.G. DATE: 5/66
 TRACED BY: A.J.A. DATE: 5/66
 PROJ. BP NO. 019-5-6676
 SHEET 3 OF 3
 0-7

TYPICAL SECTIONS

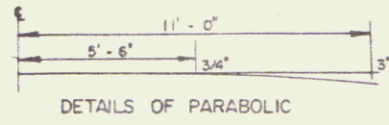

- 2 1/2" BITUMINOUS CONCRETE PAVEMENT, ITEM 361 MOD. (1/4" FOR TOTAL THICKNESS) 1/4" WEARING COURSE, TYPE III
- 3" CRUSHED GRAVEL OR CRUSHED STONE PLANT MIXED BASE COURSE, ITEM 213 (± 1/2")
- 18" SUB-BASE OF CRUSHED ROCK, ITEM 204 (± 1")
- 3" CRUSHED STONE SHOULDERS, ITEM 303 WITH TACK COAT TYPE III, ITEM 315 MOD.
- SUB-BASE OF GRAVEL, ITEM 201 MOD.
- 12" GRANULAR BORROW, ITEM 105 (± 1") IN FILL } TO BE PLACED AS NOTED ON THE PLANS OR AS DIRECTED BY THE ENGINEER.
- 24" SUB-BASE OF SAND, ITEM 202 (± 1") IN CUT }

PERMISSIBLE TOLERANCES IN PARENTHESIS APPLY TO THICKNESS ONLY.

SEEDING, ITEM 61
THE SEED MIXTURE SHALL BE COMPOSED AS FOLLOWS:

| % | LBS/ACRE | NAME | PURITY % | GERM % |
|--------|----------|---------------------------|----------|--------|
| 33.33 | 20 | CREeping RED FESCUE | 97 | 82 |
| 10.00 | 6 | TALL FESCUE | 95 | 80 |
| 16.67 | 10 | KENTUCKY BLUE GRASS | 85 | 75 |
| 8.33 | 5 | RED TOP | 92 | 90 |
| 16.67 | 10 | DOMESTIC RYE GRASS | 98 | 80 |
| 8.33 | 5 | BIRDFOOT TREFLOIL (EMPRE) | 99 | 80 |
| 0.42 | 1/4 | WEED SEED | | |
| 8.25 | 3/4 | INERT MATERIAL | | |
| 100.00 | 60 | LBS PER ACRE | | |

THE FERTILIZER ITEM 615 SHALL BE MIXED AS FOLLOWS:

| NITROGEN | PHOSPHORUS | POTASH | RATE OF APPLICATION |
|----------|------------|--------|---------------------|
| 10 % | 20 % | 10 % | 500 LBS PER ACRE. |

FERTILIZER SHALL BE DELIVERED IN BAGS OF NOT MORE THAN 100 LBS. EA.
50 LBS. OF WINTER RYE PER ACRE TO BE APPLIED TO THIS MIXTURE IF DIRECTED BY THE ENGINEER.
MULCH, ITEM 622 TO BE PLACED ON ALL EARTH SLOPES AT THE RATE OF 2 TONS PER ACRE.
STEEL MARKER POSTS, ITEM 547-D TO BE PLACED AS DIRECTED BY THE ENGINEER FOR ROUNDING OF SLOPES, SEE SHEET B-5.

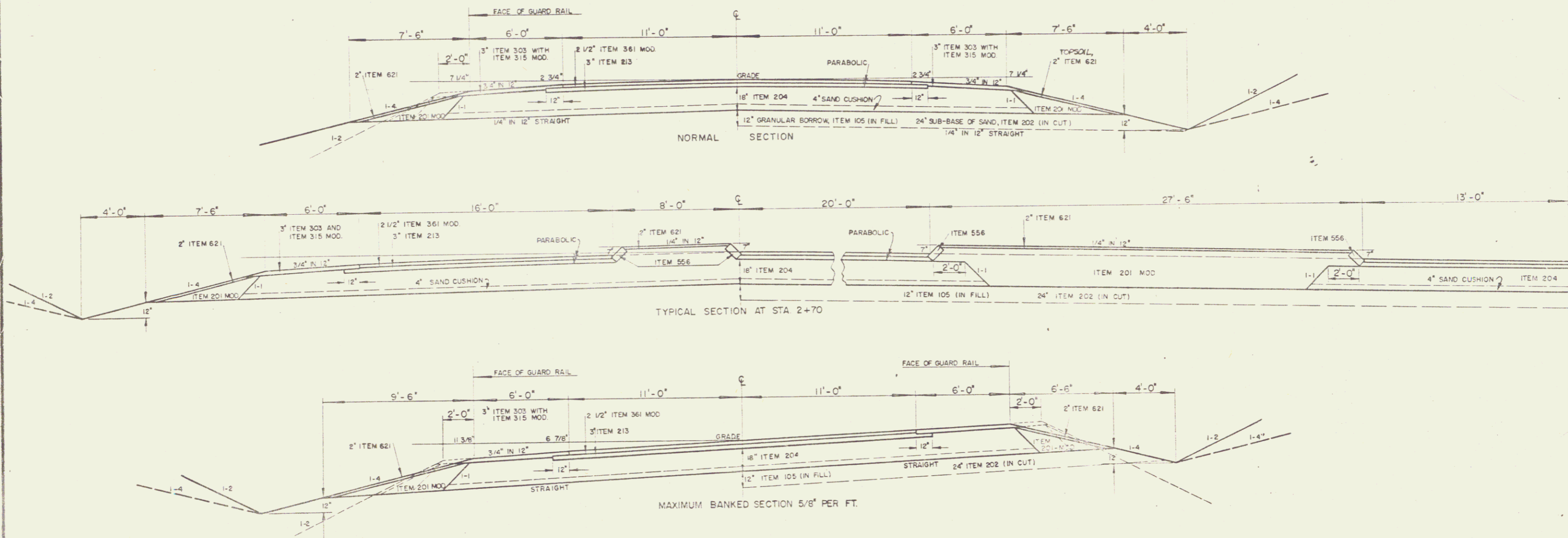

GEORGIA VT. 104-A

SURVEYED BY: R.G. DATE: 5/28/66
 DRAWN BY: R.G. DATE: 5/28/66
 TRACED BY: A.J. DATE: 5/28/66

PROJ. BP. NO. 019-5-6676
 SHEET 3 OF 13

0-7

13

STATE OF VERMONT
DEPARTMENT OF HIGHWAYS
RIGHT-OF-WAY PLANS
DETAIL SHEET

1 OF 3

TABLE OF PROJECT PROPERTY ACQUISITION

| PARCEL NO. | GRANTOR | SHEET NO. | BEGINNING STATION | ENDING STATION | TAKING | REM | RIGHTS | TITLE TAKEN | DATE | TOWN OR CITY RECORDED | BK | PG | REMARKS | |
|------------|--|-----------|--|----------------------|--------|-------|-----------------------------|----------------|-----------------|-----------------------|----|----|--------------------------------|--|
| 1 | LAIMAN, ALFRED L & DOROTHY A. (H&W) | 8 | 75+00 RT 77+31 RT | 77+48 RT | 0.55A | 1445A | | | | | | | SIGN | |
| 2A | BLAKE, GEORGE E & YVONNE M. (H&W) | 8 9410 | 75+00 LT | 77+52 LT | 0.30A | 185A | | | | | | | HOUSE, GARAGE, and Well | |
| 2B | | | 84+28 RT | 90+00 RT | 2.03A | 8+7A | | | | | | | | |
| | | | 380+11.10A | | | | | | | | | | | |
| | | | 87+80 RT | | | | | | DRIVE (T) | | | | | |
| | | | 87+67 RT | | | | | | DRIVE (T) | | | | | |
| | | | 88+34 RT | | | | | | DRAINAGE (P) | | | | | |
| | | | 88+44 RT | 90+92 RT | | | | | DRAINAGE (P) | | | | | |
| | | | 89+70 RT | | | | | | SLOPE (T) 3000' | | | | | |
| | 90+50 RT | 91+00 RT | | | | | DRIVE (T) | | | | | | | |
| | 88+93 LT | 89+64 LT | | | | | DITCH & DRAINAGE (P) | | | | | | | |
| | 88+83 RT | 89+00 RT | | | | | SLOPE (T) 80' | | | | | | | |
| | | | | | | | Easement to Remove gas Amps | | | | | | | |
| 3 | FAIRBANKS, RAEBURN M & FLORA E. (H&W) | 819 | 77+52 LT 79+50 LT 82+00 LT 77+80 LT | 84+46 LT 84+00 LT | 0.80A | 127A | | | | | | | SIGN | |
| 4 | GAUDETTE, ETHEL I | 819 | 77+34 RT 77+34 RT | 81+00 RT 81+00 RT | 0.4A | | | | | | | | SLOPE (T) 500' | |
| 5A | GAUDETTE, VERNON L. & SHIRLEY J. (H&W) | 9 | 81+00 RT | 84+38 RT | 0.5A | 55A | | | | | | | SLOPE (T) 500' | |
| | | | 81+00 RT 81+08 RT | 81+35 RT | | | | | DRIVE (T) | | | | | |
| 5B | | 10 | 8+51 RT 8+51 RT 10+00 RT 12+04 RT | 12+58 RT 12+58 RT | 0.3A | 57A | | | | | | | SLOPE (T) 4140' | |
| | | | | | | | | DRIVE (T) | | | | | CULVERT & DRAINAGE (P) | |
| 6 | TURNER, AGUSTUS R. | 9 | 84+46 LT 87+00 LT 87+88 LT 86+90 LT 85+20 LT | 88+93 LT 88+93 LT | 0.6A | 21A | | | | | | | DRIVE (T) | |
| | | | | | | | | SLOPE (T) 400' | | | | | Easement to Remove septic tank | |
| | | | | | | | | DRIVE (T) | | | | | Septic Tank & Leach Field | |

TABLE OF REVISIONS

| REVISION NO. | SHEET NO. | DESCRIPTION OF REVISION | DATE | MADE BY | APPROVED BY |
|--------------|-----------|-------------------------|------|---------|-------------|
| | | | | | |
| | | | | | |
| | | | | | |
| | | | | | |
| | | | | | |

MADE BY C.E.L. DATE 11-23-66
CHECKED BY R.D.H. & A.M.S. DATE 11-23-66

----- PRESENT R.O.W.
--- -- -- TAKING WITHOUT ACCESS
--- P --- TAKING WITHOUT ACCESS ALONG PROPERTY LINES
--- L --- TAKING WITH ACCESS
(P) PERMANENT EASEMENT
(T) TEMPORARY EASEMENT

LEGEND
SR SR SLOPE RIGHTS
P P PROPERTY LINE
-Δ-Δ-Δ- TOP OF CUT
O O O T.O.E. OF SLOPE

APPROVED Thomas C. Brambley DATE 11-28-66
CHIEF OF ACQUISITION
APPROVED London M. Lane DATE 11/29/66
HIGHWAY ENGINEER
APPROVED W. J. ... DATE 11-29-66
PROJECT DIRECTOR

PROJECT GEORGIA
NO. BP-019-5-6676
SHEET 2 OF 13

STATE OF VERMONT
DEPARTMENT OF HIGHWAYS
RIGHT-OF-WAY PLANS
DETAIL SHEET
2 OF 3

TABLE OF PROJECT PROPERTY ACQUISITION

| PARCEL NO | GRANTOR | SHEET NO | BEGINNING STATION | ENDING STATION | TAKING | REM | RIGHTS | TITLE TAKEN | DATE | TOWN OR CITY RECORDED | BK. | PG. | REMARKS |
|-----------|---|----------|---|--|--------|--------------|---|-------------|------|-----------------------|-----|-----|-----------|
| 7 | KING, KATHLEEN L. | 9 | 89+64 LT 89+87 LT | 90+00 LT | 1200± | 026A± | DRIVE (T) | | | | | | |
| 8A | BLAKE, EDWARD M. & ETHEL C. (H&W) | 9 | 90+92 RT 90+97 RT | 92+34 RT | | 145A± | SLOPE (T) 2170± DRAINAGE (P) | | | | | | |
| 8B | | 10+13 | 7+25 LT 7+25 LT 10+75 LT 8+50 LT | 10+85 LT 10+85 LT | | 018A± 213A± | SLOPE (T) 1300± DRIVE (T) CULVERT & DRAINAGE (P) | | | | | | |
| 8C | | 10+13 | 11+36 LT 11+36 LT 11+60 LT | 11+98 LT 11+82 LT | | 004A± | SLOPE (T) 400± CULVERT & DRAINAGE (P) | | | | | | |
| 9 | DUSSAULT, HARRIET P. | 11 | 117+90 LT 118+09 RT 116+50 RT 118+15 118+20 LT 125+37 LT 118+25 LT 119+50 RT | 121+25 LT 118+45 RT 117+15 RT | | | SLOPE (T) 4800± SLOPE (T) 120± SLOPE (T) 975± WATER PIPE (P) DRIVE (T) DRIVE (T) DITCHING & DRAINAGE (P) DITCHING & DRAINAGE (P) | | | | | | R.T. & I. |
| 10 | BRUSO, FREDRICK C. & MARGARET B. (H&W) | 11 | 122+72 RT 124+50 RT 125+37 LT 125+64 LT 125+64 LT 126+14 LT 126+34 RT 126+50 | 127+00 RT & I 126+92 LT 126+06 LT 126+38 LT | | 005A± 8495A± | DRAINAGE (P) DRIVE (T) SLOPE (T) 160± SLOPE (T) 50± DRIVE (T) WATER PIPE (P) | | | | | | R.T. & I. |

TABLE OF REVISIONS

| REVISION NO. | SHEET NO. | DESCRIPTION OF REVISION | DATE | MADE BY | APPROVED BY |
|--------------|-----------|-------------------------|------|---------|-------------|
| | | | | | |
| | | | | | |
| | | | | | |
| | | | | | |
| | | | | | |

MADE BY C.F.L. DATE 11-23-66
CHECKED BY B.D.H. & A.M.S. DATE 11-23-66

PRESENT R.O.W.
 --- TAKING WITHOUT ACCESS
 --- TAKING WITHOUT ACCESS ALONG PROPERTY LINES
 --- TAKING WITH ACCESS
 (P) PERMANENT EASEMENT
 (T) TEMPORARY EASEMENT

LEGEND
 SR SR SLOPE RIGHTS
 L L PROPERTY LINE
 Δ Δ TOP OF CUT
 O O TOE OF SLOPE

APPROVED Thomas C. Pennington DATE 11-28-66
CHIEF OF ACQUISITION
 APPROVED Robert M. Lane DATE 11/29/66
HIGHWAY ENGINEER
 APPROVED H.P. Johnson DATE 11-29-66
STATE ENGINEER

PROJECT GEORGIA
 NO. BP-019-5-6676
 SHEET 9 OF 13

STATE OF VERMONT
DEPARTMENT OF HIGHWAYS
RIGHT-OF-WAY PLANS

DETAIL SHEET

3 OF 3

TABLE OF PROJECT PROPERTY ACQUISITION

| PARCEL NO. | GRANTOR | SHEET NO. | BEGINNING STATION | ENDING STATION | TAKING | REM | RIGHTS | TITLE TAKEN | DATE | TOWN OR CITY RECORDED | BK. | PG. | REMARKS |
|------------|--|----------------|--|---------------------------------|--------|--------|--|-------------|------|-----------------------|-----|-----|-----------------------|
| 11 | WHITTEMORE, ELIZABETH M., A/K/A EVELYN M. WHITTEMORE | 10 | 4+85 RT 5+00 RT 7+75 RT 7+75 RT | 8+60 LT 8+51 RT | 0.48A | 0.47A | SLOPE (T) 1300 [±] PT TO REMOVE GARAGE DRIVE (T) | | | | | | HOUSE & GARAGE & WELL |
| 12 | CHARBONNEAU, CHARLES F. & JEANNETTE B. (H&W) | 10 | 10+85 LT 10+85 LT 11+00 LT | 11+36 LT 11+36 LT | 2.80 | 0.12A | SLOPE (T) 600 [±] DRIVE (T) | | | | | | |
| 13 | AIERS, WAYNE & SMITH, MARION C. | 10 | 11+82 LT 11+70 LT 12+59 LT 12+04 LT 12+59 LT | 13+59 LT 13+00 LT | 0.10A | 0.80A | SLOPE (T) 600 [±] DRIVE (T) CULVERT DRAINAGE (P) CULVERT & DRAINAGE (P) | | | | | | |
| 14 | LAPAN, DOROTHY C & BOVAT, ETHEL C. | 10/12 | 12+47 R 12+47 RT 13+20 RT 15+80 RT 14+50 RT 16+48 E | 17+00 R 17+90 RT 14+50 RT | 0.35A | 4.165A | SLOPE (T) 2600 [±] SPECIAL DITCH DRIVE (T) CULVERT & (P) DRAINAGE (P) WATER PIPE (P) | | | | | | R. T. & I. |
| 15 | TOWN OF GEORGIA | B. 9. 10/11 | 75+00 116+50 2+00 | 90+50 127+00 17+00 | | | ALL RT & I. US [±] ALL RT & I. US [±] ALL RT & I. VT 104-A | | | | | | |
| | RELINQUISHMENT # 1 OF VT 104-A TO Town of Georgia | 9/10 | 88+45 | 7+25 | | | | | | | | | |

TABLE OF REVISIONS

| REVISION NO. | SHEET NO. | DESCRIPTION OF REVISION | DATE | MADE BY | APPROVED BY |
|--------------|-----------|-------------------------|------|---------|-------------|
| | | | | | |

MADE BY C.E.L. DATE 11-23-66
CHECKED BY B.D.H. & A.M.S. DATE 11-23-66

PRESENT R.O.W.

--- TAKING WITHOUT ACCESS
--- P --- TAKING WITHOUT ACCESS ALONG PROPERTY LINES
--- TAKING WITH ACCESS
(P) PERMANENT EASEMENT
(T) TEMPORARY EASEMENT

LEGEND

SR SR SLOPE RIGHTS
P P PROPERTY LINE
-Δ-Δ-Δ- TOP OF CUT
-O-O-O- TOE OF SLOPE

APPROVED: Thomas C. Rematchy DATE 11-28-66
CHIEF OF ACQUISITION
APPROVED: Gordon W. Stone DATE 11/29/66
HIGHWAY ENGINEER
APPROVED: H.P. [Signature] DATE 11-29-66
DISTRICT DIRECTOR

PROJECT GEORGIA
NO. BP-019-5-6676
SHEET 6 OF 13

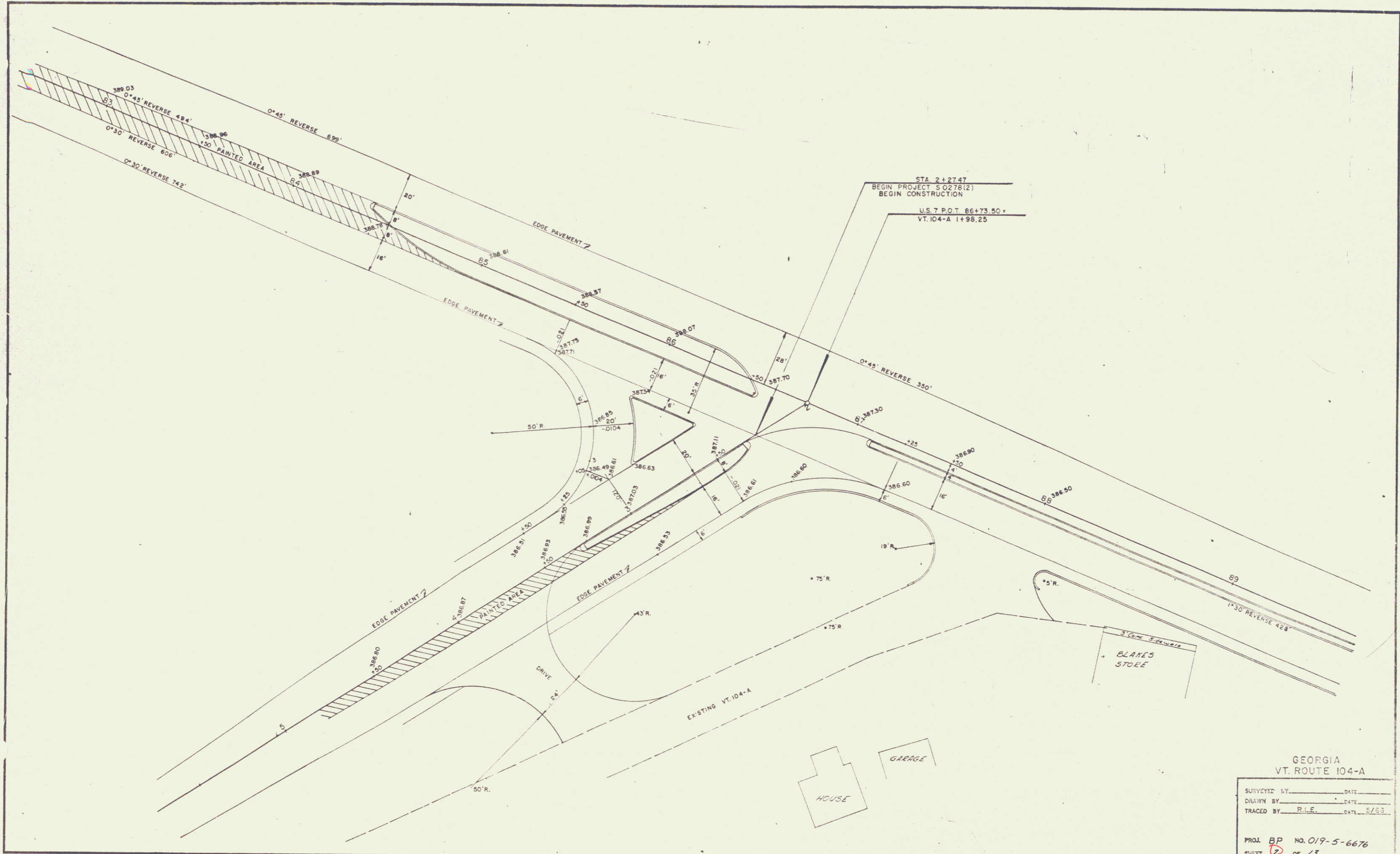

STA 2+27.47
 BEGIN PROJECT S 0278(2)
 BEGIN CONSTRUCTION
 U.S. 7 P.O.T. 86+73.50+
 VT. 104-A 1+98.25

GEORGIA
 VT. ROUTE 104-A

| | |
|-------------|-----------|
| SURVEYED BY | DATE |
| DRAWN BY | DATE |
| TRACED BY | DATE 5/83 |

PROJ. BP NO. 019-5-6676
 SHEET 13 OF 13
 D-7

PLAN
 DRAWN BY: [unclear]
 CHECKED BY: [unclear]
 DATE: 07/11/13

PROFILE
 DRAWN BY: [unclear]
 CHECKED BY: [unclear]
 DATE: 07/11/13

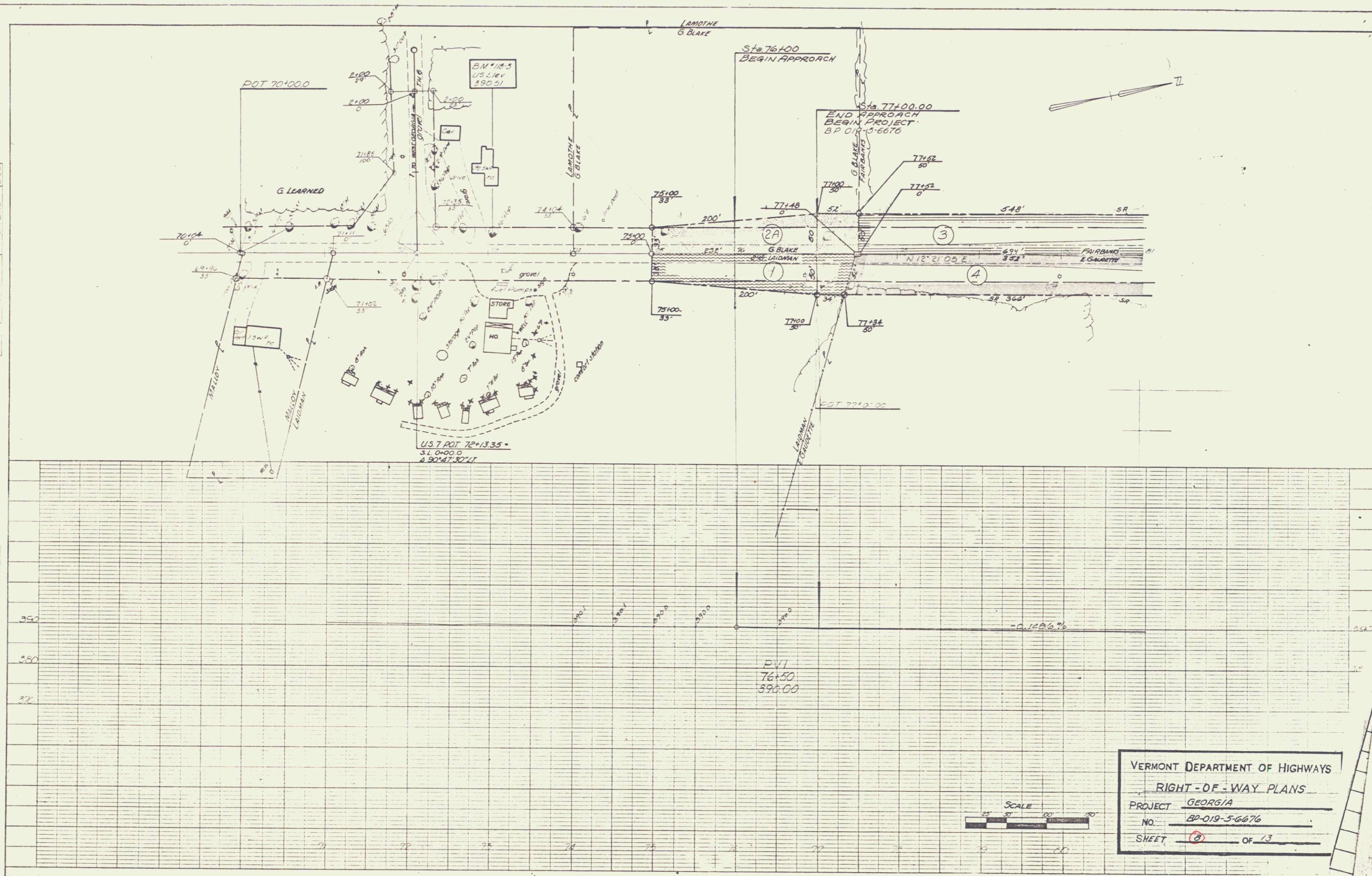

VERMONT DEPARTMENT OF HIGHWAYS
 RIGHT-OF-WAY PLANS
 PROJECT GEORGIA
 NO. BD-019-5-6676
 SHEET 18 OF 13

PLAN
 TRANSFERRED FROM SHEET 8 OF 13
 NOTE: WORK TO BE DONE BY CONTRACTOR

PROFILE
 CHECKED BY []
 DATE []
 DRAWN BY []
 DATE []

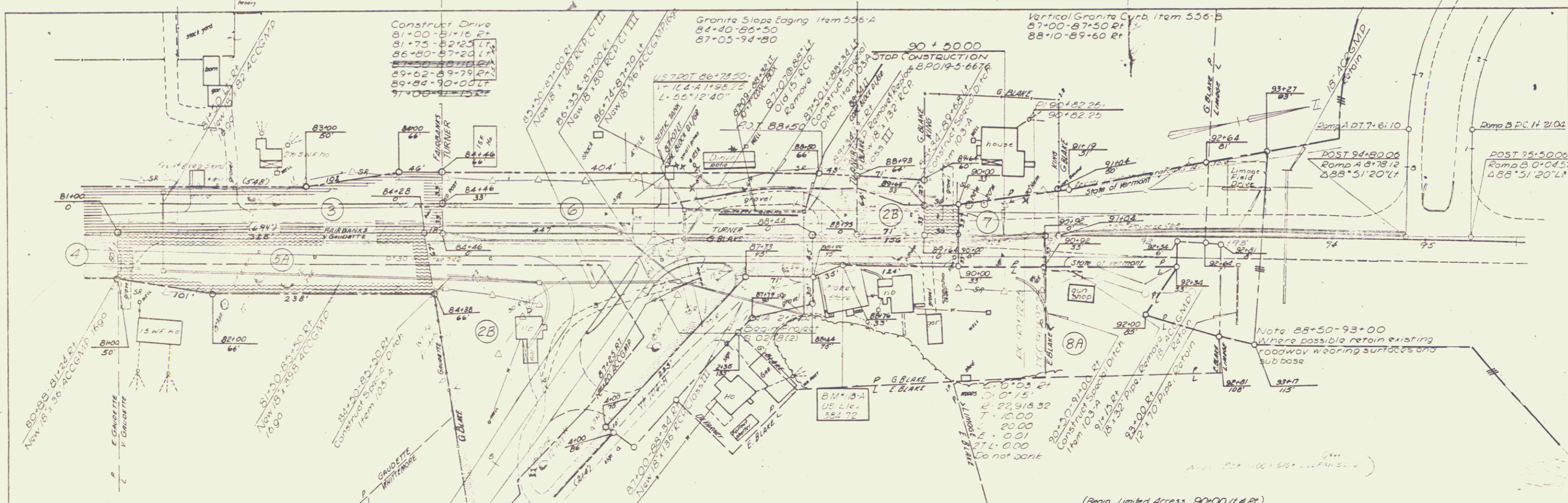

VERMONT DEPARTMENT OF HIGHWAYS
 RIGHT-OF-WAY PLANS
 PROJECT GEORGIA
 No. BPO19-5-6676
 SHEET 9 OF 13

PLAN
 DRAWN BY: [Name]
 CHECKED BY: [Name]
 DATE: 8/27/68
 NO. 177 OF 178

PROFILE
 DRAWN BY: [Name]
 CHECKED BY: [Name]
 DATE: 8/27/68
 NO. 177 OF 178

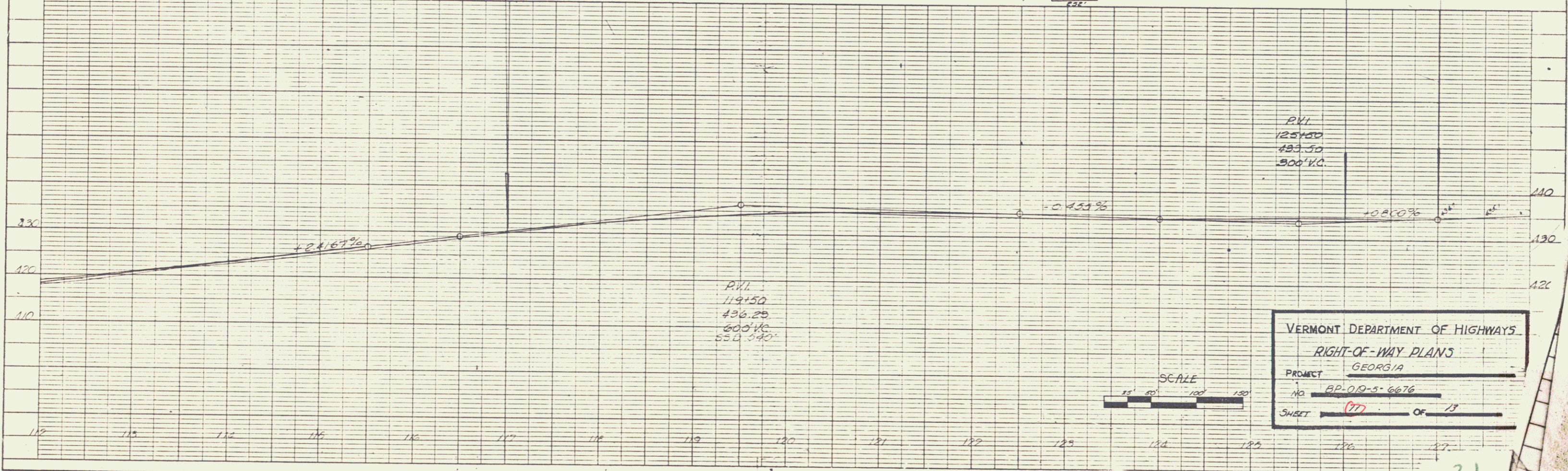
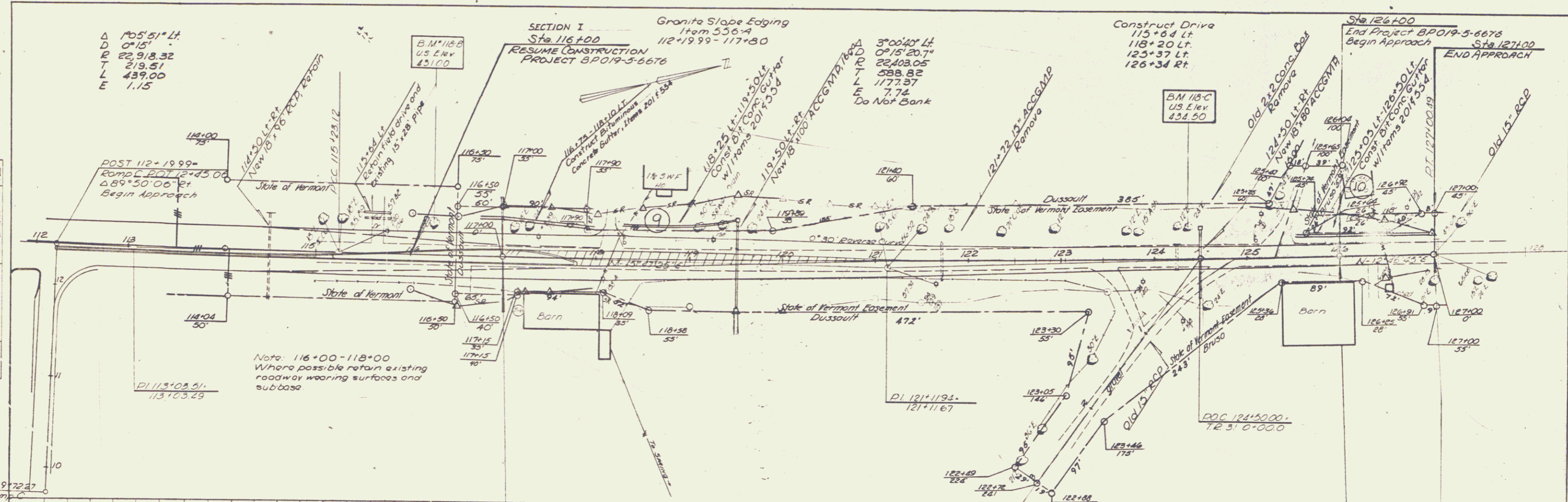

VERMONT DEPARTMENT OF HIGHWAYS
 RIGHT-OF-WAY PLANS
 PROJECT GEORGIA
 NO. 8P-019-5-6676
 SHEET 177 OF 178