

PLAN
 DRAWN BY: [Name]
 CHECKED BY: [Name]
 DATE: 8/27/68
 NO. 177 OF 178

PROFILE
 DRAWN BY: [Name]
 CHECKED BY: [Name]
 DATE: 8/27/68
 NO. 177 OF 178

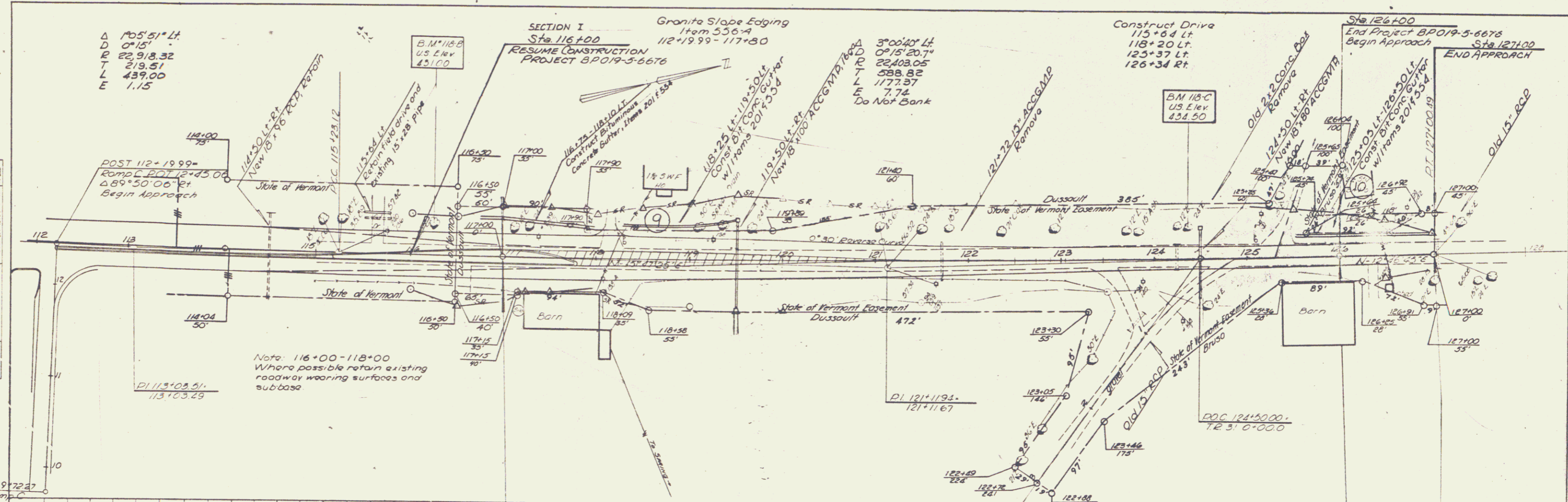

Δ 105°51' Lt.
 D 0°15'
 R 22,918.32
 T 219.51
 E 439.00
 L 1.15

SECTION I
 Sta 116+00
 RESUME CONSTRUCTION
 PROJECT 8P019-5-6676

Construct Drive
 115+64 Lt.
 118+20 Lt.
 125+37 Lt.
 126+34 Rt.

Sta 126+00
 End Project 8P019-5-6676
 Begin Approach
 Sta 127+00
 END APPROACH

Note: 116+00-118+00
 Where possible retain existing
 roadway wearing surfaces and
 subbase

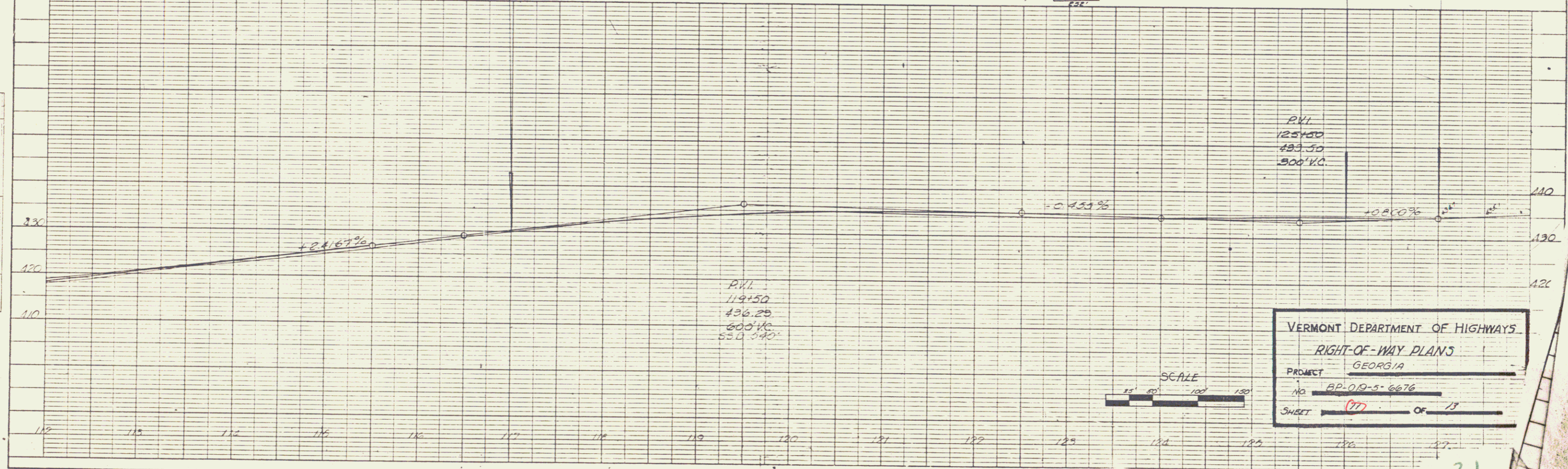

VERMONT DEPARTMENT OF HIGHWAYS
 RIGHT-OF-WAY PLANS
 PROJECT GEORGIA
 NO. 8P-019-5-6676
 SHEET 177 OF 178