

Raeburn M & Flora E Fairbanks  
Parcel No 3

Taking 0.3A±  
Remainder 12.7A±  
Scale 1"=100'

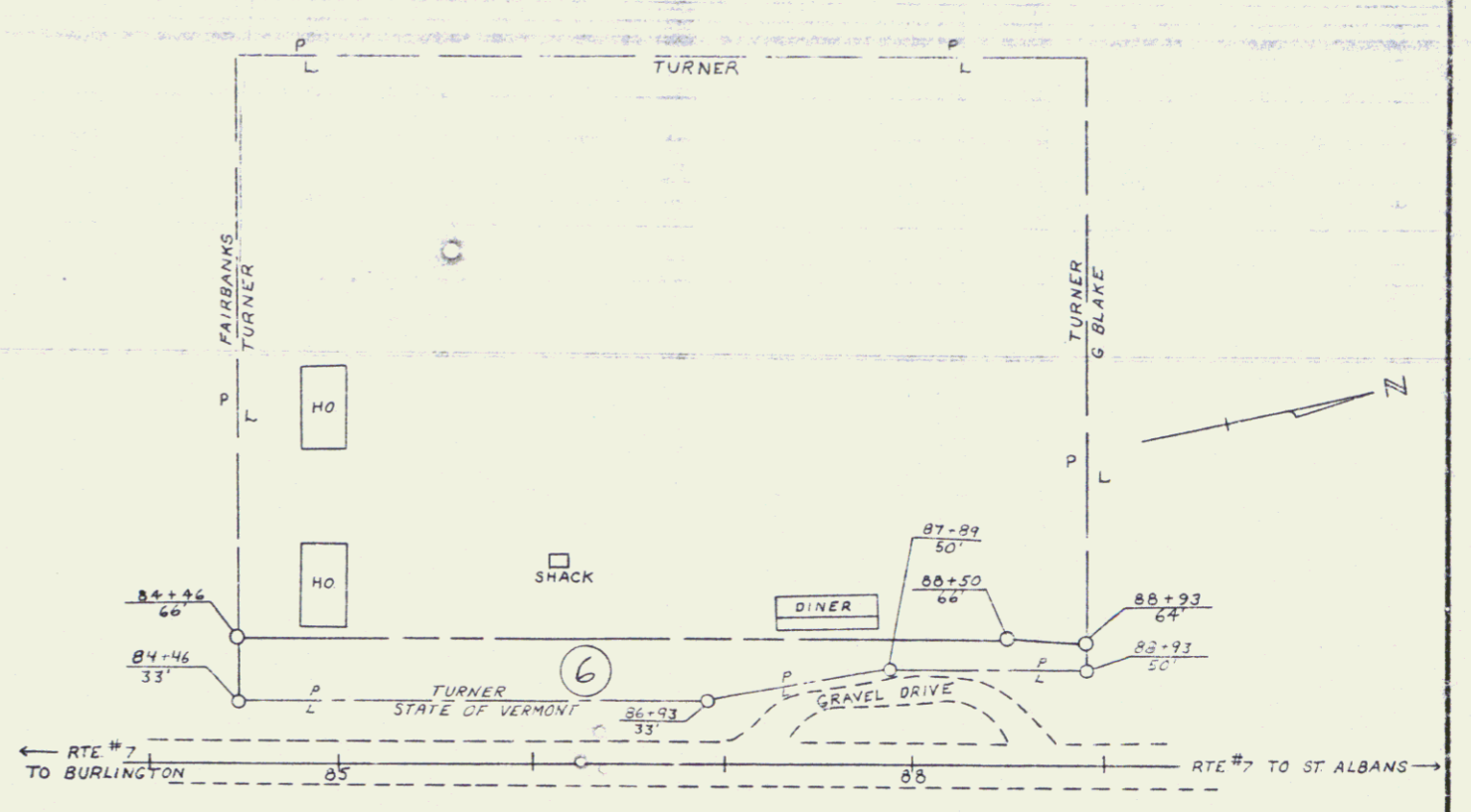
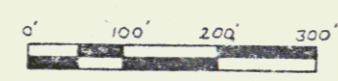

Augustus R Turner  
Parcel No 6

Taking 0.3A±  
Remainder 2.9A±  
Scale 1"=50'

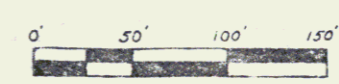

VERMONT DEPARTMENT OF HIGHWAYS  
RIGHT-OF-WAY PLANS  
GEORGIA  
BP-019-5-6676  
11 12