

- INDEX OF SHEETS
1. TITLE SHEET
  2. PLAN & PROFILE
  3. EXPANSION BEARING DETAILS
  4. TYPICAL SECTIONS & RAILING POST DETAILS
  5. SINGLE SEAL EXPANSION JOINT DETAILS
  6. THREE SEAL EXPANSION JOINT DETAILS
  7. REINFORCING SCHEDULE
  8. STD. SCB-D1-67, APR 29, 1970
  9. STD. SCB-DG-67, "
  10. STD. DB MAR 10, 1965
  11. STD. D10
  12. STD. D11
  13. STD. C1 FEB 10, 1969
  14. STD. E16 DEC. 18, 1964 R
  15. STD. E33 JAN. 9, 1967
  16. STD. E34 MAY 6, 1971 R

LIMITS OF STRUCTURE EXCAVATION, ITEM 103  
GRAVEL BACKFILL, ITEM 222-B

REMOVE EXIST. BACKWALL TO BEAM SEAT ELEV. 2. REBUILD AS SHOWN W/ CLASS B CONCRETE. (TYP. BOTH REINFORCEMENTS.)

REMOVAL OF EXISTING BACKWALL TO BE PAID FOR AS ITEM 376-A, REMOVAL OF PAVEMENT OR CONCRETE.

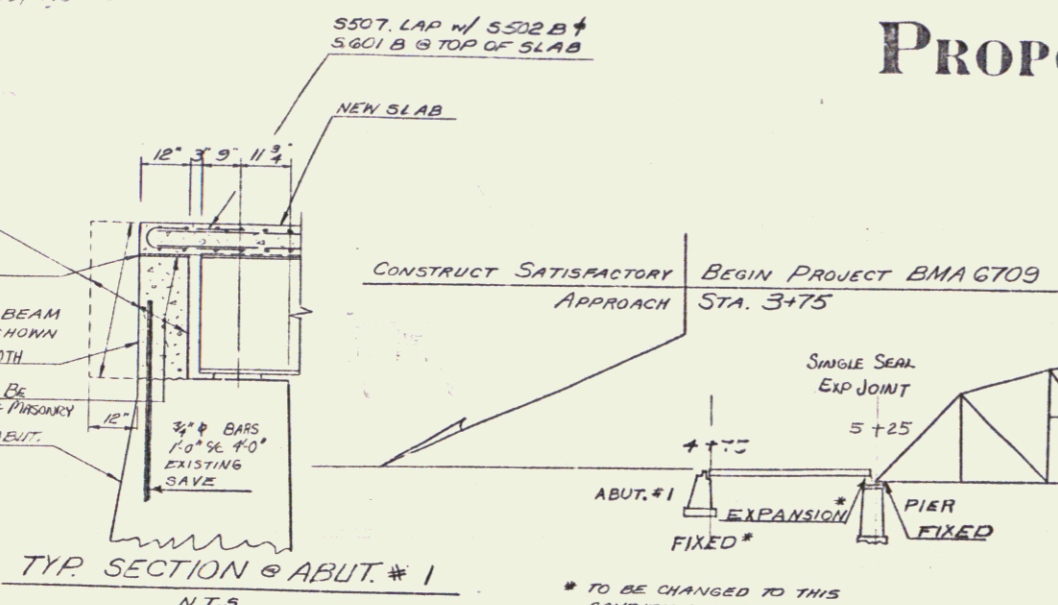

STATE OF VERMONT  
DEPARTMENT OF HIGHWAYS  
**PROPOSED IMPROVEMENT**

TOWN OF MILTON  
BMA-6216

2-992424

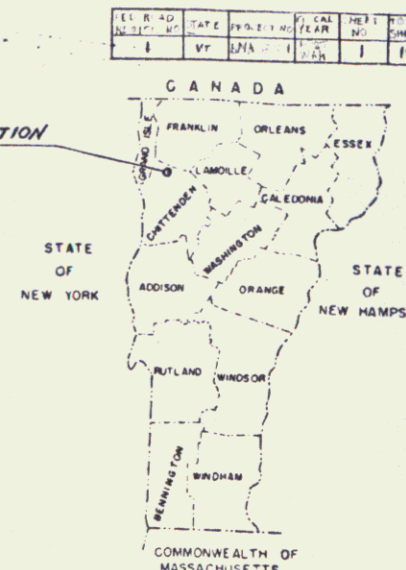
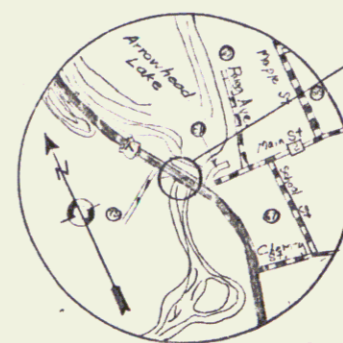

PROJECT DESCRIPTION

THE PROJECT SHALL CONSIST OF REMOVING & REPLACING CONCRETE DECK, SIDEWALK & CURBS, PLACING NEW BITUMINOUS CONCRETE PAVEMENT, REPLACING TRUSS EXPANSION BEARINGS, CLEANING & PAINTING ALL EXISTING STRUCTURAL STEEL, REPAIR OF ABUTMENTS AND REPAIRING EXPANSION JOINTS.

PROJECT LOCATION

IN THE VILLAGE OF MILTON, BEGINNING AT A POINT APPROXIMATELY 85 FEET NORTHERLY FROM THE INTERSECTION OF U.S. ROUTE 7 AND STATE ROAD 2 AND EXTENDING NORTH 4150 FEET ALONG U.S. ROUTE 7.

RECORD PLAN INFORMATION ON SHEET NO.

PARTIAL PROFILE OF BRIDGE  
SCALE 1"=30'-0"

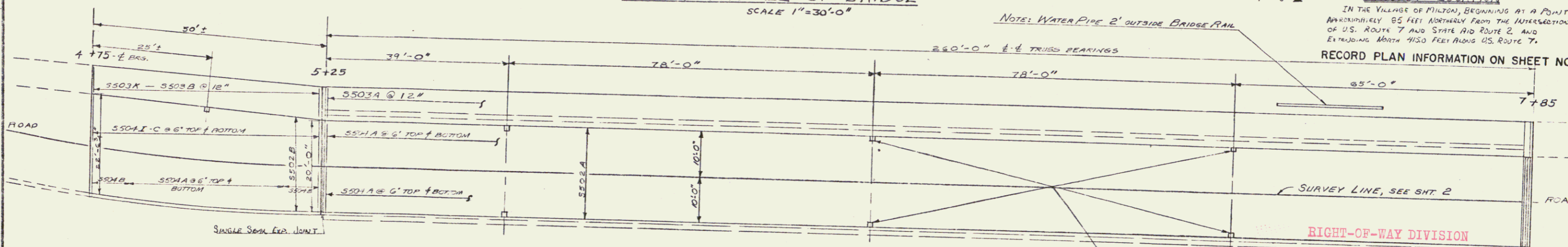

NOTE: TRANSVERSE REINFORCING STEEL TO BE PLACED PERPENDICULAR TO EXISTING BEAMS. SPACING AS REQ'D. @ ENDS OF APPROACH SPAN.

CONVENTIONAL SIGNS

- POINT OF ACCESS
- LIMITS OF ACCESS
- COUNTY LINE
- TOWN LINE
- FENCE LINE
- STONE WALL
- UNFENCED PROPERTY
- RAILROAD
- RETAINING WALL
- CENTER LINE
- SURVEY LINE
- CULVERT
- DROP INLET
- TROLLEY POLE
- POWER POLE
- TELEPHONE POLE
- TREES
- EDGE

MILTON BMA 6216  
CONST. BY PINEHILL ENG. BRIDGE CONST. CO., INC.  
RECORD PLANS - 1 AS SPIDLE  
CONST. COMPLETED - NOVEMBER 29, 1972.

ITEM #	ITEM	UNIT	EST. QUANTITY	FINAL QUANTITY
103-A1	COMMON EXCAVATION, CLASS I	C.Y.	40	22
401-AA	CONCRETE CLASS AA MODIFIED WITH ALBITHE	C.Y.	40	38
109	STRUCTURE EXCAVATION MOD.	C.Y.	20	21.4
101	MAINTENANCE OF TRAFFIC FOR BRIDGE PROJECTS	L.S.	1	1
201	SUB-BASE OF GRAVEL	C.Y.	30	34
222-B	GRAVEL BACKFILL FOR STRUCTURES	C.Y.	10	17
405-A	ELI TOMER MEMBRANE WATERPROOFING (LMB)	S.Y.	690	0
301-AA	BITUMINOUS CONCRETE PAVEMENT MODIFIED TYPE II	TONS	92	130
401-AA	CONCRETE CLASS AA MODIFIED	C.Y.	16.9	171.7
401-B	CONCRETE CLASS B MODIFIED	C.Y.	1R	11.6
402	REINFORCING STEEL MODIFIED	L.S.	65,760	66,372
404-B	STEEL SUPERSTRUCTURE (NON-BEARING 5620 x 1)	L.S.	1	1
414	REINFORCING MASONRY	S.Y.	10 (est)	14
434-A	ELASTOMERIC BRIDGE DECK EXPANSION JOINT (SINGLE SEAL)	L.F.	29	29
434-C	ELASTOMERIC BRIDGE DECK EXPANSION JOINT (THREE SEAL)	L.F.	29	28
440	WATER REPELLENT	GAL.	71	92
442	REMOVAL OF PRESENT SUPERSTRUCTURE, MODIFIED	L.S.	1	1
507	SHORING SUPERSTRUCTURE (EXR END OF TRUSS ONLY)	EQ	1	1
509-A	HAND CLEANING & DRAINING OF STRUCTURAL STEEL, MODIFIED (EST. QUANTITY)	L.S.	1	1
534-A	CAST IRON GRATE TYPE A	EQ	1	1
555	BITUMINOUS CONCRETE CURB	TONS	3	2.9
562	BITUMINOUS CONCRETE SIDEWALK, MOD.	TONS	5	11.2
435-C	EMULSIFIED BONDING COMPOUND	GAL.	15	15
221	OVERHAUL (7 MILES)	CR-MI	280	491
574-A	REMOVAL OF MASONRY & CONCRETE	C.Y.	20	22.1

NOTE: ANY FURTHER INFORMATION CONCERNING FINAL QUANTITIES, AMOUNTS OR OTHER DETAILS RELATIVE TO THIS PROJECT MAY BE FOUND IN EITHER THE FIELD BOOKS OR THE ESTIMATE FILE.

THESE PLANS ARE SUBJECT TO SUCH REVISIONS AS MAY BE REQUIRED BY THE BUREAU OF PUBLIC ROADS OR THE COMMISSIONER OF HIGHWAYS.

CONSTRUCTION IS TO BE CARRIED ON IN ACCORDANCE WITH THESE PLANS AND THE STANDARD SPECIFICATIONS FOR HIGHWAY AND BRIDGE CONSTRUCTION DATED APRIL 1964, AS APPROVED BY THE BUREAU OF PUBLIC ROADS ON OCTOBER 12, 1964, INCLUDING ALL SUBSEQUENT APPROVED REVISIONS AND SUCH REVISED SPECIFICATIONS AND SPECIAL PROVISIONS AS ARE INCORPORATED IN THESE PLANS.

APPROVED DISTRICT ENGINEER DATE 9-10-71  
APPROVED CONSTRUCTION ENGINEER DATE 10/1/71  
APPROVED BRIDGE ENGINEER DATE 11/1/71  
APPROVED HIGHWAY ENGINEER DATE 11/1/71  
APPROVED ASST. CHIEF ENGINEER DATE 11/1/71  
APPROVED CHIEF ENGINEER DATE 11/1/71

STATE OF VERMONT  
DEPARTMENT OF HIGHWAYS

TOWN OF MILTON RR No. 162

ROUTE No. US 7 - LOG STA 2691

US 7 OVER LAPOILLE RIVER

TITLE SHEET

SCALE AS NOTED

SECTION SUPERVISOR J. WOOD

DRAWN BY H. H. ... CHECKED BY ...

PROJECT NO. BMA-6216

SHEET 1 OF 16

PLAN  
 QUANTITY  
 CHECKED  
 DATE  
 NO.

PROFILE  
 QUANTITY  
 CHECKED  
 DATE  
 NO.

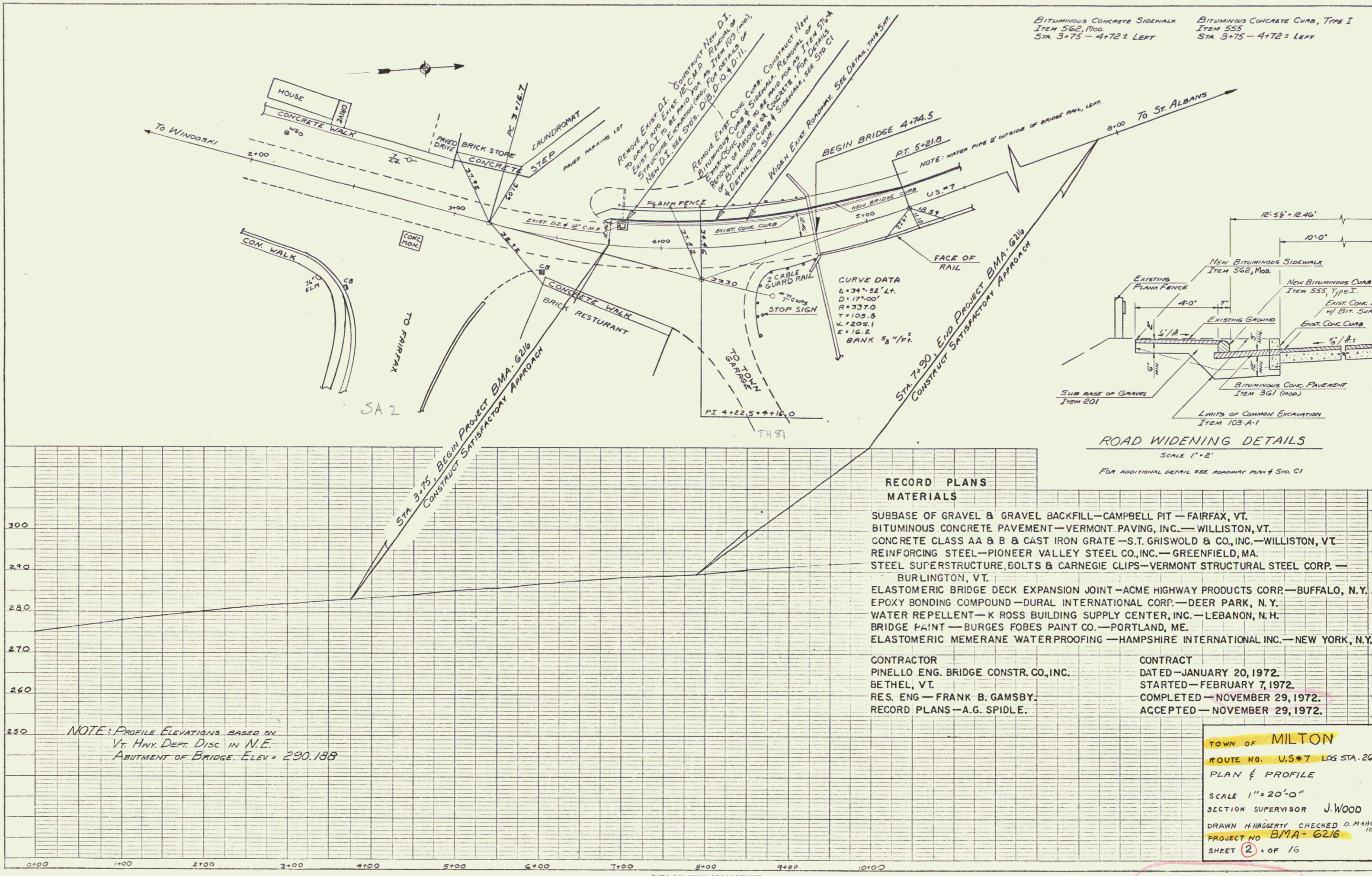

BITUMINOUS CONCRETE SIDEWALK  
 ITEM 562, MOD  
 STA 3+75 - 4+72 ± LEFT

BITUMINOUS CONCRETE CURB, TYPE I  
 ITEM 555  
 STA 3+75 - 4+72 ± LEFT

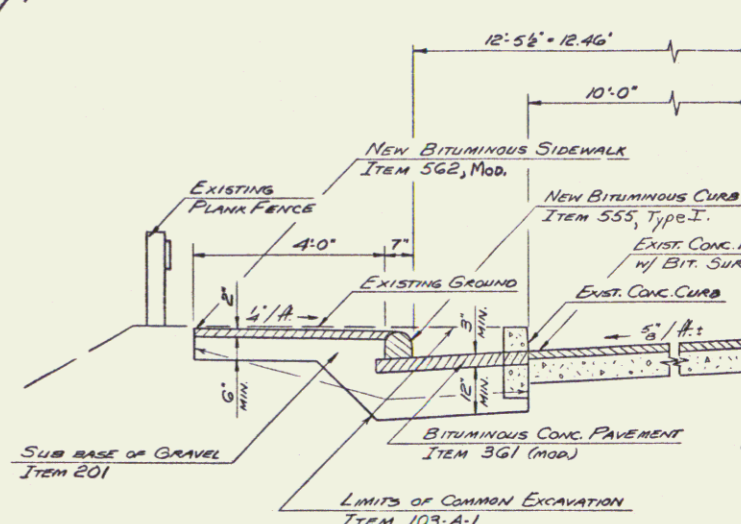

ROAD WIDENING DETAILS  
 SCALE 1"=2'  
 FOR ADDITIONAL DETAIL SEE ROADWAY PLAN # STD. C1

RECORD PLANS MATERIALS

- SUBBASE OF GRAVEL & GRAVEL BACKFILL—CAMPBELL PIT—FAIRFAX, VT.
- BITUMINOUS CONCRETE PAVEMENT—VERMONT PAVING, INC.—WILLISTON, VT.
- CONCRETE CLASS AA & B & CAST IRON GRATE—S.T. GRISWOLD & CO., INC.—WILLISTON, VT.
- REINFORCING STEEL—PIONEER VALLEY STEEL CO., INC.—GREENFIELD, MA.
- STEEL SUPERSTRUCTURE, BOLTS & CARNEGIE CLIPS—VERMONT STRUCTURAL STEEL CORP.—BURLINGTON, VT.
- ELASTOMERIC BRIDGE DECK EXPANSION JOINT—ACME HIGHWAY PRODUCTS CORP.—BUFFALO, N.Y.
- EPOXY BONDING COMPOUND—DURAL INTERNATIONAL CORP.—DEER PARK, N.Y.
- WATER REPELLENT—K ROSS BUILDING SUPPLY CENTER, INC.—LEBANON, N.H.
- BRIDGE PAINT—BURGES FOBES PAINT CO.—PORTLAND, ME.
- ELASTOMERIC MEMBRANE WATERPROOFING—HAMPSHIRE INTERNATIONAL INC.—NEW YORK, N.Y.

CONTRACTOR  
 PINELLO ENG. BRIDGE CONSTR. CO., INC.  
 BETHEL, VT.  
 RES. ENG.—FRANK B. GAMSBY.  
 RECORD PLANS—A.G. SPIDLE.

CONTRACT  
 DATED—JANUARY 20, 1972.  
 STARTED—FEBRUARY 7, 1972.  
 COMPLETED—NOVEMBER 29, 1972.  
 ACCEPTED—NOVEMBER 29, 1972.

NOTE: PROFILE ELEVATIONS BASED ON  
 VT. HWY. DEPT. DISC. IN N.E.  
 ABUTMENT OF BRIDGE. ELEV. = 290.188

TOWN OF MILTON  
 ROUTE NO. U.S.#7 LOG STA. 269  
 PLAN & PROFILE  
 SCALE 1"=20'-0"  
 SECTION SUPERVISOR J. WOOD  
 DRAWN H. HAGERTY CHECKED D. MARON  
 PROJECT NO. BMA-6216  
 SHEET 2 OF 16