

- INDEX OF SHEETS
1. TITLE SHEET
 2. PLAN & PROFILE
 3. EXPANSION BEARING DETAILS
 4. TYPICAL SECTIONS & RAILING POST DETAILS
 5. SINGLE SEAL EXPANSION JOINT DETAILS
 6. THREE SEAL EXPANSION JOINT DETAILS
 7. REINFORCING SCHEDULE
 8. STD. SCB-DI-67, APR 29, 1970
 9. STD. SCB-DG-67, "
 10. STD. DB MAR 10, 1965
 11. STD. DIO "
 12. STD. DII "
 13. STD. CI FEB 10, 1969
 14. STD. E16 DEC. 18, 1964 R
 15. STD. E33 JAN. 9, 1967
 16. STD. E34 MAY 6, 1971 R

STATE OF VERMONT
DEPARTMENT OF HIGHWAYS
PROPOSED IMPROVEMENT

TOWN OF MILTON
BMA-6216

2-992424

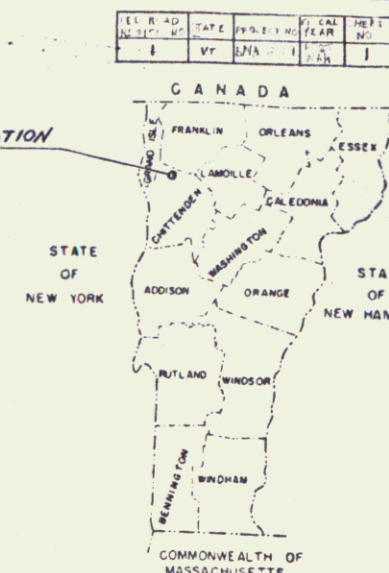
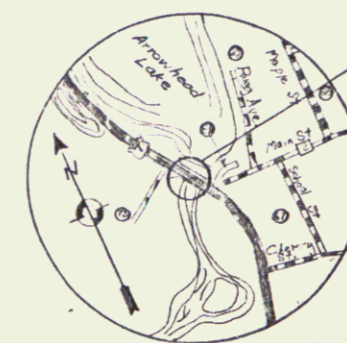

REMOVE EXIST. BACKWALL TO BEAM SEAT ELEV. 2. REBUILD AS SHOWN IN CLASS B CONCRETE. (TYP. BOTH REINFORCEMENTS.)

REMOVAL OF EXISTING BACKWALL TO BE PROVIDED FOR AS 1" MIN. 3/8" DIA. REMOVAL OF PIER OR CONCRETE.

TYP. SECTION @ ABUT. #1
N.T.S.

5507 LAP W/ 5502 B + 5601 B @ TOP OF SLAB

NEW SLAB

CONSTRUCT SATISFACTORY APPROACH BEGIN PROJECT BMA 6209 STA. 3+75

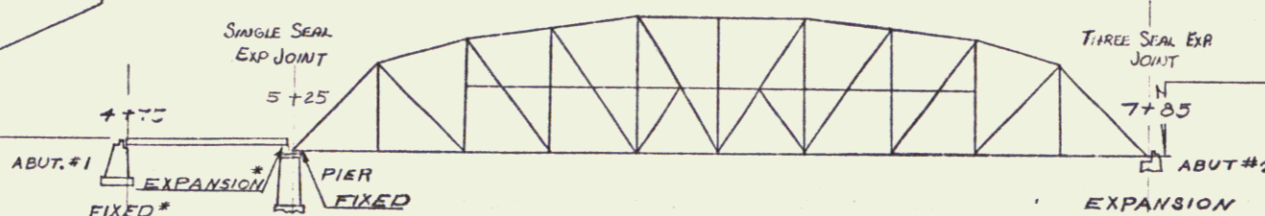

PARTIAL PROFILE OF BRIDGE
SCALE 1"=30'-0"

END PROJECT BMA 6216, STA. 7+90
CONSTRUCT SATISFACTORY APPROACH

PROJECT DESCRIPTION

THE PROJECT SHALL CONSIST OF REMOVING & REPLACING CONCRETE DECK, SIDEWALK & CURBS, PLACING NEW BITUMINOUS CONCRETE PAVEMENT, REPLACING TRUSS EXPANSION BEARINGS, CLEANING & PAINTING ALL EXISTING STRUCTURAL STEEL, REPAIR OF ABUTMENTS AND REPAIRING EXPANSION JOINTS.

PROJECT LOCATION

IN THE VILLAGE OF MILTON, BEGINNING AT A POINT APPROXIMATELY 85 FEET NORTHERLY FROM THE INTERSECTION OF U.S. ROUTE 7 AND STATE AID ROUTE 2 AND EXTENDING NORTH 4150 FEET ALONG U.S. ROUTE 7.

RECORD PLAN INFORMATION ON SHEET NO.

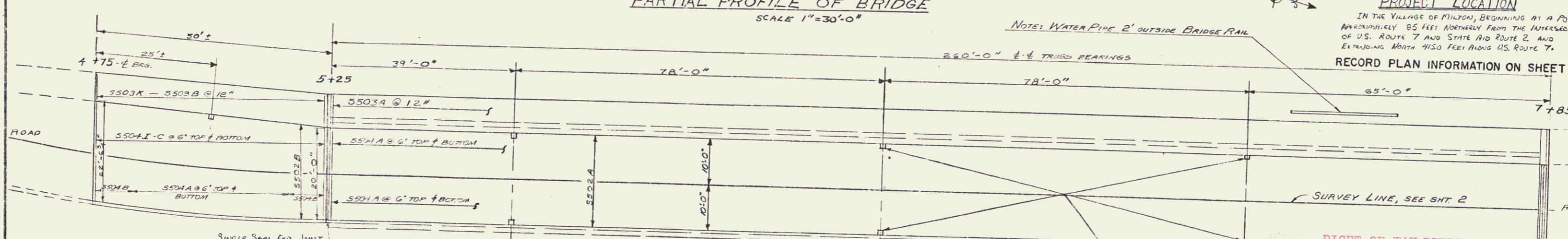

NOTE: TRANSVERSE REINFORCING STEEL TO BE PLACED PERPENDICULAR TO EXISTING BEAMS. SPACING AS REQ'D. @ ENDS OF APPROACH SPAN.

CONVENTIONAL SIGNS

- POINT OF ACCESS
- LIMITS OF ACCESS
- COUNTY LINE
- TOWN LINE
- FENCE LINE
- STONE WALL
- UNFENCED PROPERTY
- RAILROAD
- RETAINING WALL
- CENTER LINE
- SURVEY LINE
- CULVERT
- DROP INLET
- TROLLEY POLE
- POWER POLE
- TELEPHONE POLE
- TREES
- EDGE

MILTON BMA 6216
CONST. BY PINELO ENG. BRIDGE CONST. CO., INC.
RECORD PLANS - 1 AS SPIDLE
CONST. COMPLETED - NOVEMBER 29, 1972.

| ITEM # | ITEM | UNIT | EST. QUANTITY | FINAL QUANTITY |
|--------|---|---------|---------------|----------------|
| 103-A1 | COMMON EXCAVATION, CLASS I | C.Y. | 40 | 22 |
| 401-AA | CONCRETE CLASS AA MODIFIED WITH ALBITHE | C.Y. | 40 | 38 |
| 109 | STRUCTURE EXCAVATION MOD. | C.Y. | 20 | 21.4 |
| 101 | MAINTENANCE OF TRAFFIC FOR BRIDGE PROJECTS | L.S. | 1 | 1 |
| 201 | SUB-BASE OF GRAVEL | C.Y. | 30 | 34 |
| 222-B | GRAVEL BACKFILL FOR STRUCTURES | C.Y. | 10 | 17 |
| 405-A | ELI TOMER MEMBRANE WATERPROOFING (L.M.B.) | S.Y. | 690 | 0 |
| 301-AA | BITUMINOUS CONCRETE PAVEMENT MODIFIED TYPE II | TONS | 92 | 130 |
| 401-AA | CONCRETE CLASS AA MODIFIED | C.Y. | 16.9 | 171.7 |
| 401-B | CONCRETE CLASS B MODIFIED | C.Y. | 1R | 11.6 |
| 402 | REINFORCING STEEL MODIFIED | L.S. | 65,760 | 66,372 |
| 404-B | STEEL SUPERSTRUCTURE (NON-BEARING 502C * E) | L.S. | 1 | 1 |
| 414 | REINFORCING MASONRY | S.Y. | 10 (est.) | 14 |
| 434-A | ELASTOMERIC BRIDGE DECK EXPANSION JOINT (SINGLE SEAL) | L.F. | 29 | 29 |
| 434-C | ELASTOMERIC BRIDGE DECK EXPANSION JOINT (THREE SEAL) | L.F. | 29 | 28 |
| 440 | WATER REPELLENT | GAL. | 71 | 92 |
| 442 | REMOVAL OF PRESENT SUPERSTRUCTURE, MODIFIED | L.S. | 1 | 1 |
| 507 | SHORING SUPERSTRUCTURE (EXR END OF TRUSS ONLY) | EQ. | 1 | 1 |
| 509-A | HAND CLEANING & PAINTING OF STRUCTURAL STEEL MODIFIED (EST. QUANT. ESTIMATED) | L.S. | 1 | 1 |
| 534-A | CAST IRON GRATE TYPE A | EQ. | 1 | 1 |
| 555 | BITUMINOUS CONCRETE CURB | TONS | 3 | 2.9 |
| 562 | BITUMINOUS CONCRETE SIDEWALK, MOD. | TONS | 5 | 11.2 |
| 435-C | ELASTIC BONDING COMPOUND | GAL. | 15 | 15 |
| 221 | OVERHAUL (7 MILES) | CR.-MI. | 20 | 49 |
| 574-A | REMOVAL OF MASONRY & CONCRETE | C.Y. | 20 | 22.1 |

NOTE: ANY FURTHER INFORMATION CONCERNING FINAL QUANTITIES, AMOUNTS OR OTHER DETAILS RELATIVE TO THIS PROJECT MAY BE FOUND IN EITHER THE FIELD BOOKS OR THE ESTIMATE FILE.

THESE PLANS ARE SUBJECT TO SUCH REVISIONS AS MAY BE REQUIRED BY THE BUREAU OF PUBLIC ROADS OR THE COMMISSIONER OF HIGHWAYS.

CONSTRUCTION IS TO BE CARRIED ON IN ACCORDANCE WITH THESE PLANS AND THE STANDARD SPECIFICATIONS FOR HIGHWAY AND BRIDGE CONSTRUCTION DATED APRIL 1964, AS APPROVED BY THE BUREAU OF PUBLIC ROADS ON OCTOBER 12, 1964, INCLUDING ALL SUBSEQUENT APPROVED REVISIONS AND SUCH REVISED SPECIFICATIONS AND SPECIAL PROVISIONS AS ARE INCORPORATED IN THESE PLANS.

APPROVED DISTRICT ENGINEER DATE 9-10-71
APPROVED CONSTRUCTION ENGINEER DATE 10/1/71
APPROVED BRIDGE ENGINEER DATE 11/1/71
APPROVED HIGHWAY ENGINEER DATE 11/1/71
APPROVED ASST. CHIEF ENGINEER DATE 11/1/71
APPROVED CHIEF ENGINEER DATE 11/1/71

STATE OF VERMONT
DEPARTMENT OF HIGHWAYS

TOWN OF MILTON RR No. 162
ROUTE No. US 7 L.O.S. STA 2691
US 7 OVER LAMOILLE RIVER

TITLE SHEET
SCALE AS NOTED
SECTION SUPERVISOR J. WOOD
DRAWN BY J. H. WOOD - CHECKED -
PROJECT NO. BMA-6216
SHEET 1 OF 16