

GUARD RAIL REQUIRED ON LEFT

Sta. 15+21 to 15+45	Length	24 FT.
23+88		24 FT.
24+27		24 FT.

ON RIGHT

Sta. 15+45 to 15+50	Length	24 FT.
22+89		24 FT.
24+27		24 FT.

TOTAL ON THIS SHEET 192 FT.

NEW CULVERTS REQUIRED

Sta. 15+22	2'x2' Concrete	6.5
	1-2-4 Concrete	7.0
	1-2-5 Concrete	7.0
Sta. 23+00	4'x3' Reinforced Concrete	7.8
	1-2-4 Concrete	7.8
	1-2-5 Concrete	12.4
	Reinforcing Steel	250 lbs.
Sta. 25+00	4'x3' Reinforced Concrete	7.8
	1-2-4 Concrete	7.8
	1-2-5 Concrete	12.4
	Reinforcing Steel	250 lbs.

PER. POND DIST. AD.	STAFF	PER. POND DIST. AD.	STAFF	PER. POND DIST. AD.	STAFF
9	VT	4	VT	4	VT

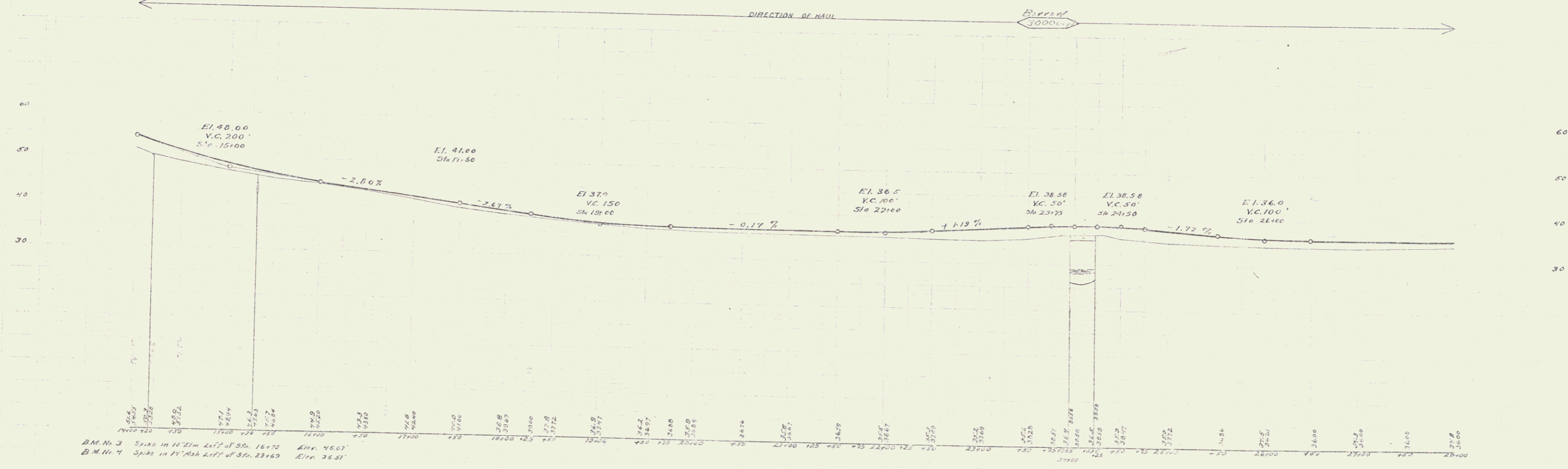
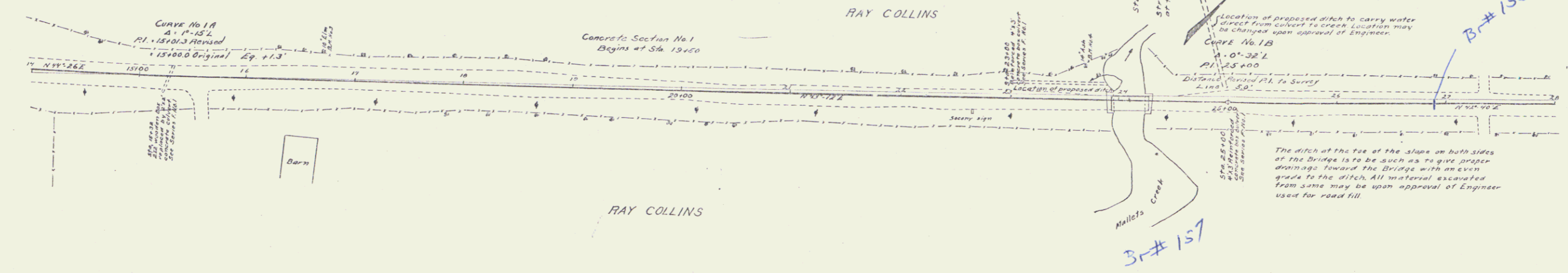

B.M. No. 3 Spike in 10' Elm Left of Sta. 16+70 Elev. 46.07'
 B.M. No. 4 Spike in 14' Elm Left of Sta. 23+60 Elev. 36.51'