



STATE OF VERMONT  
DEPARTMENT OF HIGHWAYS  
RIGHT-OF-WAY PLANS  
DETAIL SHEET

TABLE OF PROJECT PROPERTY ACQUISITION

PARCEL NO.	GRANTOR	SHEET NO.	BEGINNING STATION	ENDING STATION	TAKING	REF.	RIGHTS	TITLE TAKEN	DATE	TOWN OR CITY RECORDED	BK.	PG.	REMARKS	
1	GREATER BURLINGTON INDUSTRIAL CORP.		47+50 Rt	57+32 Rt	0.28 A <sup>2</sup>		SLOPE (P)						2550 S.F. ±	
			47+33 Rt	53+30 Rt	0.06 A <sup>2</sup>		SLOPE (P)							1575 S.F. ±
			53+86 Rt	55+89 Rt	0.04 A <sup>2</sup>		SLOPE (P)							925 S.F. ±
			57+60 Rt	58+48 Rt	0.02 A <sup>2</sup>		SLOPE (P)							
			57+09 Rt				DITCH & DRAINAGE (P)							
			TOTAL	0.40 A <sup>2</sup>										
2	HAYES INDUSTRIES, INC.		57+32 Rt	60+00 Rt	0.03 A <sup>2</sup>		SLOPE (P)						1200 S.F. ±	
			57+32 Rt	60+00 Rt	0.02 A <sup>2</sup>		SLOPE (P)							725 S.F. ±
				TOTAL	0.05 A <sup>2</sup>									
3	WEST, GERARD F. WEST, GERARD M.		87+80 Rt	101+41 Rt	0.75 A <sup>2</sup>		SLOPE (P)	WD	1-13-72	COLCHESTER	19	378		
			87+62 Rt	91+43 Rt	0.13 A <sup>2</sup>		SLOPE (P)							
			92+11 Rt	101+38 Rt	0.54 A <sup>2</sup>		SLOPE (P)							
			97+50 Rt				DRIVE (T)							
			90+37 E				DRAINAGE STRUCTURE (P)							
			92+55 E				DRAINAGE STRUCTURE (P)							
			93+72 E				DRAINAGE STRUCTURE (P)							
			97+34 E				DRAINAGE STRUCTURE (P)							
			100+81 E				DRAINAGE STRUCTURE (P)							
			97+60 Rt	96+00 Rt			DRAINAGE STRUCTURE (P)							
98+50 Rt	100+50 Rt			DRAINAGE STRUCTURE (P)										
			TOTAL	1.42 A <sup>2</sup>										
4	SEVERANCE, J. HERBERT & JUANITA M.		108+07 Rt	111+74 Rt	0.15 A <sup>2</sup>		SLOPE (P)	WD	1-11-72	COLCHESTER	19	369		
			112+24 Rt	114+68 Rt	0.09 A <sup>2</sup>		SLOPE (P)							3925 S.F. ±
			110+00 E				DRAINAGE STRUCTURE (P)							
			TOTAL	0.24 A <sup>2</sup>										

TABLE OF REVISIONS

REVISION NO.	SHEET NO.	DESCRIPTION OF REVISION	DATE	MADE BY	APPROVED BY

MADE BY: \_\_\_\_\_ DATE: \_\_\_\_\_  
CHECKED BY: \_\_\_\_\_ DATE: \_\_\_\_\_

DR RT - DRAINAGE RIGHT  
DIF RT - DITCHING RIGHT  
CH RT - CHANNEL RIGHT  
DRIVE RT - DRIVE RIGHT  
CUL RT - CULVERT RIGHT  
(D) - DEMOLITION OR REMOVAL  
(W) - WATER SOURCES

PRESENT R.O.W.  
---#---#---# TAKING WITHOUT ACCESS  
---#---#---# TAKING WITHOUT ACCESS ALONG PROPERTY LINE  
---#---#---# TAKING WITH ACCESS  
(P) - PERMANENT EASEMENT  
(T) - TEMPORARY EASEMENT

LEGEND

SR - SLOPE RIGHTS  
P - PROPERTY LINE  
A - TOP OF CUT  
O - TOP OF SLOPE

APPROVED: \_\_\_\_\_ DATE: \_\_\_\_\_  
CHIEF OF PLANS & TITLES  
APPROVED: \_\_\_\_\_ DATE: \_\_\_\_\_  
APPROVED: \_\_\_\_\_ DATE: \_\_\_\_\_

PROJECT COLCHESTER  
NO. BP 019-5-7123  
SHEET 1 OF \_\_\_\_\_



STATE OF VERMONT  
DEPARTMENT OF HIGHWAYS  
RIGHT-OF-WAY PLANS  
DETAIL SHEET

TABLE OF PROJECT PROPERTY ACQUISITION

PARCEL NO.	GRANTOR	SHEET NO.	BEGINNING STATION	ENDING STATION	TAKING	REM.	RIGHTS	TITLE TAKEN	DATE	TOWN OR CITY RECORDED	BK.	PG.	REMARKS	
10	MEUNIER, ARMEDE G. MEUNIER, BLANCHE M. MAHONEY, EMELDA C.		49+50LT	54+00LT	0.09AC				WDOE	2-27-72	COLCHESTER	17	461	4125 S.F. ±
			54+50LT	56+50LT	0.02AC									700 S.F. ±
			77+25LT	84+63LT	0.30AC									
			49+74LT	50+42LT	0.01AC			SLOPE (P)						545 S.F. ±
			50+60LT	54+00LT	0.10AC			SLOPE (P)						
			54+50LT	59+23LT	0.07AC			SLOPE (P)						2900 S.F. ±
			63+47LT	64+30LT	0.03AC			SLOPE (P)						1225 S.F. ±
			68+37LT	85+85LT	2.25AC			SLOPE (P)						
			70+50E					CULVERT (P)						
			80+28LT					CULVERT (P)						
	85+20E					CULVERT (P)								
			TOTAL		2.87AC									

TABLE OF REVISIONS

REVISION NO.	SHEET NO.	DESCRIPTION OF REVISION	DATE	MADE BY	APPROVED BY

MADE BY: \_\_\_\_\_ DATE: \_\_\_\_\_  
CHECKED BY: \_\_\_\_\_ DATE: \_\_\_\_\_

DR. RT - DRAINAGE RIGHT  
DIT. RT - DITCHING RIGHT  
CH. RT - CHANNEL RIGHT  
DRIVE RT - DRIVE RIGHT  
CUL. RT - CULVERT RIGHT  
Ⓞ - DEMOLITION OR REMOVAL  
Ⓜ - WATER SOURCES

PRESENT R.O.W.  
--- TAKING WITHOUT ACCESS  
--- TAKING WITHOUT ACCESS ALONG PROPERTY LINE  
--- TAKING WITH ACCESS  
(P) - PERMANENT EASEMENT  
(T) - TEMPORARY EASEMENT

LEGEND  
---SR---SR--- SLOPE RIGHTS  
---L---L--- PROPERTY LINE  
---Δ---Δ--- TOE OF CUT  
---O---O--- TOE OF SLOPE

APPROVED: \_\_\_\_\_ DATE: \_\_\_\_\_  
APPROVED: \_\_\_\_\_ DATE: \_\_\_\_\_  
APPROVED: \_\_\_\_\_ DATE: \_\_\_\_\_

PROJECT COLCHESTER  
NO. EP 019-5-7123  
SHEET 3 OF \_\_\_\_\_



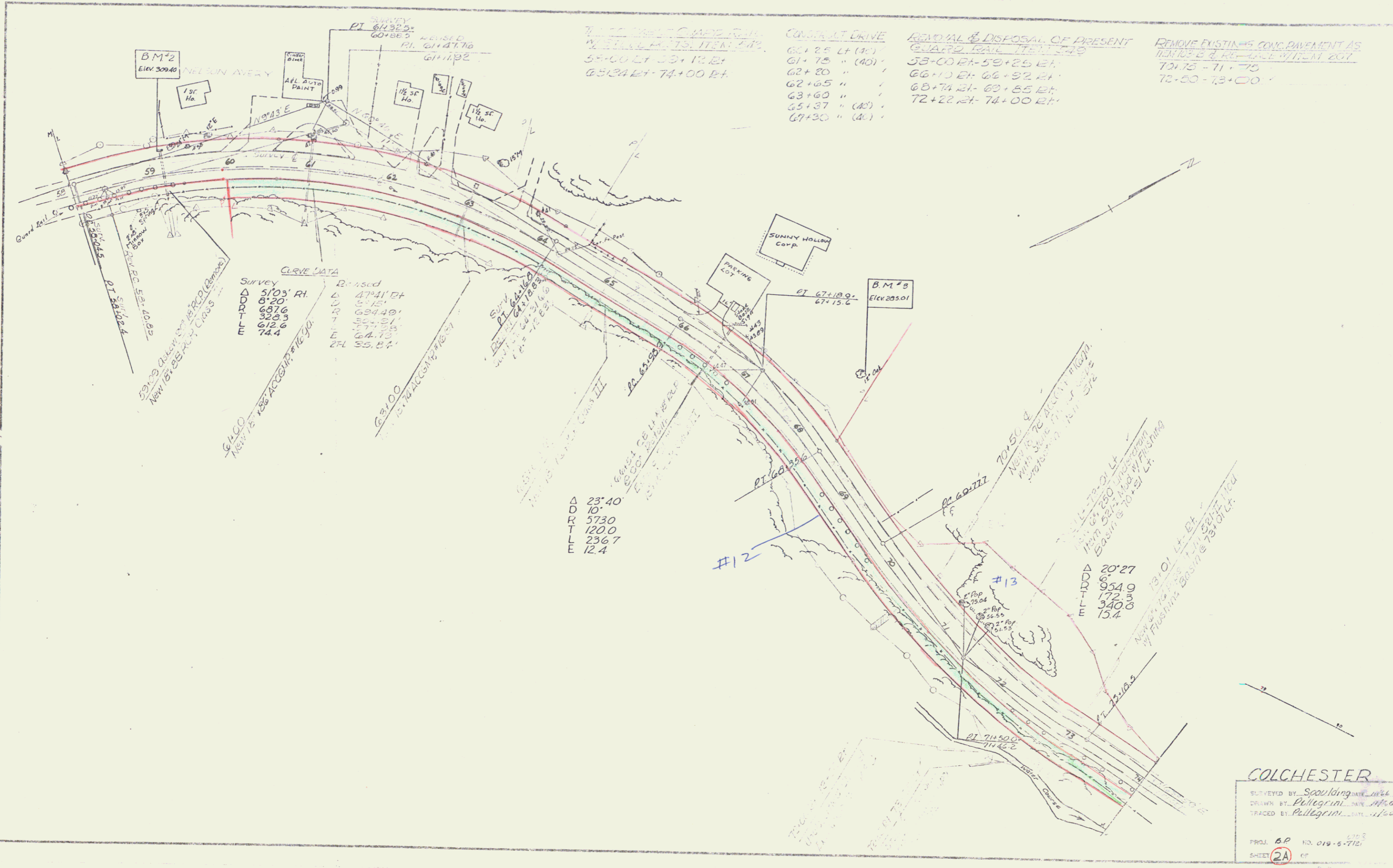

7' 11" 1/2" CURVE DATA  
 58+00 LT - 59+10 RT  
 65+34 RT - 74+00 RT

CONCRETE DRIVE  
 60+25 LT (40')  
 61+75 " (40')  
 62+20 " (40')  
 62+65 " (40')  
 63+60 " (40')  
 65+37 " (40')  
 67+30 " (40')

REMOVAL & DISPOSAL OF PRESENT  
 58+00 RT - 59+25 RT  
 66+10 RT - 66+32 RT  
 68+74 RT - 69+85 RT  
 72+22 RT - 74+00 RT

REMOVE EXISTING CONC. PAVEMENT AS  
 70+75 - 71+75  
 72+50 - 73+00

CURVE DATA

Survey	Revised
5103' RT	4741' RT
820	575'
6876	6949'
320.3	50+51'
612.6	77+33'
74.4	64.73'
	2FL 35.87'

Δ 23.40'  
 R 10'  
 T 5730'  
 L 1200'  
 E 236.7'  
 L 12.4'

COLCHESTER  
 SURVEYED BY: Scouling DATE: 1/14/66  
 DRAWN BY: Pellegrini DATE: 1/14/66  
 TRACED BY: Pellegrini DATE: 1/14/66  
 PROJ. 6P NO. 019-S-712  
 SHEET 2A OF 6

6

REMOVAL & RESITTING GUARD RAIL

74+00 Rt - 75+07 Rt

THREE CABLE GUARD RAIL  
W/LIGHT STEEL POSTS

76+30 Rt - 85+55 Rt  
83+50 Lt - 90+00 Lt  
89+25 Rt - 90+00 Rt

REMOVAL & DISPOSAL OF PRESENT  
GUARD RAIL

76+99 Rt - 77+77 Rt  
79+38 Rt - 81+93 Rt

REMOVE EXISTING CONC. PAVEMENT

77+00 - 78+00

BREAKING UP OF EXISTING CONC.  
PAVE. AS DRAGLINE RENTAL

78+00 ~ 79+50

TREATED TIMBER CURB  
83+50 Lt - 86+00 Lt  
84+14 Lt - 90+00 Lt  
89+50 Rt - 90+00 Rt

Stone Fill 1:1  
7+50 ~ 78+00  
79+50 ~ 80+00  
89+50 ~ 90+00  
84+00 ~ 87+50

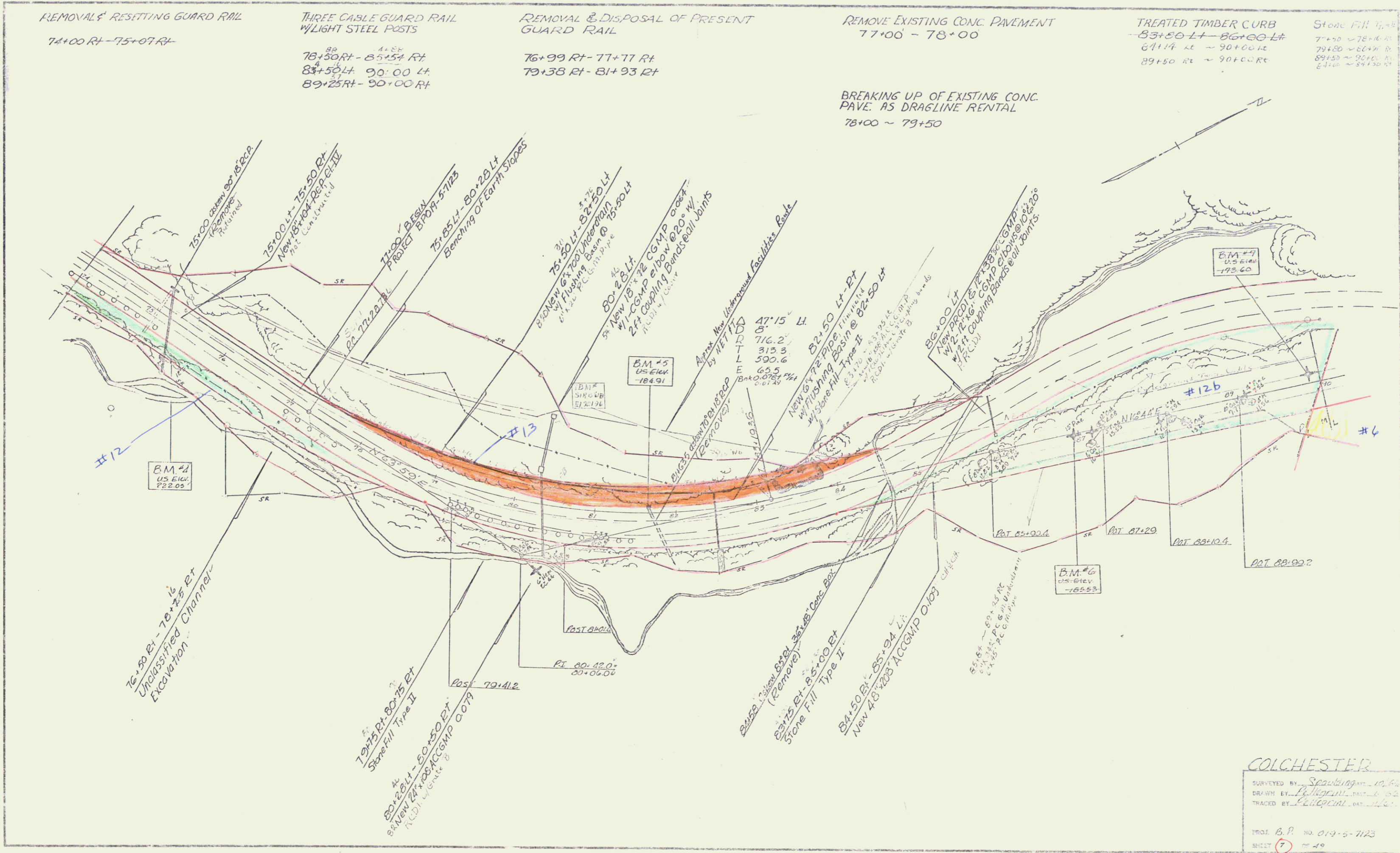

COLCHESTER

SURVEYED BY Spaulding, 10/66  
 DRAWN BY Pellegri, 11/66  
 TRACED BY Pellegri, 04/67

PROJ. B.P. No. 019-5-7123  
 SHEET 7 of 49

THREE CABLE GUARD RAIL  
W/LIGHT STEEL POSTS  
90+00' Lt - 92+94' Lt  
90+00' Rt - 94+21' Rt

REMOVAL & DISPOSAL OF PRESENT  
GUARD RAIL  
91+31' Lt - 97+80' Rt  
100+69' Rt 103+97' Rt

Construct Drives  
99+50' Rt.  
100+80' Lt

Stone Fill, Type II  
93+70 ~ 103+50' Rt.  
104+50 ~ 106+50' Rt.  
96+37 ~ 92+00' Lt  
91+00 ~ 91+50' Rt

TREATED TIMBER CURB  
98+00 - 93+20' Lt  
98+00 - 93+32' Rt

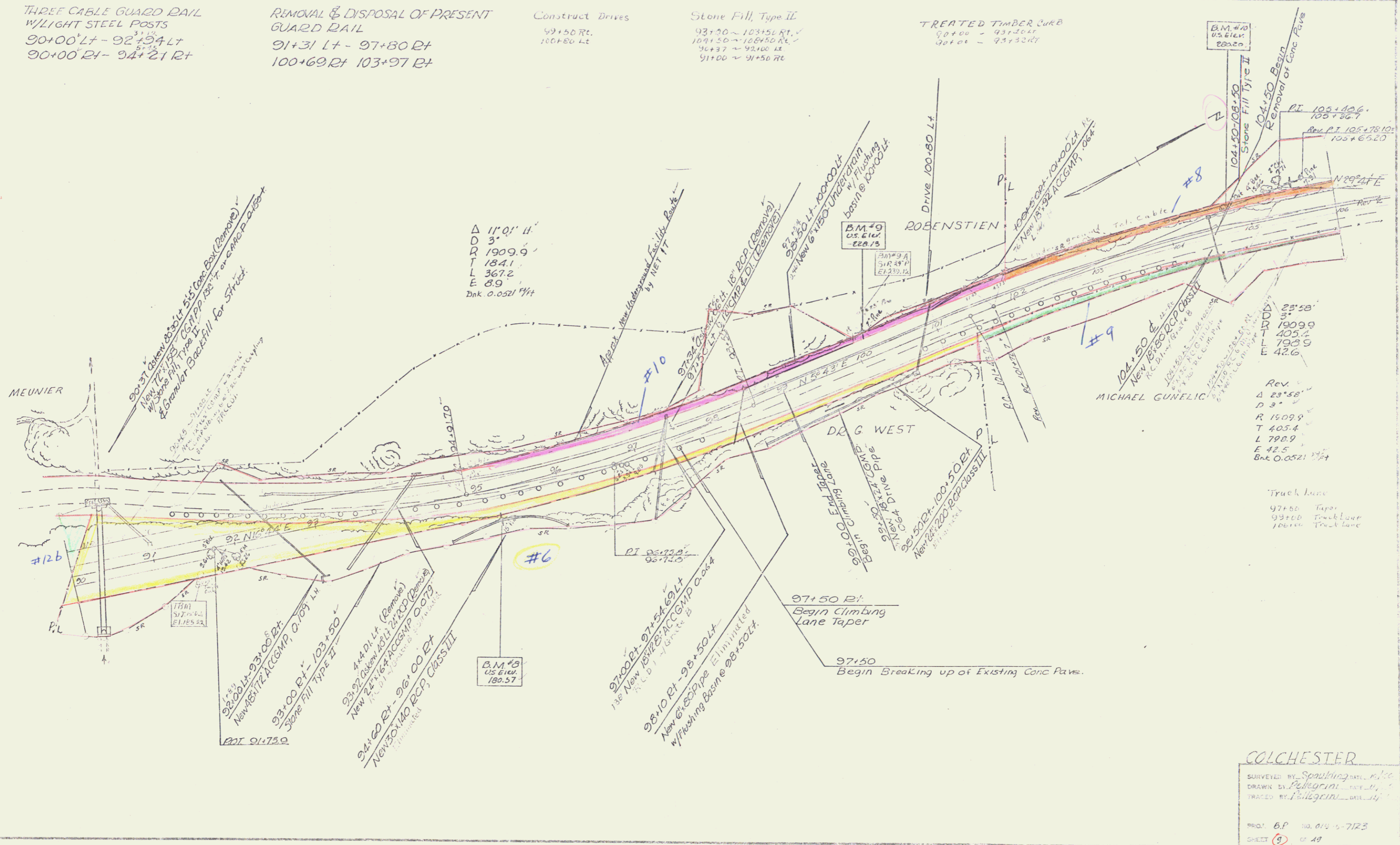

Δ 11' 0" H  
D 3'  
R 1909.9  
T 184.1  
L 367.2  
E 8.9  
Bnk 0.0521 1/4"

Rev.  
Δ 23' 58"  
D 3'  
R 1509.9  
T 405.4  
L 798.9  
E 42.5  
Bnk 0.0521 1/4"

Truck Lane  
97+50 Taper  
98+00 Truck Lane  
100+00 Truck Lane

COLCHESTER  
SURVEYED BY Spaulding DATE 11/00  
DRAWN BY Pellegrini DATE 11/00  
TRACED BY Pellegrini DATE 11/00  
PROJ. 6.P NO. 012 15-7123  
SHEET 9 OF 19

REMOVAL OF TREES  
20' CHG. D.P.L. 10/11/11  
100' 10' 11/11/11

CONSTRUCT APPROACH  
112+00 B.V.  
115+35 L.T.

CONSTRUCT DRIVE  
112+10 L.T.

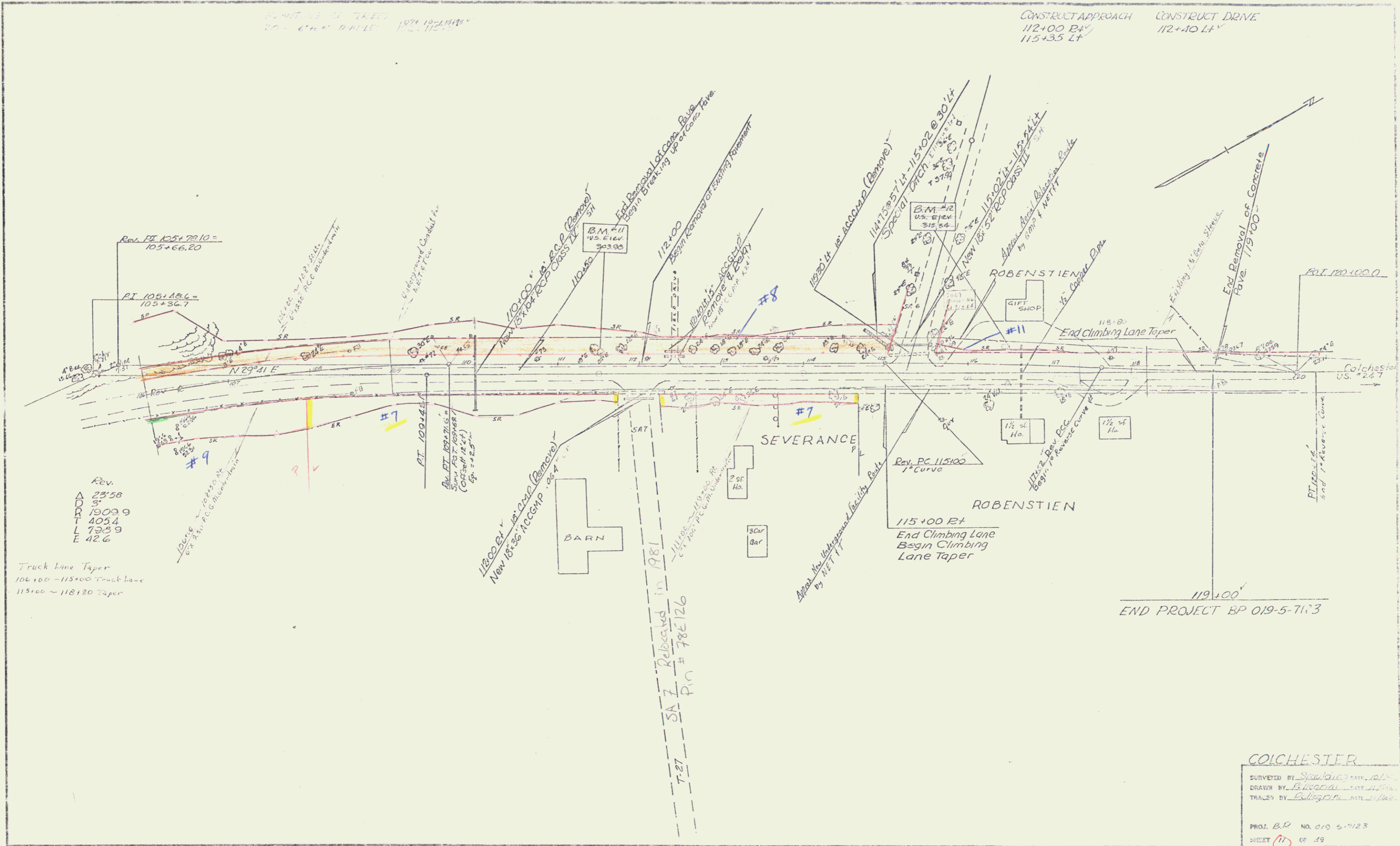

REV.  
 2358  
 3"  
 1909 9  
 4034  
 733 9  
 E 42.6

Truck Lane Taper  
 106+00 - 115+00 Truck Lane  
 115+00 - 118+20 Taper

COLCHESTER

SURVEYED BY: *[Signature]* DATE: 11/11/11  
 DRAWN BY: *[Signature]* DATE: 11/11/11  
 TRACED BY: *[Signature]* DATE: 11/11/11

PROJ. B.P. NO. 019-5-7123  
 SHEET 11 OF 19