

REMOVAL OF TREES
20' CHG. D.P.L. 10/11/11
100' 10' 11/11/11

CONSTRUCT APPROACH
112+00 B.V.
115+35 L.T.

CONSTRUCT DRIVE
112+10 L.T.

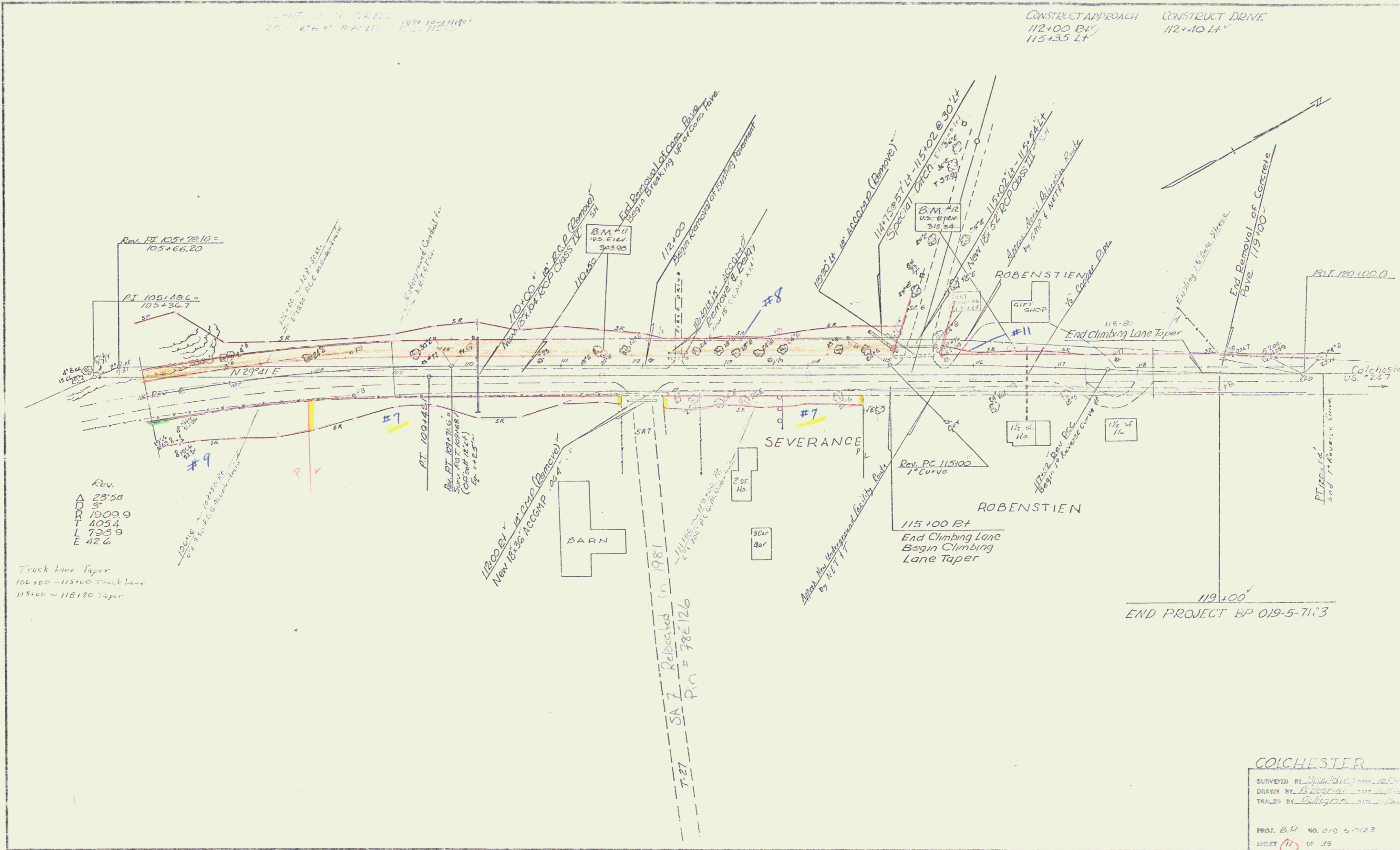

Rev.
23'58"
3"
1909.9
403.4
733.9
E 42.6

Truck Line Taper
106+00 - 115+00 Truck Lane
115+00 - 118+10 Taper

COLCHESTER

SURVEYED BY *SpawGlass* DATE *10/11/11*
DRAWN BY *B. Wood* DATE *11/11/11*
TRAILED BY *E. Logan* DATE *1/11/12*

PROJ. B.P. NO. 019-5-7123
SHEET **11** OF 19