

REMOVAL & RESITTING GUARD RAIL

74+00 Rt - 75+07 Rt

THREE CABLE GUARD RAIL
W/ LIGHT STEEL POSTS

76+30 Rt - 85+55 Rt
83+50 Lt - 90+00 Lt
89+25 Rt - 90+00 Rt

REMOVAL & DISPOSAL OF PRESENT
GUARD RAIL

76+99 Rt - 77+77 Rt
79+38 Rt - 81+93 Rt

REMOVE EXISTING CONC. PAVEMENT

77+00 - 78+00

TREATED TIMBER CURB
83+50 Lt - 86+00 Lt
84+14 Lt - 90+00 Lt
89+50 Rt - 90+00 Rt

Stone Fill 1:1
7+50 ~ 78+00
79+80 ~ 80+00
89+50 ~ 90+00
84+00 ~ 84+50

BREAKING UP OF EXISTING CONC.
PAVE. AS DRAGLINE RENTAL

78+00 ~ 79+50

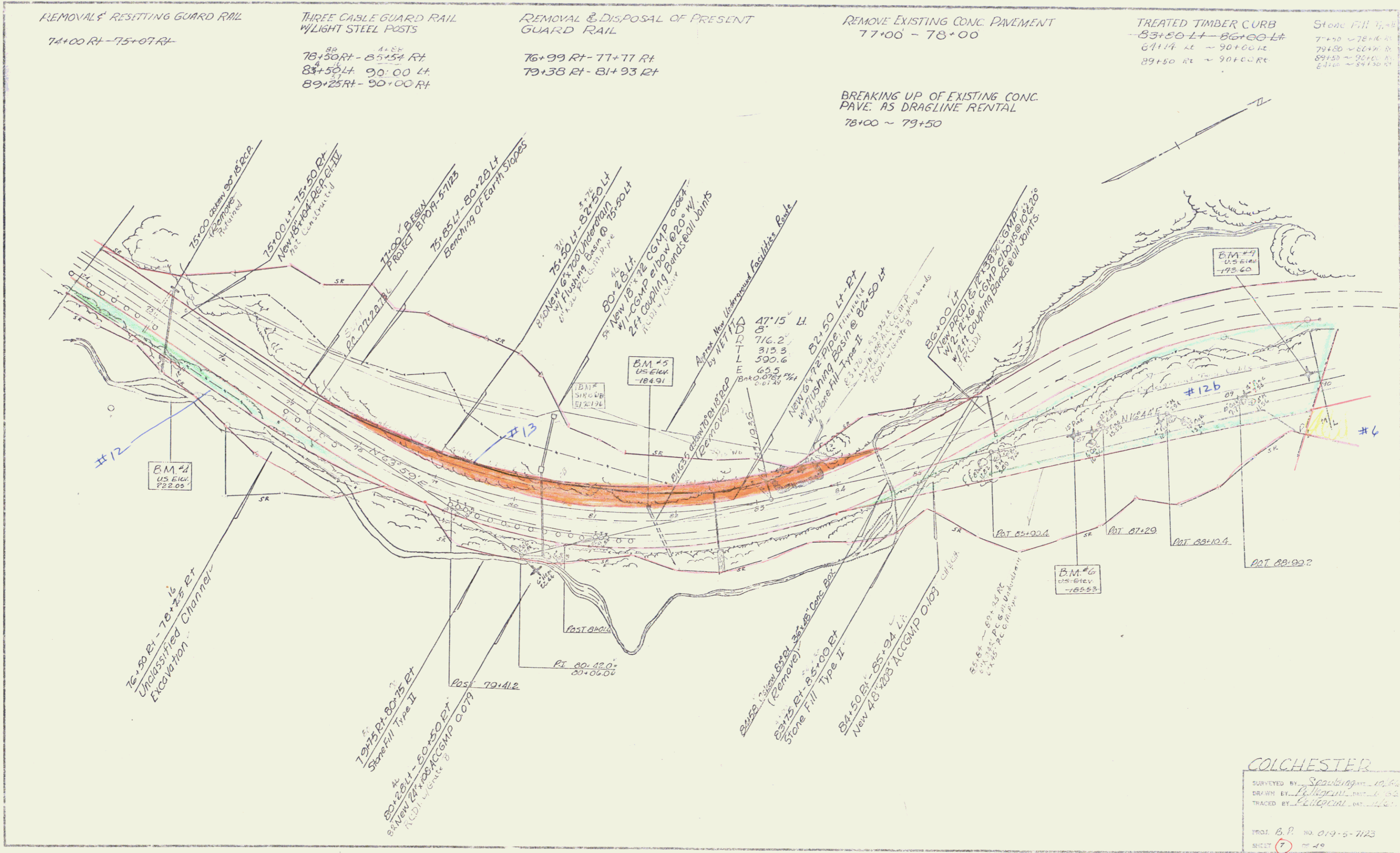

COLCHESTER

SURVEYED BY Spaulding, 10/66
 DRAWN BY Pellegri, 10/66
 TRACED BY Pellegri, 10/66

PROJ. B.P. No. 019-5-7123
 SHEET 7 of 40