

WOOD GUARD RAIL REQUIRED

STATION	TYPE	LENGTH
110+63	24	24
121+31	24	24

NEW REINFORCEMENT PIPE CULVERTS REQUIRED

STATION	SIZE	LENGTH	CONC. CURB C. BEING SET
110+63	18"	40	1.8 cu. yd.
121+31	18"	36	3.0 cu. yd.

DRIVE WAY FIRE CULVERTS REQUIRED

STATION	TYPE	LENGTH	CEMENT PORTLAND CONCRETE
112+55	R	12'	2.3 cy
113+00	L	16'	2.7 cy
114+50	R	12'	2.3 cy
116+00	L	12'	2.3 cy
116+60	R	12'	2.3 cy
117+30	R	12'	2.3 cy

GROUTED COBBLE GUTTER REQUIRED

STATION	TYPE	WIDTH	LENGTH	AREA
106+00 to 107+00	R	4'-0"	11'	32 sq. ft.

SFA
102-C/1230/27/140

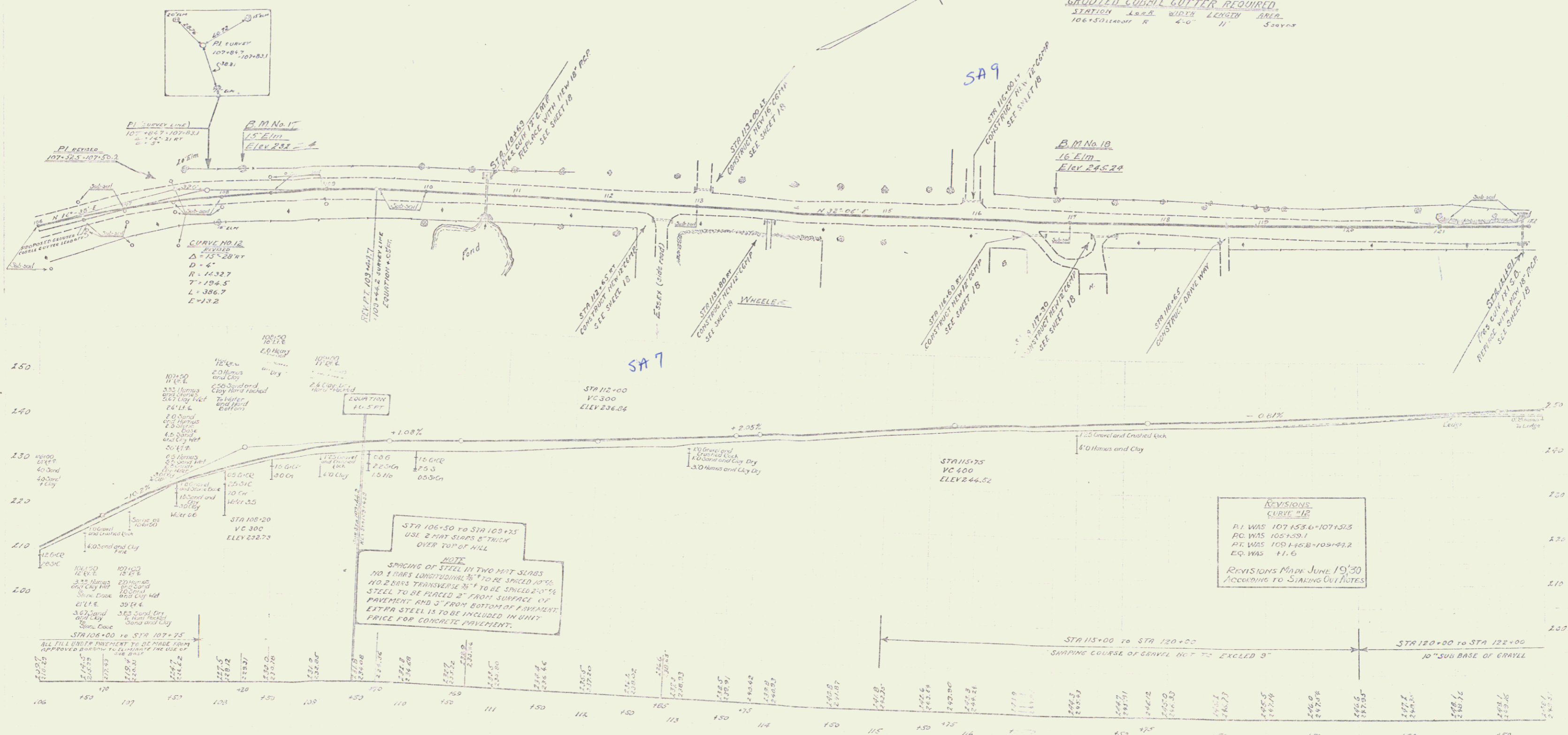

B.M. No. 17 Spill in 5' E of Sta 107+25 Elev 232.24
 B.M. No. 18 16' E of Sta 116+10 Elev 245.24

REVISIONS
 CURVE #12
 P.I. WAS 107+53.6+107+53.3
 P.C. WAS 105+53.1
 P.T. WAS 109+16.8+109+16.2
 EQ. WAS 11.6
 REVISIONS MADE JUNE 19'30
 ACCORDING TO STAKING OUT NOTES

SERIES SPAN 10' C
 SHEET 11 OF 40