

WOOD GUARD RAIL REQUIRED

STATIONS	LEFT	RIGHT
66+38	24'	24'
70+09	24'	—

CABLE GUARD RAIL REQUIRED

STATIONS	LEFT	RIGHT
68+73-75+21	—	64B
77+25-78+00	—	75

NEW REINFORCED CONCRETE PIPE CULVERTS REQUIRED

STATIONS	DIA.	LENGTH	CONC. A	CONC. B	REIN. STEEL
66+38	18"	40'	—	3.0x	33 lbs
73+09	18"	48'	1.8x	—	34 lbs

GRADED COBBLE CUTTER REQUIRED

STATIONS	TYPE	WIDTH	LENGTH	AREA
68+60-69+00	R	4'-0"	30'	232 sq. yds.
70+00-73+50	L	4'-0"	350'	1533 sq. yds.
75+75-78+00	L	4'-0"	225'	1003 sq. yds.
73+30-73+75	L	4'-0"	25'	11 sq. yds.

PLAN SHEET S.F.A. 102-C (REV. 8) 48

NOTE
 THE SAND SLOPES ON THE LEFT ARE TO BE PROTECTED BY THE USE OF A BRUSH MAT WITH WOVEN WIRE FENCING THOROUGHLY STAKED DOWN. IF CONDITIONS AT TIME OF CONSTRUCTION OF THIS PROTECTION MAKE IT ADVISABLE, LOAM IS TO BE ADDED ON TOP OF THE BRUSH AND THE SAME SEEDED DOWN. THIS PROTECTION IS NOT INCLUDED AS PART OF THE CONTRACT BUT IS TO BE PERFORMED BY STATE FORCE ACCOUNT.

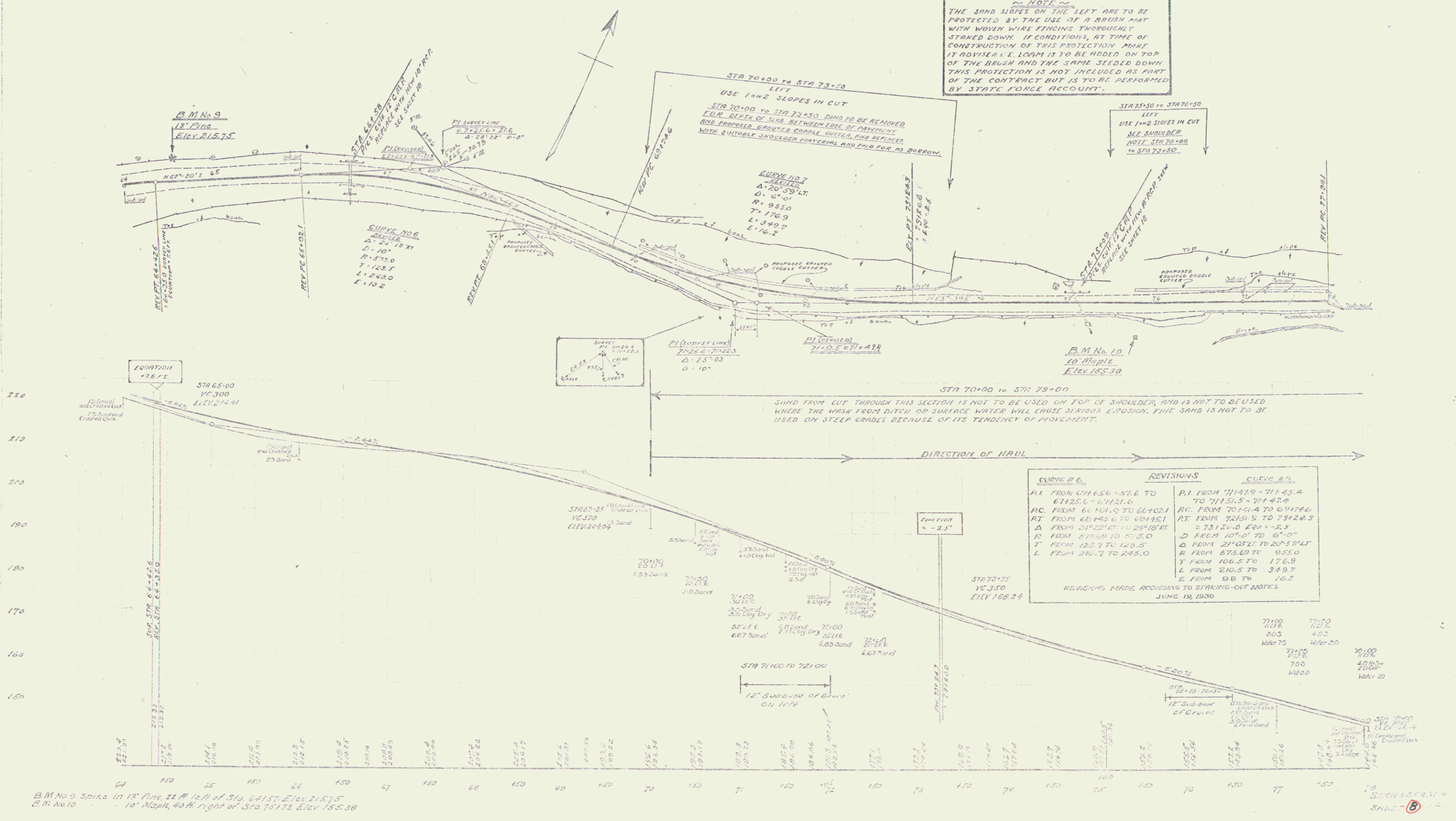

1928
 1929
 1930
 1931
 1932
 1933
 1934
 1935
 1936
 1937
 1938
 1939
 1940
 1941
 1942
 1943
 1944
 1945
 1946
 1947
 1948
 1949
 1950
 1951
 1952
 1953
 1954
 1955
 1956
 1957
 1958
 1959
 1960
 1961
 1962
 1963
 1964
 1965
 1966
 1967
 1968
 1969
 1970
 1971
 1972
 1973
 1974
 1975
 1976
 1977
 1978
 1979
 1980
 1981
 1982
 1983
 1984
 1985
 1986
 1987
 1988
 1989
 1990
 1991
 1992
 1993
 1994
 1995
 1996
 1997
 1998
 1999
 2000

B.M. No. 9 Spike in 13" Pine 21 ft. left of Sta. 64+57 Elev. 218.75
 B.M. No. 10 10" Maple 40 ft. right of Sta. 70+78 Elev. 156.38

SHEET 6