

GUARD RAIL REQUIRED
 ON LEFT
 Sta 29+95 - Sta 30+03 Length 8 ft
 Sta 30+17 - Sta 30+25 " 8 ft
 ON RIGHT
 Sta 29+95 - Sta 30+03 Length 8 ft
 Sta 30+17 - Sta 30+25 " 8 ft
 Total Length This Sheet 32 ft

SUB-BASE REQUIRED
 Sta 16+00 - Sta 32+00 Length 1596.5 ft
 Total on This Sheet 1596.5 ft

| DATE | BY | REVISION | DATE | BY |
|------|----|----------|------|----|
| 9 | VP | 34 | 1902 | 11 |

C.S. Weston
 D.L. Lane

CHEVALIER
 HATCH

HATCH
 CHEVALIER
 BK 37 #11
 89 281
 3 rods wide

STA 30+00 NEW
 BRIDGE SHEET NO. 7

Batt 181

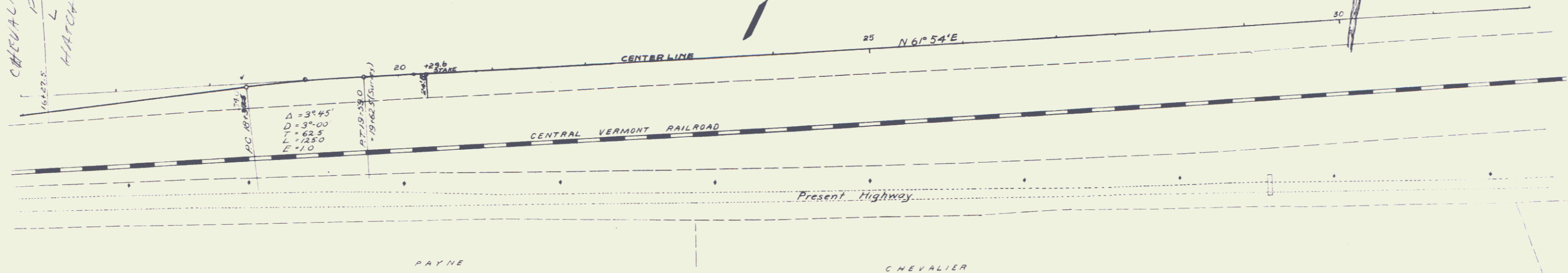

C.S. Weston
 D.L. Lane

