

INDEX OF SHEETS

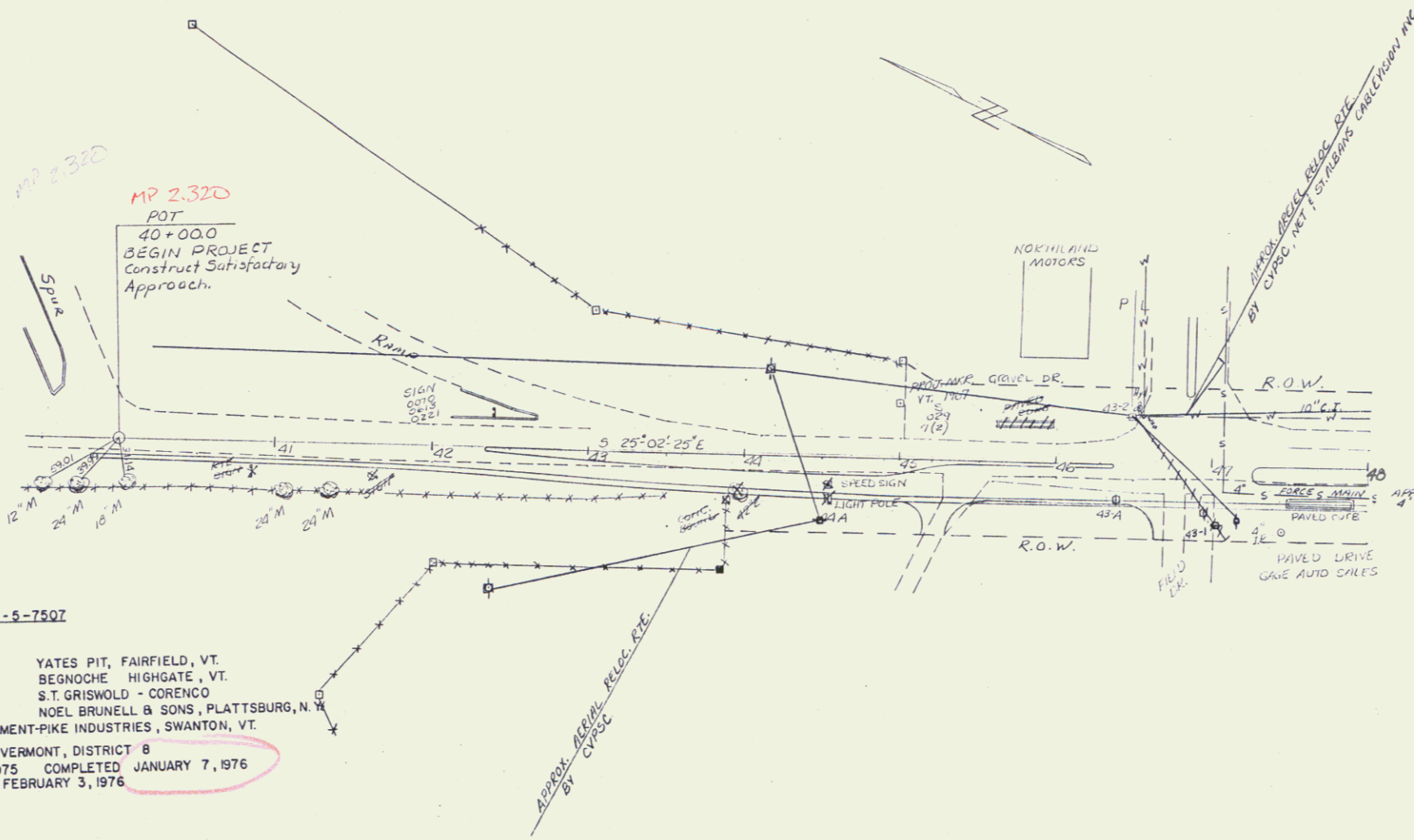

- CONVENTIONAL SIGNS
- COUNTY LINE
 - TOWN LINE
 - LIMITS OF ACCESS
 - POINT OF ACCESS
 - FENCE LINE
 - STONE WALL
 - TRAVELED WAY
 - GUARD RAIL
 - RAILROAD
 - SURVEY LINE
 - CULVERT
 - POWER POLE
 - TELEPHONE POLE
 - TREES
 - PROPERTY LINE
 - R.O.W. TAKING LINE
 - SLOPE RIGHTS
 - TOP OF CUT
 - T.O.E. OF SLOPE

ST. ALBANS BP 019-5-7507
 RECORD PLANS
 MATERIALS
 SUBBASE OF GRAVEL
 GRANULAR BORROW
 SEED, FERTILIZER
 ASPHALT
 BITUMINOUS CONCRETE PAVEMENT-PIKE INDUSTRIES, SWANTON, VT.
 CONTRACTOR STATE OF VERMONT, DISTRICT 8
 PROJECT BEGUN JUNE 2, 1975 COMPLETED JANUARY 7, 1976
 RECORD PLANS - P.F.W. FEBRUARY 3, 1976

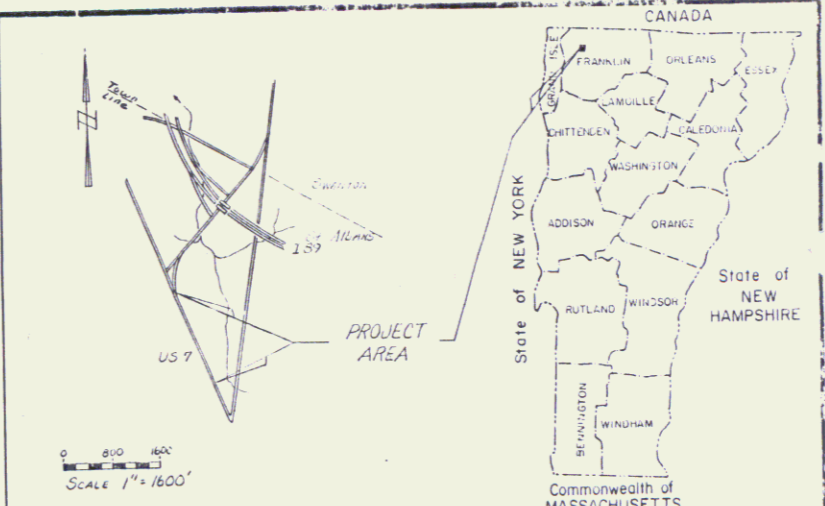

ITEM NO	ITEM	UNIT	NET	TOTAL	FINAL
201.16	Running Large Trees to Right of Way	EA	1		1
203.16	Common Excavation	CY	1		1
205.38	Earth Borrow - Granular Borrow	CY	400		400
301.15	Sub base of gravel	CU	100		100
404.40	Bituminous Concrete Pavement - Type 1	Ton	250		250
407.15	Asphalt Synthetic Binder	Ton	100		100
407.20	Synthetic Resin Binder	Ton	100		100
407.25	Support for Synthetic Resin Binder	Ton	100		100
407.30	Synthetic Resin Roadway Curb	LF	100		100
407.35	Asphalt Concrete (Gravel)	CU	10		10
407.40	Roadway Bitul Mastic	CU	10		10
407.45	All Purpose Excavator Rental	HR	10		10
407.50	Drill Bits Control of Column (1/2")	CU	1		1
407.55	Running & Re-Strip Riprap	CU	5		5
408.00	Uniformed Traffic Signs	EA	1		1
651.10	Seed	CU	50		50
651.15	Fertilizer	Ton	1		1
651.20	Agricultural Limestone	Ton	1		1
651.25	Hay Mulch	Ton	1		1
653.10	Topsoil	CY	50		50
	Signal Modification	EA	1		1
	Signage	EA	1		1

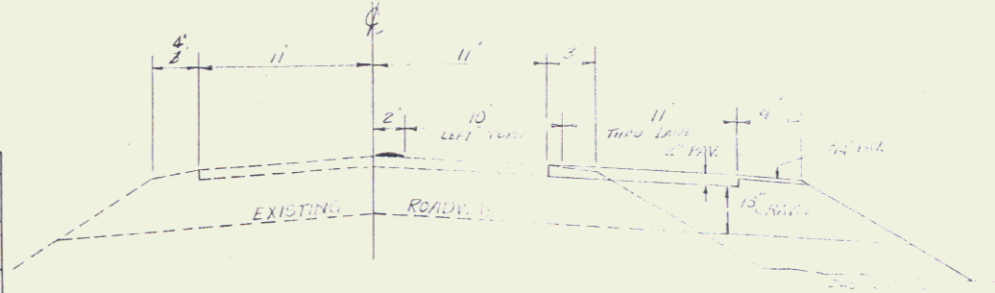

Sta. 46+00
 TYPICAL SECTION
 NOT TO SCALE

Pin # 992394

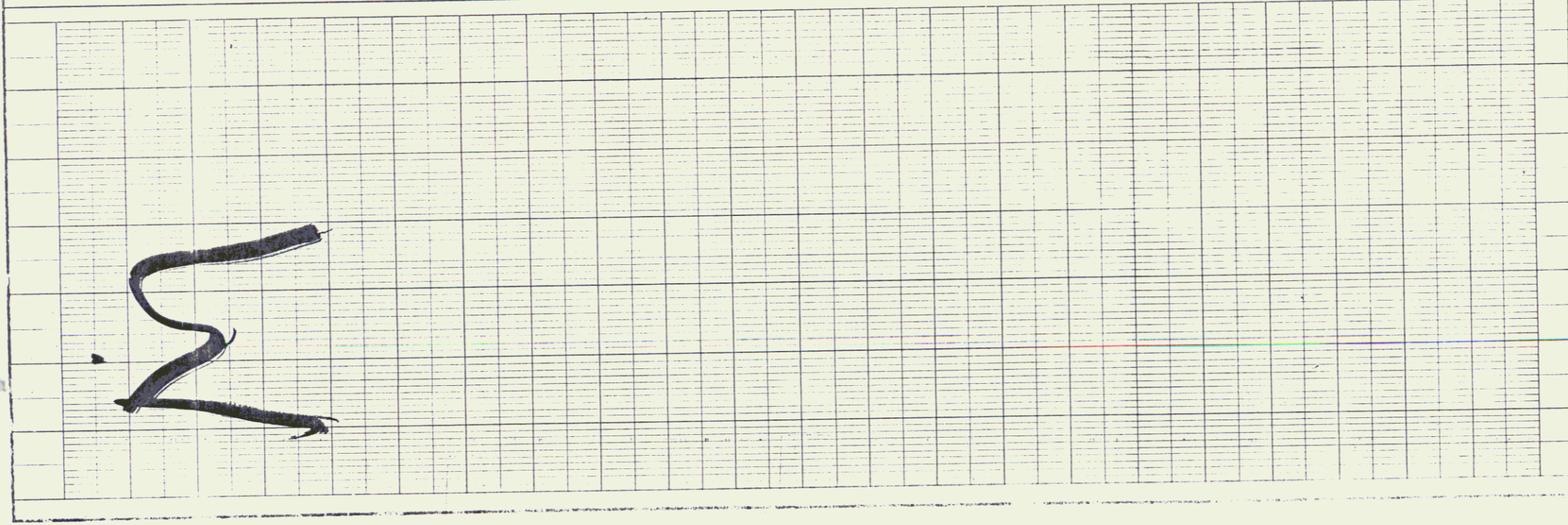

STATE OF VERMONT
 DEPARTMENT OF HIGHWAYS

TOWN OF ST. ALBANS RTE. NO. US 7

BRIDGE NO. _____
 LOG STA. _____
 SURV STA. 40+00 - 42+00

DESIGNED BY WOF DATE Aug 74
 DRAWN BY GAS DATE SEPT 74
 CHECKED BY _____ DATE _____

Design Supervisor _____ DATE _____

PROJECT BP STATE HIGHWAY 019-5-7507
 SHEET 1 OF 1

SUBMITTED BY ORDER OF THE STATE HIGHWAY BOARD
 APPROVED E.H. Steinhilber DATE 1-2-75
 CHIEF ENGINEER
 APPROVED NO 711 DATE 12-2-74
 DISTRICT ENGINEER

PLAN
 DATE: 1/10/84
 DRAWN BY: [Signature]
 CHECKED BY: [Signature]
 PROJECT: ST ALBANS U.S. 7

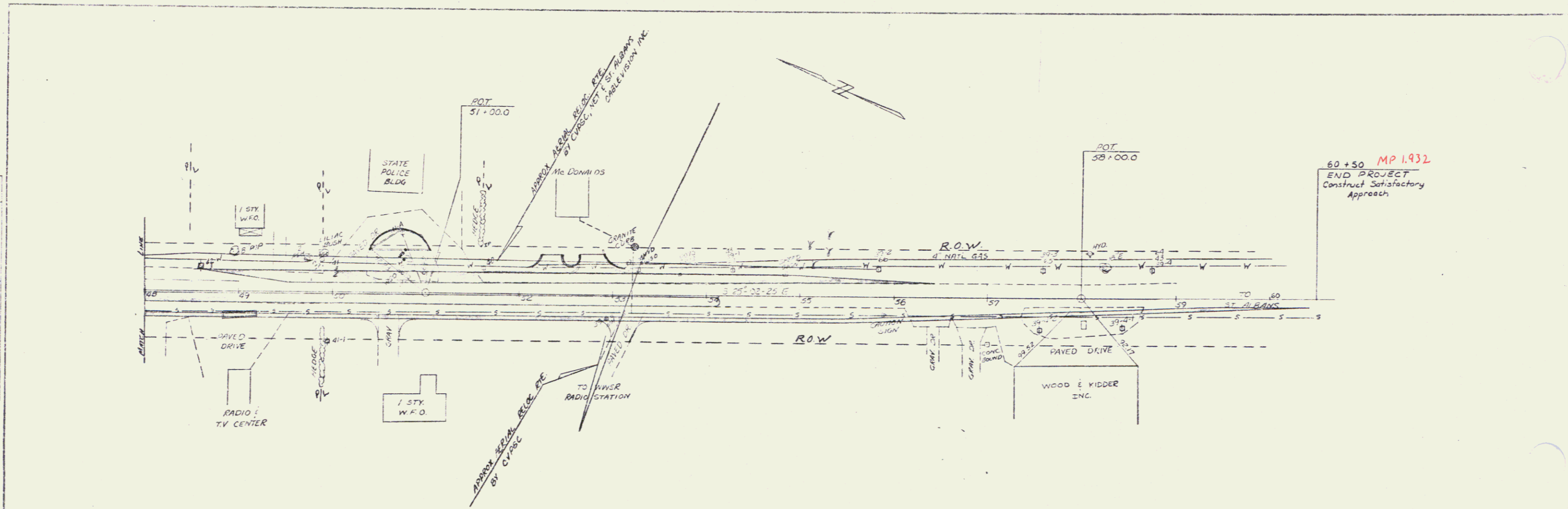

PROFILE
 DATE: 1/10/84
 DRAWN BY: [Signature]
 CHECKED BY: [Signature]
 PROJECT: ST ALBANS U.S. 7

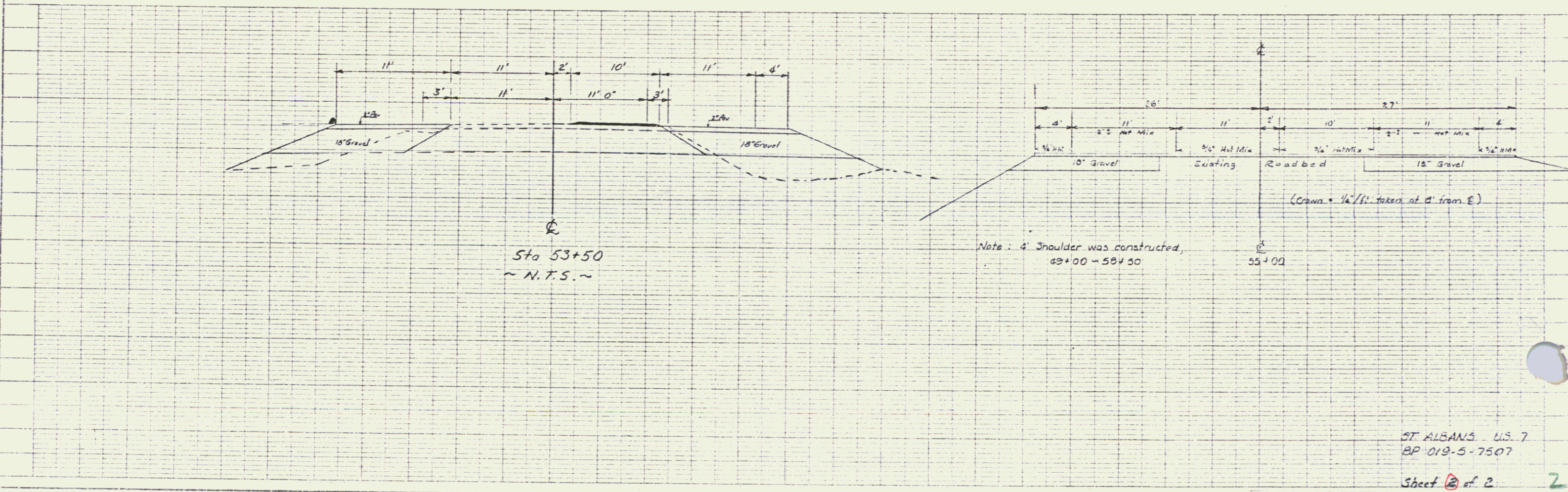

ST ALBANS U.S. 7
 BP 019-5-7507

Sheet 2 of 2

K&E
 KENNEDY & EMMETT
 ENGINEERS & ARCHITECTS
 40700 Marginal Road
 St Albans, Vermont 05478

JAN 10 1984