

PLAN  
 DATE: 1/10/84  
 DRAWN BY: [Signature]  
 CHECKED BY: [Signature]  
 PROJECT: ST ALBANS U.S. 7

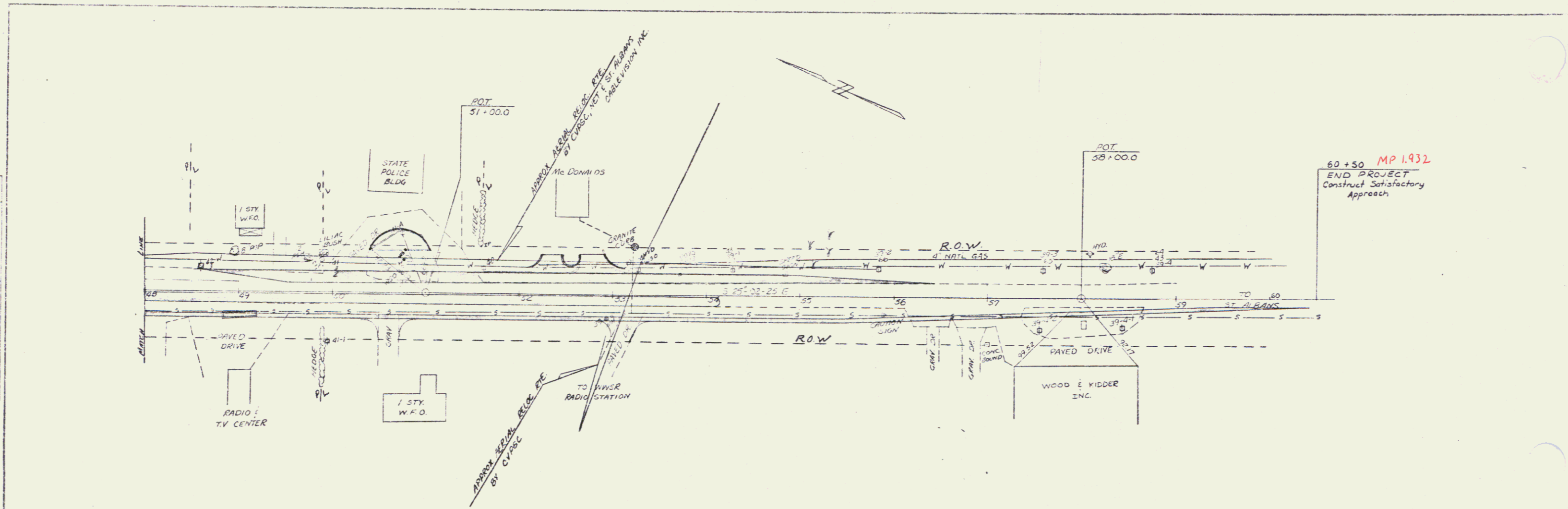

PROFILE  
 DATE: 1/10/84  
 DRAWN BY: [Signature]  
 CHECKED BY: [Signature]  
 PROJECT: ST ALBANS U.S. 7

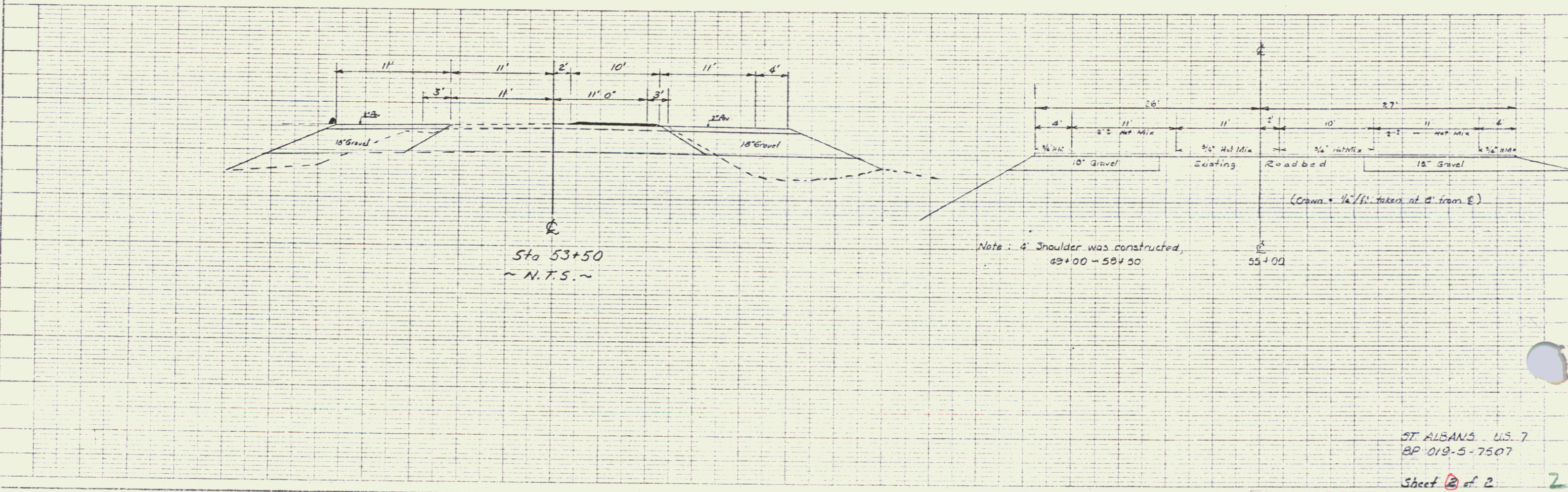

ST ALBANS U.S. 7  
 BP 019-5-7507

Sheet 2 of 2

K&E  
 KENNEDY & EMMETT  
 ENGINEERS & ARCHITECTS  
 40700 Marginal Road  
 St Albans, Vermont 05478

JAN 10 1984