

Removal & Disposal of Present Guard Rail-Item 549  
 412+00 - 414+53 Rt  
 412+00 - 416+90 Lt

Construct Drive  
 414+75 Rt ✓  
 419+52 Rt ✓  
 419+55 Lt ✓  
 417+20 Lt

Stone Fill (light type) Item 512  
 412+00-412+75 Lt ✓

Three Cable Guard Rail w/ Steel Posts, Item 542  
 Sta 412+00-417+05 Lt ✓

Note: 419+50 Lt.  
 Retain 5' x 5' Conc. Wall

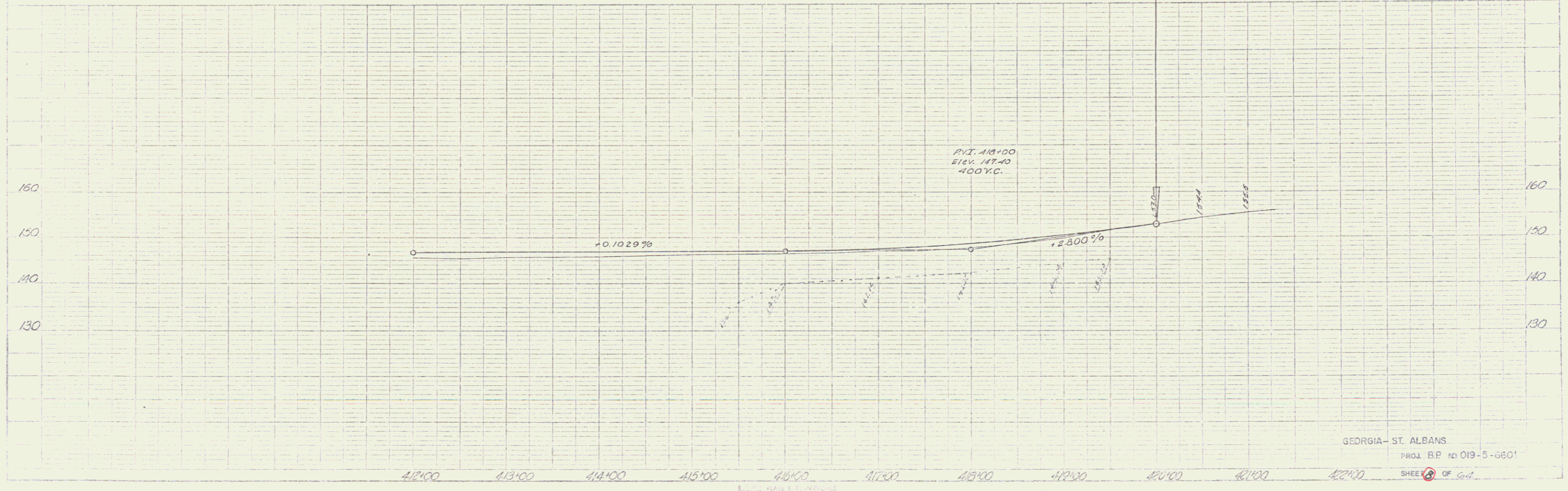
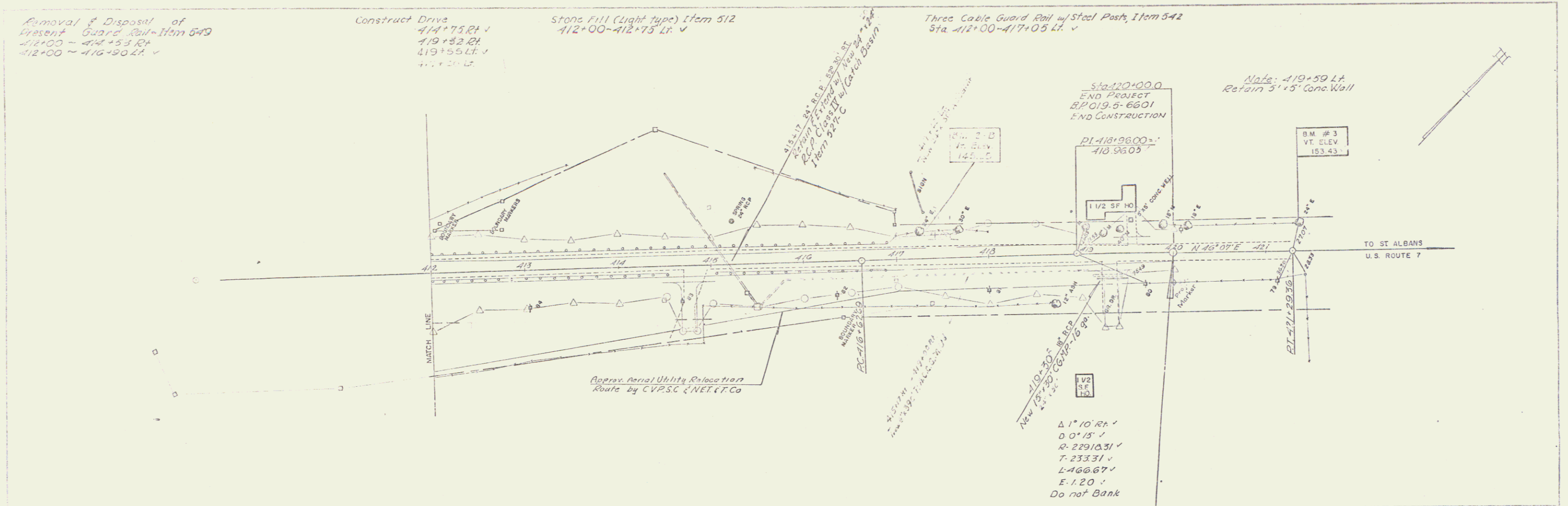

GEORGIA - ST. ALBANS  
 PROJ. B.P. NO. 019-5-6601  
 SHEET 8 OF 64

6