

INDEX OF SHEETS

SHEET NO	TITLE PAGE
2	TYPICAL CROSS-SECTION OF IMPROVEMENT
3	PLAN AND PROFILE STA. 0+00 TO STA. 15+00
4	" " " " 15+00 " " 31+00
5	" " " " 31+00 " " 47+00
6	" " " " 47+00 " " 59+37.9
7-14	CROSS SECTIONS

FED. ROAD DIST. NO.	STATE	FED. AID PROJ. NO.	FISCAL YEAR	SHEET NO.	TOTAL SHEETS
3	V.T.			1	14

STATE OF VERMONT  
STATE HIGHWAY DEPARTMENT

PLAN AND PROFILE OF PROPOSED  
STATE HIGHWAY

FEDERAL AID PROJECT  
TOWNS OF  
THETFORD AND FAIRLEE  
CONNECTICUT RIVER ROAD  
FROM PALMER CROSSING TO ELY CROSSING

SCALES { PLAN 1 INCH = 50 FEET  
PROFILE HORIZONTAL 1 IN. = 50 FT. VERT. 1 IN. = 10 FT.  
CROSS SECTIONS 1 IN. = 5 FT.

Route: US 5  
Project: F# 3,4,5,6

Pin# 99R383

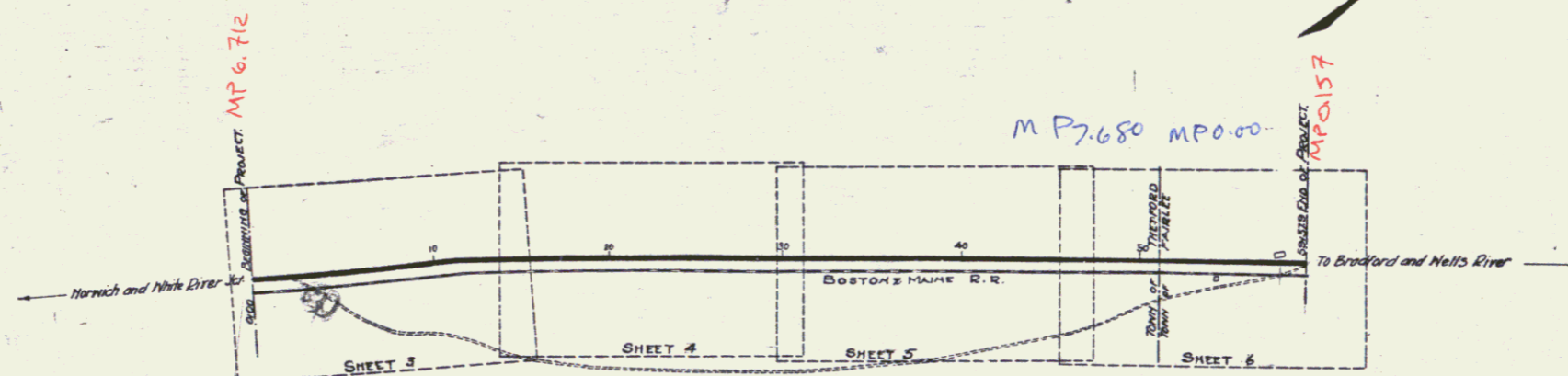

LAYOUT  
SCALE 1 INCH = 500 FEET

CONVENTIONAL SIGNS

COUNTY LINE	---	GROUND ELEVATION	DATA	SCALE
TOWN LINE	---	GRADE ELEVATION	DATA	SCALE
FENCE LINE	---			
STONE WALL	---			
UNFENCED PROPERTY	---			
RAILROAD	---			
RAILROAD	---			
RETAINING WALL	---			
CENTER & SURVEY LINE	---			
CULVERT	---			
DROP INLET	---			
TROLLEY POLE	---			
POWER POLE	---			
TELEPHONE POLE	---			
TREES	---			
HEDGE	---			

CURVE DATA

DEFLECTION ANGLE	Δ
DEGREE OF CURVE	D.
RADIUS OF CURVE	R.
TANGENT DISTANCE	T.
LENGTH OF CURVE	L.
EXTERNAL DISTANCE	E.
POINT OF INTERSECTION	P. I.
POINT OF CURVE	P. C.
POINT OF TANGENT	P. T.

RIGHT-OF-WAY DIVISION  
TOWN FILE

PERPETUAL

Route of US 5  
(To Be Returned To R.O.W. Division)

SUBMITTED BY ORDER OF THE STATE HIGHWAY BOARD  
CHIEF ENGINEER  
DEPARTMENT OF HIGHWAYS  
RECOMMENDED  
DISTRICT ENGINEER  
BUREAU OF PUBLIC ROADS  
RECOMMENDED FOR APPROVAL  
CHIEF ENGINEER - BUREAU OF PUBLIC ROADS  
APPROVED  
DIRECTOR - BUREAU OF PUBLIC ROADS

11/12/23

Series F No. 14  
Sheet 1 of 14

DIST. # 4 PLANS

**GUARD RAIL REQUIRED**  
 On Left  
 Sta 3+00 to Sta 6+00 Length 240 ft.  
 Sta 7+24 to Sta 8+60 Length 136 ft.  
 On Right  
 Sta 3+33 to Sta 5+25 Length 192 ft.  
 Sta 7+24 to Sta 8+60 Length 136 ft.  
 Total this sheet 704 ft.

**New Culverts Required**  
 Sta 4+00 Double 3x3 Concrete  
 1-2-4 Concrete 27.1 Cu Yds  
 1-2-5 Concrete 29.5 Cu Yds  
 Sta 7+55 3x3 Concrete  
 1-2-4 Concrete 19.9 Cu Yds  
 1-2-5 Concrete 22.9 Cu Yds

PER. ROAD DIST. NO.	STATE	PER. AID PROJ. NO.	FISCAL YEAR	SHEET NO.	TOTAL SHEETS
9	VA.			3	14

PLAN  
 SHEET NO. 3  
 DATE 10/15/54  
 DRAWN BY G.L. PALMER  
 CHECKED BY G.L. PALMER

VERTICAL CURVE  
 SHEET NO. 2  
 DATE 10/15/54  
 DRAWN BY G.L. PALMER  
 CHECKED BY G.L. PALMER

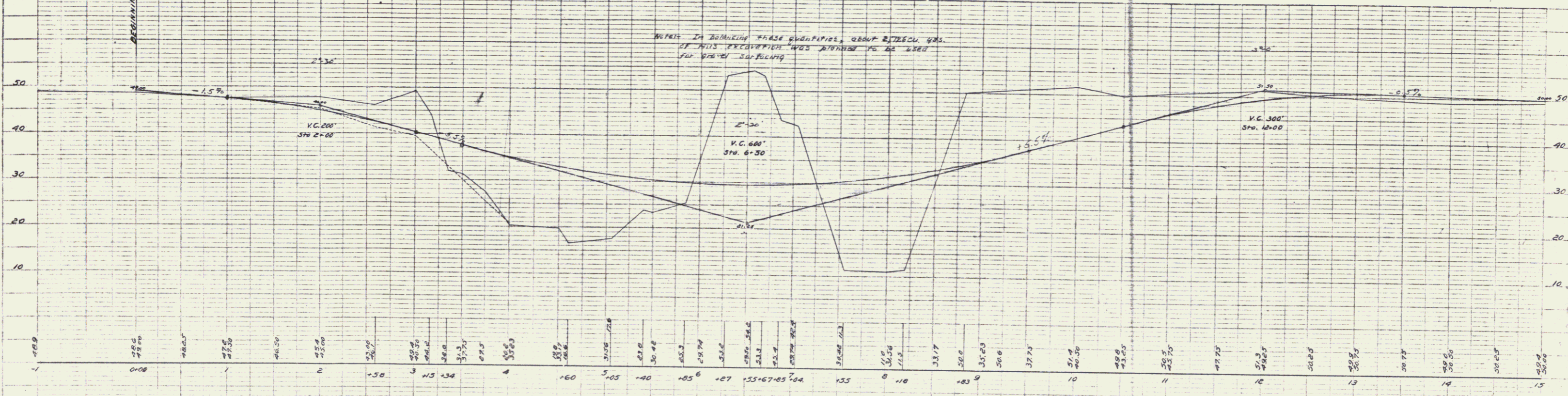
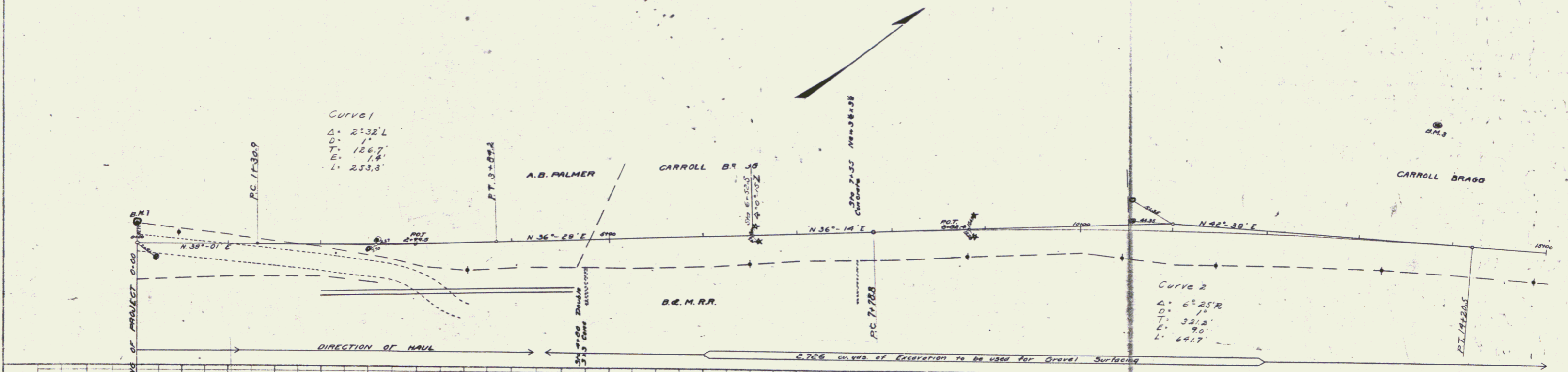

B.M. #1 Spike in 20' Birch Left of Sta 0+00 Elev. 50.00  
 B.M. #2 NW corner of base of Block Signal Right of Sta 2+50 Elev. 36.64  
 B.M. #3 Spike in 20' Oak Left of Sta 13+74 Elev. 49.70

Series F. No. Filed  
 Sheet 3 of 14

**GUARD RAIL REQUIRED**  
 On Left  
 Sta. 18+38 to Sta. 18+62 Length 24'  
 Sta. 25+00 to Sta. 26+12 Length 24'  
 On Right  
 Sta. 18+38 to Sta. 18+62 Length 24'  
 Sta. 25+00 to Sta. 26+12 Length 24'  
 Total this sheet 96'

**NEW CULVERTS REQUIRED**  
 Sta 18+50 12" Corr Iron Pipe 26'  
 1-2 1/2-3 Concrete Headwalls 1 cu yd.  
 Sta 26+00 12" Corr Iron Pipe 26'  
 1-2 1/2-3 Concrete Headwalls 1 cu yd

PER. ROAD DIST. NO.	STATE	PER. ROAD PROJ. NO.	YEAR	SHEET NO.	TOTAL SHEETS
9	VT.			4	14

PLAN  
 DRAWN BY: M.E. WARD  
 CHECKED BY: G.L. BOND  
 DATE: 1/15/78

PLAN  
 DRAWN BY: M.E. WARD  
 CHECKED BY: G.L. BOND  
 DATE: 1/15/78

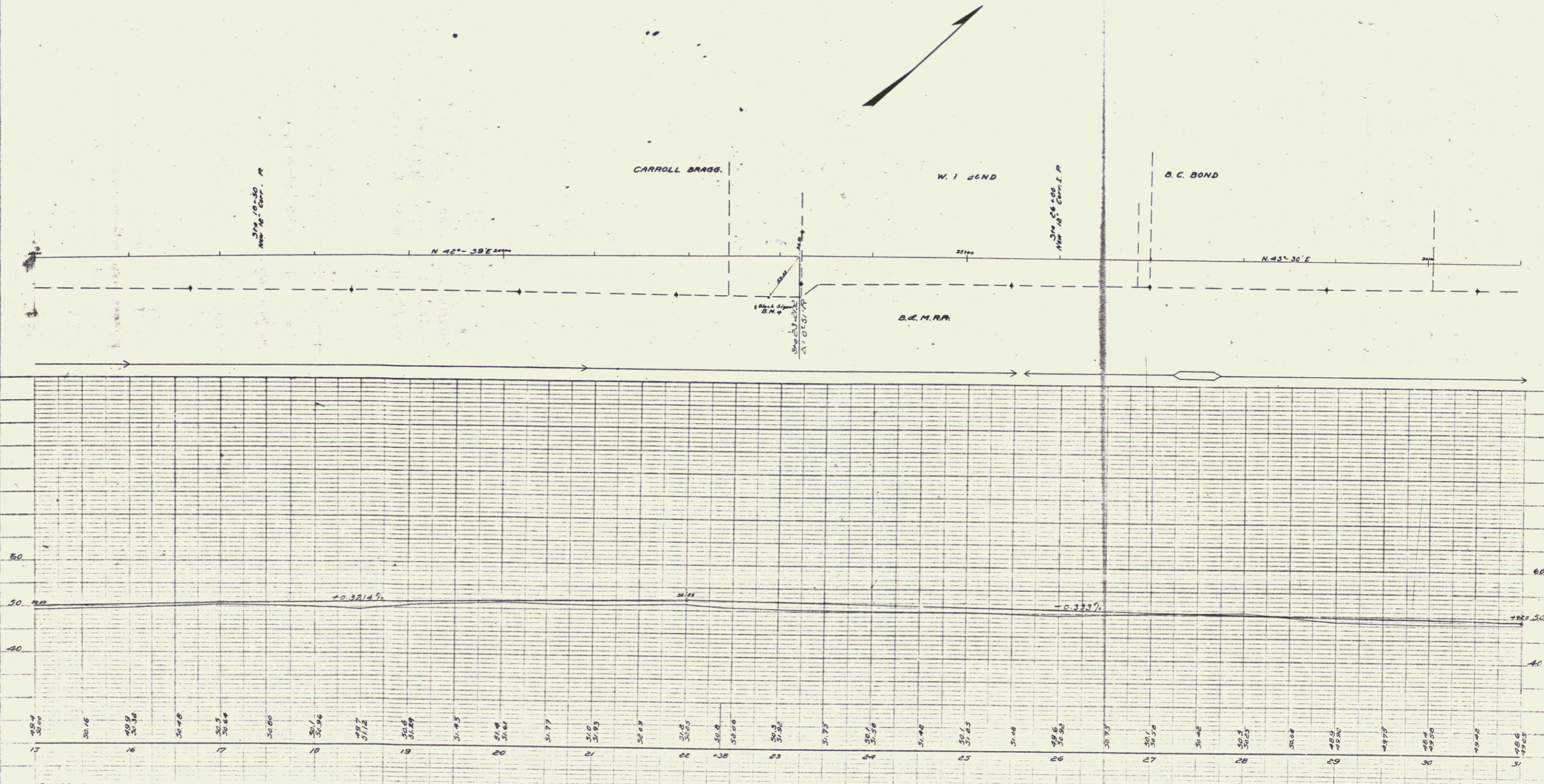

B.M. 4 N.W. corner of base of Block Signal, Right of Sta. 22+73 Elev. 44.95

Series F No. Filed  
 Sheet 4 of 14

PLAN  
 DATE: 1/1/1914  
 BY: G.L. FRANK  
 CHECKED: G.L. FRANK

PROFILE  
 DATE: 1/1/1914  
 BY: G.L. FRANK  
 CHECKED: G.L. FRANK

**GUARD RAIL REQUIRED**  
 On Left  
 Sta 35+38 to Sta 35+62 Length 24'  
 Sta 40+08 to Sta 41+12 Length 24'  
 On Right  
 Sta 35+38 to Sta 35+62 Length 24'  
 Sta 40+08 to Sta 41+12 Length 24'  
 Total this sheet 96'

**NEW CULVERTS REQUIRED**  
 Sta 35+30 12" Corr. Iron Pipe 26'  
 1-2x3 Concrete Headwalls 1 cu yd.  
 Sta 41+00 12" Corr. Iron Pipe 26'  
 1-2x3 Concrete Headwalls 1 cu yd.

PROJ. NO.	STATE	PROJ. YEAR	SHEET NO.	TOTAL SHEETS
8	VT.		2	14

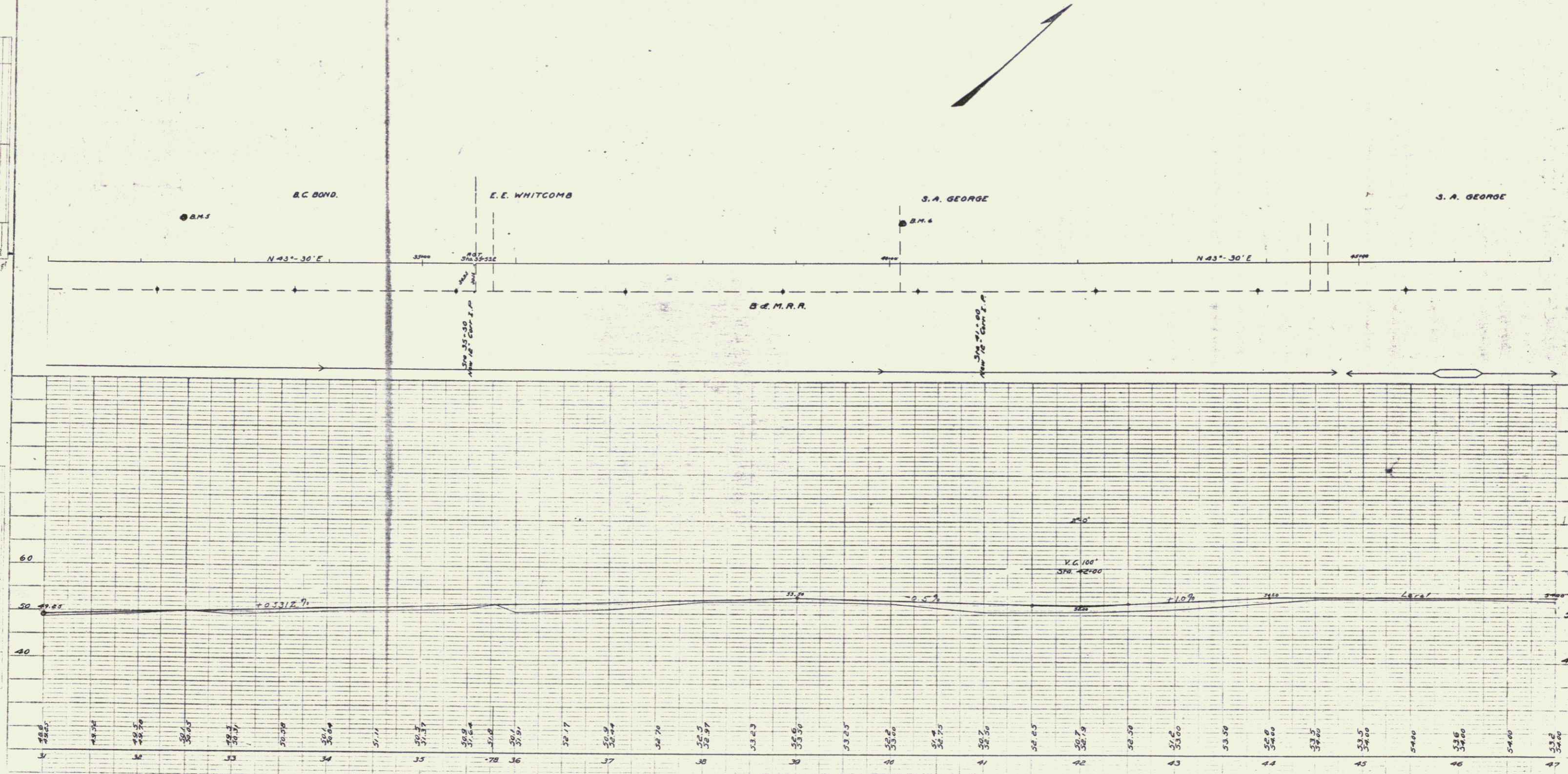

B.M. 5 Spike in Root of 24" Elm Left of Sta. 32+45 Elev. 52.27  
 B.M. 6 " 10" Birch Left of Sta. 40+11 Elev. 52.49

Series F No. Filed  
 Sheet 2 of 14

