

**GUARD RAIL REQUIRED**  
 On Left  
 Sta 3+00 to Sta 6+00 Length 240 ft.  
 Sta 7+24 to Sta 8+60 Length 136 ft.  
 On Right  
 Sta 3+33 to Sta 5+25 Length 192 ft.  
 Sta 7+24 to Sta 8+60 Length 136 ft.  
 Total this sheet  
 704 ft.

**New Culverts Required**  
 Sta 4+00 Double 3x3 Concrete  
 1-2-4 Concrete 27.1 Cu Yds  
 1-28-3 Concrete 29.5 Cu Yds  
 Sta 7+55 3x3 Concrete  
 1-2-4 Concrete 19.9 Cu Yds  
 1-28-3 Concrete 22.9 Cu Yds

PER. ROAD DIST. NO.	STATE	PER. AID PROJ. NO.	FISCAL YEAR	SHEET NO.	TOTAL SHEETS
9	VA.			3	14

PLAN  
 SHEET NO. 3  
 DATE 10/15/54  
 DRAWN BY G.L. PALMER  
 CHECKED BY G.L. PALMER

VERTICAL  
 SHEET NO. 2  
 DATE 10/15/54  
 DRAWN BY G.L. PALMER  
 CHECKED BY G.L. PALMER

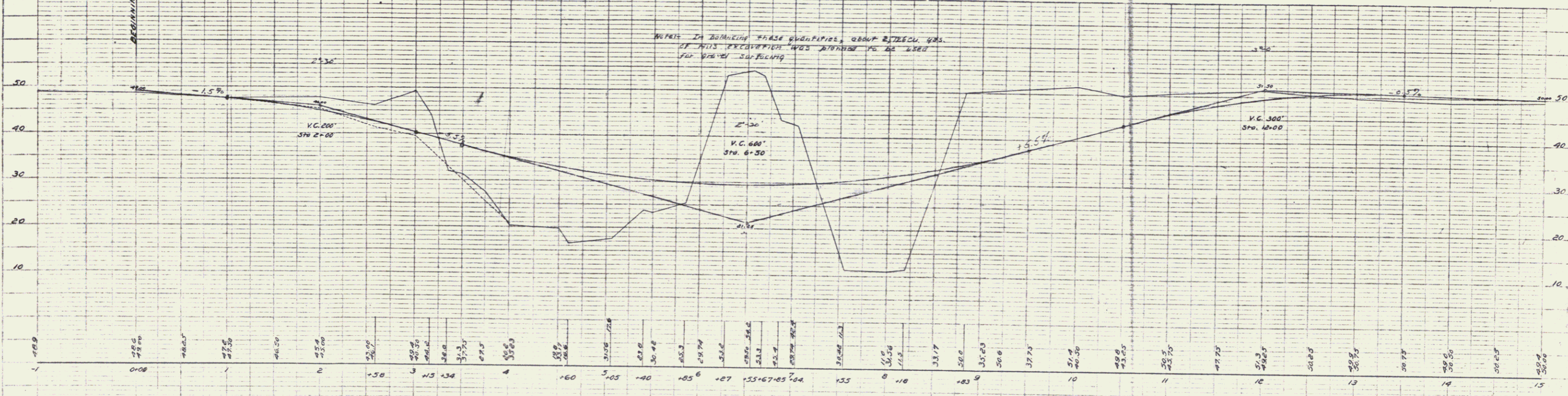
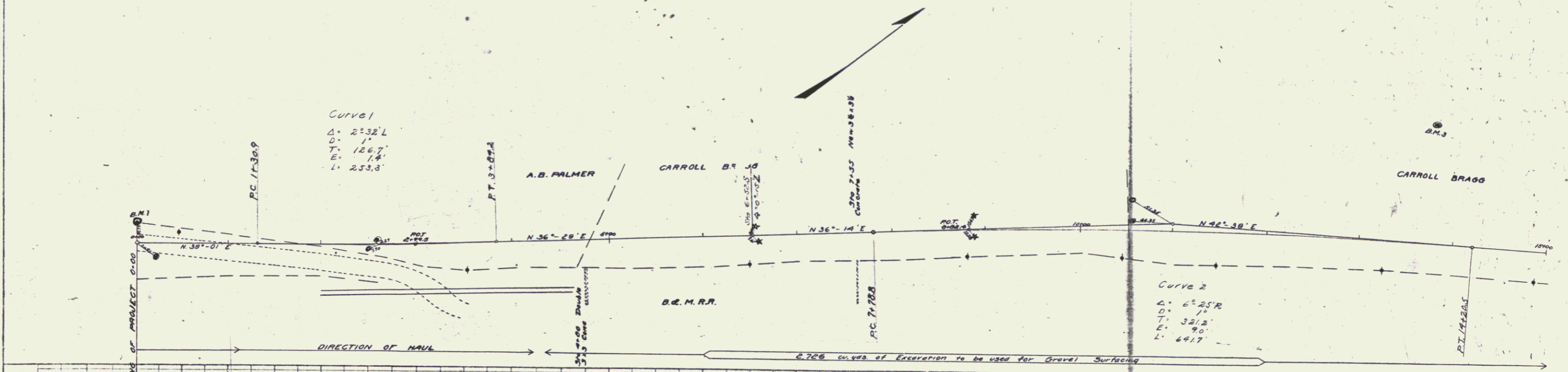

B.M. #1 Spike in 20' Birch Left of Sta 0+00 Elev. 50.00  
 B.M. #2 NW corner of base of Block Signal Right of Sta 2+50 Elev. 36.64  
 B.M. #3 Spike in 20' Oak Left of Sta 13+74 Elev. 49.70

Series F. No. Filed  
 Sheet 3 of 14