

INDEX OF SHEETS

SHEET NO. 1	TITLE PAGE
" 2	TYPICAL CROSS-SECTION OF IMPROVEMENT
" 3	BANKING AND WIDENING TABLES
" 4-6	PLAN AND PROFILE
" 7	BARRICADES, SIGNS, AND LIGHTS SB-11

GRAVEL MIXED-IN-PLACE SURFACE COURSE

FED. ROAD DIST. NO.	STATE	A.D.M. PROJ. NO.	FISCAL YEAR	SHEET NO.	TOTAL SHEETS
9	VT	114-B	1932	1	7

STATE OF VERMONT
STATE HIGHWAY DEPARTMENT

PLAN AND PROFILE OF PROPOSED
STATE HIGHWAY

FEDERAL AID PROJECT

TOWN OF THETFORD
CONNECTICUT RIVER ROAD

Route: US5
Project: NR# 114-B

FROM 2700 FEET SOUTH OF RR CROSSING
SOUTH 0.426 MILES

Pin# 99R 381

LENGTH OF PROJECT 2250.9 FEET 0.426 MILES

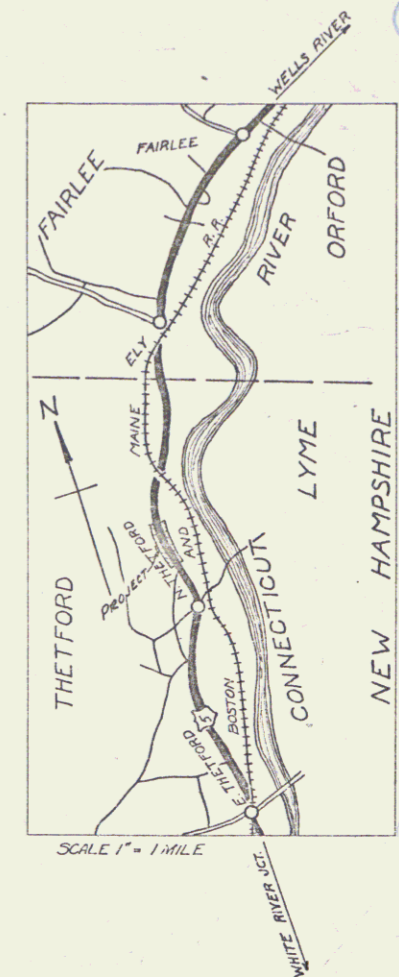

(To Be Returned To R.O.W. Division)
Town of US5
THERETVAL
TOWN FILE
RIGHT-OF-WAY DIVISION

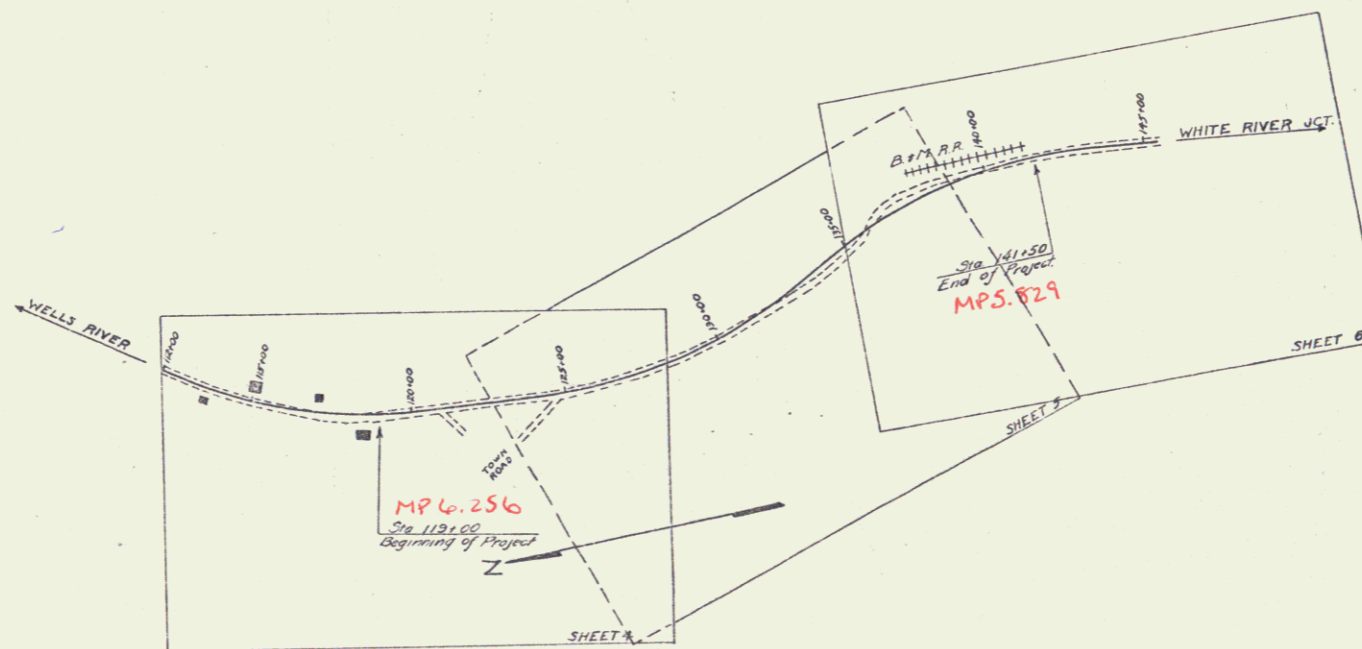

CONVENTIONAL SIGNS

COUNTY LINE	GROUND ELEVATION
TOWN LINE	GRADE ELEVATION
FENCE LINE	
STONE WALL	
UNFENCED PROPERTY	
GUARD RAIL	
TRAVELED WAY	
RAILROAD	
RETAINING WALL	
CENTER LINE	
SURVEY LINE	
CULVERT	
DROP INLET	
TROLLEY POLE	
POWER POLE	
TELEPHONE POLE	
TREES	
HEDGE	

CURVE DATA

DEFLECTION ANGLE	Δ
DEGREE OF CURVE	D
RADIUS OF CURVE	R
TANGENT DISTANCE	T
LENGTH OF CURVE	L
EXTERNAL DISTANCE	E
POINT OF INTERSECTION	P. I.
POINT OF CURVE	P. C.
POINT OF TANGENT	P. T.
POINT ON TANGENT	P. O. T.

SCALES

TITLE PAGE	1" = 300'
PLAN SHEETS	1" = 30'
PROFILE	1" = 10'
CROSS SECTIONS	1" = 5'

These Plans are subject to such revisions as may be required by the Bureau of Public Roads, or the Commissioner of Highways. Construction is to be carried on in accordance with the Standard Road and Bridge Specifications of 1930, with all subsequent approved revisions and such specifications and special provisions as are submitted with the plans.

APPROVED Oct 21, 1932 & Aug 11, 1933
W. E. Saugust
Commissioner of Highways

RECOMMENDED
DISTRICT ENGINEER
BUREAU OF PUBLIC ROADS
RECOMMENDED FOR APPROVAL
CHIEF ENGINEER
BUREAU OF PUBLIC ROADS
APPROVED
DIRECTOR, BUREAU OF PUBLIC ROADS

CORRECT
ROAD ENGINEER
SERIES NO. 114-B FILED
SHEET 1 OF 7

DIST # 4 Plans