

REINFORCED CONCRETE BOX CULVERTS
 STATION SIZE CONC. REIN. STEEL STRK. LENA
 121+40 3'x6' 21.57' 3741' 51.7'

DRIVEWAY PIPE CULVERTS
 STATION LANE TYPE SIZE LENG. GRM
 120+73 RT RC.P. 12" 24' 23.7'
 121+50 RT C.M.P., D.C. 15" 40' 27.4'

| | | | |
|--------|-----|------|------------|
| N.A.M. | | | |
| 190 | 195 | 4 | 70 |
| 9 | VT | 1140 | 1288 10 40 |

PARCEL KIND OF DATE OF GRANTEE GRANTEE RECORDED REMARKS
 INSTRUMENT
 ABCDEF W-D. 11-30-32 A.B. & J. PALMER ST. OF VT. 32 100-181-182 12-3-32

REV. CURVE
 Δ 31° 35' 12"
 D 31° 30'
 R 1637.3
 T 463.0
 L 902.4
 E 64.0

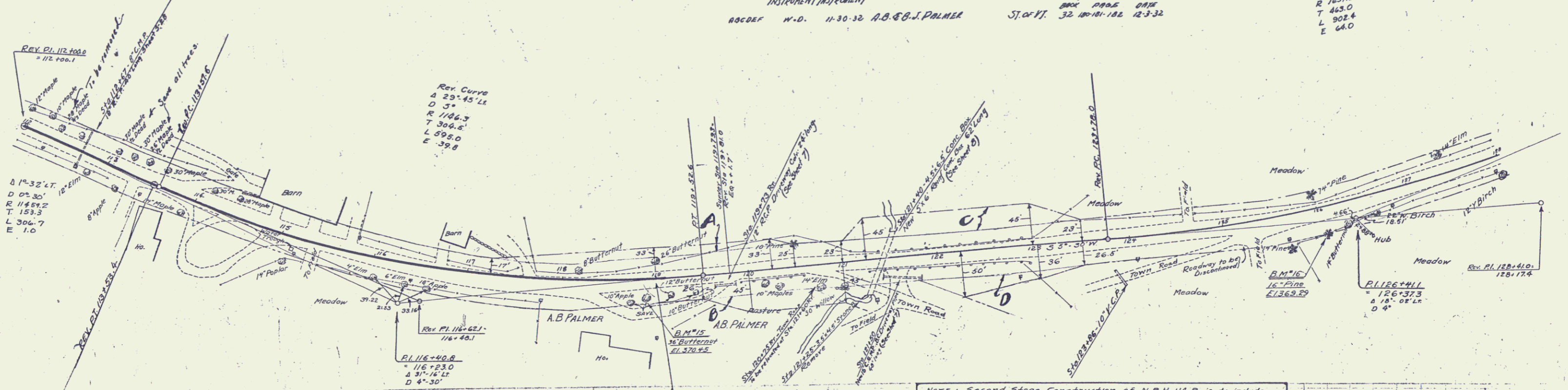

NOTE: Second Stage Construction of N.R.H. 114-B is to include construction of Surface Course and Shoulders. Grading, Base, Guard Rail and Culverts have been constructed as First Stage of Project E 114-B by Fore Account in 1932. Grades given on Layouts from Sta. 119+00 to 121+50 are for top of Subgrade. Add 0.21 feet to Finished Grades for Top of Surface. All Base and Culverts as noted on Layouts refer to First Stage Construction.

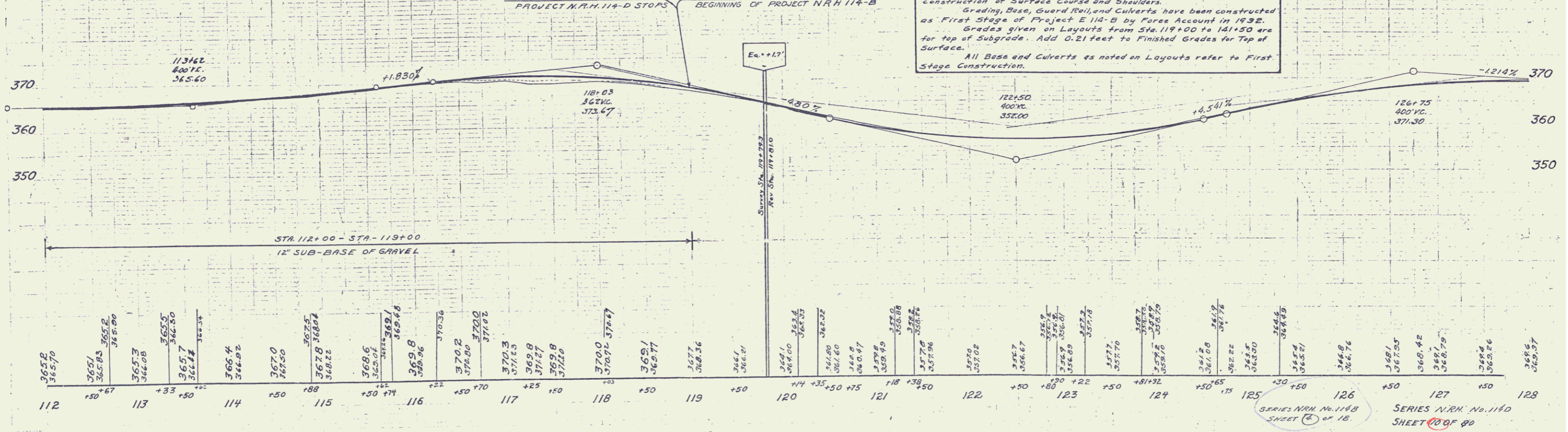

B.M. #15 Spike in Root 36' Butternut 19.5' Rt. Sta. 118+89 El. 370.45
 B.M. #16 16" Pine 2.3 Rt. Sta. 126+08 El. 369.23

SERIES N.R.H. No. 114-B
 SHEET 10 OF 18
 SERIES N.R.H. No. 114-D
 SHEET 10 OF 40