

**INDEX OF SHEETS**

SHEET NO.	PAGE	DESCRIPTION
1	1	CROSS-SECTION OF IMPROVEMENT 2 1/2" GRUNDED GRAVEL MIXED-IN-PLACE SURFACE COURSE WITH REFINED TAR, CLASS C, ITEM 341
2	2	UTILITY SHEET (ITEMS AND DRAINAGE)
3	3	WORK SHEETS
4-5	4-5	AND PROFILE
6	6	PILES OF 180" METAL PLATE PIPE
7	7	GUARD RAIL STRUCTURE SHEET S-40 BARRICADES, SIGNS AND LIGHTS.
8	8	GUARD RAIL STRUCTURE SHEET S-41 ROUNDING OF SLOPES
9	9	GUARD RAIL STRUCTURE SHEET S-46-45 BOUNDARY MARKERS
10	10	GUARD RAIL STRUCTURE SHEET S-47-45 PIPE CULVERTS
11	11	GUARD RAIL STRUCTURE SHEET S-48-46 GUARD RAIL
12	12	SECTION
13-14	13-14	CROSS SECTIONS
15-17	15-17	SECTIONS

STANDARD STRUCTURE SHEETS APPROVED BY THE CHIEF ENGINEER, VERMONT STATE DEPARTMENT OF HIGHWAYS.

S-40 FEB. 28, 1949  
 S-45 FEB. 28, 1949  
 S-46 FEB. 28, 1949  
 S-47 MAY 13, 1946

(To Be Returned To R.O.W. Division)  
 Form of U.S.  
 PERPETUAL  
 TOWN FILE  
 RIGHT-OF-WAY DIVISION

STATE OF VERMONT  
 STATE HIGHWAY DEPARTMENT

PLAN AND PROFILE OF PROPOSED  
 STATE HIGHWAY  
 FEDERAL PROJECT  
 TOWN OF THETFORD  
 COUNTY OF ORANGE  
 WHITE RIVER JCT.-BRADFORD ROAD  
 U.S. ROUTE 5 Pin # 992 377

FED. ROAD DIV. NO.	STATE	PROJ. NO.	SHEET NO.	TOTAL SHEETS
1	VT.	F 114 (14)	1	17

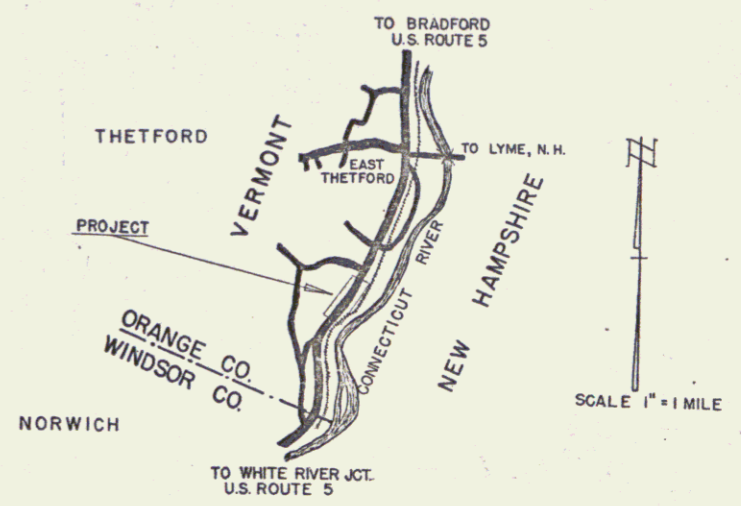

BEGINNING AT A POINT APPROXIMATELY 1.62± MILES NORTH OF THE THETFORD-NORWICH TOWN LINE AND EXTENDING SOUTHERLY 1,000 FEET.

LENGTH OF PROJECT 1,000 FT. = 0.189 MI.

PROJECT NAME AND NUMBER	TYPE	PAVEMENT AREA
THETFORD F 114 (14)	CRUSHED GRAVEL, 2 1/2" OVERLAY, 1 1/2" BASE, 1 1/2" SUB-BASE	2,933 S.Y.
RECORD PLANS		
MATERIALS		
BORROW	D. TILLEN FIT METAL GUARD RAIL, BLACK P.T. BARRIERS	
GRAVEL	COLLIERIE, VT. GUARD RAIL WHITE P.T. FRANKLIN, VT.	
TAR	SHARPLEY CO. WAREHOSE, MASS. RIPRAP AT U.S. ROUTE 5, THETFORD, VT.	
CRUSHED GRAVEL	SHARPLEY CO. WAREHOSE, MASS. RIPRAP AT U.S. ROUTE 5, THETFORD, VT.	
ACCGMP	BERGER METAL CULV. CO.	
160°CG.M.P.D.	BERGER METAL CULV. CO.	
GUARD RAIL CABLE	BERGER METAL CULV. CO.	
CONTRACTOR	LUCIEN DEMERS	CONTRACT DATED AUG. 16, 1950.
RES. ENGINEER	D.R. BOZONE	CONTRACT STARTED AUG. 19, 1950.
INSPECTOR		CONTRACT COMPLETED JULY 31, 1951.
RECORD PLANS BY	BASSACRE ENGINEERS	CONTRACT ACCEPTED JULY 31, 1951.

ANY FURTHER INFORMATION CONCERNING FINAL QUANTITIES AMOUNTS OR OTHER DETAILS RELATIVE TO THIS PROJECT MAY BE FOUND IN EITHER THE FIELD BOOK OR THE ESTIMATE FILE.

APPROVED: *June 9, 1950*  
*H. E. Sargent*  
 CHIEF ENGINEER  
 SUBMITTED BY ORDER OF THE STATE HIGHWAY BOARD

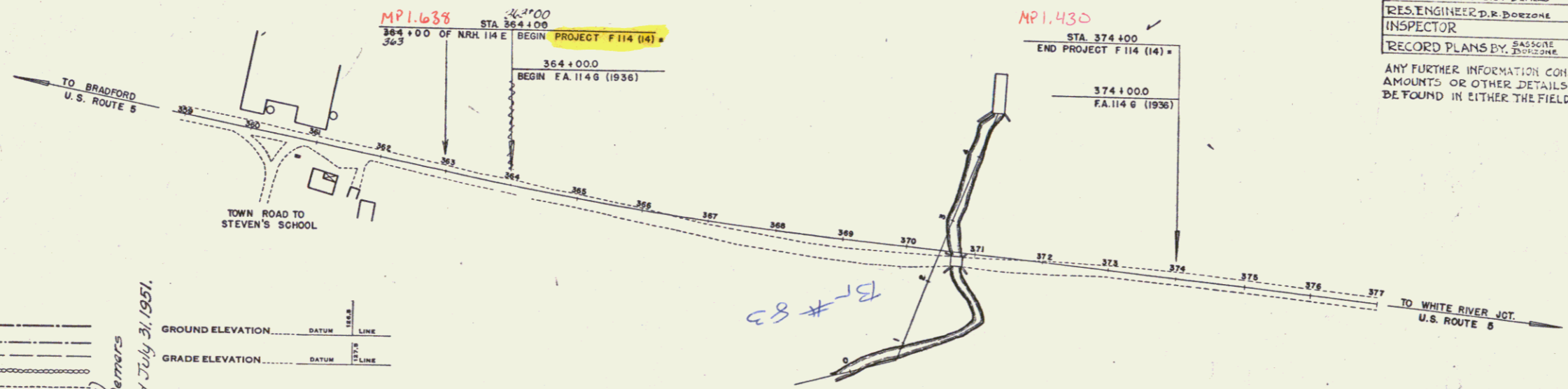

CURVE DATA	
DEFLECTION ANGLE	Δ
DEGREE OF CURVE	D
RADIUS OF CURVE	R
TANGENT DISTANCE	T
LENGTH OF CURVE	L
EXTERNAL DISTANCE	E
POINT OF INTERSECTION	P. I.
POINT OF CURVE	P. C.
POINT OF TANGENT	P. T.
POINT ON TANGENT	P. O. T.

SCALES	
TITLE	1" = 100'
TYPICAL	1" = 5'
PLAN	1" = 50'
PROFILE HORIZONTAL	1" = 50'
PROFILE VERTICAL	1" = 10'
CROSS SECTIONS	1" = 5'

THETFORD F 114 (14)  
 Contract by Lucien Demers  
 Construction completed July 31, 1951.

CONTRACTOR: Lucien Demers  
 LOCATION: White River St. Bradford Rd.  
 U.S. Rte. 5

THESE PLANS ARE SUBJECT TO SUCH REVISIONS AS MAY BE REQUIRED BY THE BUREAU OF PUBLIC ROADS OR THE COMMISSIONER OF HIGHWAYS.

CONSTRUCTION IS TO BE CARRIED ON IN ACCORDANCE WITH THE PLANS AND THE STANDARD ROAD AND BRIDGE SPECIFICATIONS OF PUBLIC ROADS JULY 25, 1949 BY THE BUREAU OF PUBLIC ROADS INCLUDING ALL SUBSEQUENT APPROVED REVISIONS AND SUCH REVISED SPECIFICATIONS AND SPECIAL PROVISIONS AS ARE SUBMITTED WITH THE PLANS.

DEPARTMENT OF COMMERCE  
 BUREAU OF PUBLIC ROADS

RECOMMENDED FOR APPROVAL

DISTRICT ENGINEER \_\_\_\_\_ DATE \_\_\_\_\_

APPROVED \_\_\_\_\_

DIVISION ENGINEER \_\_\_\_\_ DATE \_\_\_\_\_

APPROVED: <i>June 8, 1950</i> A. W. Mansett HIGHWAY ENGINEER	APPROVED: <i>June 23, 1950</i> [Signature] DISTRICT HIGHWAY COMMISSIONER	SERIES F No. 11409 FILED SHEET 1 OF 17
--	--	--

10 Thetford