

Granite Slope Edging  
Item No. 556-A  
20+00 to 18+52 Lt. Line "A"  
17+15 to 18+50 Lt. Line "A"  
17+20 Lt. Sta. 5 to 17+22 Lt. Sta. 5 (Move)  
13+86 Lt. to 14+38 Lt. Spur Line (Move)

Channel Excavation of Earth  
Item No. 106-A  
23+50 Lt. to 24+00 Lt. Spur Line

SEEDING, ITEM 611  
COMMERCIAL FERTILIZER FOR GRASSES, ITEM 615  
TOPSOIL, ITEM 621  
16+17 - 18+52 LINE "A" ISLAND

CONSTRUCT DRIVES  
20+40 LT BRT

Three Cable Guard Rail with Steel Posts,  
Item No. 553  
20+00 to 25+00 Lt.  
20+00 to 25+00 Rt.

Bituminous Concrete Cure  
Item No. 555  
20+00 to 25+00 Rt.

BITUMINOUS CONCRETE GUTTER ITEM 361-B  
20+50 RT

PUB. NO.	STAT.	FED. AID PROJECT NO.	FISCAL YEAR	SHEET NO.	TOTAL SHEETS
1	VT	F 341-1	1980	13	68

Δ 6° 55' 43" RT  
D 98'  
R 1145.9'  
T 683.0'  
L 1021.9'  
E 188.2'  
BANK 15/16' PER FT.

CONSTRUCT APPROACH  
13+50 RT

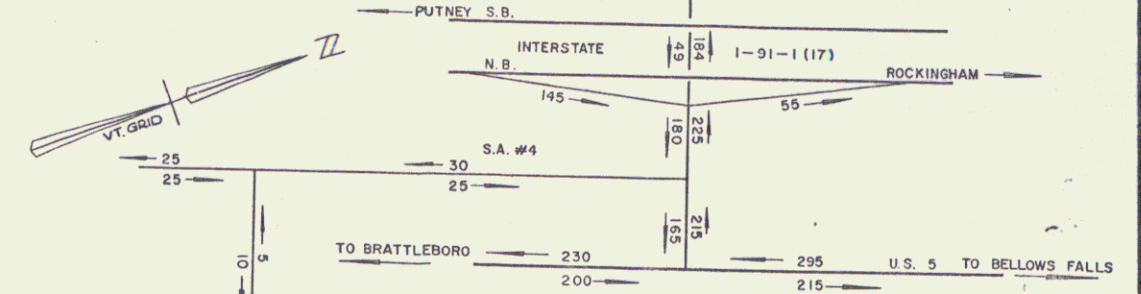

\* STAGE 2 CONSTRUCTION

PARCEL: 103  
GRANTOR: JOHN H. ALLEN, ET ALS  
D/B/A ALLEN BROS.  
STATIONS: 10+83 - 13+29 ± S.L.  
TAKING: 0.141  
REMAINDER: 14.941  
RIGHTS: NONE  
TITLE TAKEN: COND. 9/28/67  
RECORDED: WESTMINSTER BK 50 PG. 143-146  
10/10/61

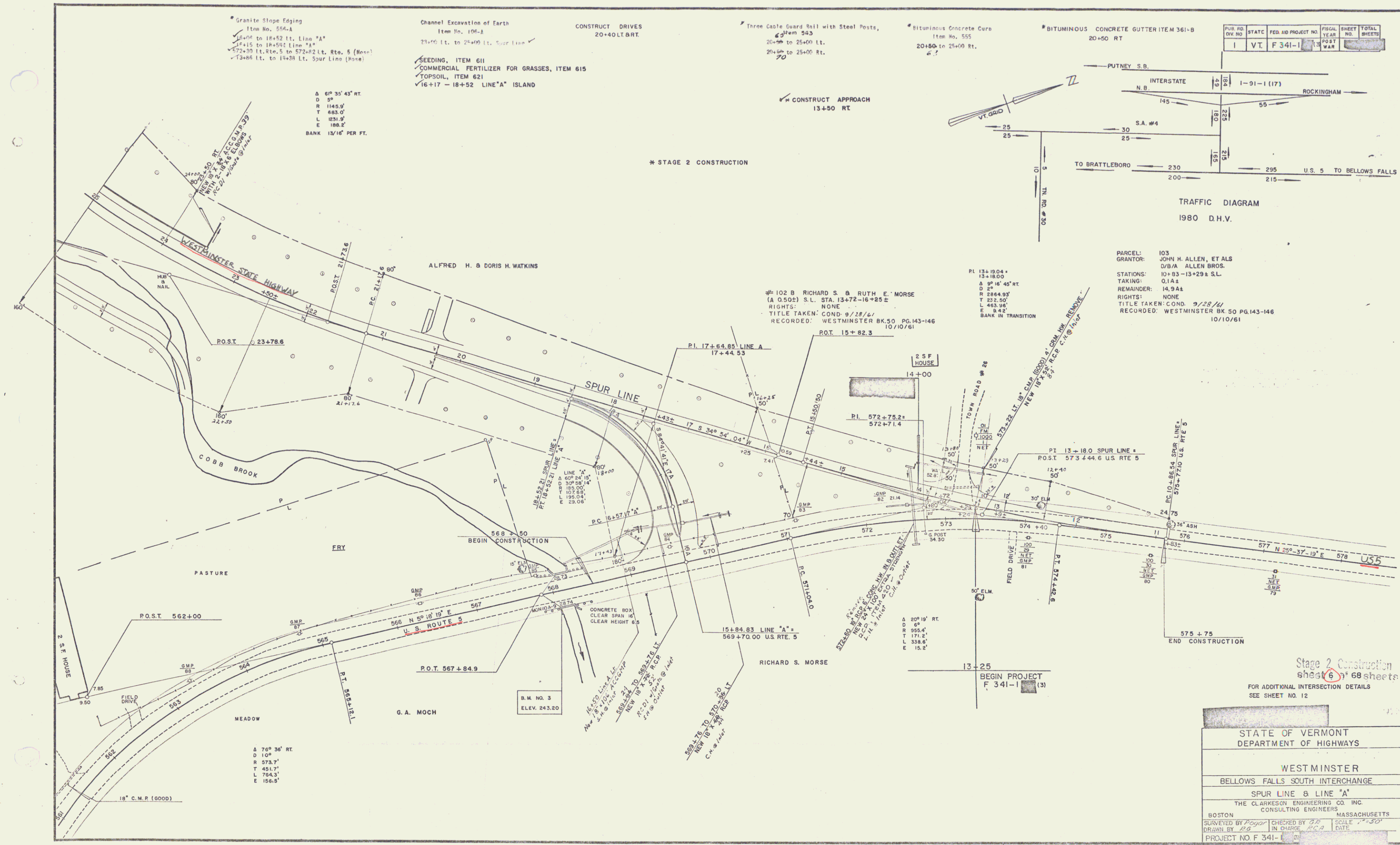

Stage 2 Construction  
Sheet (6) of 68 sheets

FOR ADDITIONAL INTERSECTION DETAILS  
SEE SHEET NO. 12

STATE OF VERMONT  
DEPARTMENT OF HIGHWAYS

WESTMINSTER  
BELLOWS FALLS SOUTH INTERCHANGE  
SPUR LINE & LINE "A"

THE CLARKSON ENGINEERING CO. INC.  
CONSULTING ENGINEERS  
BOSTON MASSACHUSETTS

SURVEYED BY *P. G. G.* CHECKED BY *P. G. G.* SCALE 1" = 30'  
DRAWN BY *P. G. G.* IN CHARGE *P. G. G.* DATE

PROJECT NO. F 341-1 (3)