

**WOOD GUARD RAIL REQUIRED**  
 ON RIGHT  
 Sta. 89+88 to Sta. 90+12 24 lin. ft.  
 ON LEFT  
 Sta. 81+88 to Sta. 82+12 24 lin. ft.  
 - 89+88 - 90+12 24 - -

**CABLE GUARD RAIL REQUIRED**  
 ON RIGHT  
 Sta. 81+25 to Sta. 82+21 96 lin. ft.

**NEW CULVERTS REQUIRED**  
 Sta. 88+00 18" Cast Iron Pipe Culv. 40 lin. ft.  
 Conc. Class B (1-2 1/2 - 5) 2.7 cu yds.  
 Reinforcing Steel 33 lbs.  
 Sta. 90+00 18" Cast Iron Pipe Culv. 34 lin. ft.  
 Conc. Class B (1-2 1/2 - 5) 2.7 cu yds.  
 Reinforcing Steel 33 lbs.

US. ROAD & BLDG. DIV. DATE: 1958-8-18 YEAR: 80 SHEET: 15

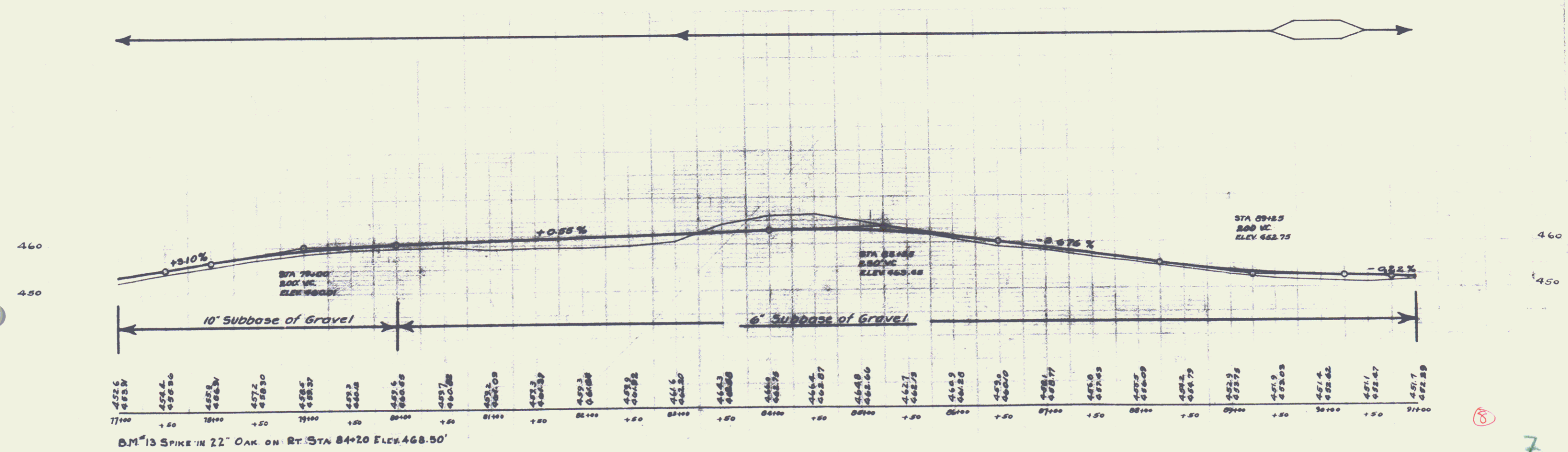
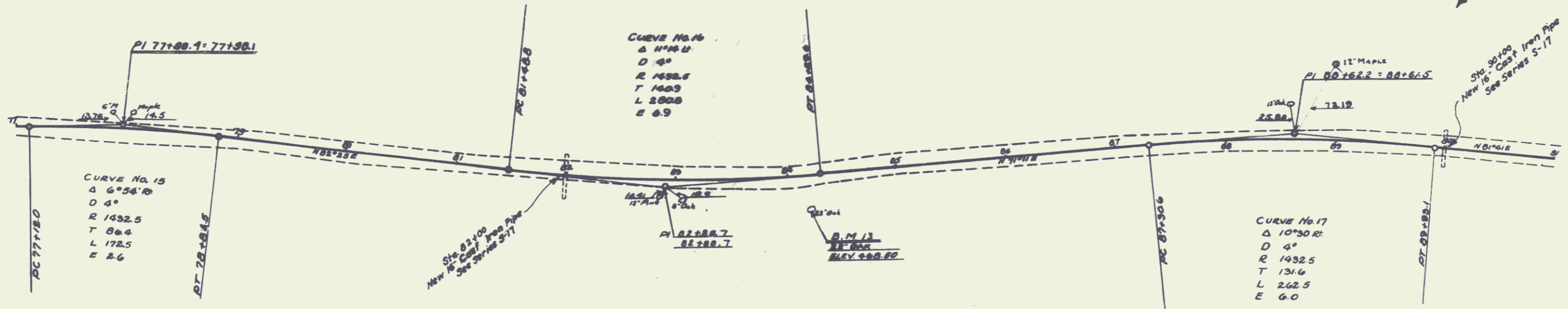

8

7