

CABLE GUARD RAIL REQUIRED
 ON RIGHT
 Sta. 14+50 to Sta. 15+00 Length 50 Ft.
 ON LEFT
 Sta. 14+50 to Sta. 15+00 Length 50 Ft.

DRIVEWAY CULVERTS REQUIRED
 Sta. 11+00 Right, 12" Corr. Galv. Metal Pipe 18 lin. ft.
 Concrete Class B (1-2 1/2-5) 1 cu. yd.
 Sta. 12+65 Right, 12" Corr. Galv. Metal Pipe 18 lin. ft.
 Concrete Class B (1-2 1/2-5) 1 cu. yd.
 Sta. 14+50 Right, 12" Corr. Galv. Metal Pipe 18 lin. ft.
 Concrete Class B (1-2 1/2-5) 1 cu. yd.

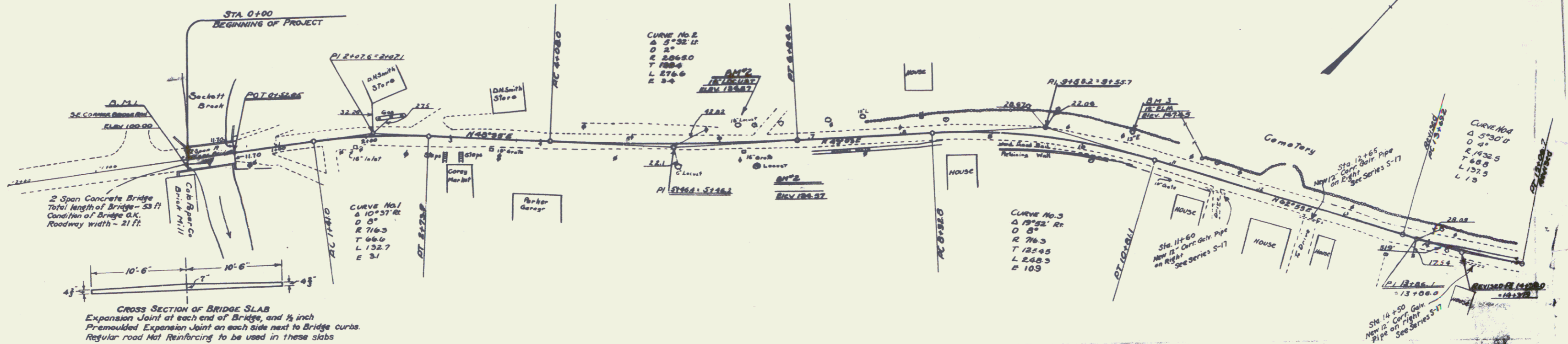

CROSS SECTION OF BRIDGE SLAB
 Expansion Joint at each end of Bridge, and 1/2 inch
 Premoulded Expansion Joint on each side next to Bridge curbs.
 Regular road Mat Reinforcing to be used in these slabs

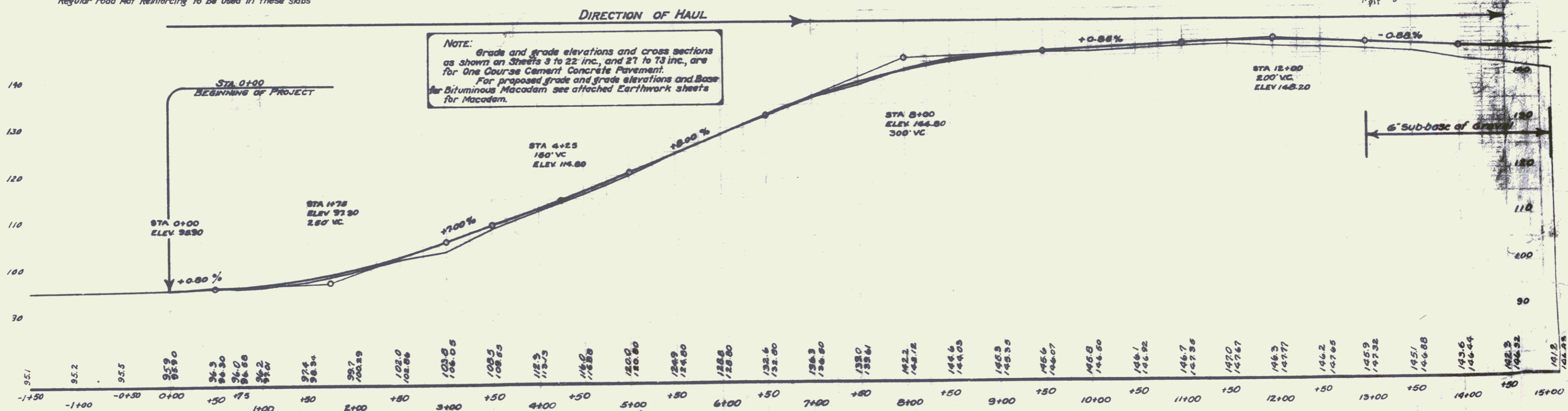

NOTE: Grade and grade elevations and cross sections as shown on Sheets 3 to 22 inc., and 21 to 73 inc., are for One Course Cement Concrete Pavement. For proposed grade and grade elevations and Base for Bituminous Macadam see attached Earthwork sheets for Macadam.

BM^{#1} ON S.E. CORNER OF BRIDGE RAIL ELEV 100'
 BM^{#2} SPIKE IN LOCUST TREE ON RT. STA 6+46 ELEV 134.57'
 BM^{#3} SPIKE IN 12' ELM ON LT. STA 10+50 ELEV 147.45'

3
2