

**INDEX OF SHEETS**

SHEET NO.	TITLE PAGE
2	TYPICAL CROSS-SECTION OF IMPROVEMENT (CONCRETE)
3	PLAN AND PROFILE STA. 0+00 TO STA. 15+00
4	15+00 - 31+00
5	31+00 - 47+00
6	47+00 - 62+00
7	62+00 - 77+00
8	77+00 - 91+00
9	91+00 - 105+00
10	105+00 - 121+00
11	121+00 - 134+00
12	134+00 - 146+00
13	146+00 - 161+00
14	161+00 - 176+00
15	176+00 - 190+00
16	190+00 - 206+00
17	206+00 - 222+00
18	222+00 - 237+00
19	237+00 - 253+00
20	253+00 - 269+00
21	269+00 - 285+00
22	285+00 - 295+25
23	
24	BRIDGE SHEETS
25	
26	
27 TO 13	CROSS SECTIONS
14-15-16	STANDARD STRUCTURE SHEETS, Nos 17-18-19

STATE OF VERMONT  
STATE HIGHWAY DEPARTMENT

PLAN AND PROFILE OF PROPOSED  
STATE HIGHWAY

FEDERAL AID PROJECT

BRATTLEBORO-BELLOWS FALLS ROAD

IN TOWNS OF  
PUTNEY AND WESTMINSTER

BEGINNING AT SACKETT'S BROOK BRIDGE IN PUTNEY VILLAGE  
EXTENDING NORTHERLY TO A POINT 4,245 FEET NORTHERLY OF  
PUTNEY-WESTMINSTER TOWN LINE

LENGTH OF PROJECT 28,461 FEET 5.579 MILES

PLAN - 1 INCH = 50 FEET  
PROFILE (HOR.) - 1 INCH = 50 FEET  
PROFILE (VERT.) - 1 INCH = 10 FEET  
CROSS SECTIONS - 1 INCH = 5 FEET

FED. ROAD DIST. NO.	ROUTE	PROJECT NO.	FISCAL YEAR	DATE	LENGTH
9	Vt.	83B	1928	1	76

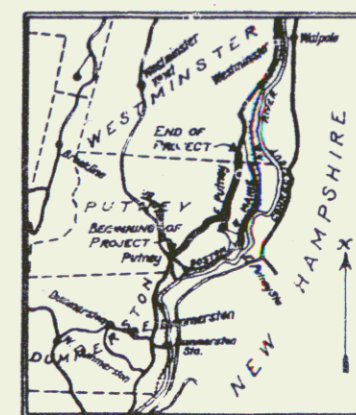

Route: US 5

Project: F83B

Pin# 59R372

DC 2/8/00

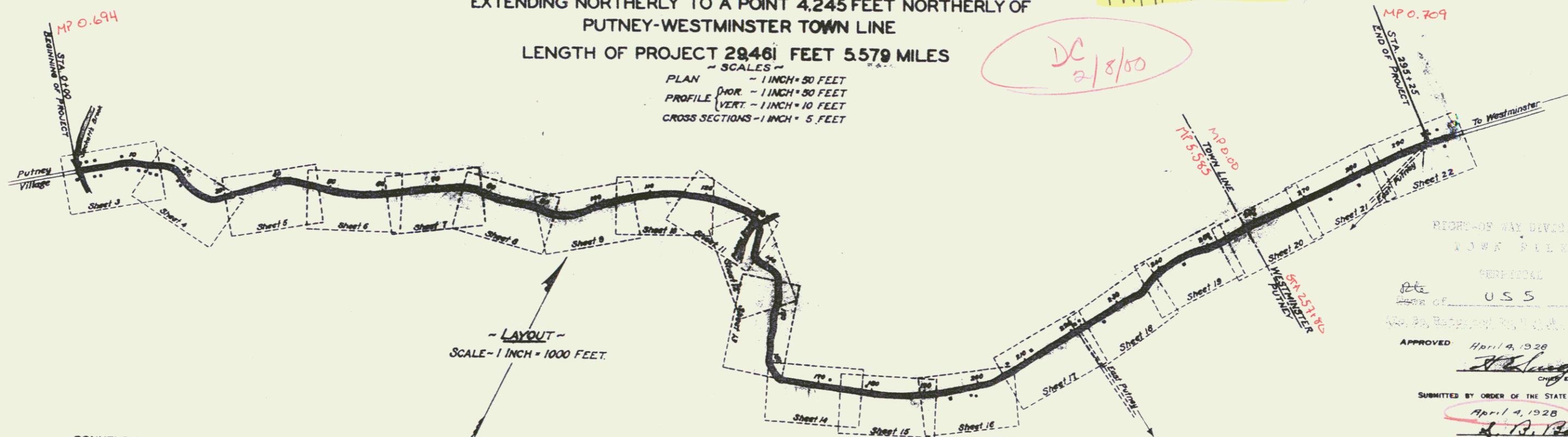

LAYOUT  
SCALE - 1 INCH = 1000 FEET

**CONVENTIONAL SIGNS**

COUNTY LINE	GROUND ELEVATION	DATE	LINE
TOWN LINE	GRADE ELEVATION	DATE	LINE
FENCE LINE			
STONE WALL			
UNFENCED PROPERTY			
HARD RAIL			
RAVELED WAY			
RAILROAD			
RETAINING WALL			
CENTER LINE			
DRIVE LINE			
VERT			
DROPPINLET			
ROLLY POLE			
PG WER POLE			
TELEPHONE POLE			
TREES			
HEDGE			

**CURVE DATA**

DEFLECTION ANGLE	Δ
DEGREE OF CURVE	D
RADIUS OF CURVE	R
TANGENT DISTANCE	T
LENGTH OF CURVE	L
EXTERNAL DISTANCE	E
POINT OF INTERSECTION	P. I.
POINT OF CURVE	P. C.
POINT OF TANGENT	P. T.
POINT ON TANGENT	P. O. T.

This project to be constructed in accordance with Standard Specifications on file with the U.S. Bureau of Public Roads as approved July 7, 1926

Structures on this project to be constructed in accordance with details given on Standard Structure Sheets, Series S, Nos 17, 18 and 19.

THESE PLANS SUBJECT TO SUCH REVISIONS AS MAY BE REQUIRED BY THE BUREAU OF PUBLIC ROADS OR THE CHIEF ENGINEER

REPORT OF WAY DIVISION  
LOWE PEEK  
FEDERAL  
ROAD OF  
U.S.S.  
APPROVED April 9, 1928  
SUBMITTED BY ORDER OF THE STATE HIGHWAY BOY  
April 9, 1928

RECOMMENDED  
DISTRICT ENGINEER BUREAU OF PUBLIC ROADS  
RECOMMENDED FOR APPROVAL  
CHIEF ENGINEER BUREAU OF PUBLIC ROADS  
APPROVED  
DIRECTOR BUREAU OF PUBLIC ROADS

SERIES F. No. 83B FILED