

INDEX OF SHEETS

SHEET NO.	TITLE PAGE
1	TYPICAL CROSS-SECTION OF IMPROVEMENT
2	BANKING AND WIDENING TABLES
3	PLAN AND PROFILE SHEETS
4	STANDARD STRUCTURE SHEET 5-28
5	STANDARD STRUCTURE SHEET 5-29
6	STANDARD STRUCTURE SHEET 5-30
7	STANDARD STRUCTURE SHEET 5-31
8	STANDARD STRUCTURE SHEET 5-34
9	CROSS SECTION SHEETS

STANDARD STRUCTURE SHEETS APPROVED  
BY THE CHIEF ENGINEER  
5-28 & 5-29 ON JULY 11, 1933  
5-30 ON AUG. 15, 1933  
5-31 ON JULY 25, 1933

STATE OF VERMONT  
STATE HIGHWAY DEPARTMENT

PLAN AND PROFILE OF PROPOSED  
STATE HIGHWAY

EMERGENCY RELIEF PROJECT

TOWN OF SPRINGFIELD

WINDSOR-BELLOWS FALLS ROAD

BEGINNING AT A POINT ABOUT 2.4 MILES SOUTH OF  
THE SPRINGFIELD-WEATHERSFIELD TOWN LINE AND  
EXTENDING SOUTHERLY 2.498 MILES.

LENGTH OF PROJECT 13,192.5 FT. = 2.498 MI.

Route: US 5  
Project: ER 2  
Pin# 99R371

FED. ROAD DIST. NO.	STATE	PROJ. NO.	YEAR	SHEET NO.	TOTAL SHEETS
9	Vt.	2	1937	1	10

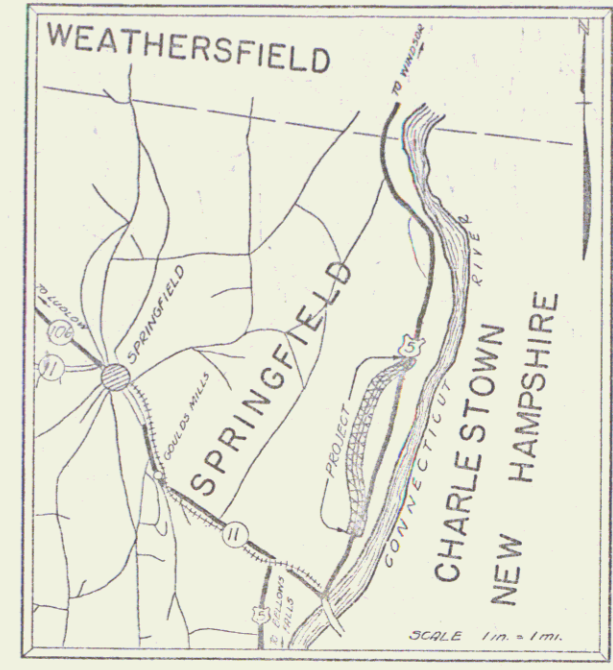

STA. 545+00.0  
BEGIN PROJECT E.R. 2  
MP 6.594

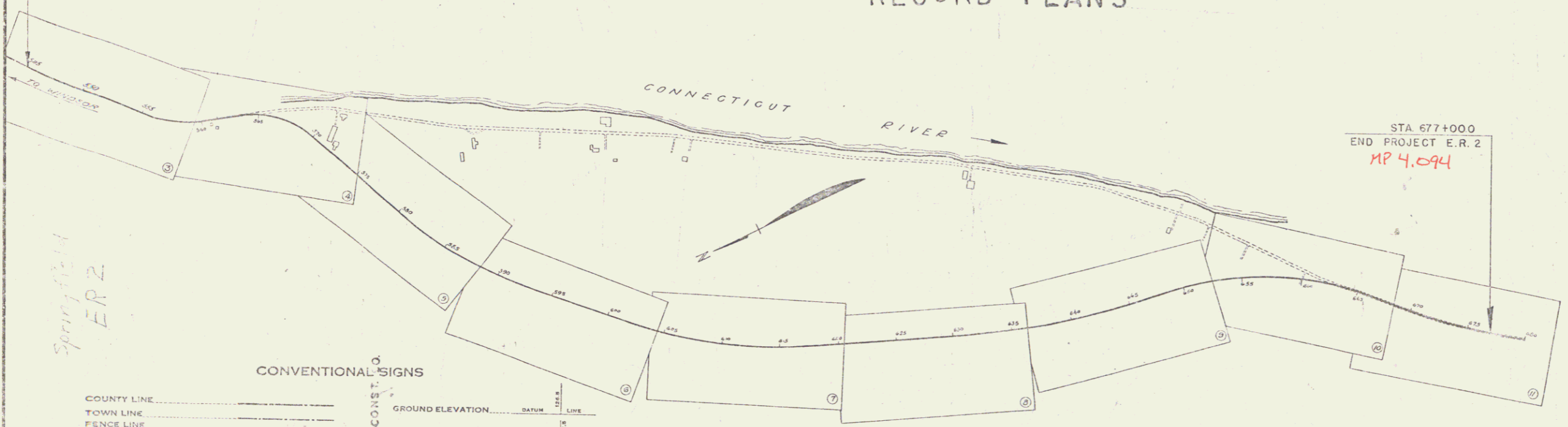

STA 677+000  
END PROJECT E.R. 2  
MP 4.094

RIGHT-OF-WAY DIVISION  
TOWN FILE  
PERPETUAL  
Town of US 5  
(To Be Returned To R.O.W. Division)

APPROVED: Feb 5, 1937  
H. H. ...  
COMMISSIONER OF HIGHWAYS  
SUBMITTED BY ORDER OF THE STATE HIGHWAY BOARD

CONVENTIONAL SIGNS

COUNTY LINE	GROUND ELEVATION
TOWN LINE	GRADE ELEVATION
FENCE LINE	
STONE WALL	
UNFENCED PROPERTY	
GUARD RAIL	
TRAVELED WAY	
RAILROAD	
RETAINING WALL	
CENTER LINE	
SURVEY LINE	
CULVERT	
DROP INLET	
TROLLEY POLE	
POWER POLE	
TELEPHONE POLE	
TREES	
HEDGE	

CURVE DATA

DEFLECTION ANGLE	Δ
DEGREE OF CURVE	D
RADIUS OF CURVE	R
TANGENT DISTANCE	T
EXTERNAL DISTANCE	E
POINT OF INTERSECTION	P. I.
POINT OF CURVE	P. C.
POINT OF TANGENT	P. T.
POINT ON TANGENT	P. O. T.

SCALES

TITLE	1 IN. = 500 FT.
TYPICAL	1 IN. = 2 FT.
PLAN	1 IN. = 50 FT.
PROFILE	1 IN. = 10 FT.
CROSS SECTIONS	1 IN. = 5 FT.

These plans are subject to such revisions as may be required by the Bureau of Public Roads or the Commissioner of Highways.  
Construction is to be carried on in accordance with the plans and Standard Road and Bridge Specifications of 1936 as approved Dec. 20, 1936 by the Bureau of Public Roads, with all subsequent approved revisions and such revised specifications and special provisions as are submitted with the plans.

APPROVED: Feb 5, 1937  
H. H. ...  
ROAD ENGINEER

SERIES E.R. NO. 2  
SHEET 1 OF 10

DIST. #2 PLANS