

**INDEX OF SHEETS**

|             |  |
|-------------|--|
| SHEET NO. 1 | TITLE PAGE   |
| 2-3         | TYPICAL CROSS-SECTION OF IMPROVEMENT } 2 1/2 CRUSHED GRAVEL MIXED-IN-PLACE SURFACE COURSE. |
| 4           | BANKING AND WIDENING TABLES  |
| 5-11        | PLAN AND PROFILE STA.  |
| 12-13       | PLAN AND PROFILE SHEETS OF PROPOSED TROLLEY RELOCATION                                     |
| 14-14A      | PLAN AND PROFILE SHEETS FOR STONE FILL MATERIAL  |
| 15          | SLAB LAYOUT FOR CONCRETE INTERSECTIONS   |
| 16-17       | DETAILS OF SUPERSTRUCTURE  |
| 18          | DETAILS OF ABUTMENT NO. 1  |
| 19          | DETAILS OF PIER  |
| 20          | DETAILS OF ABUTMENT NO. 2  |
| 21          | STANDARD STRUCTURE SHEET   |
| 22          | 3B 11 BARRICADES, SIGNS & LIGHTS   |
| 23          | 3B 20 DETAILS  |
| 24          | 3B 5C RAILING  |
| 25          | 3B 28 PIPE CULVERTS  |
| 26          | 3B 30 GUARD RAIL   |
| 27          | 3B 30A BOUNDARY MARKERS  |
| 28          | 3B 33 ONE COURSE CEMENT CONCRETE PAVEMENT  |
| 29          | 3B 40 BARRICADES, SIGNS & LIGHTS   |
| 30-76       | 3B 41 ROUNDINGS OF SLOPES  |

STANDARD STRUCTURE SHEETS  
 APPROVED BY THE CHIEF ENGINEER  
 3-28 JULY 11, 1933  
 3-30 AUGUST 16, 1934

**STATE OF VERMONT  
 STATE HIGHWAY DEPARTMENT**

**PLAN AND PROFILE OF PROPOSED  
 STATE HIGHWAY**

FEDERAL AID PROJECT  
 135-H (1)

**TOWN OF SPRINGFIELD** Project: FAP 135 H (1)  
**ROUTE U.S. 5 WINDSOR-BELLOWS FALLS ROAD** Pin# 99x369

BEGINNING AT A POINT 0.4 MILE WEST OF THE CHESHIRE BRIDGE & EXTENDING  
 SOUTHERLY 1.078 MILES TO A POINT 1.4 MILES NORTH OF THE SPRINGFIELD-  
 ROCKINGHAM TOWN LINE

LENGTH OF ROADWAY 5408.94 FT. = 1.024 MILES  
 LENGTH OF "B" LINE 444.0 FT. = 0.084 MILES  
 LENGTH OF BRIDGE 285.66 FT. = 0.054 MILES  
 TOTAL LENGTH OF PROJECT 6138.60 FT. = 1.162 MILES

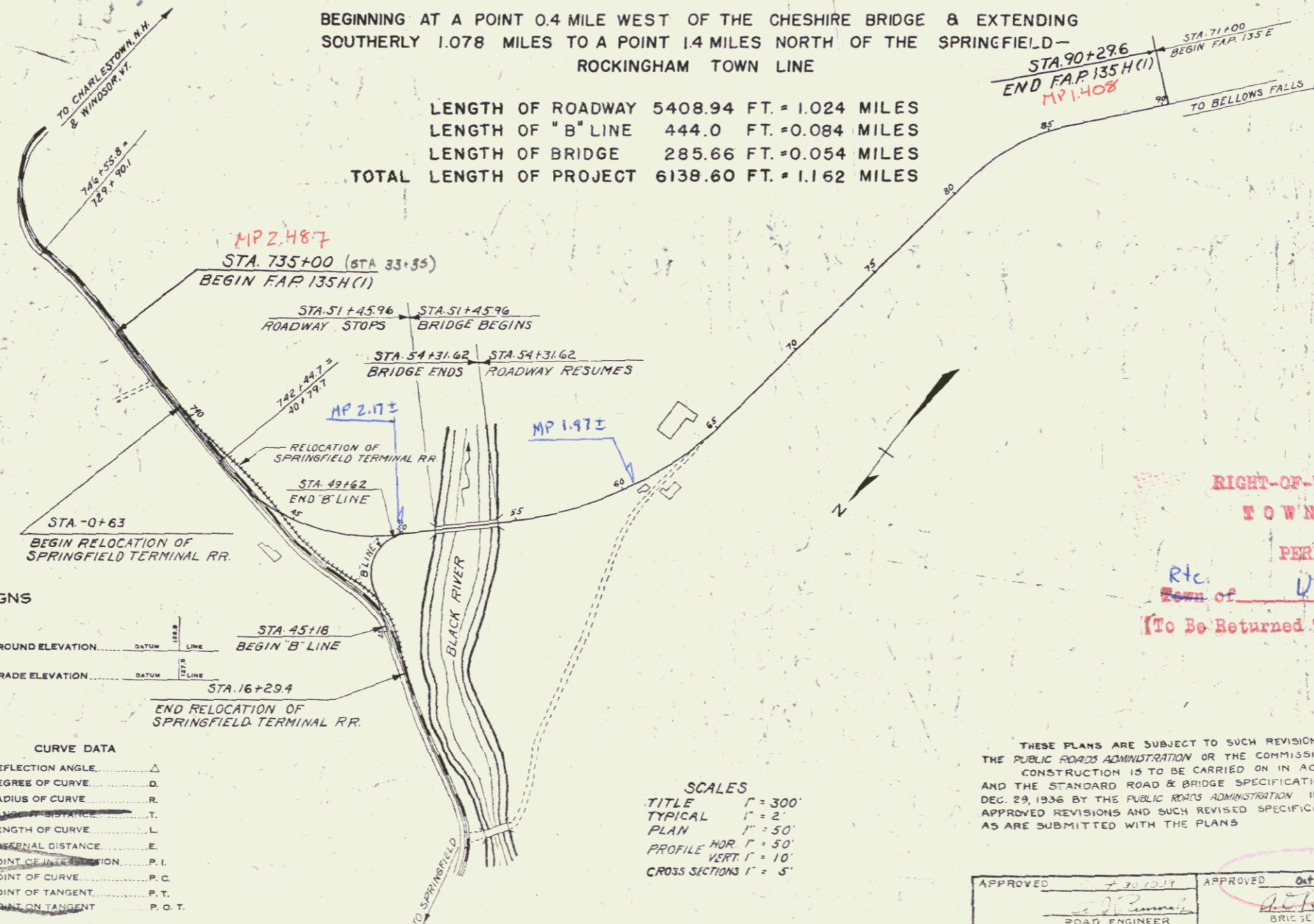
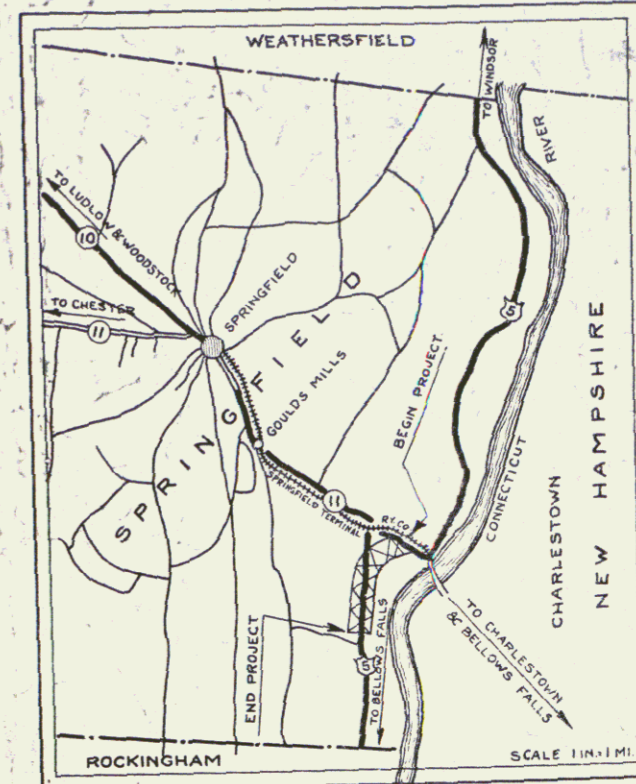

**CONVENTIONAL SIGNS**

|                   |       |
|-------------------|-------|
| COUNTY LINE       | ..... |
| TOWN LINE         | ..... |
| FENCE LINE        | ..... |
| STONE WALL        | ..... |
| UNFENCED PROPERTY | ..... |
| GUARD RAIL        | ..... |
| TRAVELED WAY      | ..... |
| RAILROAD          | ..... |
| RETAINING WALL    | ..... |
| TROLLEY POLE      | ..... |
| POWER POLE        | ..... |
| TELEPHONE POLE    | ..... |
| TREES             | ..... |
| HEDGE             | ..... |

**CURVE DATA**

|                       |          |
|-----------------------|----------|
| DEFLECTION ANGLE      | Δ        |
| DEGREE OF CURVE       | D        |
| RADIUS OF CURVE       | R        |
| TANGENT DISTANCE      | T        |
| LENGTH OF CURVE       | L        |
| CHORDAL DISTANCE      | C        |
| POINT OF INTERSECTION | P. I.    |
| POINT OF CURVE        | P. C.    |
| POINT OF TANGENT      | P. T.    |
| POINT ON TANGENT      | P. O. T. |

**SCALES**  
 TITLE 1" = 300'  
 TYPICAL 1" = 2'  
 PLAN 1" = 50'  
 PROFILE HOR. 1" = 50'  
 VERT. 1" = 10'  
 CROSS SECTIONS 1" = 5'

**RIGHT-OF-WAY DIVISION  
 TOWN FILE**  
 PERPETUAL  
 Rtc. Form of U.S. 5  
 [To Be Returned To R.O.W. Division]

APPROVED: *January 20, 1940*  
*The Sargent*  
 COMMISSIONER OF HIGHWAYS  
 SUBMITTED BY ORDER OF THE STATE HIGHWAY BOARD

THESE PLANS ARE SUBJECT TO SUCH REVISIONS AS MAY BE REQUIRED BY  
 THE PUBLIC ROADS ADMINISTRATION OR THE COMMISSIONER OF HIGHWAYS  
 CONSTRUCTION IS TO BE CARRIED ON IN ACCORDANCE WITH THE PLANS  
 AND THE STANDARD ROAD & BRIDGE SPECIFICATIONS OF 1936 AS APPROVED  
 DEC. 29, 1936 BY THE PUBLIC ROADS ADMINISTRATION INCLUDING ALL SUBSEQUENT  
 APPROVED REVISIONS AND SUCH REVISED SPECIFICATIONS & SPECIAL PROVISIONS  
 AS ARE SUBMITTED WITH THE PLANS

APPROVED: *[Signature]* ROAD ENGINEER  
 APPROVED: *[Signature]* DISTRICT ENGINEER  
 APPROVED: *[Signature]* DIST. HWY. COMMISSIONER  
 SERIES FAP NC 135 H (1) FILED  
 SHEET 1 OF 76