

INDEX OF SHEETS

SHEET NO.	TITLE PAGE
2	TYPICAL CROSS-SECTION OF IMPROVEMENT (Grading, Base, & Drainage, with Guard Rail, and Double Thick Coat of Refined Tar, Item 29)
6	DETAILS OF CONC. REFLECTING CURB
7	BANKING & WIDENING TABLES
8-21	PLAN & PROFILE
22	DETAILS OF 6'x12" RC. BOX
23	STD. STRUCT. SHEET 5-23, PIPE CULVERTS
24	5-30, GUARD RAIL, CURB RET. WALLS, GUIDE POSTS.
25	5-30A, STD. UND. BOUNDARY MARKS, F.A. MARKS.
26	5-40, BARRICADES, SIGNS, & LIGHTS.
27	5-41, ROUNDING TOPS OF CUT SLOPES.
28	SC 24, DETAILS, 4'x4" RC. BOX.
29	SCM-4, DETAILS, WINGS FOR 4'x4" RC. BOX.
30-47	CROSS SECTION SHEETS
148-151	CHANNEL EXCAV., STA. 79+85

Standard Structure Sheets Approved
By The Chief Engineer
5-28, July 11, 1933.
5-30, Aug. 15, 1934.

STATE OF VERMONT
STATE HIGHWAY DEPARTMENT

PLAN AND PROFILE OF PROPOSED
STATE HIGHWAY
FEDERAL AID PROJECT

TOWN OF ROCKINGHAM

BEGINNING AT THE BELLOWS FALLS VILLAGE
LIMITS ON ROUTE U.S. 5 AND EXTENDING NORTHERLY
2.219 MILES TO A POINT 616.0 FEET BEYOND THE
INTERSECTION OF STATE ROUTE 103 & ROUTE U.S. 5

LENGTH OF MAIN LINE 11,718.4 FEET = 2.219 MILES
LENGTH OF "B" LINE 1,116.0 FEET = 0.211 MILES
TOTAL LENGTH OF PROJECT 12,834.4 FEET = 2.430 MILES

Pin # 99R362
Project: SN FAP 135J(1)

PROJECT DIST. NO.	YEAR	PROJ. NO.	PLAN NO.	SHEET NO.	TOTAL SHEETS
9	VT	135J(1)	1	1	1

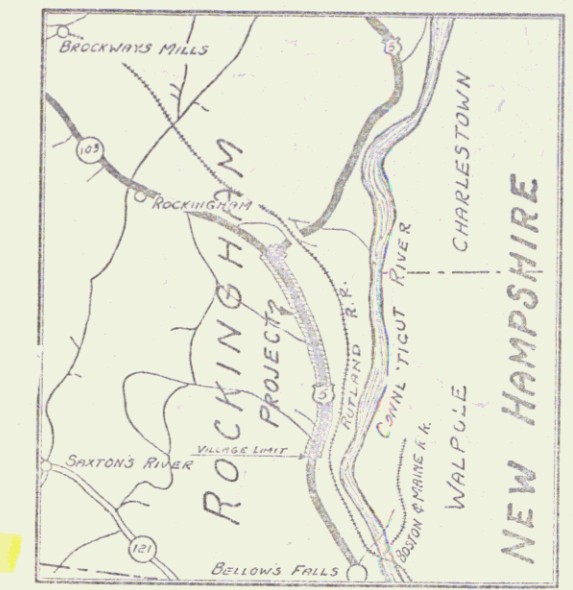

SCALE: 1 INCH = 1 MILE

RECORD PLAN
BY
T. P. Tierney 2/72

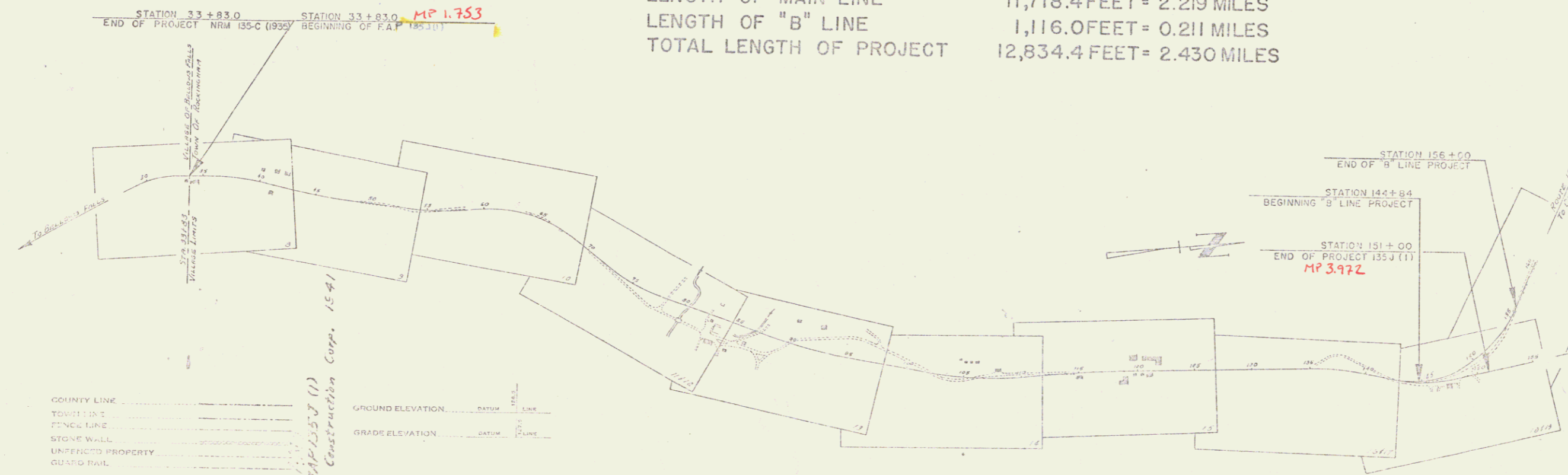

RIGHT-OF-WAY DIVISION
TOWN FILE
PERPETUAL
Town of U.S. 5
(To Be Returned To R.O.W. Division)

APPROVED: May 13, 1940
COMMISSIONER OF HIGHWAYS

SYMBOL	DESCRIPTION
---	COUNTY LINE
---	TOWN LINE
---	TINCLINE
---	STONE WALL
---	UNFENCED PROPERTY
---	GUARD RAIL
---	TRAVELLED WAY
---	RAILROAD
---	RETAINING WALL
---	CENTER LINE
---	SURVEY LINE
---	CULVERT
---	DROP INLET
---	POWER POLE
---	TELEPHONE POLE
---	TRUCK
---	HELIX

CURVE DATA		SCALES	
DEFLECTION ANGLE	Δ	TITLE	1" = 500 ft.
DEGREE OF CURVE	D	TYPICAL	1" = 2 ft.
RADIUS OF CURVE	R	PLAN	1" = 30 ft.
TANGENT DISTANCE	T	PROFILL	HORIZONTAL 1" = 50 ft.
LENGTH OF CURVE	L	VERTICAL	1" = 10 ft.
EXTERNAL DISTANCE	E	CROSS SECTIONS	1" = 5 ft.
POINT OF INTERSECTION	P. I.	TYPICAL BOX TRANSVERS.	1" = 5 ft.
POINT OF CURVE	P. C.		
POINT OF TANGENT	P. T.		
POINT ON TANGENT	P. O. T.		

THESE PLANS ARE SUBJECT TO SUCH REVISIONS AS MAY BE REQUIRED BY THE PUBLIC ROADS ADMINISTRATION OR THE COMMISSIONER OF HIGHWAYS.

CONTRACTORS TO BE CARREY ON IN ACCORDANCE WITH THE PLANS AND THE STANDARDS AND SPECIFICATIONS OF 1934 AS APPROVED DECEMBER 21ST 1937 BY THE PUBLIC ROADS ADMINISTRATION INCLUDING ALL SUBSEQUENT APPROVED REVISIONS AND C.M. REVISED SPECIFICATIONS AND SPECIAL PROVISIONS AS ARE FURNISHED WITH THE PLANS.

APPROVED: [Signature]
COMMISSIONER OF HIGHWAYS

DIST # 2 PLANS