

| INDEX OF SHEETS | |
|-----------------|---|
| SHEET NO. 1 | TITLE PAGE |
| 2 | TYPICAL CROSS SECTION OF IMPROVEMENT (BIT CONC. PAV'T., ITEM 301 B) |
| 3 | QUANTITY SHEET (ITEMS & DRAINAGE) |
| 4 | EARTHWORK SHEET |
| 5-6 | PLAN & PROFILE SHEETS |
| 7 | DETAILS OF SUPERSTRUCTURE WIDENING (NORTH APPROACH) |
| 8 | DETAILS OF ABUTMENT AND PIERS (NORTH APPROACH) |
| 9 | DETAILS OF SLAB AND ABUTMENT SECTIONS (NORTH APPROACH) |
| 10 | DETAILS OF SUPERSTRUCTURE WIDENING (SOUTH APPROACH) |
| 11 | DETAILS OF TOWER AND PIER SECTIONS (SOUTH APPROACH) |
| 12 | DETAILS OF SLAB AND ABUTMENT SECTIONS (SOUTH APPROACH) |
| 13 | DETAILS OF BRIDGE RAILING |
| 14 | REINFORCING STEEL SCHEDULE |
| 15 | ROADWAY STANDARD SHEET RS 56-2 (DROPP INLETS) |
| 16 | ROADWAY STANDARD SHEET RS 56-3 (CONC. GRAVITY CURBS) |
| 17 | ROADWAY STANDARD SHEET RS 56-6 (TYPICAL SLOPE GRADING) |
| 18 | ROADWAY STANDARD SHEET RS 56-11 (THREE CABLE GUARD RAIL WITH STEEL POSTS) |
| 19 | ROADWAY STANDARD SHEET BS 56-2 (BARRICADES, SIGNS, AND LIGHTS) |
| 20-27 | PLANS OF EXISTING STRUCTURE |
| 28-32 | CROSS SECTIONS |

STATE OF VERMONT
DEPARTMENT OF HIGHWAYS
PROPOSED IMPROVEMENT
STATE PROJECT
TOWN OF WESTMINSTER
COUNTY OF WINDHAM
U.S. ROUTE 5 Pin# 99R359
BRATTLEBORO-BELLOWS FALLS ROAD

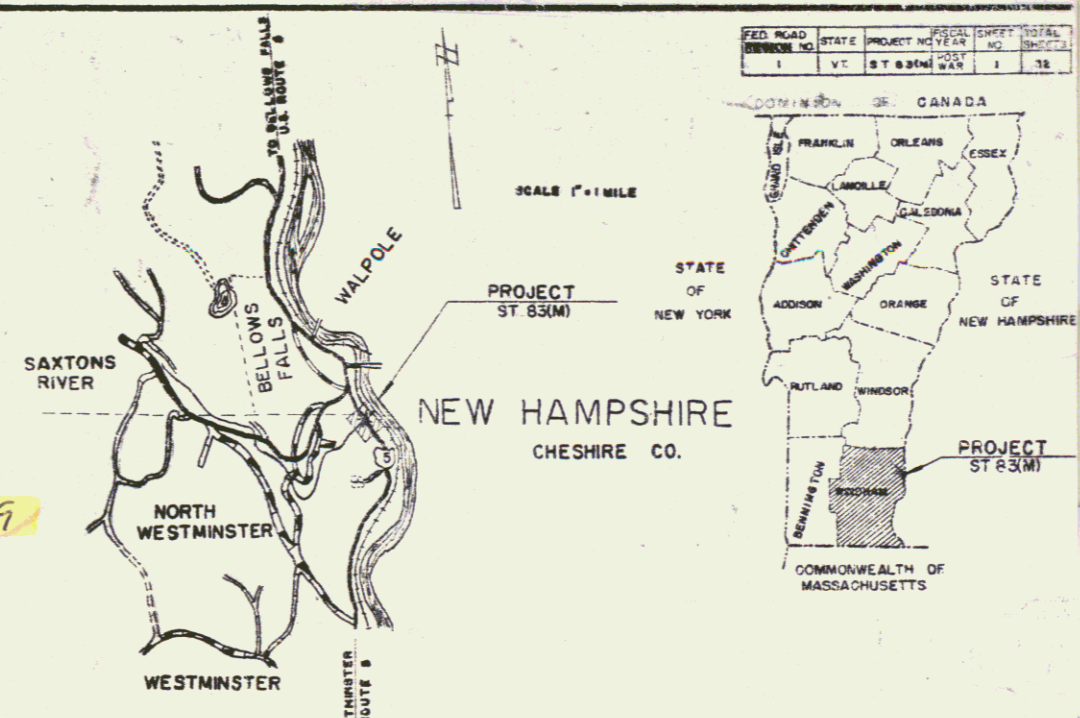

BEGINNING AT A POINT APPROXIMATELY 822 FEET SOUTH OF THE ROCKINGHAM-WESTMINSTER TOWN LINE AND EXTENDING NORTHERLY 600 FEET INCLUDING BRIDGE

LENGTH OF ROADWAY 321 FEET = 0.0607 MILE
LENGTH OF BRIDGE 279 FEET = 0.0528 MILE
LENGTH OF PROJECT 600 FEET = 0.1135 MILE

| PROJECT NAME & NUMBER | TYPE | FAVEMENT | DATE |
|-----------------------|---------|----------|------|
| WESTMINSTER ST 83(M) | ROADWAY | ASPH | 1957 |

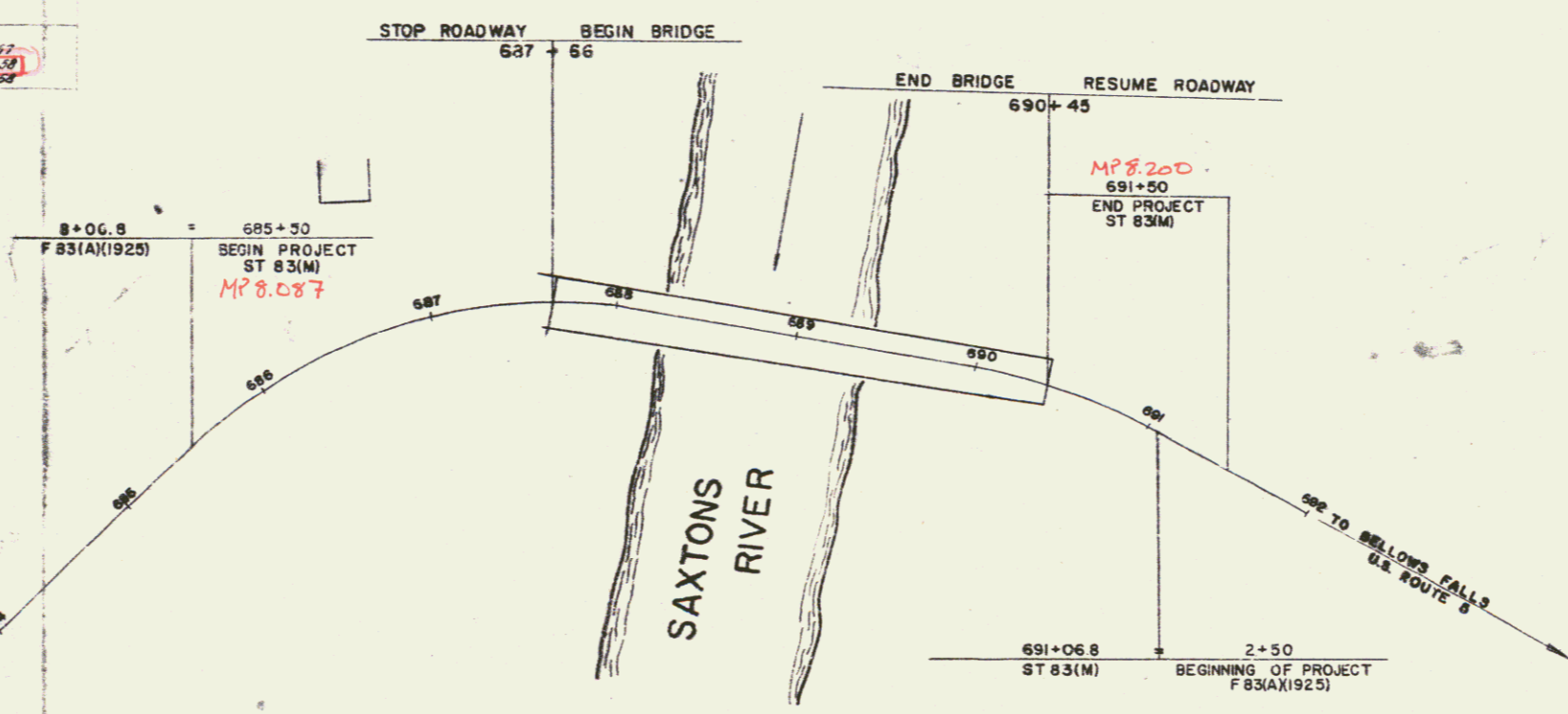

WESTMINSTER
 BRIDGE 279 FT
 3 Span Steel Conc. Arch & T-Beams
 Widening done by Miller
 Const. Co. Windsor Vt. 1956
 Beginning 822 feet south
 of the Rockingham-Westminister
 T.L. and extending northerly 600
 ft including bridge.

| GROUND ELEVATION | GRADE ELEVATION |
|------------------|------------------------------------|
| 8+06.8 | 685+50 |
| F 83(A)(1925) | BEGIN PROJECT ST 83(M) |
| | MP 8.087 |
| | 687 |
| | 688 |
| | 689 |
| | 690 |
| | 691 |
| | 691+06.8 |
| | ST 83(M) |
| | 2+50 |
| | BEGINNING OF PROJECT F 83(A)(1925) |

| TITLE | SCALE |
|--------------------|----------|
| TYPICAL | 1" = 50' |
| PLAN | 1" = 50' |
| PROFILE HORIZONTAL | 1" = 50' |
| PROFILE VERTICAL | 1" = 10' |
| CROSS-SECTIONS | 1" = 5' |

| | | | | | |
|--------------------|-----------------------|------------------|-------------------|------------------|------------------|
| APPROVED DATE | APPROVED DATE | APPROVED DATE | APPROVED DATE | APPROVED DATE | APPROVED DATE |
| Secondary Engineer | Construction Engineer | Bridge Engineer | District Engineer | Highway Engineer | Chief Engineer |
| | 7-24-57 | 3-16-57 | 5-10-57 | 3-16-57 | 5-16-57 |

NOTE: ANY FURTHER INFORMATION CONCERNING FINAL QUANTITIES, AMOUNTS OR OTHER DETAILS RELATIVE TO THIS PROJECT MAY BE FOUND IN EITHER THE FIELD BOOKS OR THE ESTIMATE FILE.

DEPARTMENT OF COMMERCE
BUREAU OF PUBLIC ROADS

PROJECT ST 83(M)

SHEET (1) OF 32 SHEETS

| STA | STA | LF | RT | ANCHORS |
|----------|----------|-------|----|---------|
| 687+18 V | 687+66 I | 48 I | X | 2 I |
| 690+43 V | 692+00 I | 160 I | X | 2 I |
| Totals | | 208 I | | 4 I |

| STA | STA | LF | RT | CV |
|--------|--------|-------|----|--------|
| 685+50 | 687+66 | 116 I | X | -8.16 |
| 690+43 | 691+50 | 105 I | X | -2.37 |
| TOTALS | | 221 I | X | -10.53 |

| PROJ. ROAD | STATE | PROJ. NO. | FISCAL YEAR | SHEET NO. | TOTAL SHEETS |
|------------|-------|-----------|-------------|-----------|--------------|
| | VT. | | | | |

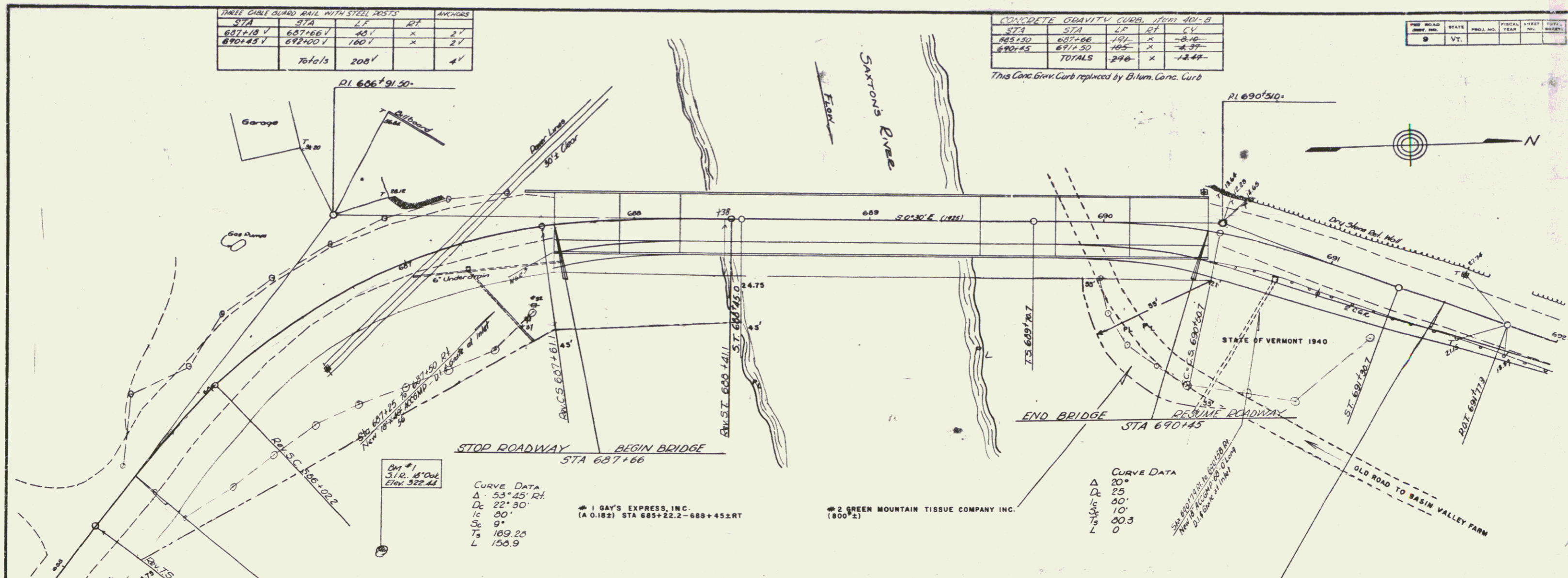

CURVE DATA
 Δ 53° 25' Rt.
 D 22' 30"
 L 109.25
 L 158.9

1 BAY'S EXPRESS, INC.
 (A 0.182) STA 685+22.2 - 688+45.2 RT

2 GREEN MOUNTAIN TISSUE COMPANY INC.
 (800' ±)

CURVE DATA
 Δ 20°
 D 25'
 L 10'
 L 100.3
 L 0

LIST OF QUANTITIES (BRIDGE ONLY)

| ITEM | DESCRIPTION | UNIT | NET | OVER | TOTAL | FINAL |
|-------|--|------|------|------|-------|-------|
| 107 | STRUCTURE EXCAVATION | C.Y. | 46 | 5 | 51 | 120 |
| 109 | MAINT. OF TRAFFIC FOR BRIDGE PROJECTS | L.S. | 1 | - | 1 | 1 |
| 222 | GRAVEL BACKFILL | C.Y. | 20 | 3 | 23 | 23 |
| 361-B | BIT CONC. PAVEMENT | TONS | 19 | 3 | 22 | 22 |
| 401-B | CONCRETE - CLASS B, Modified | C.Y. | 203 | 10 | 213 | 225 |
| 402 | REINFORCING STEEL | LBS. | 2368 | - | 2368 | 2368 |
| 572 | BRIDGE RAILING | LF | 119 | - | 119 | 119 |
| 574 | PREPARING SUPERSTRUCTURE FOR WIDENING | L.S. | 1 | - | 1 | 1 |
| 596 | PREP EXISTING PAVEMENT FOR NEW WEARING SURFACE | S.Y. | 123 | - | 123 | 123 |

LIST OF SHEETS (BRIDGE ONLY)

| | |
|-------|---|
| 5 | PLAN SHEET (1"=20') |
| 7 | SUPERSTRUCTURE WIDENING - NORTH APPROACH |
| 8 | DETAIL NO. APPROACH - ABUTMENT & PIERS |
| 9 | " " - SLAB & ABUTMENT SECTIONS |
| 10 | SUPERSTRUCTURE WIDENING - SOUTH APPROACH |
| 11 | DETAIL NO. APPROACH - TOWER & PIER SECTIONS |
| 12 | " " - SLAB & ABUTMENT SECTIONS |
| 13 | RAILING DETAIL |
| 14 | REINFORCING STEEL DETAILS |
| 20-21 | PLANS OF EXISTING STRUCTURE |

WESTMINSTER SAXTONS RIVER BRIDGE

Surveyed by
 Designed by
 Drawn by JT
 Traced by
 Checked by R.T.B.
 Series ST No. 83(M) Plac
 Sheet 5 of 52 Sheets

Surveyed by Calvano 2-87