

STA	STA	LF	RT	ANCHORS
687+18 V	687+66 I	48 I	X	2 I
690+43 V	692+00 I	160 I	X	2 I
Totals		208 I		4 I

STA	STA	LF	RT	CV
685+50	687+66	116 I	X	-8.16
690+45	691+50	105 I	X	-2.37
TOTALS		221 I	X	-10.53

PROJ. ROAD	STATE	PROJ. NO.	FISCAL YEAR	SHEET NO.	TOTAL SHEETS
	VT.				

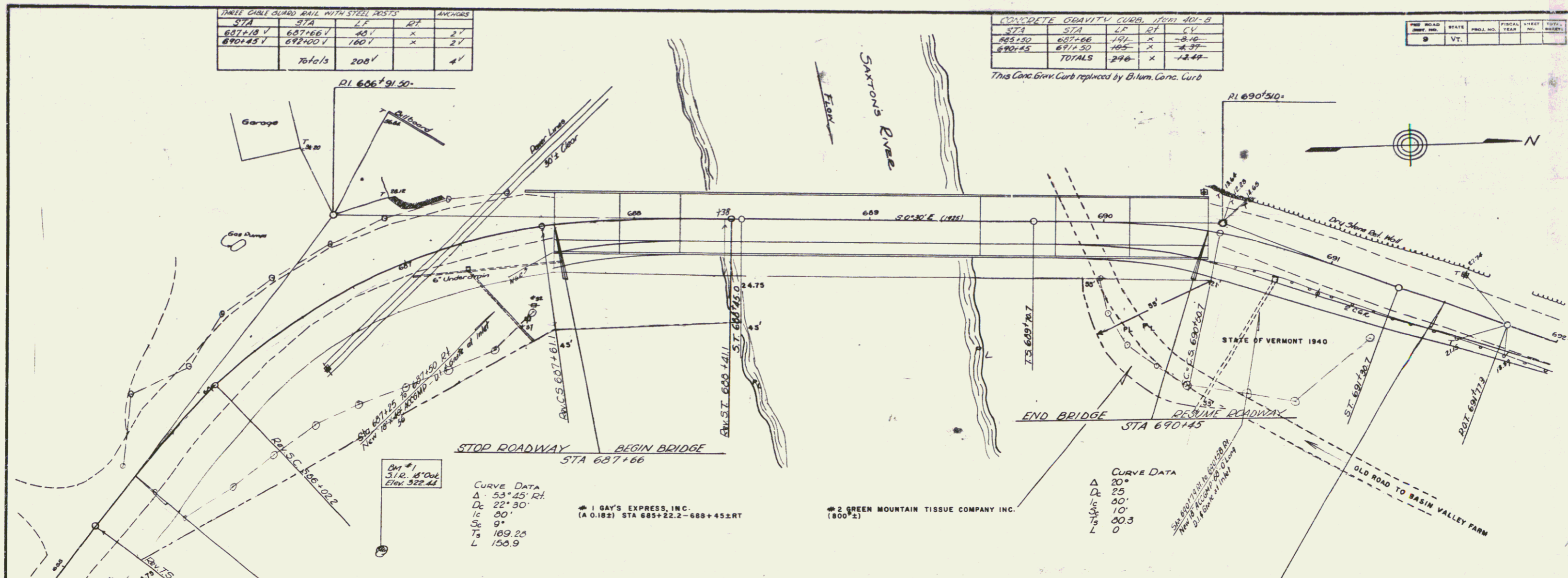

CURVE DATA
 Δ 53° 25' Rt.
 D 22' 30"
 L 90'
 L_1 109.25
 L_2 158.9

CURVE DATA
 Δ 20°
 D 25'
 L 100'
 L_1 100'
 L_2 0

LIST OF QUANTITIES (BRIDGE ONLY)

ITEM	DESCRIPTION	UNIT	NET	OVER	TOTAL	FINAL
107	STRUCTURE EXCAVATION	C.Y.	46	5	51	120
109	MAINT. OF TRAFFIC FOR BRIDGE PROJECTS	L.S.	1	-	1	1
222	GRAVEL BACKFILL	C.Y.	20	3	23	23
361-B	BIT CONC. PAVEMENT	TONS	19	3	22	22
401-B	CONCRETE - CLASS B, Modified	C.Y.	203	10	213	225
402	REINFORCING STEEL	LBS.	2368	-	2368	2368
572	BRIDGE RAILING	L.F.	119	-	119	119
574	PREPARING SUPERSTRUCTURE FOR WIDENING	L.S.	1	-	1	1
596	PREP EXISTING PAVEMENT FOR NEW WEARING SURFACE	S.Y.	123	-	123	123

LIST OF SHEETS (BRIDGE ONLY)

5	PLAN SHEET (1"=20')
7	SUPERSTRUCTURE WIDENING - NORTH APPROACH
8	DETAIL NO. APPROACH - ABUTMENT & PIERS
9	" " " " - SLAB & ABUTMENT SECTIONS
10	SUPERSTRUCTURE WIDENING - SOUTH APPROACH
11	DETAIL NO. APPROACH - TOWER & PIER SECTIONS
12	" " " " - SLAB & ABUTMENT SECTIONS
13	RAILING DETAIL
14	REINFORCING STEEL DETAILS
20-21	PLANS OF EXISTING STRUCTURE

WESTMINSTER
SAXTONS RIVER BRIDGE

Surveyed by
 Designed by
 Drawn by JT
 Traced by
 Checked by R.T.B.
 Series ST No. 83(M) Plac
 Sheet 5 of 52 Sheets