

INDEX OF SHEETS

- TITLE PAGE.
- PLAN AND PROFILE.
- ROADWAY CROSS SECTIONS.
- PLAN AND TYPICAL SECTION.
- BRIDGE QUANTITY SHEET.
- ABUTMENT PLAN.
- ABUTMENT AND WING ELEVATIONS.
- REINFORCING SCHEDULE.
- CHANNEL SECTIONS.

SCB-D1-75 (4-23-75)
 G-1 (6-4-74)
 E-3 (5-14-74 R)
 SCB-D6-73 (1-27-75)

STATE OF VERMONT
 DEPARTMENT OF HIGHWAYS



PROPOSED IMPROVEMENT

BRIDGE PROJECT
 TOWN OF HARTFORD Pin# 99R358
 COUNTY OF WINDSOR
 ROUTE No. U.S. 5 BRIDGE No. 75

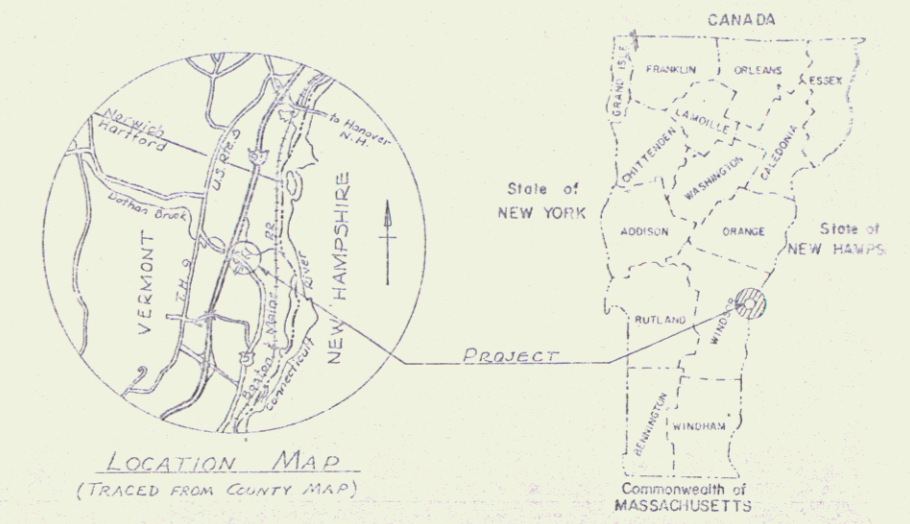

GENERAL NOTES:

- FOR FURTHER DETAILS OF ROADWAY TYPICAL, SEE STANDARD SHEET A-35.
- FOR GENERAL NOTES, SEE SCB-D1-75.

RECORD PLANS-MATERIALS

HARTFORD ROS 041-3(1)
 CONTRACTOR-STATE OF VERMONT (HIGHWAY DEPT., DISTRICT 4)
 CONSTRUCTION BEGAN-4 MAY 1976
 CONSTRUCTION COMPLETED-10 SEPTEMBER 1976
 CONSTRUCTION ACCEPTED-8 OCTOBER 1976
 RESIDENT ENGINEERS-DWAIN L. MANNING & STANLEY E. ROBINSON
 SUB-BASE OF GRAVEL-TWIN STATE SAND & GRAVEL, WHITE RIVER JCT., VT.
 BITUMINOUS CONCRETE PAVEMENT-PIKE INDUSTRIES, WEST LEBANON, N.H.
 CONCRETE-MILLER READY MIX, WEST LEBANON, N.H.
 REINFORCING STEEL-PIONEER VALLEY STEEL CO., WATERTOWN, MASS.
 GRAVEL RAIL-SPRINGFIELD HOME IMPROVEMENT CO., SPRINGFIELD, VT.
 WATER-PROOFING MEMBRANE-VERMONT SEALCOATING, BARRE, VT.

PROJECT LOCATION: Beginning @ a point approximately 0.9 miles southeasterly from the intersection of T.H. #9 and U.S. #5 in the town of Hartford and running in a northwesterly direction for 250 feet on U.S. #5.

PROJECT DESCRIPTION: The project shall consist of removing the existing superstructure, widening existing abutments, constructing a new concrete slab deck, and any necessary abutment and approach work.

Length of Structure: 25.0 ft.
 Length of Participation Roadway: 225.0 ft.
 Length of Non-Participation Roadway:
 Length of Project: 250.0 ft.

ADT 1400 - 1975
 OHV 215
 D 55
 T 8
 DESIGN SPEED 35
 ACCIDENTS - LAST 5 YEARS - 2

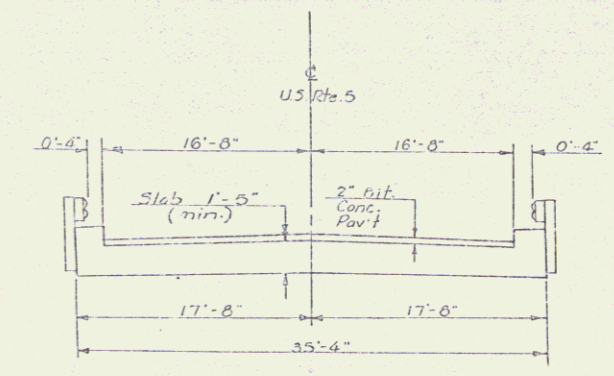

TYPICAL BRIDGE SECTION
 N.T.S.

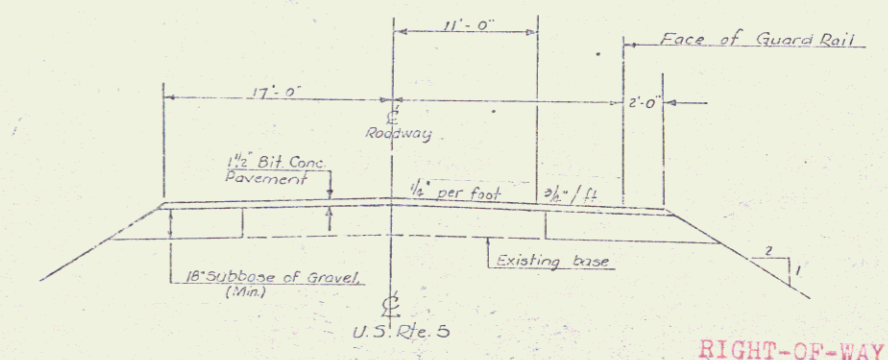

TYPICAL ROADWAY SECTION
 N.T.S.

RIGHT-OF-WAY DIVISION
 TOWN FILE
 PERPETUAL
 Town of U.S. 5
 (To Be Returned To R.O.W. Division)

CONVENTIONAL SIGNS

- COUNTY LINE
- TOWN LINE
- LIMITS OF ACCESS
- POINT OF ACCESS
- FENCE LINE
- STONE WALL
- TRAVELED WAY
- GUARD RAIL
- RAILROAD
- SURVEY LINE
- CULVERT
- POWER POLE
- TELEPHONE POLE
- TREES
- F & CONST. IDENTIFICATION SIGNS
- PROPERTY LINE
- ROW TAKING LINE
- SLOPE RIGHTS
- TOP OF CUT
- TOE OF SLOPE

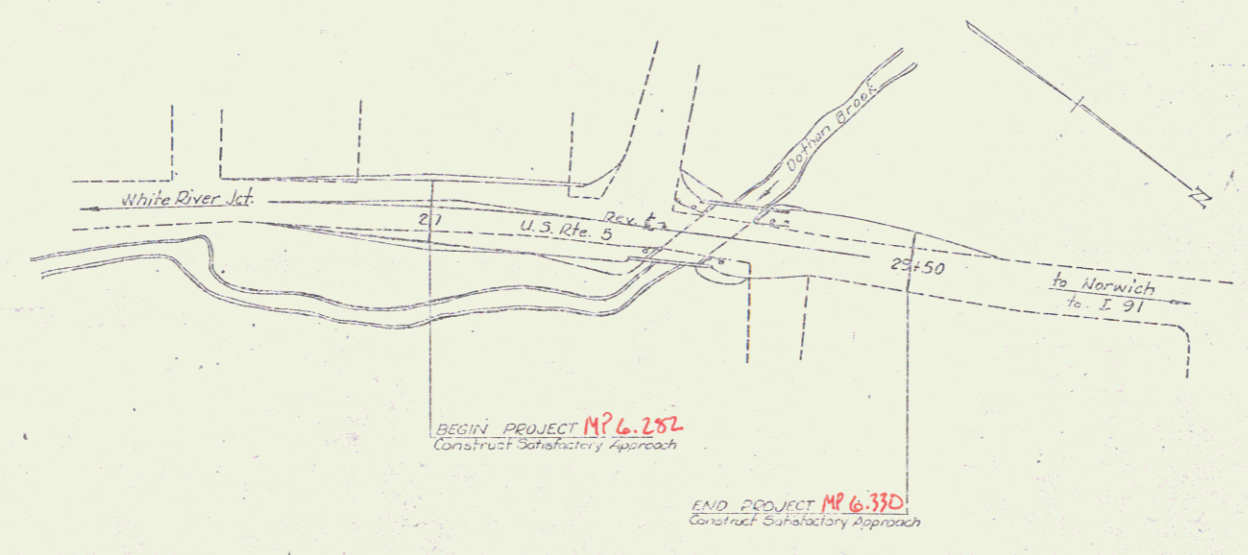

SUBMITTED BY ORDER OF THE STATE HIGHWAY

APPROVED: C. H. Stinchcomb DATE 4/1
 CHIEF ENGINEER

APPROVED: A. B. Carlin DATE 8/1
 DIRECTOR OF RIGHT-OF-WAY

PROJECT NO. ROS 041-3(1)
 SHEET 9 OF 9 SHEETS

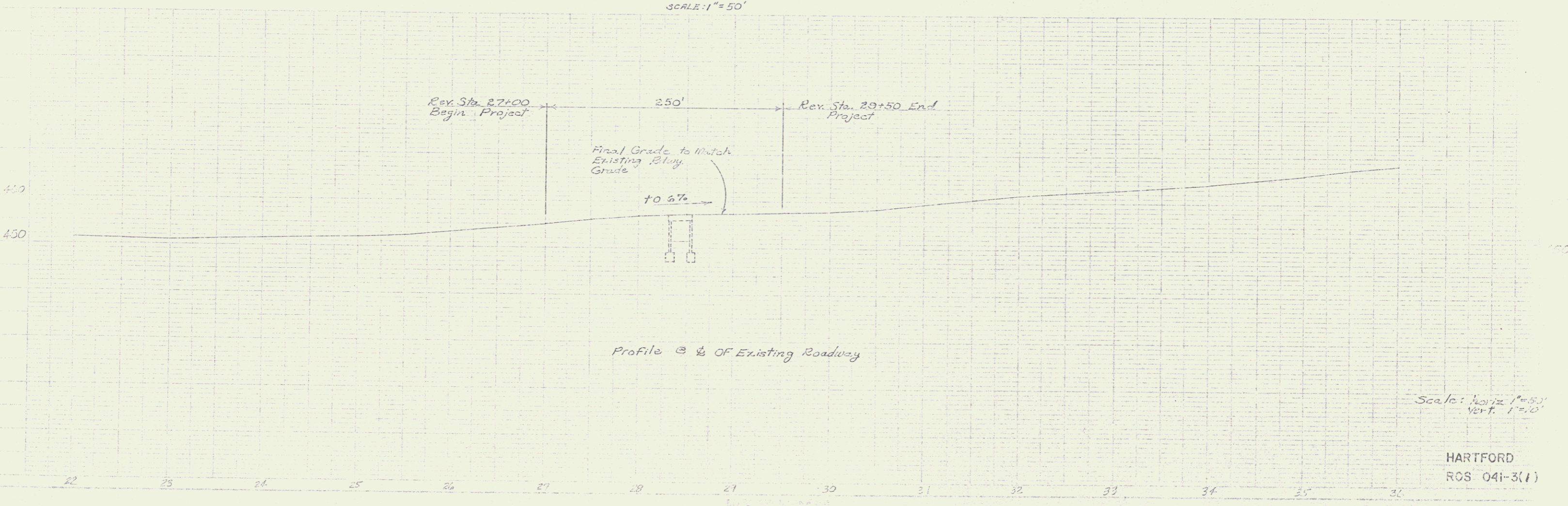
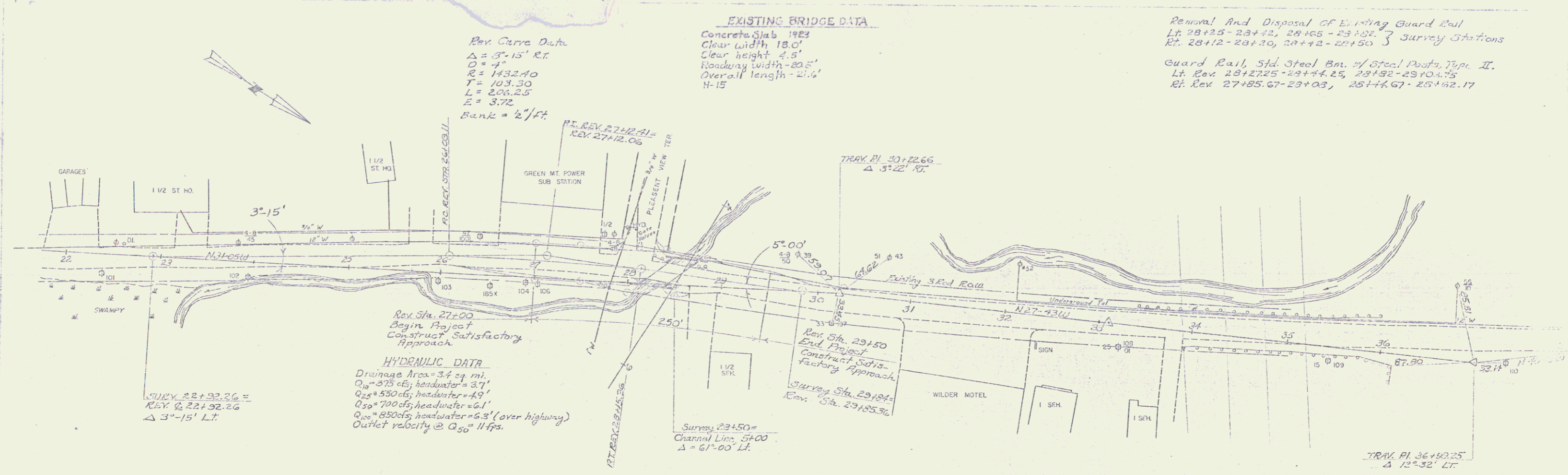

Sheet 2 of 3