

- INDEX OF SHEETS
1. TITLE, TYPICAL, PLAN, PROFILE, QUANTITY SHEET
  2. E-2 ROAD CONSTRUCTION APPROACH DETAILS
  - 3-4. Cross Sections

REMOVE & RE-SET GUARD RAIL  
 STANDARD STEEL BEAM GUARD RAIL W/8 FT POSTS  
 6' 3" SPACING  
 14+00-15+00 LT.  
 14+20-15+20 RT.

CONSTRUCT DRIVE  
 20+62 LT.

TOWN OF HARTFORD  
 COUNTY OF WINDSOR

BEGINNING AT A POINT APPROXIMATELY 1.488 MILES SOUTH  
 OF THE HARTFORD-NORWICH TOWN LINE EXTENDING NORTH  
 0.110 MILES.  
 LENGTH OF PROJECT 580 FT = 0.110 MILE.

REMOVE AND RE-SET GUARD RAIL  
 19+35-21+67 RT.

GUARD RAIL STD STEEL BEAM ABOVE  
 POSTS TYPE II (12' 6" SPACING)  
 17+75-22+00 RT.

TRAFFIC DATA

1975 ADT	1400
DIV	215
D	55
T	4
ACCIDENTS (5 YEARS)	9
V	35 MPH
SD - Original	215'
Design	325'

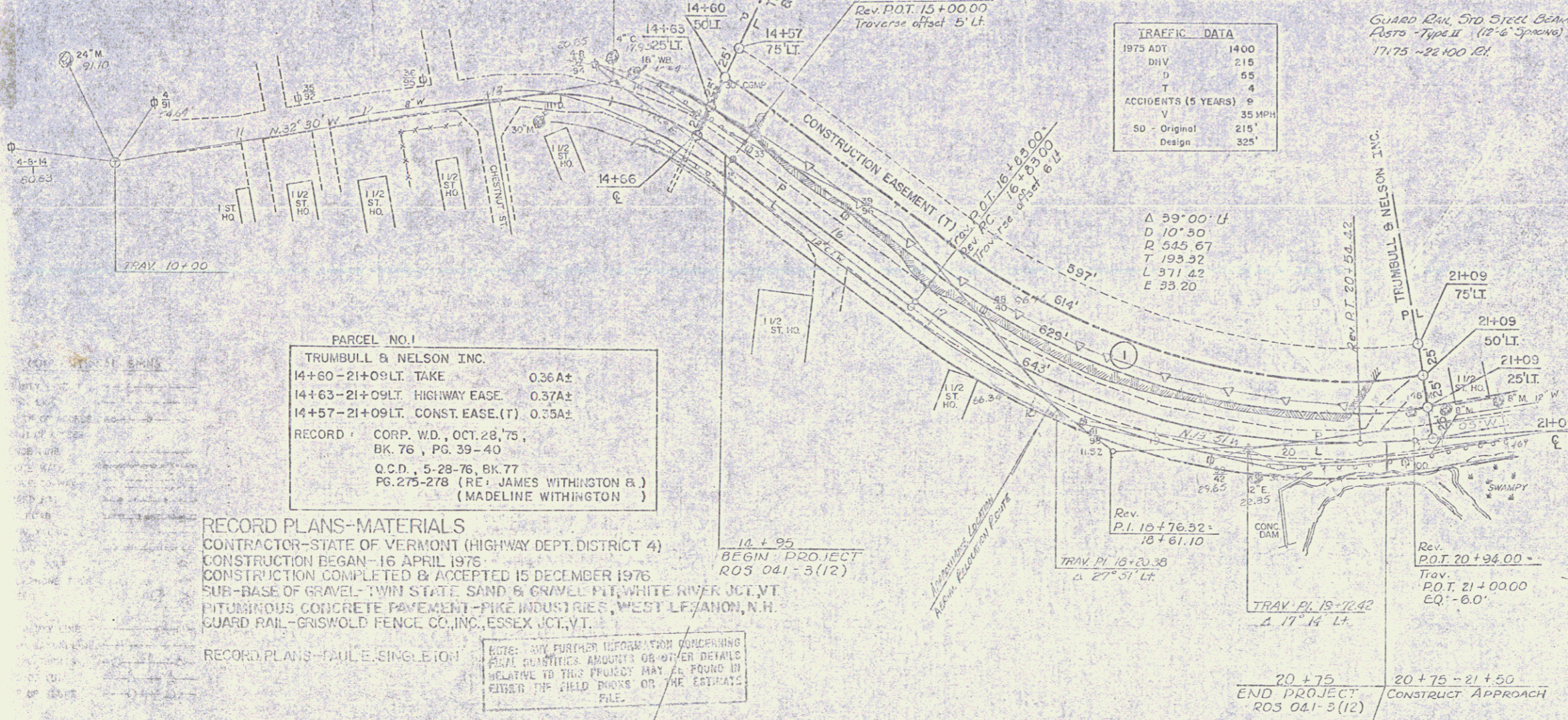

PARCEL NO. 1  
 TRUMBULL & NELSON INC.  
 14+60-21+09 LT. TAKE 0.36 A2  
 14+63-21+09 LT. HIGHWAY EASE. 0.37 A2  
 14+57-21+09 LT. CONST. EASE. (T) 0.35 A2

RECORD CORP. WD., OCT. 28, 75,  
 BK. 76, PG. 39-40  
 Q.C.D., 5-28-76, BK. 77  
 PG. 275-278 (RE: JAMES WITHINGTON & J.  
 MADELINE WITHINGTON)

RECORD PLANS - MATERIALS  
 CONTRACTOR-STATE OF VERMONT (HIGHWAY DEPT. DISTRICT 4)  
 CONSTRUCTION BEGAN - 16 APRIL 1976  
 CONSTRUCTION COMPLETED & ACCEPTED 15 DECEMBER 1976  
 SUB-BASE OF GRAVEL-TWIN STATE SAND & GRAVEL PIT, WHITE RIVER JCT, VT.  
 BITUMINOUS CONCRETE PAVEMENT-FIKE INDUSTRIES, WEST LEYAHON, N.H.  
 GUARD RAIL-GRISWOLD FENCE CO. INC., ESSEX JCT, VT.

RECORD PLANS - PAULE SINGLETON  
 NOTE: FOR FURTHER INFORMATION CONCERNING  
 FINAL QUANTITIES AMOUNTS OR OTHER DETAILS  
 RELATIVE TO THIS PROJECT MATERIAL FOUND IN  
 EITHER THE FIELD BOOKS OR THE ESTIMATE  
 FILE.

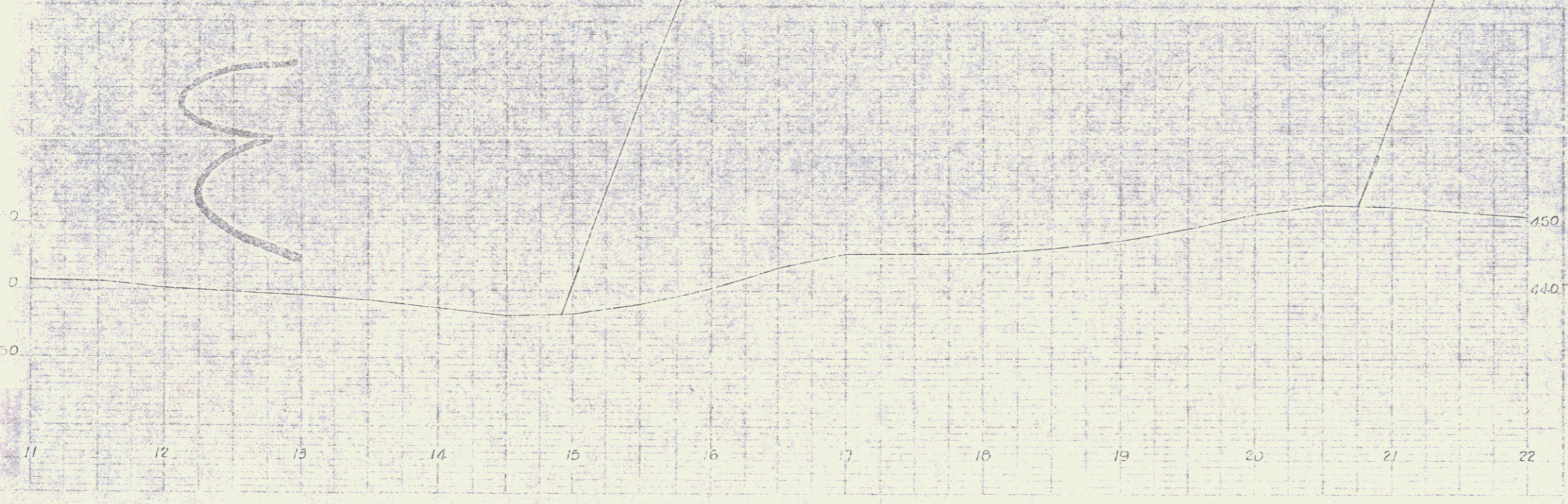

ITEM NO.	ITEM	UNIT	EST.	QUANTITY	PRICE	TOTAL
20110	Cleaning & Grubbing (Individual Poles & Stumps)	LS	1	1	1	1
20316	Common Excavation	CY	305	5	512	1517
20318	Solid Rock Excavation	CY	345	8	3500	11955
20332	Groutwork Berms	CY	18	6	150	2688
20420	Trench Excavation of Earth	CY	18	1	15	270
20421	Trench Excavation of Rock	CY	80	0	50	4000
20418	Subbase of Gravel	CY	328	16	400	13120
20415	Overhaul (5.0 mi. Est.)	CY/M	2000	EST.	2002	
20625	Bituminous Concrete Pavement	TON	1250	EST.	1750	
605101	6" Underdrain	LF	100	EST.	100	
605151	6" Underdrain Carrier Pipe	LF	20	EST.	30	
60710	Roadway Patrol Maintenance	HR	100	EST.	100	
60910	Dust Control with Water	M/3	140	EST.	110	
61310	Boundary Markers	EA	2	EST.	4	
62155	Removing & Re-setting Guard Rail	LF	25	EST.	25	
63010	Uniformed Traffic Officers	HR	57	EST.	58	
65112	Seed	LB	70	EST.	50	
65115	Fertilizer	LB	250	EST.	200	
65120	Agricultural Limestone	TON	1	EST.	1	
65125	Hay Mulch	TON	1	EST.	1	
60481	Bituminous Surface Treatment, Type III	GAL	165	17	2892	
62126	Remove and Dispose of Existing Guard Rail	LF	164	1	145	
62126	Guard Rail, Std Steel Beam (Std Post, Type II (12' 6" Spacing))	LF	255	—	435	

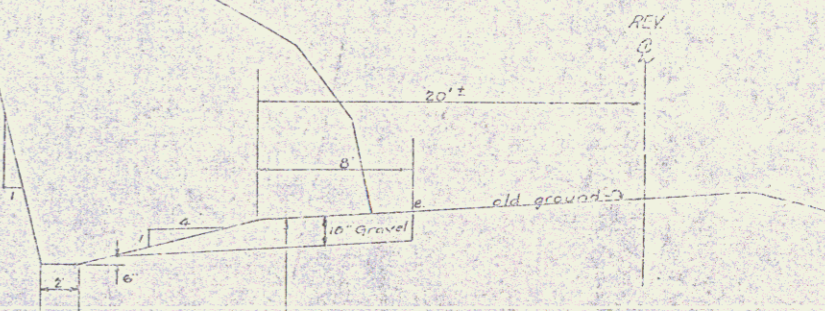

BUILT AS DESIGNED

RIGHT-OF-WAY DIVISION  
 TOWN FILE  
 PERPETUAL

Town of US 5 MM 6.06-6.17  
 (To Be Returned To R.O.W. DIV.)

APPROVED: *[Signature]* DATE 7-11-75  
 R.O.W. DIRECTOR

SUBMITTED BY OFFICE OF THE STATE HIGHWAY BOARD  
 DATE 7-16-75

DEPARTMENT OF TRANSPORTATION  
 FREEBORN, VERMONT ADMINISTRATION

PROJECT: HARTFORD  
 SHEET: ROS 041-3(12)