

CABLE GUARD RAIL REQUIRED

STATION	LEFT	RIGHT
246100-249124	324 ft.	-
246100-249124	-	320 ft.
251175-251175	-	124 ft.
251175-253111	126 ft.	-

REV. CURVE (R=42' 50")
 Δ 64° 25'
 D 12'
 R 477.5'
 T 302.9'
 L 536.8'
 E 86.9'

The material in the present Superstructure to become the property of the Contractor and to be removed by him from the site.
 The two concrete piers to be removed to the low water elevation by the Contractor and to be paid for as Structure Excavation.
 Estimated Quantity for Two Piers = 150 Cu. Yds.

77E 1929 21 73

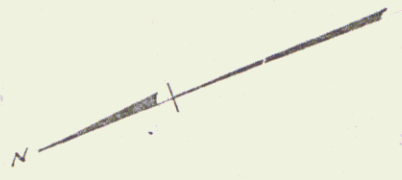
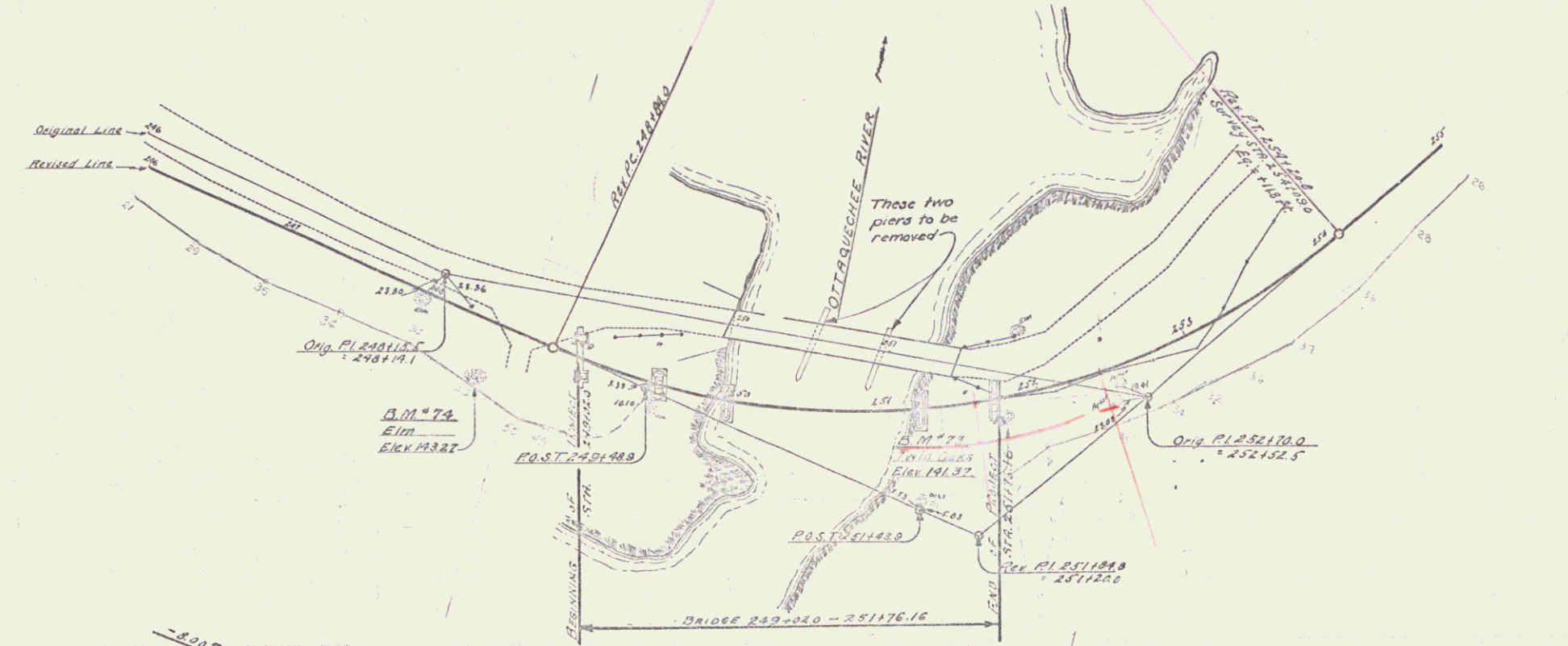

Top of Slope from Final Sections by Conis June 21, 1930
 HARTLAND BRIDGE
 P.L. 77E
 SCALE 1" = 50 FT.

170
160
150
140
130
120

170
160
150
140
130
120

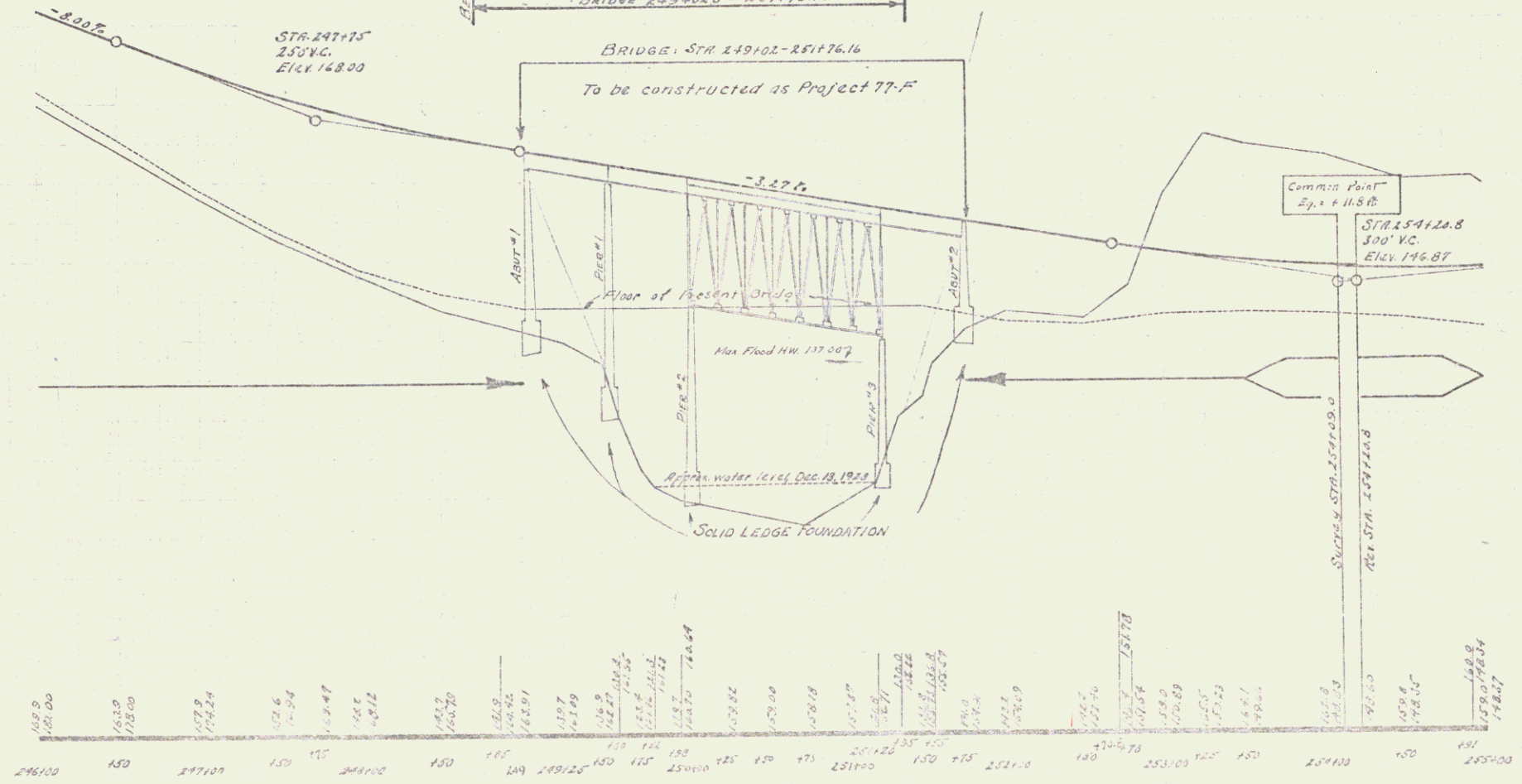

Δ 11° 73' to right of Sta. 251176 Elev. 141.37
 Δ 11° 73' to right of Sta. 249102 Elev. 143.87

HARTLAND BRIDGE
 SERIES P 77E
 SHEET 21 OF 73