

WEEP GUARD PAV. REQUIRED

Station	Left	Right
95+00-96+04	24"	24"
99+23-99+47	24"	24"
104+76-105+04	24"	24"
104+83-105+12	-	24"

NEW KENT SING. PIPE CULVERTS REQUIRED

Station	Width	Length	Conc. & Conc. R.	Steel
96+72	10'	31'	-	30cy, 38"
99+35	15'	35'	-	30cy, 38"
105+00	14'	44'	1.5cy	34"

77E 1939 11 73

Date: Aug 24, 1939
 Drawn by: A. S. ...

Date: Aug 24, 1939
 Drawn by: A. S. ...

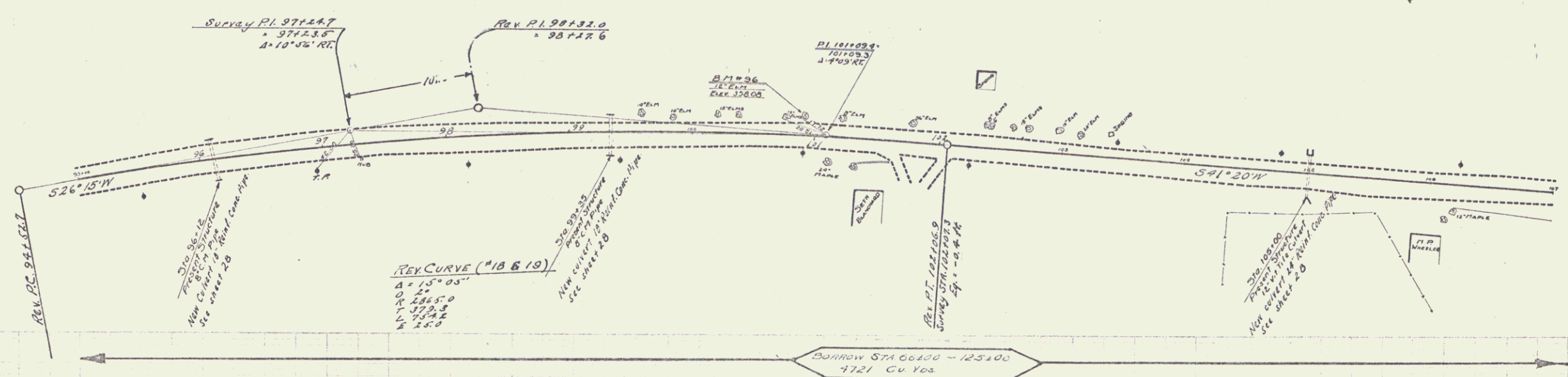
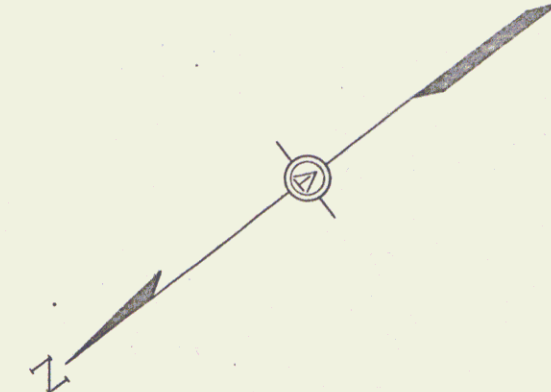

BORROW STA 00+00 - 125+00
 7721 Cu Yds

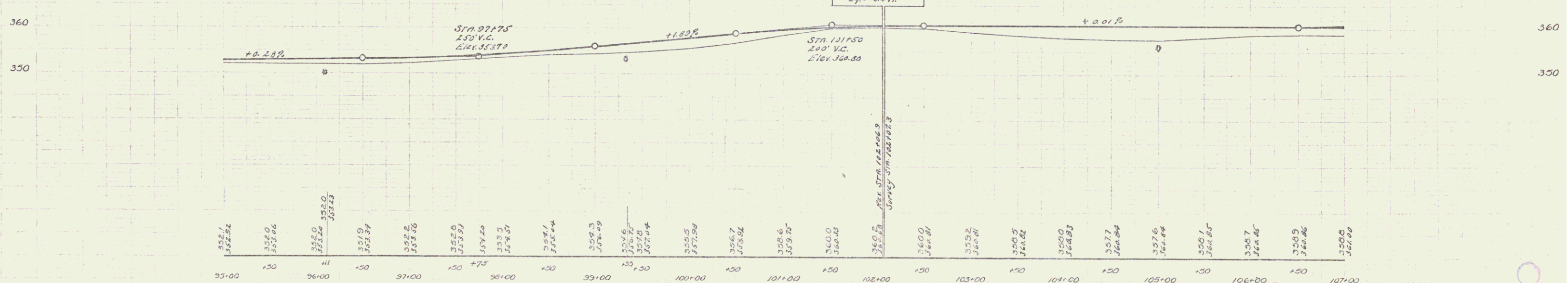

B.M. # 36 12' ELM LEFT STA 100+32 ELEV 358.05

SERIES F 11077E
SHEET 11 OF 73