

**NEW DEEP INLETS REQUIRED**

Station	Left	Right	Cl. Conc. Steel Grate
21165	14	1A	99
21840	14	1A	99
219130	14	1A	99

**NEW CAST IRON PIPE CONVERTS REQUIRED**

Station	Diam.	Length	Conc. H.	Steel
21190	15"	20'	3.0	314
21744	18"	45'		

**NEW CATCH BASIN REQUIRED**

Station	Left	Right
21748		R.

**NEW VITRIFIED CLAY PIPE REQUIRED**

Stations	Diam.	Length	Conc. H.	Steel
21165-21714	12"	536		
21910-21940	12"	30		
21940-21942	12"	2		

**CONCRETE CURB & GUTTER REQUIRED**

Stations	Side	Width	Length	Curb Height	Conc. A	Steel
20910-20940	RH	2.0'	30'	8 inches	3.9	2.9
21940-21942	RH	2.0'	2	8	1.8	1.4

**GRADED COBBLE GUTTER REQUIRED**

Stations	Side	Width	Length	Depth
21015-21440	RH	4.0'	415'	1.85'

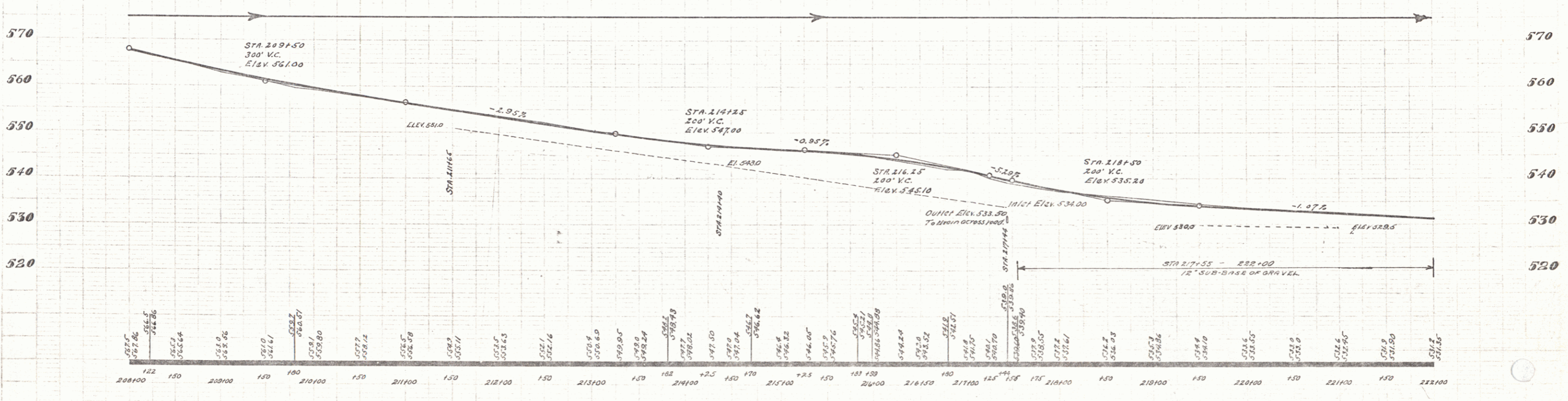
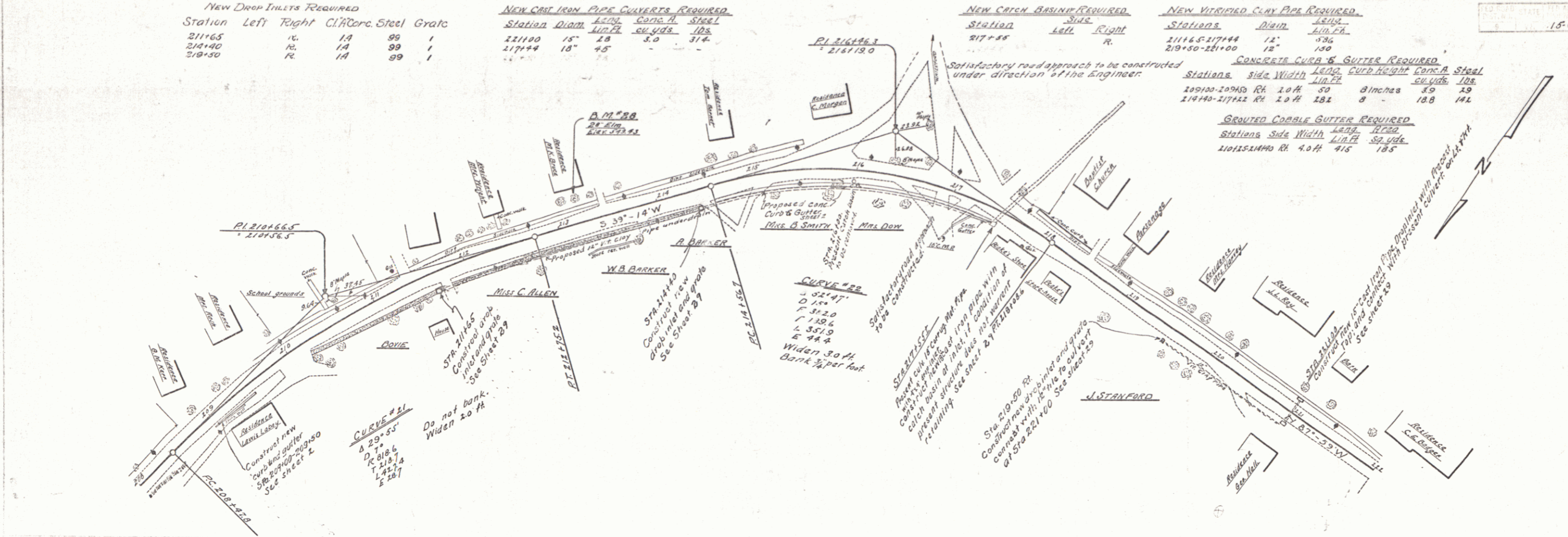

B.M. 26 Spike in root of 28 Elm, 23 ft. left of Sta. 213+34. Elev. 549.43

WOOD KIMBALL 1929

WOOD KIMBALL 1929

12