

CABLE GUARD RAIL REQUIRED		DROP INLETS REQUIRED (STANDARD)		CONCRETE CURB & GUTTER REQUIRED	
Stations	Length	Station	Conc. R. Steel Grates	Stations	Side Width
81103-84103	320	81100 R/L	1.4 cu yds 30" x 12" 8" H	80145-81100 R/L	2.0 ft 375#
85115-85117	32	81115 R/L	1.4 cu yds 30" x 12" 8" H	81115-81115 R/L	1.0 ft 205#
85115-85117	-			81115-81115 R/L	2.0 ft 375#
85115-85117	608			80130 R/L to 81100 R/L	3.0 ft 555#

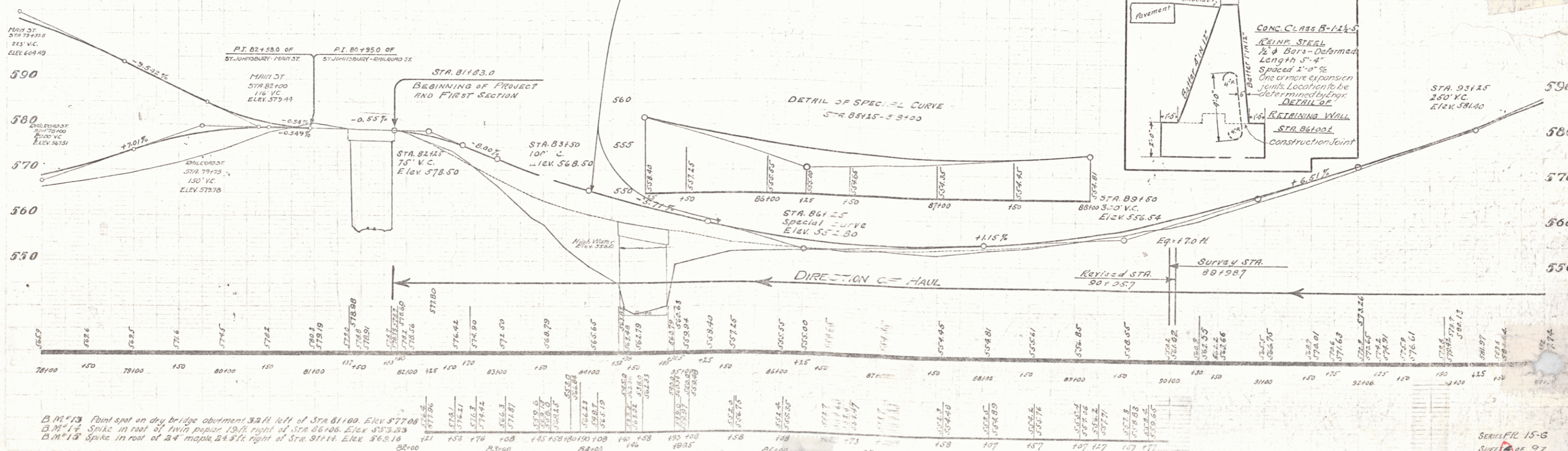
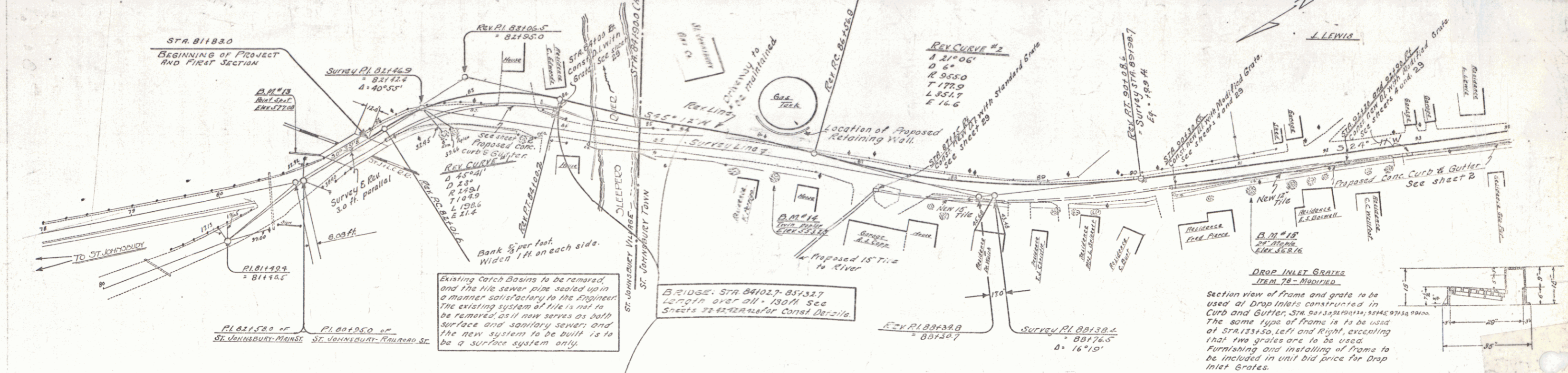

B.M. 13 Point spot on dry bridge abutment 30 ft left of Sta 81100. Elev 577.06
 B.M. 12 Spike in root of twin poplar 13 ft right of Sta 86100. Elev 533.53
 B.M. 13 Spike in root of 24 maple 24 ft right of Sta 81114. Elev 568.18