

WOOD GUARD RAIL REQUIRED
CULVERT STATIONS LEFT RIGHT

WOOD GUIDE POSTS REQUIRED
STATION LEFT RIGHT

CURVE #60 REV.
Δ = 10°-30' LT
D = 4'
R = 1432.7
T = 233.3
L = 402.5
E = 10.9

CABLE GUARD RAIL REQUIRED

STATIONS LEFT RIGHT

NEW DEWING PIPE CULVERTS REQUIRED

STATIONS DRAIN LENGTH CURVE A CONC. C. RAIN. SPEED CURVE B CONC. C. RAIN. SPEED

GROUPED COBBLE GUTTER REQUIRED

STATIONS STATION TO STATION LENGTH WIDTH AREA CONC. C. STEEL

NO.	DATE	BY	CHKD.	TITLE	TOTAL SHEETS
1	12-0-A	1930	5	58	

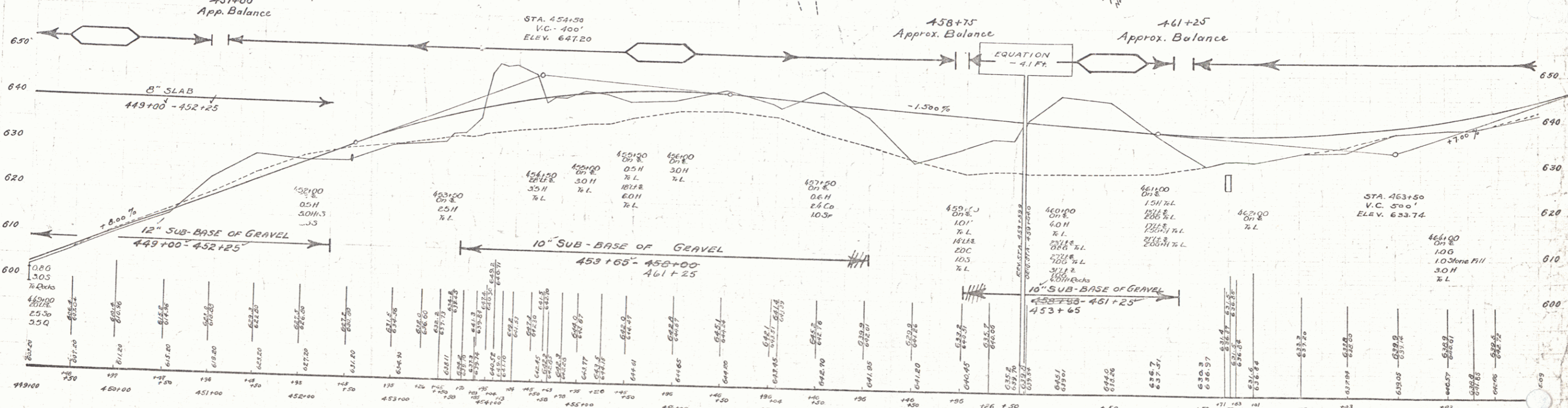
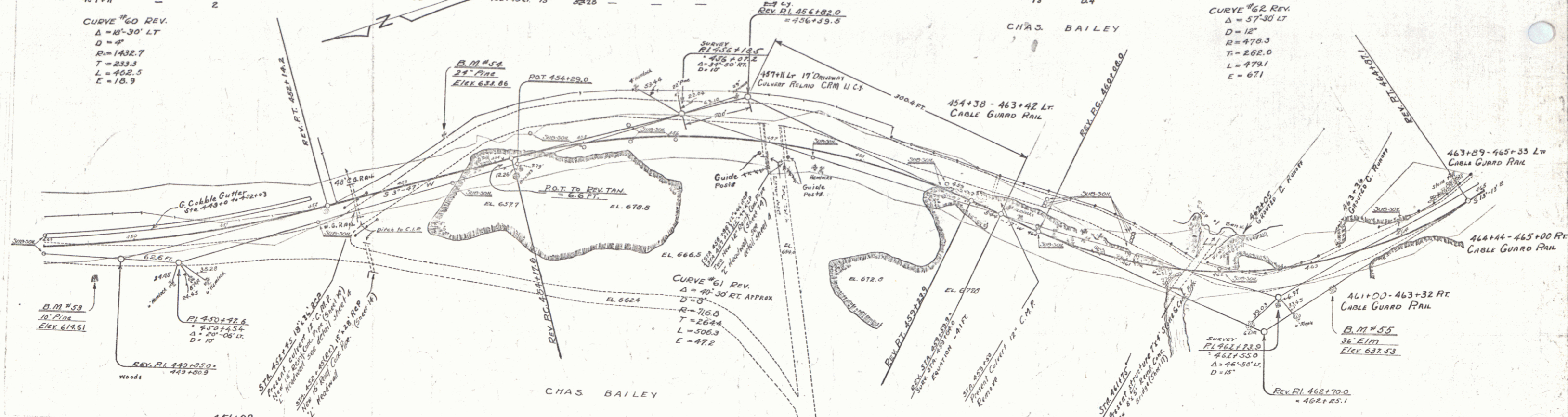

B.M. #53 SPIKE IN ROOT OF 10" W PINE 33' RT STA. 449+59 ELEV. 616.61
B.M. #54 SPIKE IN ROOT OF 24" W PINE 41' LT STA. 453+63 ELEV. 633.86
B.M. #55 SPIKE IN ROOT OF 36" ELM 28' RT STA. 463+18 ELEV. 637.53