

WOOD GUARD RAIL REQUIRED

CULVERT STATIONS	LEFT	RIGHT
443+00	24'	24'
448+00	24'	24'

CABLE GUARD RAIL RAIL REQUIRED

STATIONS	LEFT	RIGHT
440+00 to 444+00	8'	8'
443+00 to 448+00	10'	10'
443+14.75 to 444+52	10'	10'

NEW REIN. CONC. PIPE CULVERTS REQUIRED

STATIONS	DIAM.	LENGTH	CONC. CLASS	NO. OF	REIN. SPEC.
443+00	18"	20'	1	1	18
448+00	10"	44'	1	1	18

GROUTED COBBLE GUTTER REQUIRED

STATIONS	L.O.R.	LENGTH	WIDTH	DEPTH	NO. OF	REIN. SPEC.
440+00 to 444+00	R	40'	30"	12"	32.3	0.9 16"
440+00 to 441+00	R	10'	30"	12"	7.7	
440+00 to 448+00	L	88'	30"	12"	393	

DATE	12-0-25
SCALE	1" = 40'
SHEET	52

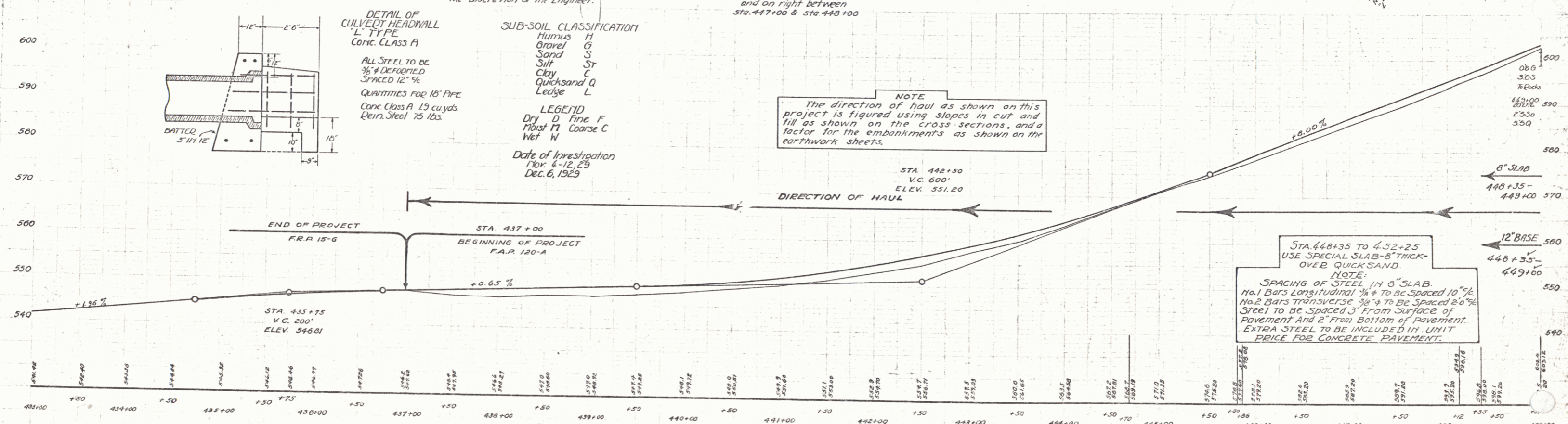
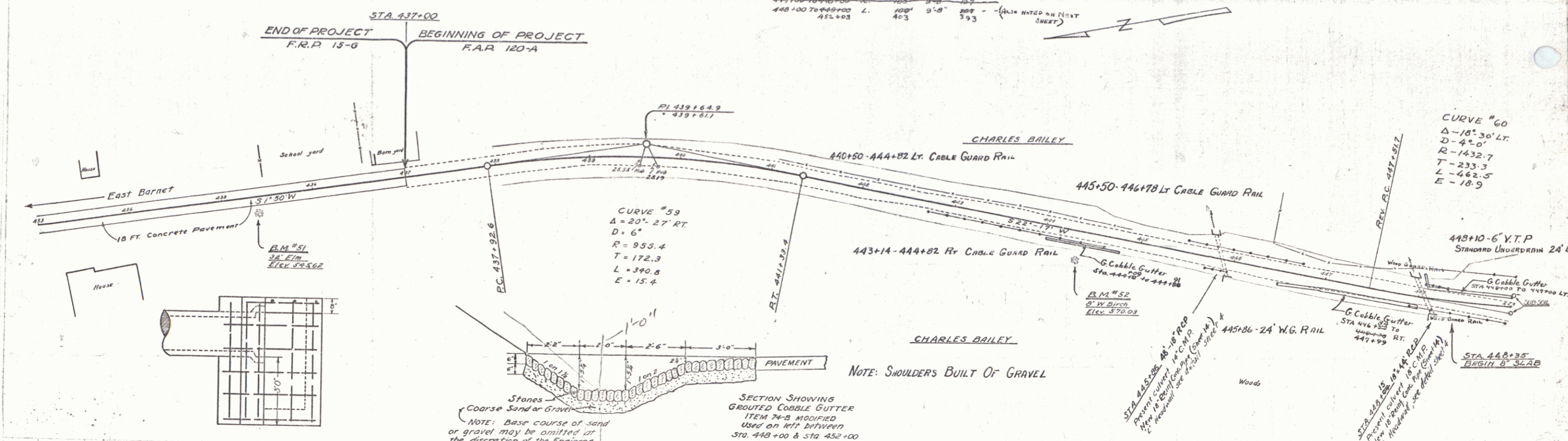

B.M. #51 SPIKE IN ROOT OF 32' ELM 135 FT RT. STA. 435+37 ELEV. 545.62
 B.M. #52 SPIKE IN ROOT OF 6" W. BIRCH RT. STA. 444+36 ELEV. 570.03

SERIES F No. 120A
 SHEET 52 OF 52