

CABLE GUARD RAIL REQUIRED
 Stations: 86+00 - 87+23
 Lt. 128' Rt. 128'

NEW REINFORCED CONC. BOX REQUIRED
 Station: 86+50 Size: 6'x6'
 See Sheet 19 For Details of Construction

GRAVEL COBBLE CUTTER REQUIRED
 Stations: 86+50 - 93+90
 Lt. 740 Rt. 740 Area: 247sq.yd.
 See note, sheet 19

STATE: F.R. COUNTY: SHERMAN
 DISTRICT: 15F SECTION: 11 SURVEY: 57

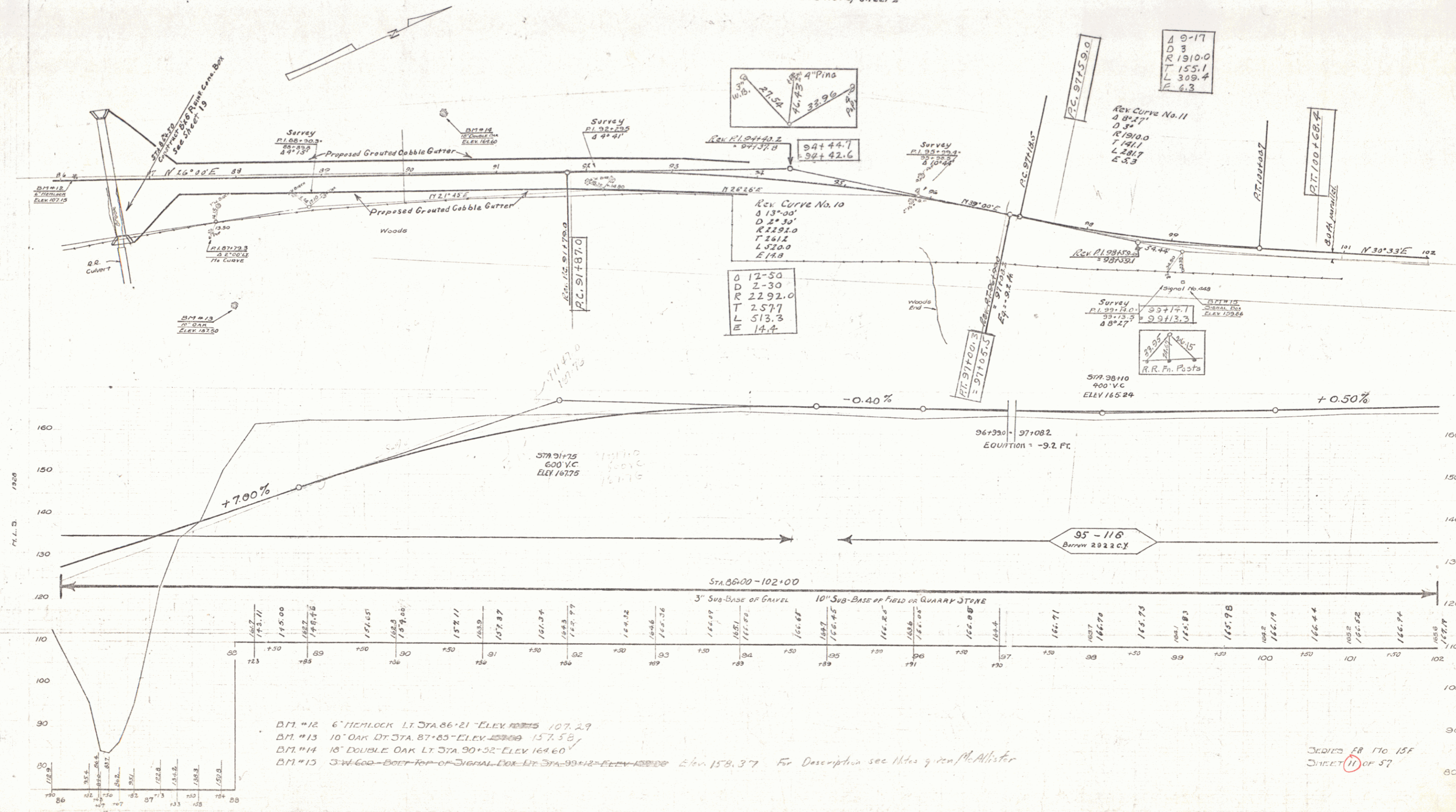

BM #12 6" Hemlock Lt. Sta. 86+21 - ELEV. 107.29
 BM #13 10" Oak Dt. Sta. 87+85 - ELEV. 157.58
 BM #14 18" Double Oak Lt. Sta. 90+32 - ELEV. 164.60
 BM #15 3" W. God - Bolt Top of Signal - For Lt. Sta. 99+42 - ELEV. 158.37 For Description see Notes given McAllister

SEE SHEET 19 FOR 15F
 SHEET 11 OF 57