

WOOD GUARD RAIL REQUIRED

Station	Left	Right
117140	24'	-

WOOD GUIDE POSTS REQUIRED

Station	Left	Right
116150	1	-

CABLE GUARD RAIL REQUIRED

Station	Left	Right
117141-126125	-	904'
119158-125158	592'	-
130128-131100	-	72'

NEW CAST IRON PIPE CULVERTS REQUIRED

Station	Diam	Length	Conc. P.	Steel O.T.
117140	15"	45'	31cy	184' 1"

NEW VIT. CLAY PIPE REQUIRED

Station	Size	Length
115100-116140 LH	12"	140'
116140-117136 LH	12"	94'

REINFORCED CONCRETE CURB AND GUTTER REQUIRED

Station	Length	Width	Conc. P.	Steel
115175-116150	75'	2'-0"	4.8cy	54#

GROUTED COBBLE GUTTER REQUIRED

Station	Width	Length	Area
117110-117116 RH	3'-0"	30'	70 sq. yds.
117115-122150 LH	2'-6"	475'	132
120100 LT Runoff	2'-6"	57'	16
122130 LT Runoff	2'-6"	57'	16

BRICK CATCH BASINS REQUIRED

Station	Side
116140	LH

Note: 115160 & 115190
 These trees to be saved

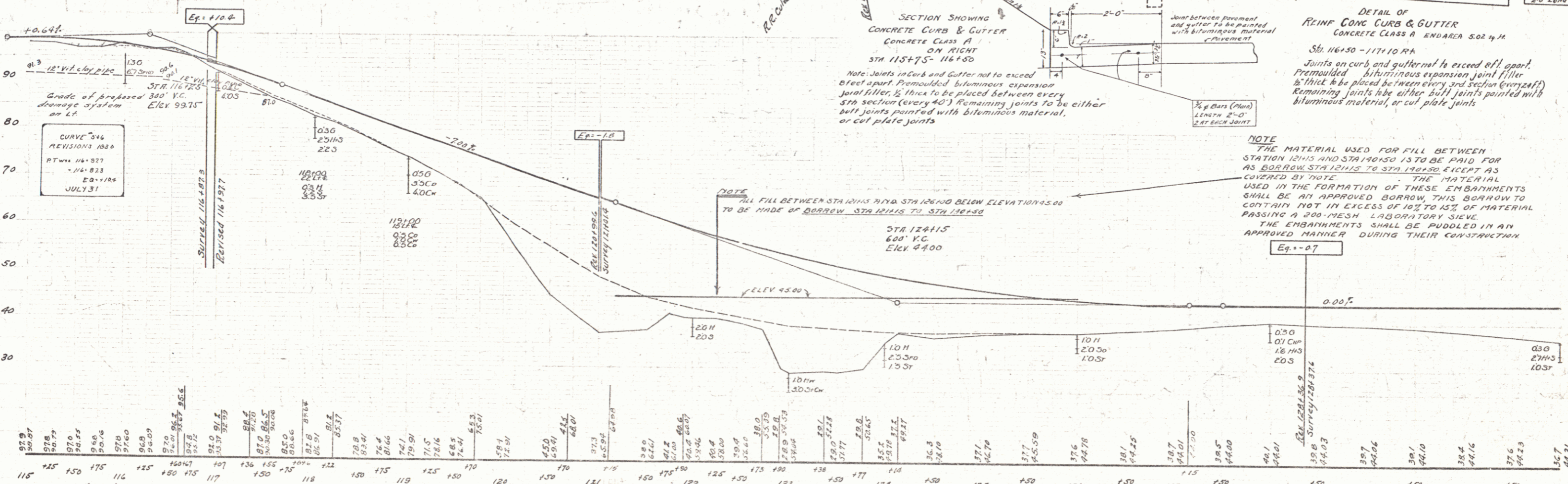
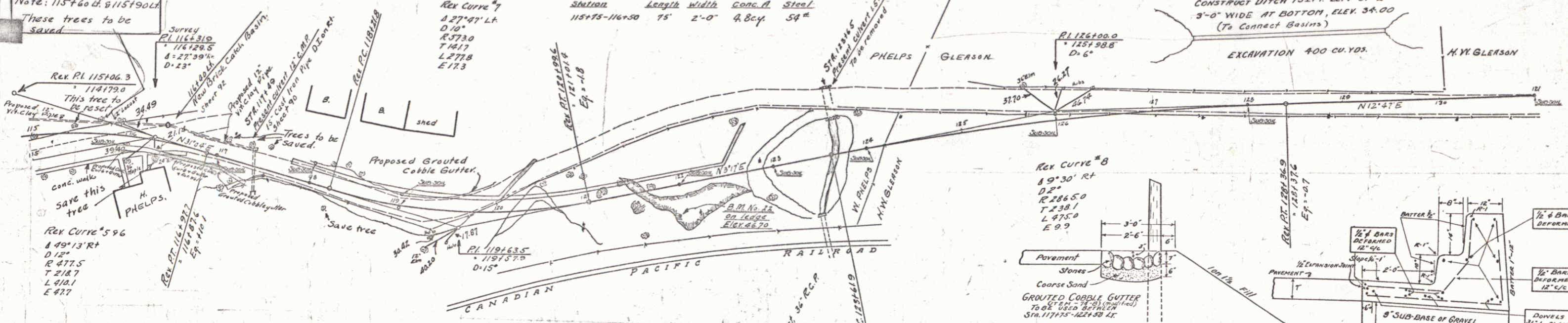

B.M. Sta 121145 Point on ledge on right Elev 46.70
 Power Co. B.M. 19 Elev 46.97 - Elev 50.84 of Highway Survey Levels.

SECTION SHOWING CONCRETE CURB & GUTTER CONCRETE CLASS A ON RIGHT STA 115175 - 116150

Note: Joints in curb and gutter not to exceed 2 feet apart. Preformed bituminous expansion joint filler 1/2" thick to be placed between every 3rd section (every 24"). Remaining joints to be either butt joints painted with bituminous material, or cut plate joints.

DETAIL OF REINFORCED CONCRETE CURB & GUTTER CONCRETE CLASS A END AREA 5.02 sq. ft. STA 116150 - 117110 RH

Joints on curb and gutter not to exceed 2 ft. apart. Preformed bituminous expansion joint filler 1/2" thick to be placed between every 3rd section (every 24"). Remaining joints to be either butt joints painted with bituminous material, or cut plate joints.

NOTE
 THE MATERIAL USED FOR FILL BETWEEN STATION 121145 AND STA 121145.15 TO BE PAID FOR AS BORROW STATION 121145 TO STA 121145.15 EXCEPT AS COVERED BY NOTE. THE MATERIAL USED IN THE FORMATION OF THESE EMBANKMENTS SHALL BE AN APPROVED BORROW. THIS BORROW TO CONTAIN NOT IN EXCESS OF 10% TO 15% OF MATERIAL PASSING A 200-MESH LABORATORY SIEVE. THE EMBANKMENTS SHALL BE PUDDLED IN AN APPROVED MANNER DURING THEIR CONSTRUCTION.