

Wood Guard Rail Required  
 Right  
 Sta 94+25 to 94+37 length 12 ft  
 Sta 102+35 to 102+37 length 2 ft  
 Left  
 Sta 102+35 to 102+37 length 2 ft  
 Sta 94+18 to 94+37 length 19 ft

Cable Guard Rail Required  
 Left  
 Sta 94+25 to 94+37 length 12 ft  
 Sta 94+18 to 94+37 length 19 ft

New Culverts Required  
 Sta 94+25 15" R/C Pipe length 32 ft  
 Sta 98+40 15" R/C Pipe length 32 ft  
 Sta 102+45 15" R/C Pipe length 36 ft

Relief Culvert (Drive By) Required  
 Sta 102+35 12" R/C Pipe length 16 ft  
 Sta 94+18 12" R/C Pipe length 19 ft

Proj. No.	Sheet No.	Project Name	Scale	Sheet No.	Total Sheets
9	W	648	1927	7	32

Concrete Retaining Wall Required  
 Right  
 Sta 97+30 to 98+36 length 70 ft  
 Left  
 Sta 97+30 to 98+36 length 70 ft

37

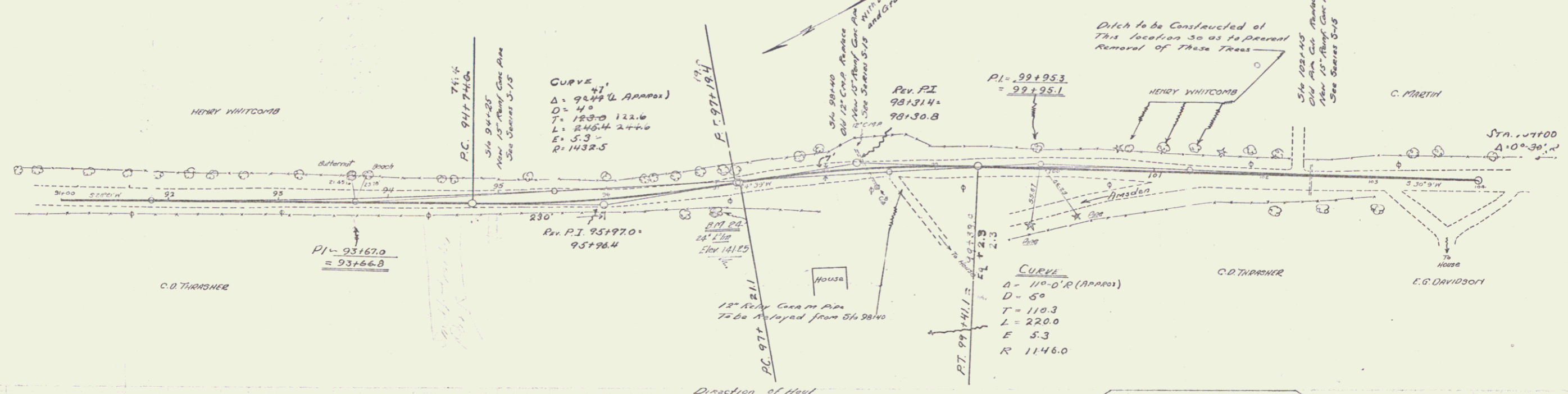

Direction of Road  
 SEE NOTE  
 NOTE - Borrow is to be made from Excess Cut taken from Windsor F.P. 87B

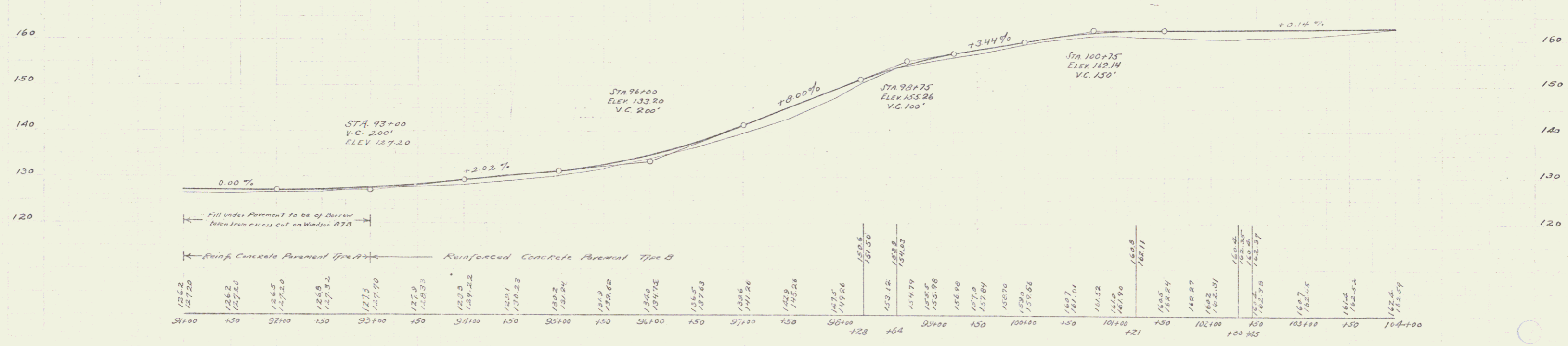

ST 24-24-100 RT of STA 97+00 - ELEV 141.25 ft

5