

INDEX OF SHEETS

SHEET NO. 1	TITLE PAGE
2	TYPICAL CROSS-SECTION OF IMPROVEMENT
3	BANKING AND WIDENING TABLES
4	PLAN AND PROFILE

FED. ROAD DIST. NO.	STATE	FED. AID PROJ. NO.	FISCAL YEAR	SHEET NO.	TOTAL SHEETS
9	Vt.				

STATE OF VERMONT
STATE HIGHWAY DEPARTMENT

PLAN AND PROFILE OF PROPOSED
STATE HIGHWAY
FEDERAL AID PROJECT

TOWN OF WEATHERSFIELD
ROUTE U.S. 5
CONNECTICUT RIVER ROAD

BEGINNING AT A POINT 900 FT. SOUTHERLY FROM THE INTERSECTION OF VT. ROUTE 12 AND U.S. ROUTE 5 IN WEATHERSFIELD AND EXTENDING SOUTHERLY 190 FT.

LENGTH OF PROJECT 190 FEET = 0.04 MILES

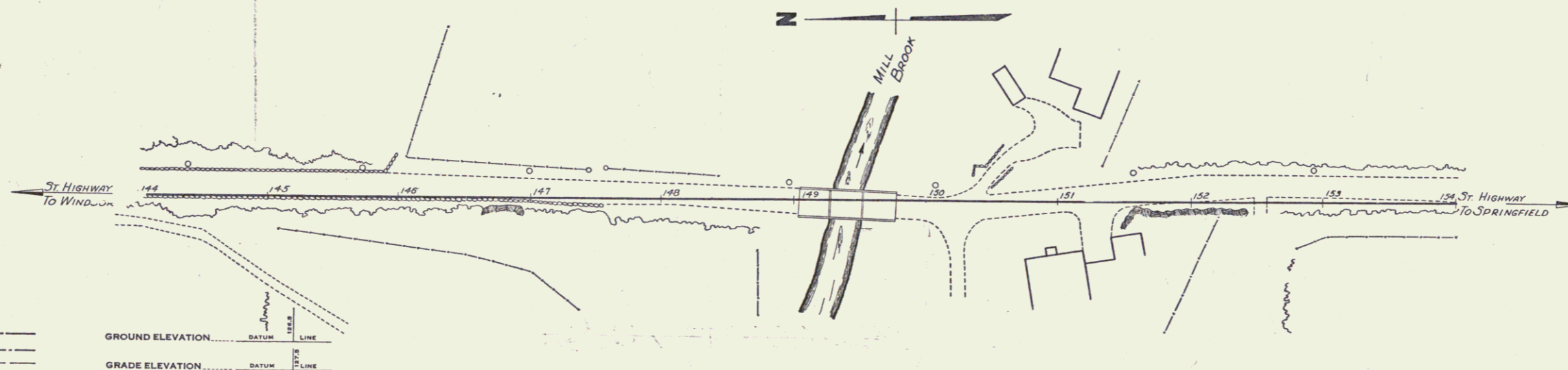
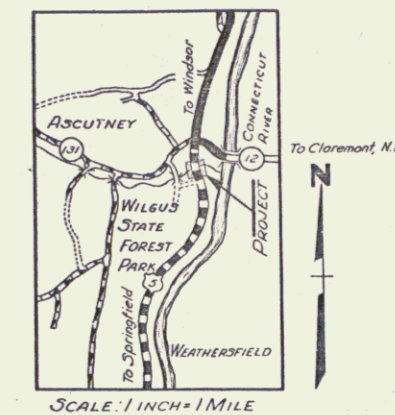

GROUND ELEVATION..... DATUM..... LINE
GRADE ELEVATION..... DATUM..... LINE

CURVE DATA

DEFLECTION ANGLE.....	Δ
DEGREE OF CURVE.....	D.
RADIUS OF CURVE.....	R.
TANGENT DISTANCE.....	T.
LENGTH OF CURVE.....	L.
EXTERNAL DISTANCE.....	E.
POINT OF INTERSECTION.....	P. I.
POINT OF CURVE.....	P. C.
POINT OF TANGENT.....	P. T.
POINT ON TANGENT.....	P. O. T.

SCALES

TITLE	1" = 30'
TYPICAL	1" = 2'
PLAN	1" = 30'
PROFILE HORIZONTAL	1" = 30'
PROFILE VERTICAL	1" = 10'
CROSS SECTIONS	1" = 5'

CONCRETE T BEAM BRIDGE
LENGTH OVERALL 750'
ROADWAY 210'

THESE PLANS ARE SUBJECT TO SUCH REVISIONS AS MAY BE REQUIRED BY THE PUBLIC ROADS ADMINISTRATION OR THE COMMISSIONER OF HIGHWAYS.
CONSTRUCTION IS TO BE CARRIED ON IN ACCORDANCE WITH THE PLANS AND THE STANDARD ROAD AND BRIDGE SPECIFICATIONS OF 1936, AS APPROVED DECEMBER 29TH, 1936 BY THE PUBLIC ROADS ADMINISTRATION, INCLUDING ALL SUBSEQUENT APPROVED REVISIONS AND SUCH REVISED SPECIFICATIONS AND SPECIAL PROVISIONS AS ARE SUBMITTED WITH THE PLANS.

APPROVED: _____

COMMISSIONER OF HIGHWAYS
SUBMITTED BY ORDER OF THE STATE HIGHWAY BOARD

RECOMMENDED FOR APPROVAL

DISTRICT ENGINEER
PUBLIC ROADS ADMINISTRATION
FEDERAL WORKS AGENCY

APPROVED

COMMISSIONER OF
PUBLIC ROADS ADMINISTRATION
FEDERAL WORKS AGENCY

APPROVED	APPROVED	SERIES F No.	FILED
ROAD ENGINEER	DISTRICT HIGHWAY COMMISSIONER	SHEET (1A) OF	