

INDEX OF SHEETS

SHEET NO.	1	TITLE PAGE
-	2	TYPICAL CROSS-SECTION OF IMPROVEMENT
-	3	BANKING AND WIDENING TABLES
-	4	PLAN AND PROFILE

FED. ROAD DIST. NO.	STATE	FED. AID PROJ. NO.	FISCAL YEAR	SHEET NO.	TOTAL SHEETS
9	VT.				

STATE OF VERMONT
STATE HIGHWAY DEPARTMENT

PLAN AND PROFILE OF PROPOSED
STATE HIGHWAY

TOWN OF WEATHERSFIELD

ROUTE U.S. 5

CONNECTICUT RIVER ROAD

BEGINNING AT THE INTERSECTION OF VT. ROUTE 12 AND U.S. ROUTE 5
IN WEATHERSFIELD AND EXTENDING SOUTHERLY

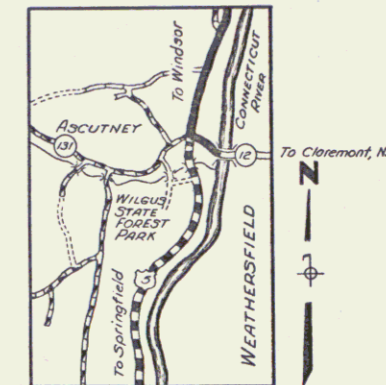

SCALE: 1 INCH = 1 MILE

Form of U.S.S. PERPETUAL TOWN FILE NO. 6011
NO. 6011 DIVISION HIGHWAY-OR-RAV. DIVISION

Project: FAP 64A(2)
Pin # 990 336

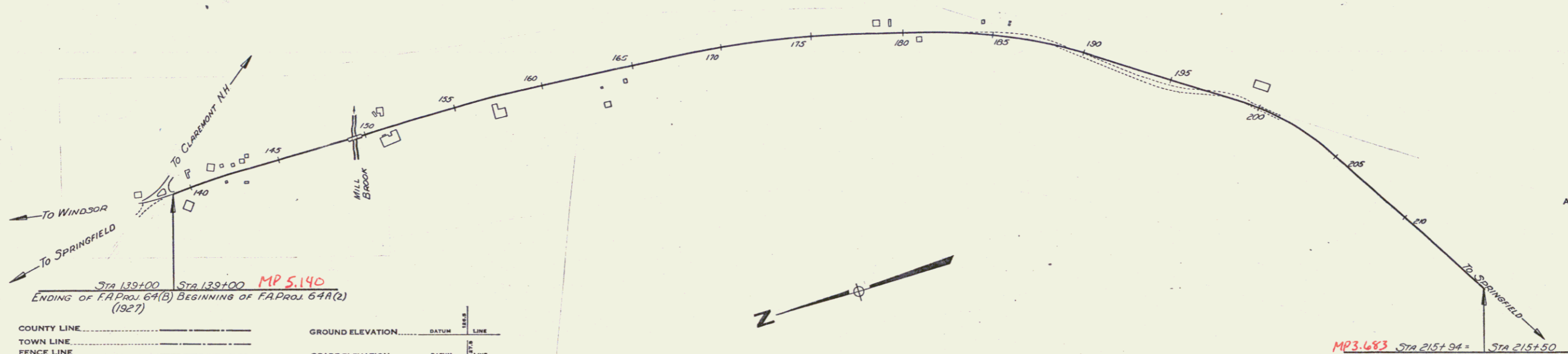

Sta 135+00 Sta 139+00 MP 5.140
ENDING OF F.A. PROJ. 64A(B) BEGINNING OF F.A. PROJ. 64A(2) (1927)

- COUNTY LINE
- TOWN LINE
- FENCE LINE
- STONE WALL
- UNFENCED PROPERTY
- GUARD RAIL
- TRAVELED WAY
- RAILROAD
- RETAINING WALL
- CENTER LINE
- SURVEY LINE
- CULVERT
- DROP INLET
- TROLLEY POLE
- POWER POLE
- TELEPHONE POLE
- TREES
- HEDGE

GROUND ELEVATION DATUM LINE
GRADE ELEVATION DATUM LINE

- CURVE DATA
- DEFLECTION ANGLE
 - DEGREE OF CURVE
 - RADIUS OF CURVE
 - TANGENT DISTANCE
 - LENGTH OF CURVE
 - EXTERNAL DISTANCE
 - POINT OF INTERSECTION
 - POINT OF CURVE
 - POINT OF TANGENT
 - POINT ON TANGENT

- SCALES
- TITLE
 - TYPICAL
 - PLAN
 - PROFILE
 - CROSS SECTIONS

THESE PLANS ARE SUBJECT TO SUCH REVISIONS AS MAY BE REQUIRED BY THE PUBLIC ROADS ADMINISTRATION OR THE COMMISSIONER OF HIGHWAYS.
CONSTRUCTION IS TO BE CARRIED ON IN ACCORDANCE WITH THE PLANS AND THE STANDARD ROAD AND BRIDGE SPECIFICATIONS OF 1936, AS APPROVED DECEMBER 29TH, 1936 BY THE PUBLIC ROADS ADMINISTRATION, INCLUDING ALL SUBSEQUENT APPROVED REVISIONS AND SUCH REVISED SPECIFICATIONS AND SPECIAL PROVISIONS AS ARE SUBMITTED WITH THE PLANS.

APPROVED	APPROVED	SERIES F NO.	FILED
ROAD ENGINEER	DISTRICT HIGHWAY COMMISSIONER	SHEET 1 OF	

10/1/40

24(A 2)