

PER ROAD DIST. NO.	STATE	E.R. PROJ. NO.	SHEET NO.	TOTAL SHEETS
9	VT.	1	1	96

INDEX OF SHEETS

SHEET NO.	TITLE PAGE
1	TITLE PAGE
2-3	TYPICAL CROSS-SECTION OF IMPROVEMENT CHADUNG, BASE, DRAINAGE & GUARD RAIL WITH DOUBLE TACK COAT OF REFINED TAR - ITEM 29
4	BANKING AND WIDENING TABLES
5-16	PLAN AND PROFILE STA.
17	DETAILS OF 2x3 CONC. BOX STA. 303+85
18	DETAILS OF 2x2 CONC. BOX STA. 317+50
19	PIPE CULVERTS-----5-28
20	BOX CULVERTS-----5-29
21	GUARD RAIL-----5-30
22	BOUNDARY MARKERS-----5-31
23	STANDARD BOXES-----5C-1
24	BARRICADES & LIGHTS-----5-40
25-30	CROSS-SECTIONS

STANDARD STRUCTURE SHEETS APPROVED BY THE CHIEF ENGINEER

SHEETS 5 28 & 5 29	JULY 11, 1933
SHEET 5 30	AUG 15, 1933
SHEET 5 31	JULY 25, 1934

STATE OF VERMONT
STATE HIGHWAY DEPARTMENT
PLAN AND PROFILE OF PROPOSED STATE HIGHWAY
EMERGENCY RELIEF PROJECT

TOWN OF WEATHERSFIELD

WINDSOR-SPRINGFIELD ROAD

BEGINNING AT A POINT 3.1 MILES SOUTH OF THE WINDSOR-WEATHERSFIELD TOWN LINE AND EXTENDING SOUTHERLY 2.400 MILES.

Route - US5
Project: ERI
Pin# 992335

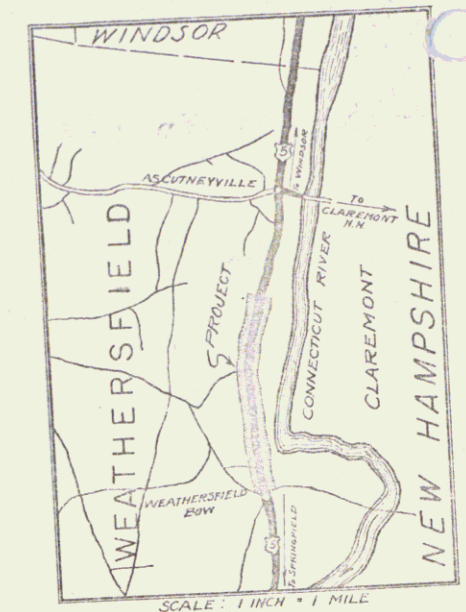

RIGHT-OF-WAY DIVISION
OWN FILE
PERMIT
Town of USS
To Be Returned To R.O.W. Division

LENGTH OF PROJECT: 12,669.9 FT. = 2.400 MILES

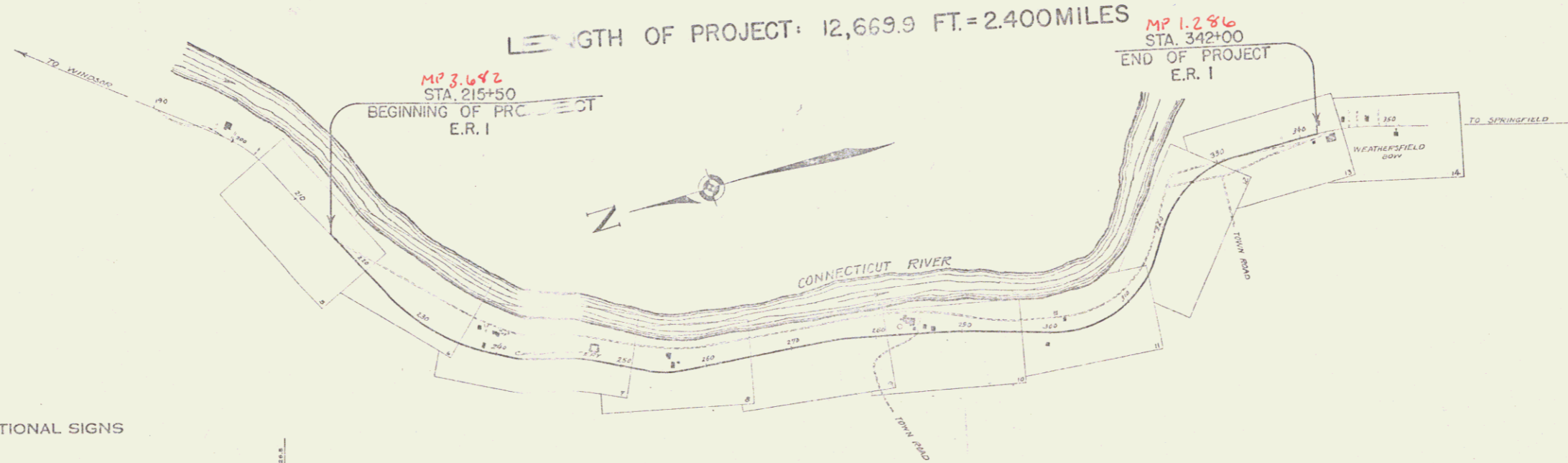

APPROVED: Nov 14, 1936
COMMISSIONER OF HIGHWAYS
SUBMITTED BY ORDER OF THE STATE HIGHWAY DEPARTMENT

CONVENTIONAL SIGNS

COUNTY LINE	GROUND ELEVATION
TOWN LINE	GRADE ELEVATION
FENCE LINE	
STONE WALL	
UNFENCED PROPERTY	
GUARD RAIL	
TRAVELED WAY	
RAILROAD	
RETAINING WALL	
CENTER LINE	
SURVEY LINE	
CULVERT	
DROP INLET	
TROLLEY POLE	
POWER POLE	
TELEPHONE POLE	
TRAILER	
HEUGE	

SCALES

TITLE	1" = 800'
TYPICAL	1" = 2'
PLAN	1" = 50'
PROFILE	HOR. 1" = 50'
	VER. 1" = 10'
CROSS-SECTIONS	1" = 5'

These plans are subject to such revisions as may be required by the Bureau of Public Roads or the Commissioner of Highways. Construction is to be carried out in accordance with the plans and Standard Road and Bridge Specifications of 1935 including all subsequent approved revisions and such revised specifications and special provisions as may be submitted with the plans. Attention of the contractor is called to the fact that the State Highway Board reserves the right to extend this project at the same contract prices. Said cost of extension not to exceed 25% of the amount of the contract.

RECOMMENDED FOR APPROVAL

RECOMMENDED FOR APPROVAL

APPROVED

FILED

SHEET 1 OF 96

DIST # 2 Plans