

DATE: 12/1/00  
 DRAWN BY: [Signature]  
 CHECKED BY: [Signature]

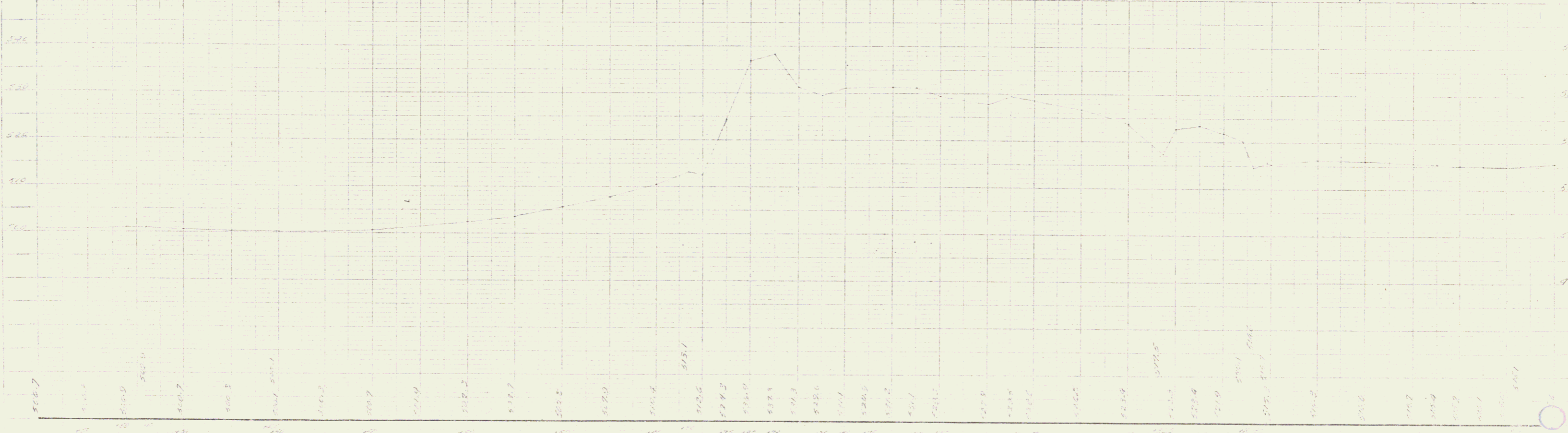
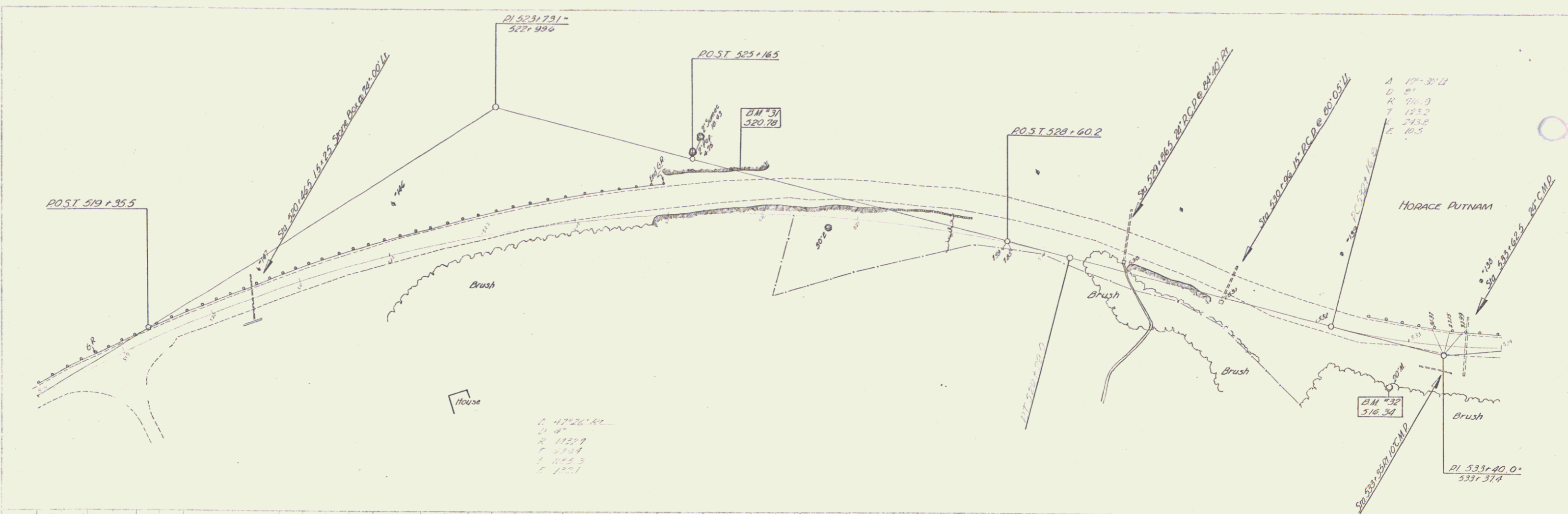

BM #31 Spot on Ledge 40ft. Lt. of Sta. 525+75 Elev. 520.78  
 BM #32 Spike in Root of 24" Maple 40ft. Rt. of Sta. 532+80 Elev. 516.38