

WOOD GUARD RAIL REQUIRED			CABLE GUARD RAIL REQUIRED		
Stations	Left	Right	Stations	Left	Right
123+00-124+10	-	24 Lin.Ft.	132+30-133+00	70 Lin.Ft.	-
125+29-125+53	24 Lin.Ft.	-			
132+75-132+99	-	24			

CONCRETE CURB+GUTTER REQUIRED
 STA 121+50-126+50 Right 500ft. 2'-0" 8" 32x4 500'

FED. ROAD DIST. NO.	STAT. VT.	FED. AID PROJ. NO.	FISCAL YEAR	SHEET NO.	TOTAL SHEETS
9	VT.	TT-D	1929	6	13

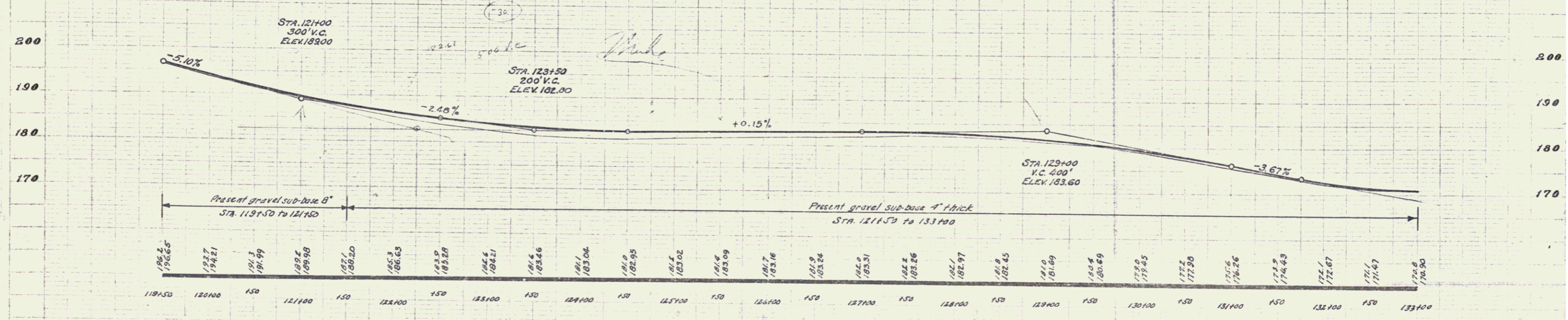
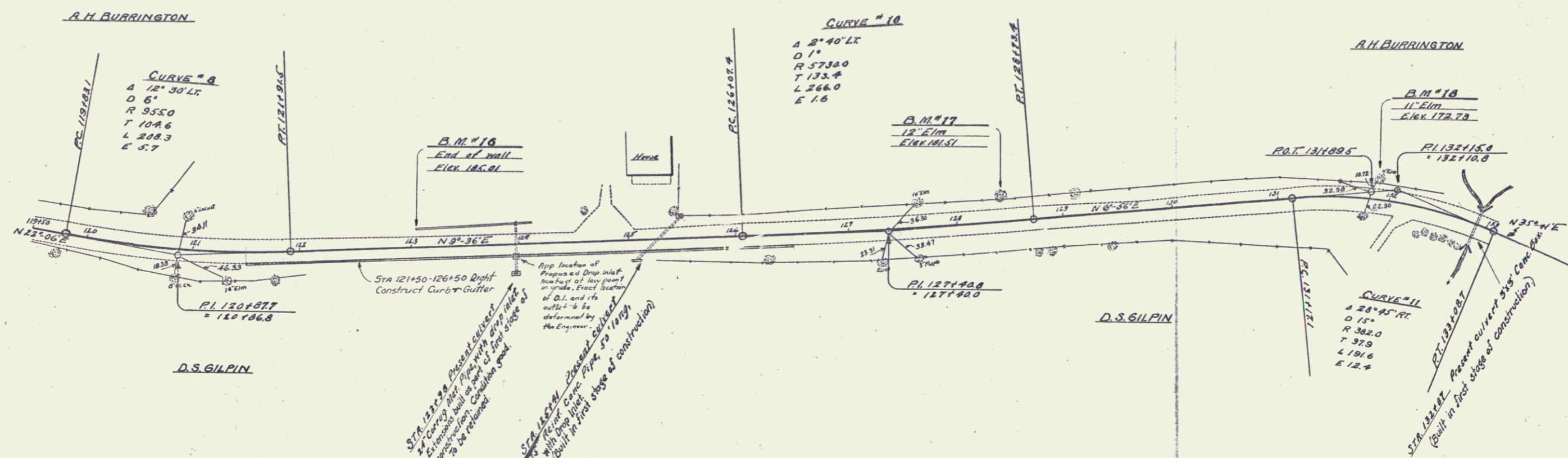

B.M. #16 South end concrete retaining wall left of Sta 123+05. Elev 105.01
 B.M. #17 Spike in trunk of 12 Elm left of Sta 120+48. Elev 101.51
 B.M. #18 Spike in roof of 11 Elm left of Sta 131+91. Elev 172.73

SERIES F # 77-D
 SHEET 6 OF 13