

WOOD GUARD RAIL REQUIRED

Stations	Left	Right
106+00-107+1/2	24 Lin. Ft.	24 Lin. Ft.
111+38-111+62	24 "	-

CABLE GUARD RAIL REQUIRED

Stations	Left	Right
110+26-111+62	-	36 Lin. Ft.
112+25-115+93	-	360 "
115+09-115+31	48 Lin. Ft.	-

CONCRETE CURB + GUTTER REQUIRED

STATIONS	L.S.	LENG.	WIDTH OF GUTTER	HEIGHT OF CURB	CONC. CLASS	STEEL DIMENSIONS
111+50-116+00	Right	450 Ft.	2'-0"	6"	2504	905#

FED. ROAD DIST. NO.	STATE	FED. AID PROJ. NO.	FISCAL YEAR	SHEET NO.	TOTAL SHEETS
2	VT	11-D	1929	5	13

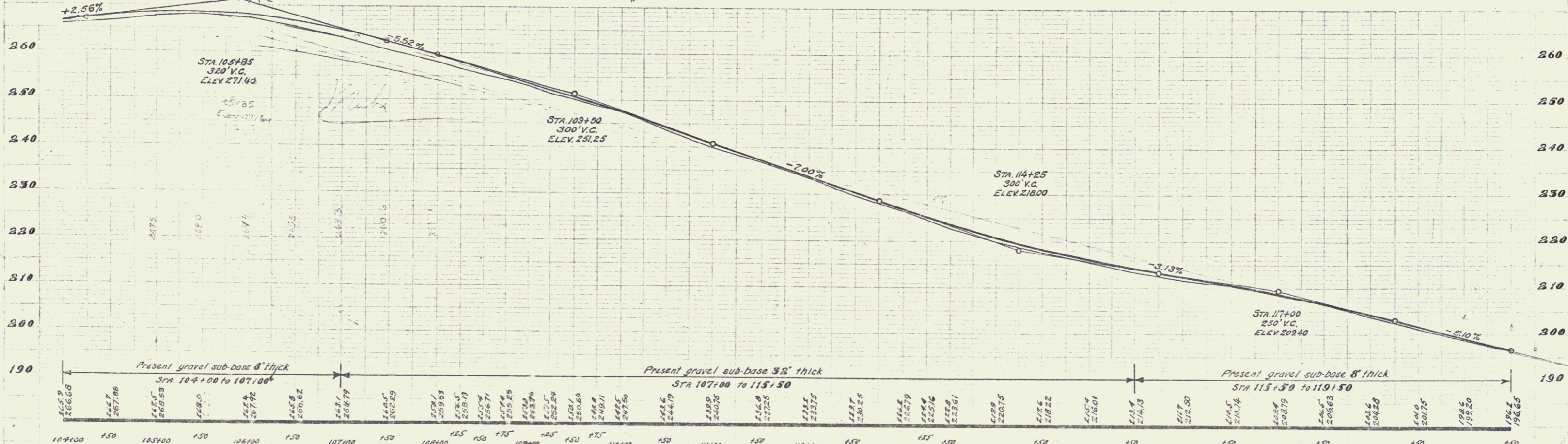
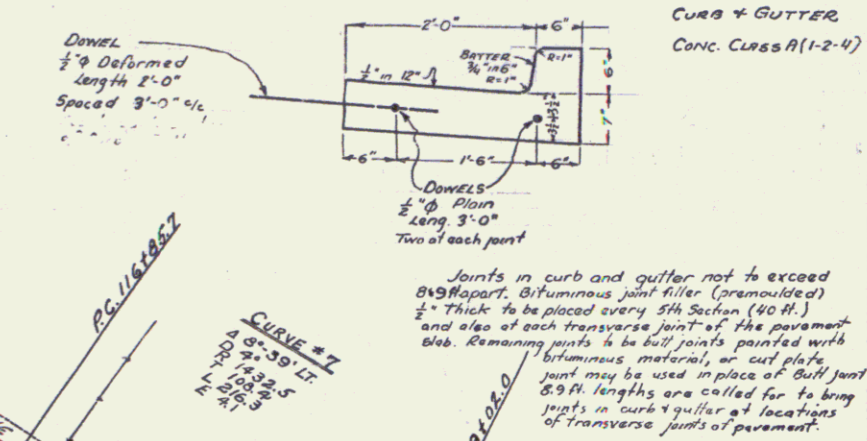
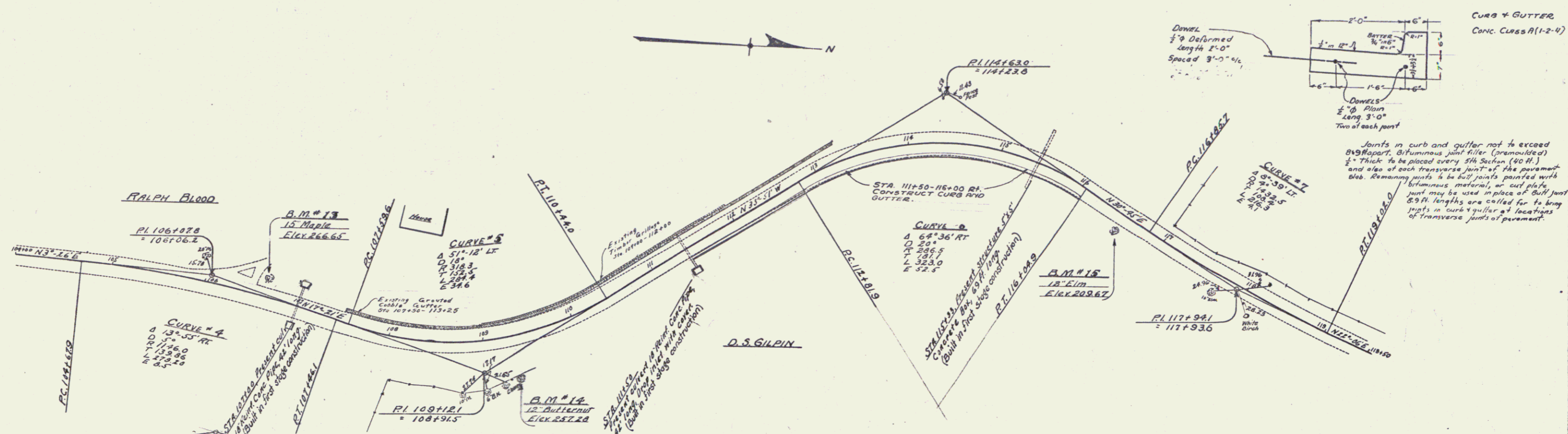

B.M. #13 spike in 13" Maple, left of Sta. 106+75±, Elev. 266.65  
 B.M. #14 spike in trunk 12" Butternut, right of Sta. 109+33, Elev. 257.28  
 B.M. #15 spike in root 1 1/2" Elm, right of Sta. 116+52, Elev. 209.67

SERIES 5-477-D  
 SHEET 5 OF 13